

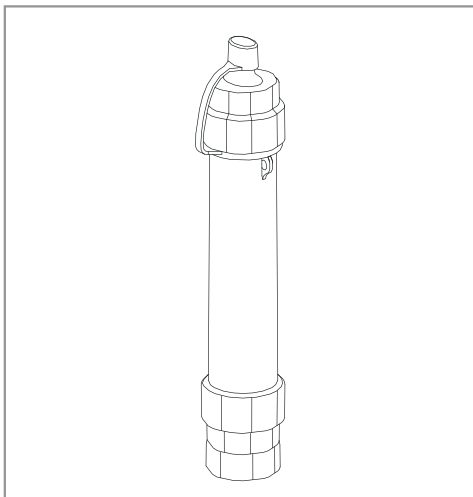

Water-Straw User Manual



Model: M01013

Please retain user manual for future reference

I. Specifications

Description	Spec.
Temperature range	34-104°F
Filter Capacity	5000L (1321Gallons)
Flow Rate Max	450mL/min
Pore Size	0.1µm

II. Diagram

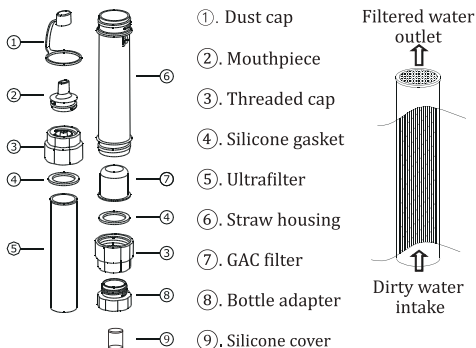

III. Instruction

Membrane Solutions® Water-Straw filters water quickly and easily. The product requires no batteries, and filters at least 5,000 liters of water over its lifetime.

Membrane Solutions® Water-Straw can be used to drink directly from surface waters, like a river or lake, or a container, like a bottle or a glass. It can even be connected to Membrane Solutions Gravity Bag for treating and storing bulk water. Its lightweight and slender design makes it perfect for hiking, travelling, and camping in areas where water may be unsafe to drink due to contamination by bacteria.

Membrane Solutions® Water Filter uses advanced ultrafiltration membrane technology that can remove up to 99.99999 percent of bacteria (e.g., Escherichia coli, Native klebsiella).

IV. Operating Instructions

1. Modes of Use

1) Draw in surface water directly through the intake of the Water-Straw.	2) Draw water from a container.
3) Draw water from a squeezable or rigid bottle threaded to the Water-Straw.	4) Connect and hang from a water-bag of water and let gravity fill a container.
5) Place inline or connect to the end of the tubing bag system.	6) Compatible with most Membrane Solutions water bottles.

(Note: if the ultrafilter fibers are wet, then it's important to make sure there is no air gap between the fibers and water. The ultrafilter module must be flooded in order to allow drawn or pressurized flow through the filter.)

2. Backwash After Use.

If the Water-Straw won't be used for an extended period of time, or if flow rate or taste quality has diminished then it is recommended to backflush. Backflushing is more effective if performed before letting the filter to dry out.

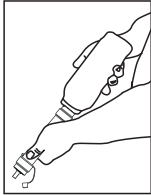

First remove the dust cap, then twist off the mouthpiece and thread on a squeezable plastic water bottle (e.g., ones commonly available at grocery stores) containing clean and safe water to the threaded cap. Some bottles need to be connected to the bottle adapter first. Then with the bottle connected, invert the Water-Straw so that the intake is pointed downward. Gently squeeze the bottle so that water from the bottle flows slowly out of the straw intake. Backwashing is more effective if the pressure is pulsed. ~500ml (17oz) should be sufficient. Please visit our website for demonstration video.

If the Water-Straw is going to be stored for an extended period of time then it is highly advisable to disassemble and let air dry for 1-2 days prior to storing. Do not store in sun or in areas with elevated temperatures. Recommended to store in a refrigerated environment (do not freeze if wet).

3. Product Service Life & Filter Replacement

Typical life is 5,000L of filtered water. However, if it is difficult to draw water through the Water-Straw, or if the flow rate has greatly diminished, then try backflushing. If water taste has deteriorated then backflush, allow to dry, and replace the GAC filter. If these steps don't improve performance, then the Water-Straw or the ultrafiltration module needs replacing.

4. Storage

Store at normal temperature and humidity (0-40°C, <75%), avoid high temperature and humidity, and store at no lower than 0°C.

The storage temperature must be higher than 0°C.

It is necessary to put the silicone cover on when storing whether unused or after cleaning.

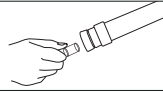

Description	Replacement schedule	Part NO.
UF Filter	12-18 months	OESF014
GAC(UDF) Filter	6-12 months	

V. Caution

To ensure long life use with relatively clean and turbid free surface water.

Never use Membrane Solutions® Water-Straw to filter seawater or chemically or oil contaminated water, including water from mine tailing ponds or from near large agricultural operations.

Careless or unintended use may result in damaging this product. Discard this product if any of the components become cracked or damaged.

This product must not be used by children without adult supervision.

Do not drop the product in polluted water as this might contaminate the outlet the filter.

Always keep the mouthpiece covered with the provided dust cap when product is not in use.

VI. Disclaimer

Membrane Solutions Corp shall be neither liable for damages arising out of or as a result of the use of Membrane Solutions® Water-Straw for any purpose other than for which it is clearly intended, nor for any malfunction resulting from the failure of the user of Membrane Solutions® Water-Straw to strictly abide by the use and safety information contained in this manual.

Stated microbiological and longevity performance of Membrane Solutions® Water-Straw is conducted under standard laboratory test conditions.

The effectiveness of Membrane Solutions® Water-Straw maybe be limited by environmental or hygienic conditions that could contribute to the recontamination of water after it has passed though the product's internal ultrafilter. These conditions include but are not limited to:

1. Use of the Water-Straw with dirty and bacteria-contaminated hands.
2. Backflushing with contaminated water.
3. Backflushing with mouth instead of a plastic bottle as instructed.
4. Do not backflush with excessive pressure (<22psi).
5. Not used as instructed or intended.
5. Storing the Water-Straw for extended periods of time in a warm environment while in a wet condition.
6. Exposing the Water-Straw to extreme heat or allowing it to freeze when saturated with water.

Read these use and safety instructions carefully before using Membrane Solutions® Water-Straw. The Water-Straw is a personal water filtration tool and should only be used for filtering water. The quality of the filtered water is not guaranteed if the product is submitted to conditions other than those advised for proper use.

VII. Package List

Description	Quantity
Water-Straw	1 pc
Bottle adapter	1 pc
String	1 pc
Manual	1 pc

Note:



Toll-Free: 1-866-528-4572
Website: www.mspurelife.com