

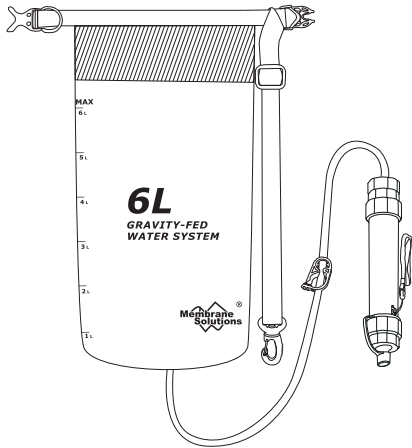

# Gravity-fed Water System User Manual



Model : M01011

Please retain the user manual for future reference

## I. Specifications

Description	Spec.
Bag Volume	6L (1.59Gallons)
Filter Capacity	5000L (1321Gallons)
Temperature Range	34-104°F (0-40°C)
Pore Size	0.1µm

## II. Diagram

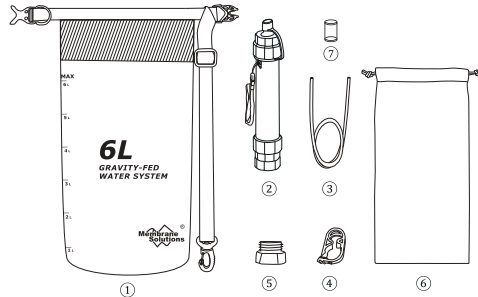

- ① Gravity Bag
- ② Water filter straw
- ③ Water hose
- ④ Shut-off clamp
- ⑤ Expansion interface
- ⑥ Storage bag
- ⑦ Silicone cover

## III. Introduction

Drinking safe water from Membrane Solutions® Gravity Water System is quick, easy and convenient. This product requires no batteries. Filters up to 5,000 liters of water over its lifetime. And can satisfy the hydration needs of groups of 3-4 people per day.

Membrane Solutions® Gravity Water System is designed to filter stored fresh water from an open body of water, like a river, stream or lake. Or, it can be used to drink directly from surface waters. Its lightweight, compact and simple design makes it perfect for hiking, traveling, and camping in areas where water may be unsafe to drink due to contamination by sediment, bacteria or parasites.





Membrane Solutions® Gravity Water System uses advanced ultrafiltration membrane technology that can remove up to 99.99999 percent of bacteria (e.g., Escherichia coli, Native klebsiella).

## IV. Operating instructions

### 1. Gravity Bag Set-up and Use

1) Fill bag with fresh water from a source free of visible suspended particles and known chemicals, oils or other pollutants.	2) Close the seal tightly and align it, and then roll the seal forward or backward one to three times, Insert the buckle tightly and finish sealing.
3) Hang the gravity water bag above the ground.	4) Insert the extension hose into the quick connection. Turn on the hose clip and fill the extension hose with water.
5) When the water flows out, connect the filter straw inlet with the extension hose outlet.	6) Then pure water will flow out of the filter straw.

## 2. Modes of Use

	
1) Draw in surface water directly through the intake of the Water-Straw.	2) Draw water from a squeezeable or rigid bottle threaded to the Water-Straw.
	
3) Compatible with most Membrane Solutions water bottles.	4) Can be used with gravity water bag to become a gravity-fed water system.

## 3. How To Clean & Store?

After use or an outing, the filter straw should be backflushed with clean water.

Remove the carbon filter and hollow fiber membrane from both ends of the straw, and rinse with clean water.

Let all parts dry before you complete the installation and place it away in storage.

Do Not wash the device with soap, bleach or other chemicals.

Store at normal temperature and humidity (0-40°C, <75%), avoid high temperature and humidity, and store at no lower than 0°C.

The storage temperature must be higher than 0°C.

It is necessary to put the silicone cover on when storing whether unused or after cleaning.

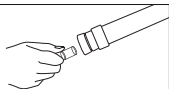

## 4. Product Service Life & Replace the Filters

After filtering 5000L water; or when flow through the filter straw has greatly diminished; or off-odors and tastes are no longer removed, it has reached its recommended service life. Suggest replacing with a new membrane solutions® filter straw element from [www.msPURElife.com](http://www.msPURElife.com).

Description	Replace Schedule
Clean Water Source	100-500 bags
Dirty Water Source	30-120 bags
UF Filter	12-18 months
GAC(UDF)Filter	6-12months

## V. Caution

To ensure long life use with relatively clean and turbid free surface water.

Never use Membrane Solutions® Gravity Water System to filter seawater or chemically or oil contaminated water, including water from mining tailing ponds or from near large agricultural operations.

Careless or unintended use may result in damaging this product. Discard this product if any of the components become cracked or damaged.

This product must not be used by children without adult supervision.

Do not drop the product in polluted water as this might contaminate the filter outlet.

Always keep the mouthpiece covered with the provided dust cap when product is not in use.

## VI. Disclaimer

Membrane Solutions® Gravity Water System is designed to filter fresh water. Logarithmic reduction of microorganism and device longevity and performance of the Gravity Water System is conducted under standard laboratory test conditions. User assumes all risk when using this Gravity Water System. Any damages caused by using or misusing are not the responsibility of the Membrane Solutions®

The effectiveness of membrane solutions® Gravity Water System may be limited by environmental or hygienic conditions, please avoid incorrect operations as below (including but not limited):

1. Use of the Gravity Water System with dirty and bacteria-contaminated hands.
2. Backflushing with contaminated water.
3. Using with salt or chemically polluted water.
4. Backflushing with excessive pressure (>15psi).
5. Not used as instructed or intended.
5. Storing the Gravity Water System for extended periods of time in a warm environment while in a wet condition.
6. Exposing the Gravity Water System to extreme heat or allowing it to freeze when saturated with water.

Read the user manual carefully before using. membrane solutions® Gravity Water System is a personal water filtration device and should only be used for filtering water. The quality of the filtered water is not guaranteed if the product is submitted to conditions other than those advised for proper use.



Toll-Free: 1-866-528-4572  
Website: [www.msPURElife.com](http://www.msPURElife.com)