

Advanced G-Profile extrusion

ASSEMBLY AND USER GUIDE

# Table of Contents

Disclaimer .....	3
Required Tools .....	1
Content of package .....	2
Assembly guide .....	3
User Guide .....	4

# Disclaimer

This assembly guide shall be considered as such: a guide. The steps, methods and measurements are suggestions from our assembly experience and are in no way shape or form absolute.

The dimensions shown throughout the guides are reference dimensions. They are subject to be revised without notice and can be altered for preferred position of your peripherals.

If you consider doing a step differently, feel free to try a different method that works for you! On the other hand, any damage caused during assembly is solely your responsibility.

Take your time, loosen some screws if it doesn't fit, or ask our support team for help before throwing an allen key to the other side of the room. You got this!



# Required Tools

4mm Allen key



For questions, issues or comments, feel free to reach our support team!

<https://www.advancedsimracing.com/pages/advanced-help-center>

# Content of package

## Boxes

1X G-Profile bundle

---

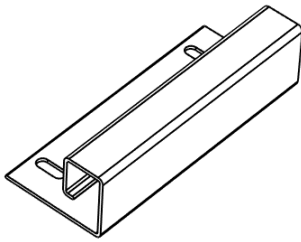

6" G-Profile - 2X

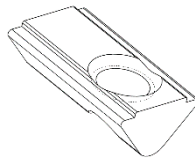

M6 T-Nuts - 4X

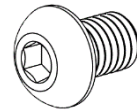

M6 X 12 button  
head screw - 4X

**\*OR\***

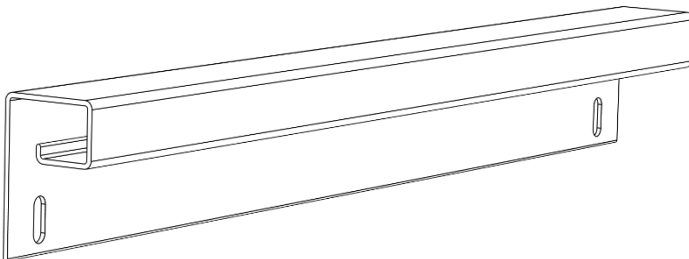

18" G-Profile - 1X

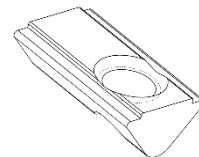

M6 T-Nuts - 2X

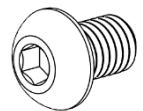

M6 X 12 button  
head screw - 2X

# Assembly guide

1. Locate where you wish to install your G-Profile, and place 2 M6 t-nuts through the channel closest to the face you want to place your profile. For example, here, I'm placing it to be in front of the wheel deck. Use the tip at the "T-nut install tip" page at the end of the guide to give you a hand!

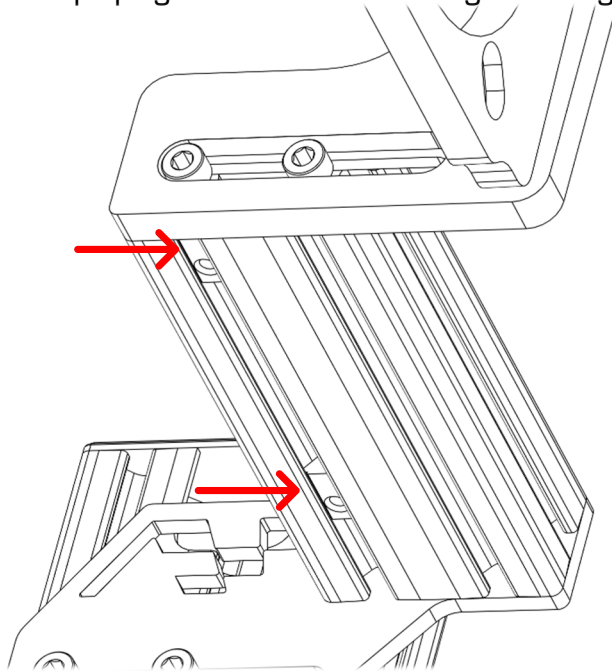

2. Screw in your G-Profile using 2X M6 x 12 screws. Don't tighten yet, back off 1/4 of a turn when it starts to get tight. Time for cable routing!

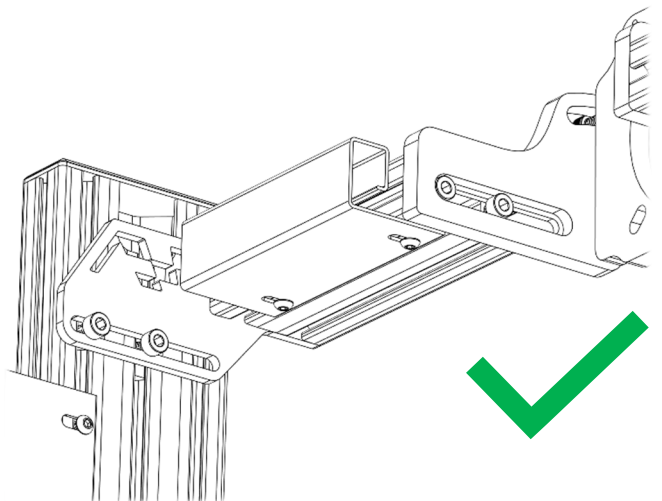
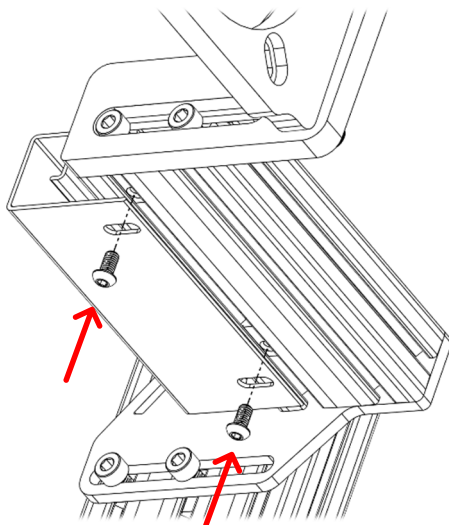

# User Guide

Your G-Profile is not only designed to be aesthetically pleasing, but easy to use as well. I'm using a 6" G-Profile on our front mount wheel deck for illustration purposes. Install is the same whether you've got the 18" or 6".

To place your cables, pull the profile to reveal a 0.5" gap, and place your cables in (don't fish them through from one side to the other, simply push the whole length through the gap then up and around until it's at the center of the profile)

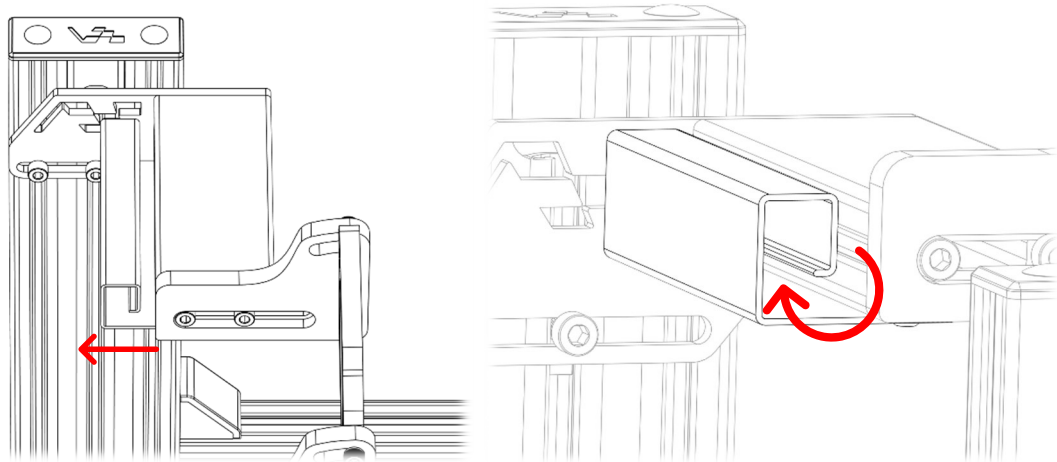

When you've put all your desired cables through, push the G-Profile flush to the extrusion and tighten the 2X M6 x 12 screws. Tighten moderately, it isn't structural!

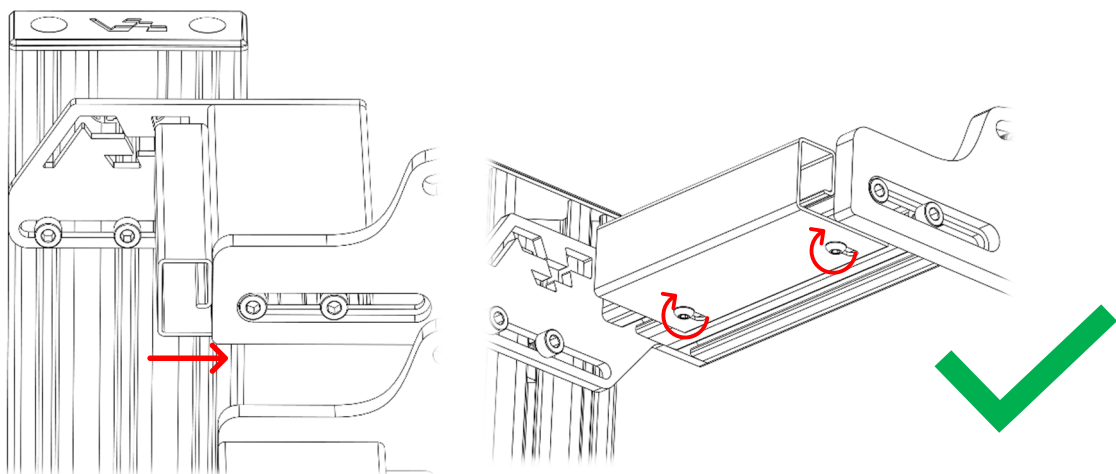



*Congratulations on your superb cable management using our  
G-Profiles!*



### *T-Nut install tip*

Insert an M8 T-Nut in the desired slot of the extrusion. Insert the T nut perpendicular, and with the help of a small allen key in your attire such as a 3mm, pry the T nut straight with the allen key through the hole. The t-nut will snap into place when in position. This technique is used throughout our assembly methods and may be used for supplementary accessory installation

