

In Your Bags
you will find:

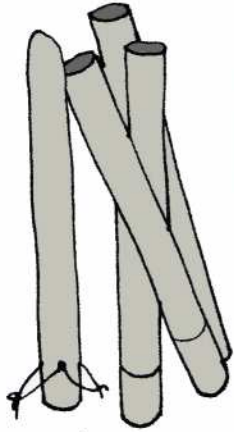

1x Aluminium centre pole in 4 sections.



3x wooden peak poles in 3 sections each.



1x mallet



3x Banana bags

1x repair pack

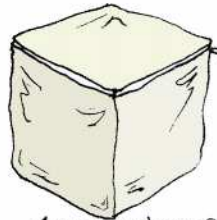

1x polyester roof cover



21x metal wall poles

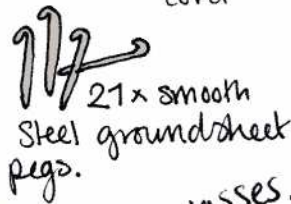

21x smooth steel groundsheet pegs.



1x 540mm PVC groundsheet

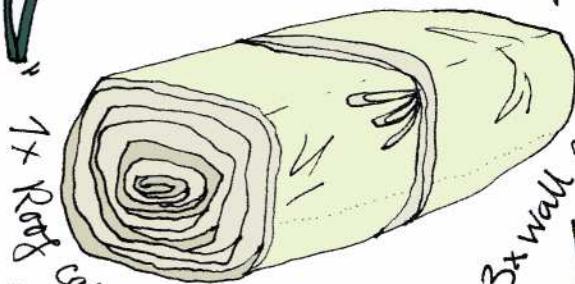

1x Roof canvas.

3x wall panel canvasses....



2x wall panels for the sides/rear

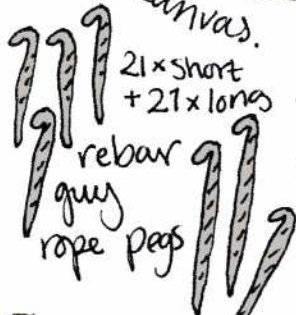

21x short + 21x long rebar guy rope pegs

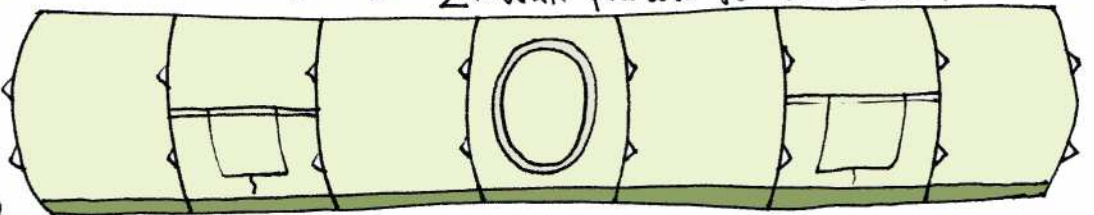

1x front wall panel with extra zippers



guy ropes x 63



Ingredients for buying a beautiful Lotus Maral

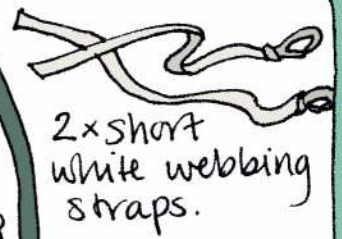

2x short white webbing straps.



1x large wooden pole coaster



3x small wooden pole coasters

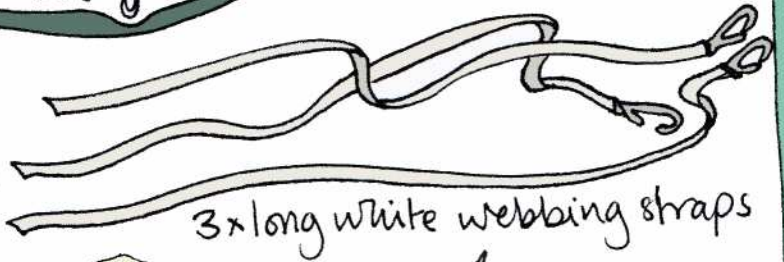

3x long white webbing straps

How to pitch your tent

1. Spread out your groundsheet with the black elastic loops



2. Lay your wall canvas panels rope-side up on your groundsheet...



3. Zip the panels together. + do up velcro tabs.

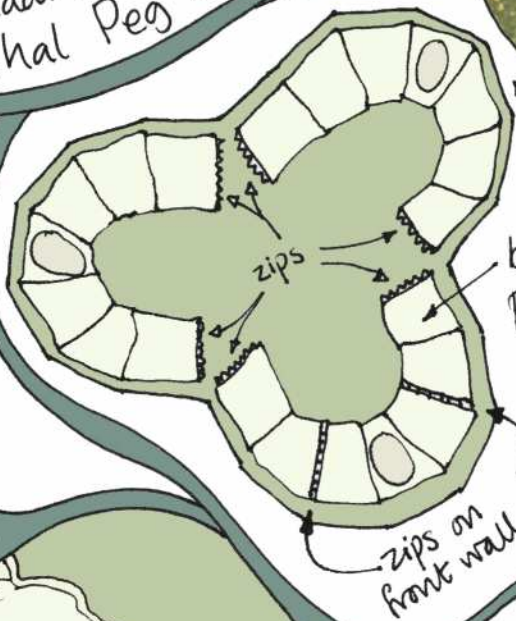

the doors should be pointing to the outer most points.
be sure to locate the wall panel with the extra zips at the side where you want the front entrance of your tent to be.

4. Hook the webbing loops at the base of your wall panels on to the groundsheet pegs. Then push the groundsheet pegs down fully.



5. At the top of the zips which connect the wall panels together, you will find a metal cleat; thread the

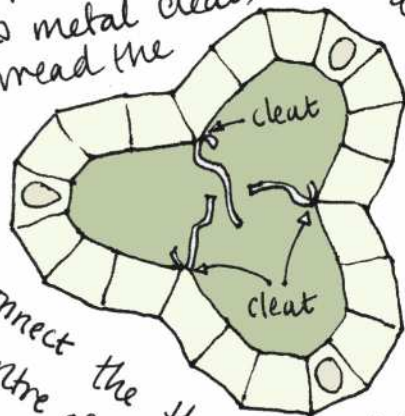

Then connect the three straps together in the centre of your tent by clipping them to each other, like this



6. Pull the webbing straps through the cleats until the stitched stopper prevents it from going further

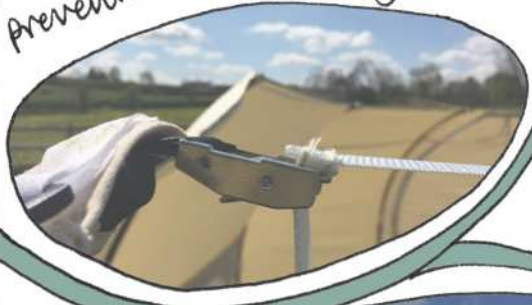

7. Pull the walls up with the hook both guy ropes on to the inner row of thick pegs. Attach loosely at first, then go around tightening all the ropes equally. When finished, your walls should be taught & free of creases, and the webbing straps should be tight + horizontal, like this



8. Carry the Roof inside the tent & spread it out. Check that the Logo is located above the doorway. NB: This part requires 2 people ideally as the roof is heavy!



9. Temporarily unclip the webbing straps. Throw the tentacles from the roof canvas over the wall...



and attach the guy ropes from the roof on to the outer row of pegs. *NOTE: Sometimes it is easier to attach them to the inner row first, then move them to the outer row later.

See notes to add roof cover now

10. Connect your central metal pole and 3 wooden poles together:

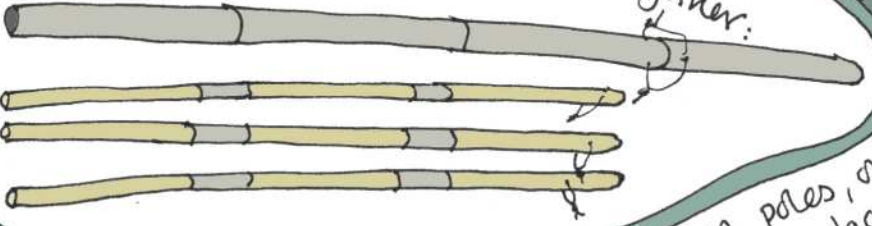

Walk in with your wooden poles, one at a time and stand them upright in the three outer peaks, place pole coaster under each pole. * Don't worry if they are wobbly or loose at this point.

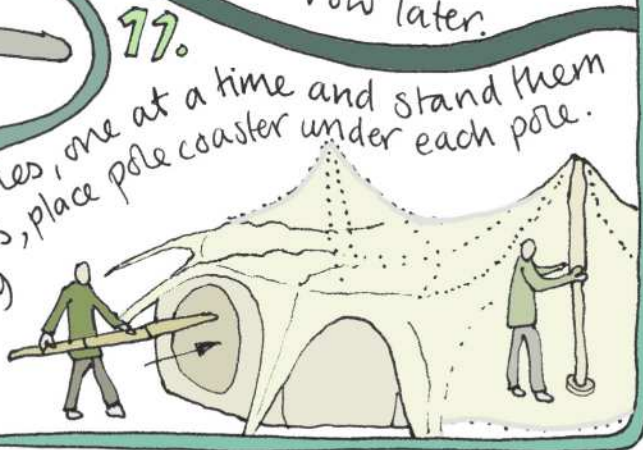

11.

12. Pull the 3x long webbing straps back through their cleats to the maximum length:



14. Stand the Metal centre pole upright in the middle of the tent, placing the base on the large wooden coaster.

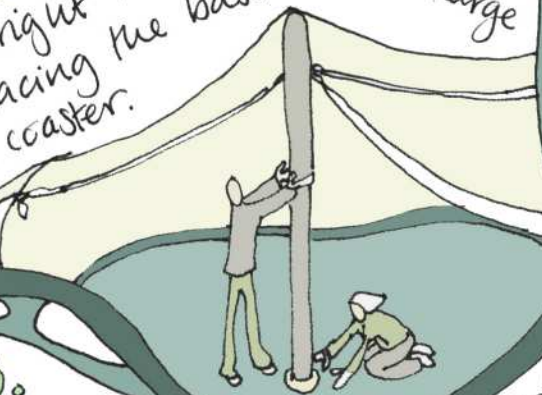

13. Clip the metal clips on the webbing straps onto the string loops

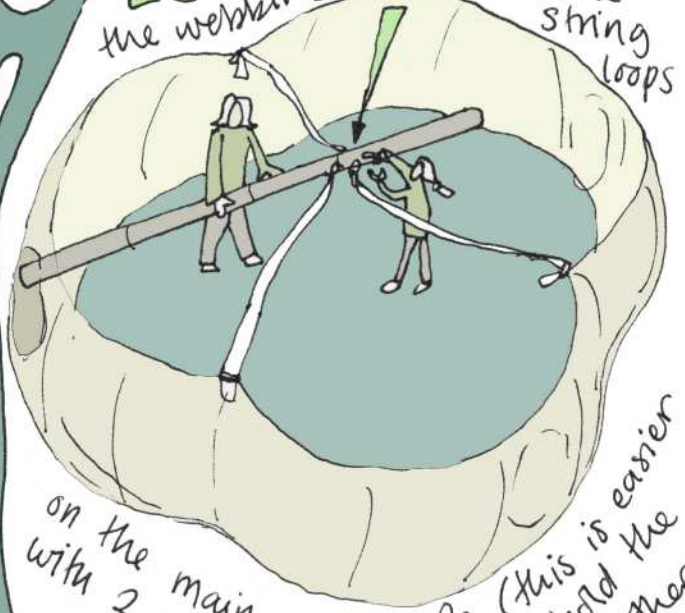

on the main centre pole (this is easier with 2 people, one person can hold the pole at an angle whilst the other person attaches the clips).

15.

Tighten the webbing straps until the tops of your walls are sitting comfortably underneath the roof canvas.

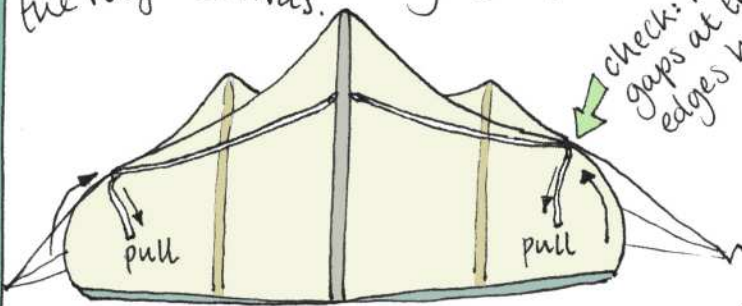

16.

Tighten all the guy ropes until the walls and roof are taught and free of creases

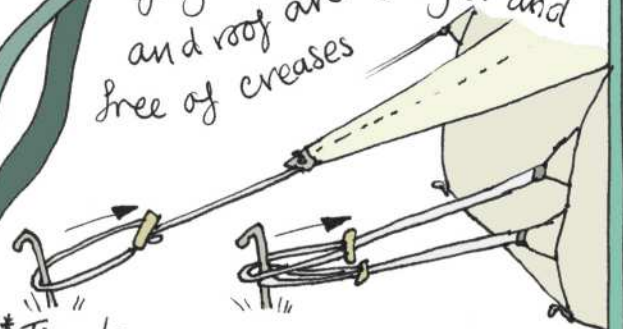

*Tip: If you have sections with large diagonal creases, this may be caused by uneven ground and can often be remedied by digging out a little earth to lower, or placing a flat stone under the pole to increase height.

17.

Go inside the tent and hook the groundsheet up onto the canvas loops inside the wall by the base of each pole.



NOTE

If you are using your tent long-term, or if heavy rain is forecast then we recommend using the polyester roof cover provided. To put this on your tent, simply pull the cover over your tent after Step 9, attach to the same posts as the roof.

Mahal Peg Map:

Key:

wood pole + mallet = A

2 x mallet = B

1.5 mallets = C

1 mallet = D

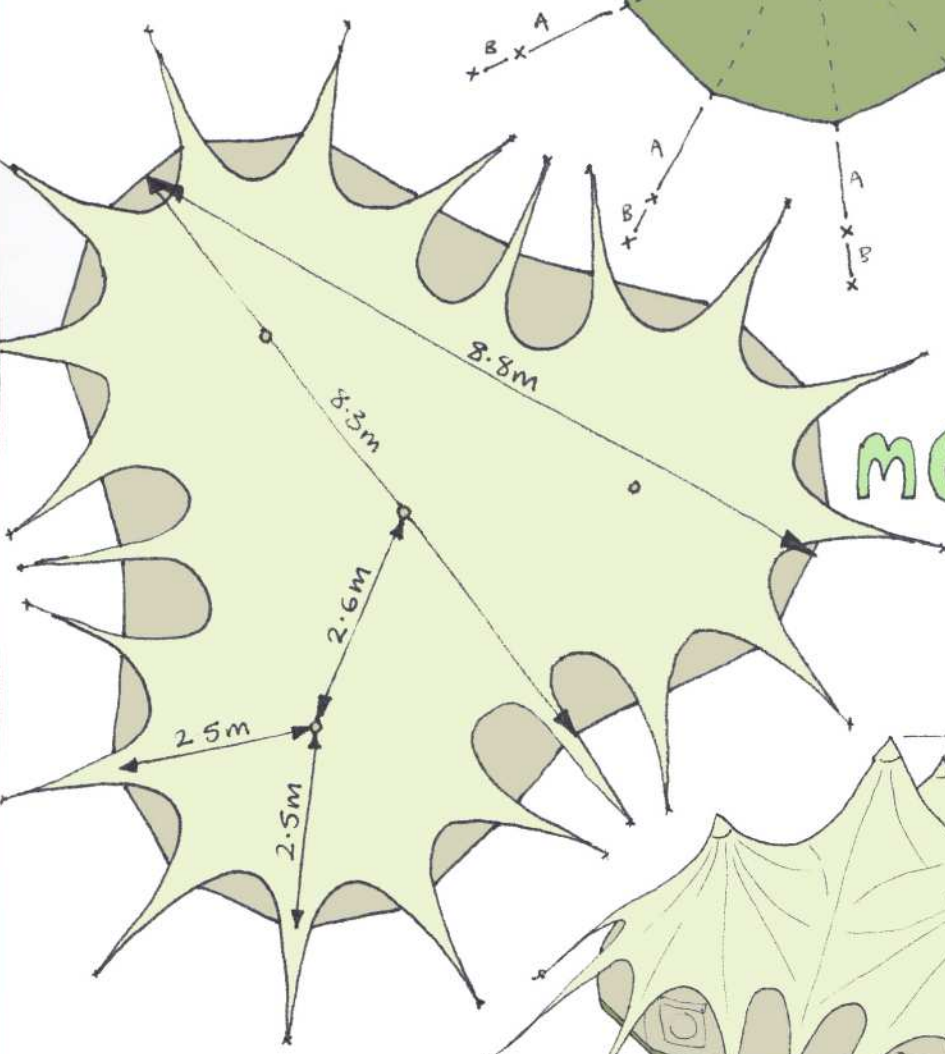
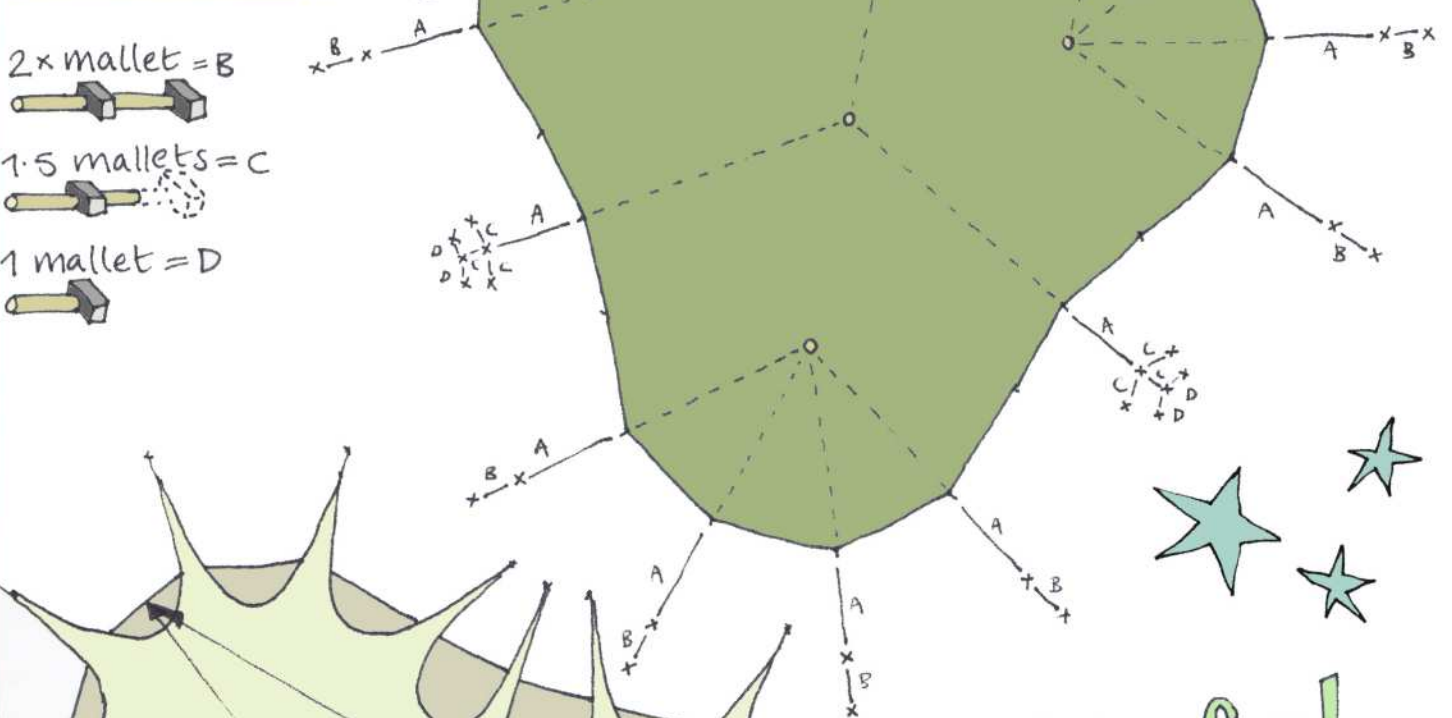

Useful measurements

