



Violin Mount Installation and Cabinet Hanging Instructions

How To Videos available at www.youtube.com/sfdisplay

PARTS:

- 1 violin hanger w/ 2 sets of T-nuts & screws
- 1 bow hook
- 1 packet mounting hardware and keys



Step 1: Test fit hanger with violin and bow in place to find the most ideal location to mount in cabinet.

Step 2: Mark the 2 holes for drilling. Use a 3/16" drill bit and create 2 holes for attaching the T-nuts. If you don't have a drill, you can use a screw that is a bit bigger than 3/16" to help make the hole. The center of the T-nut will need to be able to go inside from the back.

Step 3: From the back of the case, insert the T-Nuts with the prongs-side facing into the 2 holes as shown in the 1st photo below. Push the T-nut into the back panel as much as you can.

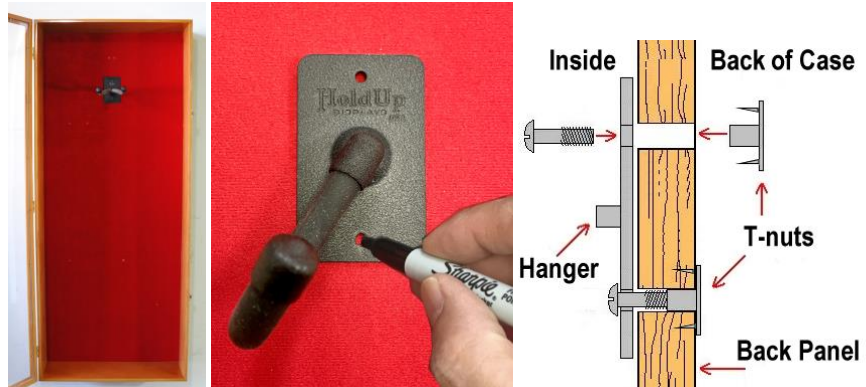

Step 4: Position the hanger plate from the inside to align with the 2 holes/T-nuts. Use the 2 black screws to attach hanger as shown in 2nd photo. You will need to screw very tightly, as this will force the T-nut prongs to press into the back panel. A power screwdriver is best for this. The attached hanger should look like the 2nd photo from front, the 3rd photo from the back.



Step 5: If you are displaying a bow, test the position of the bow, either to the left or right of the violin. Push and screw in the bow hook to mount.

Step 6: Install the left and right Tear-Drop brackets to the top corners to the back of the cabinet with the provided small brass screws, see 4th photo below. There are pre-drilled holes to match the brackets. With a measuring tool, measure the distance between the 2 holes of the left and right Tear-Drop brackets. After locating where you will be displaying the cabinet, measure out the same recorded distance onto the wall. It is important that your measurement is accurate as this will make the attachment easier later. Into the wall, install the 2 large black screws. Use the 2 plastic hollow wall anchors if your wall material requires.

Step 7: To hang the cabinet on the wall, simply position the cabinet over the top 2 screws and align with the holes of the Tear-Drop brackets. Slide down the case and have it rest on the brackets. Now you are ready to use the cabinet to display your items, test fit the hanger with item again and adjust the hangers if need.

