



The World's Only Self-Flushing, Self-Washing Cat Box™

YOUR GUIDE to SETTING UP the CATGENIE 120



WELCOME TO CATGENIE!

Congratulations and thank you for joining our CatGenie community, a community of happier cat lovers who live litter-free in their cleaner, odor-free homes (some owners since 2006!)

Your wise CatGenie purchase is, for your cat, a clean, comfy cat box. For you, it's an appliance that washes, sanitizes, and dries its Granules. Then, like a toilet, flushes the "smellies" out of your home and into the sewer/septic system – where waste belongs.

Now, to get your CatGenie installed and ready to work, start with this Set Up Manual. The Operation Manual has all the details on operating your CatGenie 120. While most cats easily adjust, to help ensure a smooth transition, consult the Cat Acclimation Manual for some vital tips for introducing your cats to their new "digs."

Please know that we are here for you if you have questions or issues. Located in Pennsylvania, our Customer Support Team is available Monday thru Friday 9am-10pm and weekends 10am-7pm EST*. **Call us at 1-888-735-3927 or email us at support@catgenie.com.**

WELCOME!

**Please consult website for any schedule changes or updates.*

WHERE SHOULD YOUR CATGENIE GO?



THE BEST LOCATION FOR YOUR CATGENIE is a Laundry/Utility Room OR a Bathroom.

Because your CatGenie needs:

- 1) Fresh water from a cold water supply line that connects to a washing machine, sink, or toilet
- 2) A laundry drain pipe or toilet for cat waste removal
- 3) An electrical outlet

MEASURE THE AREA

Before you unpack your CatGenie, measure the space where you want to place your CatGenie to make sure that your CatGenie fits. The CatGenie Water Supply Hose is 8 feet long, and the CatGenie Drain Hose is 10 feet long.

STOP & THINK BEFORE MOVING YOUR LITTER BOX

Reference your Cat Acclimation guide for full instructions and recommendations. You may need to move your old litter box to the CatGenie location, but it is important to reference the Cat Acclimation guide first to see what works best for you and your cat.



UNPACK AND CHECK

UNPACK CAUTIOUSLY. Do not drop. If you suspect that your CatGenie is damaged, do not use it. Contact CatGenie Support at 1-888-735-3927. Save original packaging and receipt for at least 90 days in case you need to return your CatGenie. See the Operation Manual for complete details.



PACKAGE CONTENTS:

- 1) Operation Manual
- 2) Cat Acclimation Manual
- 3) Set Up Manual
- 4) Processing Unit, Water Supply Hose, and Power Cord
- 5) CatGenie Base, Brim, Bowl, Hopper
- 6) Drain Hose and Drain Hook
- 7) GenieHand
- 8) Laundry Room T-Adapter/Bathroom T-Adapter
- 9) Hopper Cover
- 10) Box of Washable Granules
- 11) Cartridge of SaniSolution
- 12) Spare Parts Kit (located under the Base)

NOTE: The CatGenie has many unique parts that make it the smart and revolutionary cat box that it is. For a list of complete parts and their functions, see the Operation Manual.

90-DAY, MONEY-BACK GUARANTEE

With our 90-Day, Money-Back Guarantee, you and your cats have a total of 90 days from your purchase date to fall in love with your CatGenie.

TWO-YEAR WARRANTY

Before assembling, write down your serial number located on the back of the Processing Unit. Fill in on the line below and also in your Operation Manual, for easy reference.

Your Serial Number is: _____

ASSEMBLE FOUR EASY PIECES



1. Unpack Base, Processing Unit, Hopper Cover, GenieHand, the T-Adapters, and all Manuals. The install location must have a water source, a drain, and an electrical outlet.

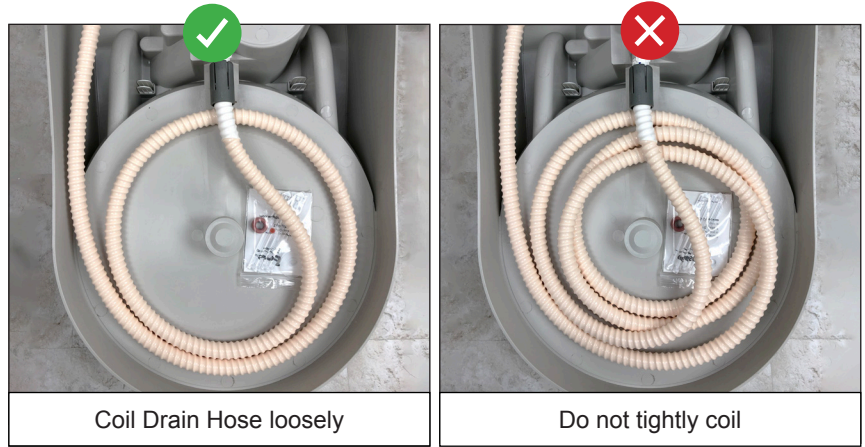

2. Flip the Base to access the 10' Drain Hose. Be careful with the GenieArm when removing packing material. Leave Spare Parts Kit secured under Base. **Note:** Coil Hose under base as shown. Do not tightly coil the hose as that could prevent proper draining. Thread Drain Hose through groove cut into back of Base. Bring the Drain Hose end to the waste drain or toilet. If you have excess hose, make another loose coil under the CatGenie Base.



3. To run properly, your CatGenie must be level in its final location. Use shims to level it, especially side to side.

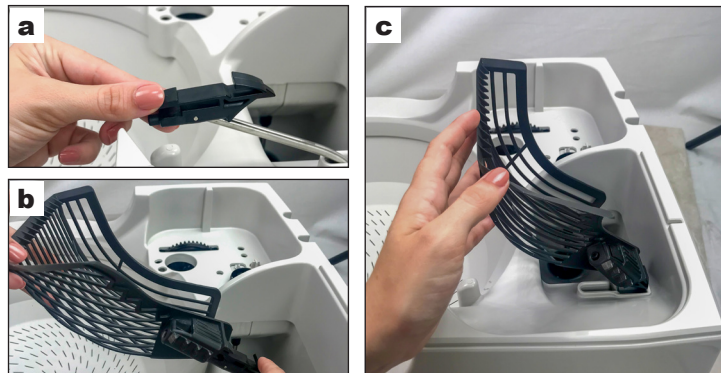

4. **a.** Pull the Black Clip and GenieArm out of the slot. **b.** Attach the GenieHand to the Black Clip. A click means it's connected. **c.** Push Arm and Hand back to upright position.

CAUTION: The GenieHand is locked in place by the Processing Unit. Do NOT force the Hand into position. Remove Processing Unit to move it.



5. Line up Processing Unit over its slot, then carefully and securely slip the Unit into it.



6. Fit the Hopper Cover into grooves on right side of the Processing Unit. Slide it down to fit into Brim slot. The CatGenie logo faces front.



7. Fit the Water Hose and Electric Cord in back of Unit into grooves behind the Base. **Hand-tighten Water Hose nut. Do NOT use tools.**

LAUNDRY/UTILITY ROOM SET UP

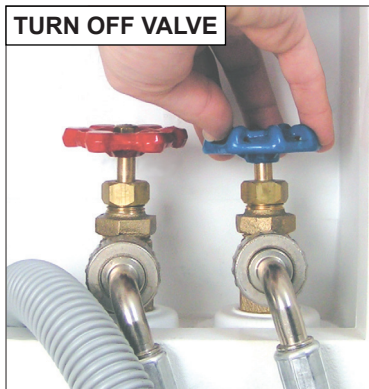

TURN OFF VALVE

1. Have a towel handy. Shut off COLD water supply line to Washer.

TIP: Cold water line may have a blue valve, be labeled, or feels cold.

WARNING: ONLY use COLD water line. Hot water damages CatGenie.

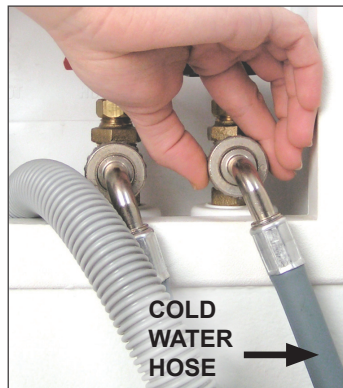

2. Unscrew **COLD** water hose from the shut-off valve. Loosen connection and finish disconnecting hose by hand. Hold hose upright so water won't leak out.

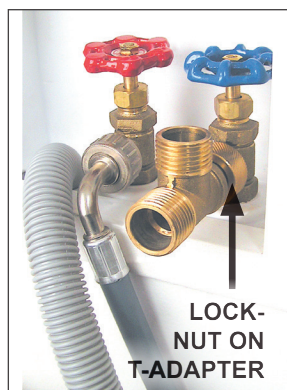

3. Screw Lock-Nut on the T-Adapter to the water shut-off valve.



The large T-Adapter **MUST** have its Black Washer in place



4. Attach washer water hose to the T-Adapter. Make sure hose's lock-nut is movable. Tighten lock nut around T-Adapter threads **by hand**.

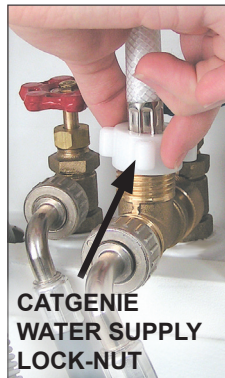

5. Screw the CatGenie Water Hose on to the T-Adapter.

CAUTION: Do NOT use pliers to tighten the CatGenie Lock-Nut. Hand tighten only.

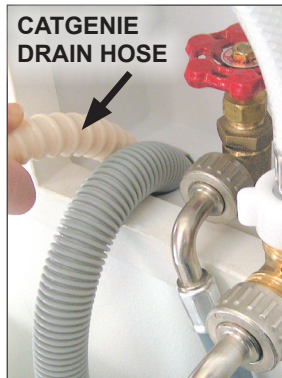

6. Insert CatGenie Drain Hose securely into the Washing Machine waste pipe opening.

CAUTION: Do NOT force GenieHose into waste pipe. See below for info on fitting drain hoses into pipe. If hoses don't fit, call Customer Support at 1-888-735-3927.



FINISHED SET UP

10. When set up is finished, put a towel under the water connection. **Turn the water ON.** If the water is leaking at any connection, turn the water off and re-tighten.

LAUNDRY SETUP TIPS AND CAUTIONS

• Before adding the CatGenie Drain Hose, check that the Washer's drain hose does not exceed the correct 5" length inside the waste pipe.

CAUTION: Put NO more than 5 inches of your Washer's drain hose into the waste pipe. A hose that goes in too far can cause backflow, which could result in flooding.

• A laundry waste pipe opening that's higher than 4' above the floor may slow the draining process (a rare occurrence). See Operation Manual page 9.

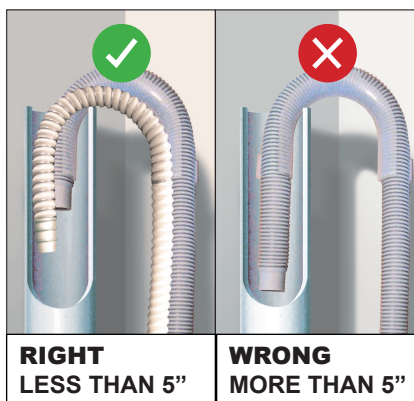

RIGHT LESS THAN 5"

WRONG MORE THAN 5"

• If your CatGenie Drain Hose runs into a floor drain, you must have a portion of the hose at least 1' above the bottom of the CatGenie. Just a short run is needed. See Operation Guide for pictures, page 9.

• If you have low water pressure, it is best **NOT** to run your washing machine and the CatGenie at the same time.

CAUTION: Do NOT use the Drain Hook with a laundry setup.

BATHROOM SET UP



1. Access the cold water line to a toilet or sink.

WARNING: ONLY use COLD water line. Hot water damages CatGenie. Fresh water to a toilet is cold.

NOTE: If either sink or toilet water line is a rigid pipe, measure the pipe and replace with a flexible water pipe available at any hardware store. To replace, turn off water. Remove the rigid pipe and replace with a flex pipe.

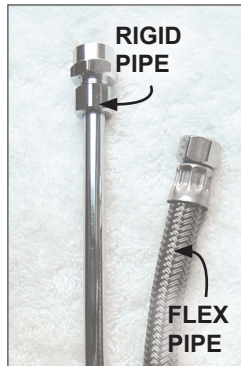

2. Shut the **COLD** water off by turning the valve on the toilet or sink water supply line.



3. For toilet, check that water is off by flushing the toilet to empty the tank.

WARNING: If the toilet tank refills after shut-off valve is OFF, the valve needs to be replaced.

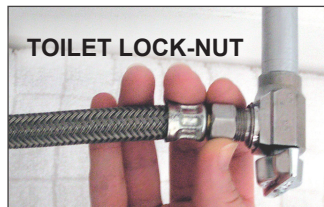

4. Unscrew the water line flex pipe at the valve. You may need a tool to loosen the lock-nut connection. Keep a towel handy to catch any drips.



5. Connect and **HAND TIGHTEN** the small T-Adapter Lock-Nut to the water shut-off valve.

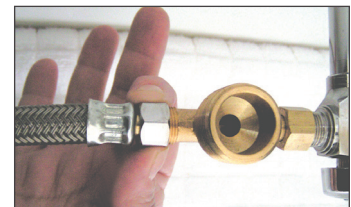

6. Connect the flex pipe to the T-Adapter and hand tighten the pipe's lock-nut.



7. Connect the CatGenie Water Hose to the T-Adapter and **HAND TIGHTEN** its Lock-Nut.

Do NOT use a tool on the CatGenie plastic Lock-Nut. HAND TIGHTEN ONLY.

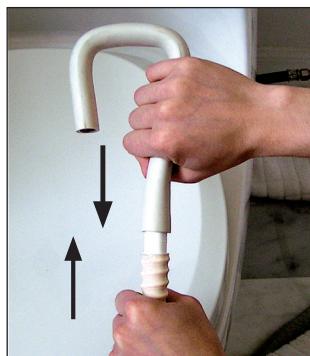

8. Add the Hook to the Drain Hose only if draining into a toilet. Push the Drain Hose and Hook tightly together until the white Tip at the end of the Hose is covered by the Hook.



9. Place Drain Hook over the toilet bowl and lower the toilet seat. Check that seat has "feet" so Hook is not squeezed when toilet seat is down.

NOTE: If water pressure is low, don't flush toilet or run appliances during a CatGenie Cycle.

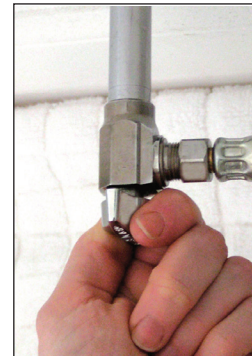

10. When set up is finished, put a towel under the water connection. **Turn the water ON.** If the water is leaking at any connection, turn the water off and re-tighten.

RUNNING YOUR CATGENIE



1. Complete water in and waste out set up, as directed on previous pages.



2. Empty entire Washable Granules Box into the Bowl. Box fills to level indented inside the Bowl. Spread Granules out evenly. Only use CatGenie Washable Granules.

WARNING: DO NOT use or mix cat litter in the CatGenie. Litter causes severe damage to the CatGenie and voids your Warranty.



3. Insert SaniSolution Cartridge into the slot on top of the Unit. Notch points to back.

NOTE: Your CatGenie cannot function with an empty Cartridge. Always have an extra Cartridge on hand.

TIP: In Cat Activation mode, the Cartridge is good for 240 washes. On other settings, it is good for 120 washes.

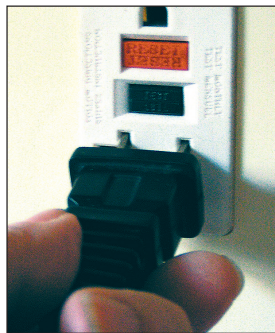
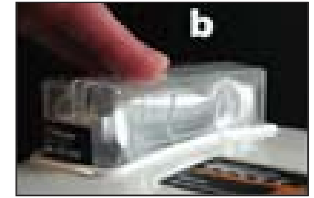

4. Plug the CatGenie electric cord into a GFCI certified wall outlet. GFCIs are required by code for baths, laundry rooms and wet areas.

WARNING: Do NOT use an extension cord with your CatGenie. This can be hazardous.

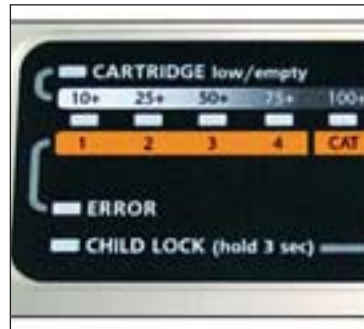

5. When plugged in, a series of beeps sounds and all LEDs light up in a sequence. This means CatGenie is working correctly.

NOTE: If none of the LEDs light, check if the Processing Unit is securely in place. Lift it up and replace it into its slot. Check the electric connection. If still not lighting, call Customer Support at 1-888-735-3927.



6. Press Start to run a Cleaning Cycle to see if your setup is correct and to observe the Unit's operation.

IMPORTANT: MAKE SURE YOUR CATS ARE NOT NEARBY WHEN YOU FIRST RUN THE CATGENIE.

If something does not run properly, or your CatGenie is giving you an alert, troubleshoot using the Operation Manual, pages 20-21. If that does not work, Call Customer Support at 1-888-735-3927.

WHAT TO EXPECT DURING CLEANING:

1. Scoop Cycle: GenieHand scoops 3 times to remove solids.

NOTE: Ridges on the GenieHand purposely rub against a post on the Brim so that excess Granules get shaken back into the Bowl. The clicking sound it makes is normal.

2. Wash Cycle: After scooping, water and SaniSolution flow in to cover Washable Granules. SaniSolution, Water, and GenieHand scrubs Granules and Bowl. GenieHand moves to agitate Granules. Solids get liquefied inside the Hopper. Water and waste drains out. Interior is rinsed clean.

3. Dry Cycle: Air dryer blows warm air as GenieHand sifts through Granules for thorough drying.

Total cycle time: ~38 minutes

NEED HELP?

USE THESE RESOURCES:

ACCLIMATION MANUAL

Included with your CatGenie unit, the Acclimation Manual contains detailed processes for helping your cat transition from their current litter to successfully using their CatGenie.

OPERATION MANUAL

Included with your CatGenie unit, the Operation Manual contains essentially everything you need to get started, program, and troubleshoot your CatGenie.

ONLINE VIDEOS

Go to youtube.com/CatGenieCatBox for visuals on how to set up, clean, program, troubleshoot, and more.

CUSTOMER SUPPORT

If none of the above helps, call CatGenie Customer Support at 1-888-735-3927 or email at support@catgenie.com. Our Customer Support Team is available M-F 9am-10pm EST and weekends 10am-7pm.*

*Please consult website for any schedule changes or updates