

Technical data sheet for

E35D6-26 ON THE SK35 STAND

Full Size Digital / Electric Convection Oven
on a Stainless Steel Stand



E35D6-26

Unit shall be a Moffat electrically heated Turbofan convection oven E.T.L. listed and NSF-4 listed. The oven shall have a one piece porcelain enameled oven chamber, stainless top and sides and safe touch vented easy clean side hinged door that offers field reversible hinging. Oven shall have capacity for 6 full size sheet pans. The oven shall be controlled by an electronic control having separate digital displays and adjusting knobs for time and temperature functions. The oven control shall allow both manual and programmed operating modes with programmable steam level injection and 2 speed oven fan. A core temperature probe M236060 is optional. The unit shall include dual halogen oven lamps. Oven shall be able to be bench mounted on 3" / 76mm feet or mounted on oven stand model SK35. Unit shall be supplied in 100% recyclable shipping packaging.

SK35

Unit shall be a Moffat Turbofan stainless steel oven stand NSF-4 listed. The stand shall be constructed from stainless steel tube with castors, with front castors having dual swivel and wheel locks. It shall be fitted with 6 tray runners suitable for up to 12 half size sheet pans or 6 full size sheet pans. The stand shall be fully compatible with, and support, Turbofan Convection Oven models E35D6 and E35T6. Unit shall be supplied in 100% recyclable shipping packaging.

STANDARD FEATURES

- 6 full size sheet pan capacity
- 4 $\frac{1}{8}$ " / 105mm tray spacing
- 35 $\frac{7}{8}$ " / 910mm width
- Digital display Time and Temperature Controls
- Large easy view $\frac{3}{4}$ " / 20mm high displays
- Electronic thermostat control
- Electronic timer with countdown or time count modes
- Manual mode and Program mode
- 30 programs with 3 stage cooking and stage end alarms
- Core Probe program cooking (optional Core Probe Kit)
- Steam injection mode (5 levels) and manual injection
- 2 speed bi-directional reversing fan system
- 12kW heating (220-240V) / 10.7kW heating (208V)
- Oven vent - Program and manual control
- Safe-Touch vented side hinged door (standard LH hinge). Optional RH hinge (field convertible)
- Slam-shut / Pendulum door latch
- Porcelain enameled oven chamber
- Plug-in continuous oven door seal
- Dual halogen oven lamps
- Anti-skid 2" / 50mm dia. 3" / 76mm high adjustable stainless steel feet
- 6 oven wire racks supplied
- 100% recyclable packaging

OPTIONS

- Single Phase model oven (specify when ordering)

ACCESSORIES

- Optional M236060 Core Temperature Probe Kit
- Turbofan SK35 Oven Stand
- DSK35-26 Double Stacking Kit with adjustable feet
- DSK35C-26 Double Stacking Kit with castors

E35D6-26 Full Size Digital / Electric Convection Oven - 2 speed fan on a Stainless Steel Stand

CONSTRUCTION

Porcelain enameled fully welded oven chamber
Stainless steel front, sides and top exterior
Stainless steel oven fan baffle and oven vent
Removable 6 position stainless steel side racks
Oven racks chrome plated wire (6 supplied)
Stainless steel frame side hinged door
0.2" / 5mm thick door outer glass
0.2" / 5mm thick low energy loss door inner glass
Full stainless steel welded door handle
Stainless steel control panel
Aluminized coated steel base and rear panels

CONTROLS

Electronic controls with Digital Time and Temperature display, Manual or Program modes
Large ¾" / 20mm high LED displays
Two individual time and temperature setting control knobs
6 function keys
Fan LO speed key
Timer Start/Stop key
Steam injection key (5 levels)
Programs select key
Actual temperature display key
Vent open / close key
Adjustable buzzer/alarm volume
Thermostat range 150-500°F / 50-260°C
Timer range from 180 minutes in countdown mode
Timer range up to 999 minutes in time count mode for holding, slow cooking
Over-temperature safety cut-out

CLEANING

Stainless steel top and side exterior panels
Porcelain enameled oven chamber
Fully removable stainless steel oven side racks
Removable stainless steel oven fan baffle
Easy clean door system with hinge out door outer glass
Removable plug-in oven door seal (no tools required)
3" / 76mm high stainless steel feet for easy access underside

SPECIFICATIONS

Electrical Requirements
208V, 60Hz, 1-phase, 11.2kW, 54A
208V, 60Hz, 3-phase, 11.2kW, 31A / ph
220-240V, 60Hz, 1-phase, 12.5kW, 52A
220-240V, 60Hz, 3-phase, 12.5kW, 30A / ph
No cordset supplied

Water Requirements (optional)

Cold water connection ¾" GHT male
80psi maximum inlet pressure / 20psi minimum inlet pressure

External Dimensions

Width 35 7/8" / 910mm
Height 34 1/4" / 871mm including 3" / 76mm feet
Depth 36 7/8" / 923mm

Oven Internal Dimensions

Width 18 1/4" / 465mm
Height 28" / 710mm
Depth 27 1/2" / 700mm
Volume 8ft³ / 0.23m³

Oven Rack Dimensions

Width 18" / 460mm
Depth 26" / 660mm

Nett Weight (E35D6-26)

302lbs / 137kg

Packing Data (E35D6-26)

359lbs / 163kg
37.7ft³ / 1.07m³
Width 37 7/8" / 950mm
Height 37 1/2" / 960mm
Depth 46" / 1170mm

SK35 Stainless Steel Stand

All stainless steel welded frame oven stand for Turbofan E35D, E35T Series ovens
6 position tray runners standard
3" / 76mm diameter wheel swivel castors standard with 2 front castors with dual swivel and wheel
Welded 1 1/2" and 1 1/4" square tube front and rear frames
Welded rack supports/side frames
4 dia. 3" / 76mm swivel castors with 2 front castors dual wheel and swivel lock
Top frame oven supports suit Turbofan E35D, E35T Series oven mounting
Supplied CKD for assembly on site

External Dimensions (SK35 Oven Stand)

Width 35 7/8" / 910mm
Height 34 5/8" / 880mm
Depth 30 3/8" / 770mm

Nett Weight (SK35 Oven Stand)

54lbs / 24kg

Packing Data (SK35 Oven Stand)

59lbs / 27kg
4.4ft³ / 0.13m³
Width 37 5/8" / 960mm
Height 32" / 815mm
Depth 6 1/8" / 160mm

INSTALLATION CLEARANCES

Rear 2" / 50mm
LH Side 2" / 50mm
RH Side* 2" / 50mm

* For fixed installations a minimum of 20" / 500mm is required for service

CLEARANCE FROM SOURCES OF HEAT

A minimum distance of 12" / 300mm from the appliance sides is required



www.blue-seal.ca
www.turbofanoven.com
www.servecanada.com

CANADA

Serve Canada
40 East Pearce Street
Richmond Hill ON
L4B 1B7
Ph Toll Free 800-263-1455
Fax 905-731-7687
Email info@servecanada.com

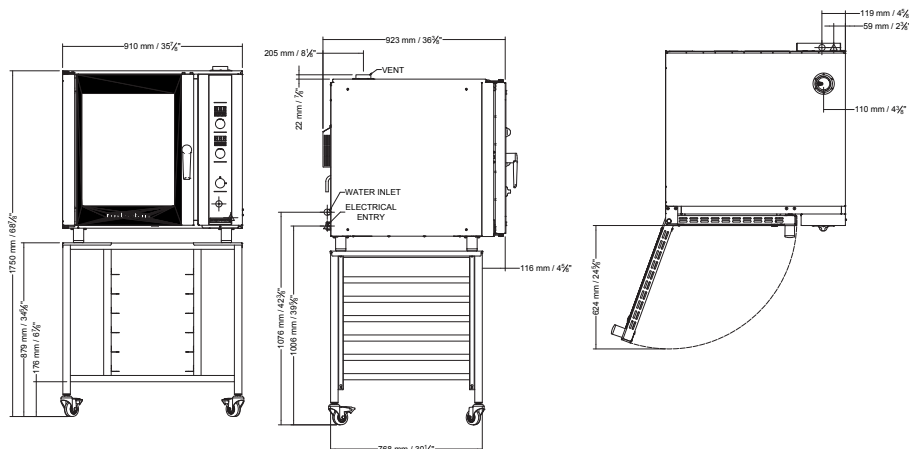

Manufactured by:
Moffat Limited
45 Illinois Drive, Izone Business Hub
Rolleston 7675, New Zealand



ISO9001
Quality
Management
Standard

Designed and manufactured by



ISO9001

All Turbofan products are designed and manufactured by Moffat using the internationally recognised ISO9001 quality management system, covering design, manufacture and final inspection, ensuring consistent high quality at all times.

In line with policy to continually develop and improve its products, Moffat Limited reserves the right to change specifications and design without notice.



© Copyright Moffat Ltd
CA.TFN.S.1601