



P225

THERMAL LABEL PRINTER

- Compatible with DETECTO's D series price computing scales via an RS232 cable
- Label rolls are quick and easy to install for fast reloading
- Compact footprint
- microSD Flash memory up to 4 GB
- Connectivity is simple via RS232 serial port
- Print width of 2 inches
- Label rolls available from DETECTO (part no. 7100-0026)
- Stores fonts and graphics for printing logos and graphics through printer software
- Wall mountable
- Common applications include: retail point-of-sale, shelf labeling, product marking, healthcare patient tracking, shipping, and receipt printing

Space-saving, high-quality printer compatible with DETECTO D series price computing scales

DETECTO's P225 printer is an easy-to-use, high-quality solution for many applications that require a fast and accurate printing option. This space-saving direct thermal label printer is designed to work with the DETECTO D series price computing scales. The P225 is also compatible with all Cardinal weight indicators and DETECTO food service scales with RS232 serial connectivity.



The P225 printer may be connected with DETECTO's D series scale via RS232 serial cable (part no. 7100-0025). P225 labels available from DETECTO (part no. 7100-0026) in single rolls or by the case (case is 12 rolls).

DETECTO's P225 desktop direct thermal printer is a space-saving option for retail POS weighing applications

The P225's clamshell design provides easy access to media for cleaning and installation. This printer is capable of printing a variety of labels up to 2-inches wide including continuous, die-cut, black mark, fan-fold, and notched via the external label entrance chute. Labels print at speeds of up to 5 inches per second at 203 DPI. The P225 is capable of printing a variety of graphics and logos through the printer software or Cardinal Scale's nControl label software. Graphics, bar codes, and logos may be stored on the printer's microSD flash memory up to 4 GB (microSD card not included).



The P225 printer comes with an AC adapter, Quick Installation Guide, utility drivers CD, and USB cable.



Quick replacement of label rolls via easy-loading clamshell design.

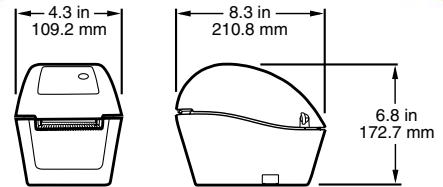

Resolution	8 dots / mm (203 DPI)
Printing Method	Direct thermal
Max. Print Speed	127 mm (5") / second
Max. Print Width	54 mm (2.13")
Max. Print Length	2,286 mm (90")
Enclosure	Clamshell design with wall mount holes at bottom cover
Overall Dimensions	4.3" (W) x 6.8" (H) x 8.3" (D) / 109.2 mm (W) x 172.7 mm (H) x 210.8 mm (D)
Weight	2.65 lb / 1.2 kg
Label Roll Capacity	5" (12.7 cm)
Processor	32-bit RISC CPU
Memory	4 MB Flash memory 8 MB SDRAM MicroSD card reader for Flash memory expansion, up to 4 GB
Interface	RS232 (for scale connectivity) USB 2.0 (for configuration only)
Power	External universal switching power supply Input: AC 100-240V, 1A, 47-63Hz Output: DC 24V, 2.08A, 50W
Switch, Button, LED	1 power switch, 1 feed button, & 1 LED (3 Colors: green, amber, & red)
Sensors	Transmissive gap sensor Black mark reflective sensor (position adjustable) Head open sensor
Internal Fonts	8 alpha-numeric bitmap fonts Monotype Image® true type font engine with one CG Triumvirate Bold Condensed scalable font
Printer Language	TSPL-EZ™
Media Type	Continuous, die-cut, black mark, fan-fold, and notched
Media Width	0.59" - 2.36" (15-60 mm)

Connectivity Ports	
Media Thickness	2.36 - 7.48 mil (0.06 - 0.19 mm)
Media Core Dia.	1" - 1.5" (25.4 mm - 38 mm)
Label Length	0.39" - 90" (10 - 2,286 mm)
Environment	Operation: 41° F to 104° F (5° C to 40° C); 25 - 85% non-condensing
Condition	Storage: -40° F to 140° F (-40° C to 60° C); 10 - 90% non-condensing
Safety Regulation	FCC Class B, CE Class B, C-Tick Class B, UL, CUL, TUV/Safety, CCC, ENERGY STAR®
Environmental Concern	Comply with RoHS, WEEE
Included Accessories	Windows labeling software CD disk Quick start guide USB cable Power cord External universal switching power supply
UPC Code	809161202502
Optional Labels	DETECTO part no. 7100-0026 (1,135 labels per roll)
Optional Serial Cable	DETECTO part no. 7100-0025 (for connecting with D series scales with RS232 serial port)

DETECTO reserves the right to improve, enhance, or modify features and specifications without prior notice.



203 E. Daugherty, Webb City, MO 64870 USA
Ph: 417-673-4631 or 1-800-641-2008 Fax: 417-673-2153

Mobile: m.detecto.com

SOLD BY: