



HANDLING & STORAGE

SERVING THE FOOD INDUSTRY SINCE 1951

HAND SINK & FLOOR MOP SINK

Item: 47246 | Model: CHSMS-211734

**CONVENIENCE IN CLEANING.
USEFUL TOOL FOR MOPPING
YOUR FLOORS AND MORE**

FEATURES:

- Hand sink and mop combination
- 18 gauge, type 304 stainless steel hand sink, cabinet body, mop sink, and wall mount clips
- Gooseneck faucet included
- Hand sink 1½" drain basket included
- Mop sink 3½" drain basket included



TECHNICAL DRAWINGS & DIMENSIONS

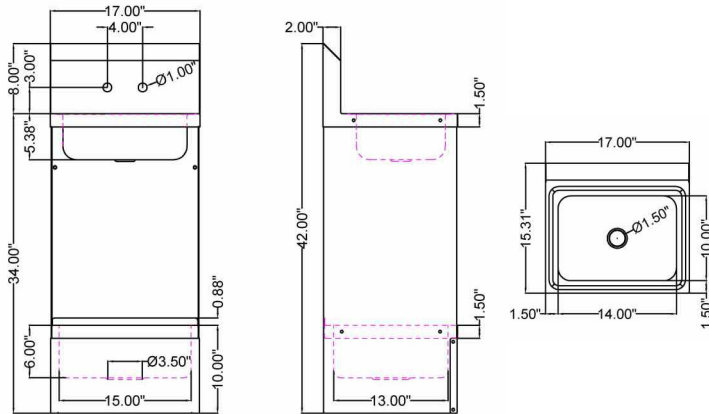

TECHNICAL SPECIFICATIONS

Item	47246
Model	CHSMS-211734
Hand Sink Bowl	14" x 10" x 5.38"
Mop Sink Bowl	15" x 13" x 6"
Weight	41.4 lbs 18.8 kg
Gross Weight	47.2 lbs 21.4 kg
Dimensions	15.31" x 17" x 34" with 8" Backsplash
Gross Dimensions	22" x 18.1" x 43"



Authorized Dealer