



Equipment for the Foodservice Industry  
value + quality + service

## Back Bar Swing Glass Door Coolers (Stainless Steel)

CBBSGD2-48CC



### CBBSGD2-48CC Features

#### Features:

- Exterior front, side and counter covered in stainless steel with swing glass door
- Counter tops and interiors are made with Type 304 stainless steel
- Swing doors equipped with locks for security
- Self-closing doors equipped to stay open when past 90 degrees
- Adjustable/removable plastic coated shelves
- Refrigeration system holds 33°F to 38°F (-0.5°C to 3.3°C) for optimum food preservation

- Removable door gasket for easy cleaning and service
- R290 refrigerant
- Foamed-in polyurethane cell insulation

#### Warranty:

- Two year parts and labour; Five years on compressor. *For full warranty details visit <https://www.efifoodequip.com/warranty-info.php>*



**CBBSGD2-48CC Specifications**

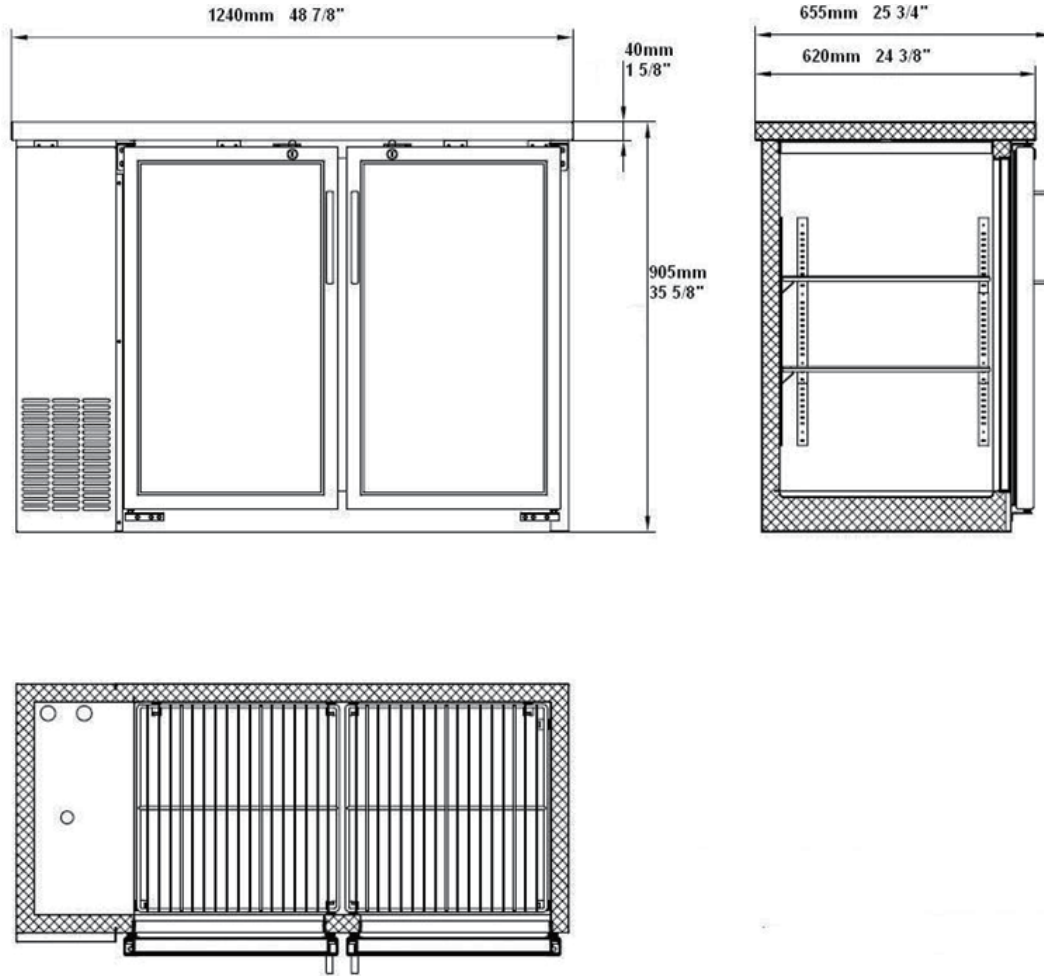

Model	Doors	Dimension (mm / inch)			HP	Voltage	Amps	Capacity (L / Cu Ft.)	Net Weight (KG / LBS)	Temperature Range	NEMA Config.
		L	D	H							
CBBSGD2-48CC	2	1240	620	905	1/3	115/60/1	6.4	334.1	117.9	0.5 ~ 3.3°C	5-15P ⓘ
		48.8	24.4	35.6				11.8	260	33 ~ 38°F	

Specifications subject to change without notice.