

Adam, Rouilly

SERVING MEDICAL EDUCATION WORLDWIDE

AR50S/AR50S0-B OBSTETRIC PHANTOM WITH FETAL DOLL AR57/AR57-B OBSTETRIC PHANTOM SET

Instruction Manual



Thank you for purchasing this AR50S/AR50S-B Obstetric Phantom with Fetal Doll or AR57/AR57-B Obstetric Phantom Set.

The models are durable and simple to use and maintain, and allow for demonstration of a variety of birthing procedures.

Our obstetric, fetal and pelvic models are the versatile choice for midwifery training and education across the world.

Please read this instruction manual carefully and retain it for future reference.

Skills

- The fetal doll can be placed in the model in various positions, to enable the student to practise palpation through the abdominal wall
- Different birth positions can be demonstrated
- Fetal doll, umbilical cord and placenta included

Features

- Based on a female pelvis, this life size model features all the relevant landmarks
- The vulva will stretch during the delivery procedure and afterwards will return to its original form
- Removable abdominal wall
- Fetal doll head may rotate and flex as with representation of fontanelle

Features (AR57/AR57-B Set)

- Fetal doll with 4 interchangeable heads:
 1. Occipito-posterior
 2. Occipito-anterior
 3. Brow
 4. Face
- Female pelvis cast from life in high quality plastic

Safety and Precautions



Both the head of the fetal doll(s) and the vulva of the phantom must be coated with the lubricant provided before use.



The phantom is best used in a reasonably warm atmosphere, as room temperature or above makes the plastic vulva more pliable.



Fetal head(s) rotate 90° to the left and right, and bend forwards and backwards. Do not exert excessive force on the head as this may damage the doll.



Please treat the simulator with the same care you would a patient.

Contents

Parts	4
- Supplied With	5
During Use	
- Normal and Breach Delivery	7
- Forceps and Ventouse Delivery	7
- Abdominal Palpation	9
For AR57/AR57-B Obstetric Phantom Sets Only	
- Using the AR55 Fetal Doll with Four Interchangeable Heads	9
- Using the AR35 Female Pelvis	11
After Use	
- Cleaning	11

Parts

AR50S OBSTETRIC PHANTOM WITH FETAL DOLL

AR50S-B OBSTETRIC PHANTOM WITH FETAL DOLL, BLACK

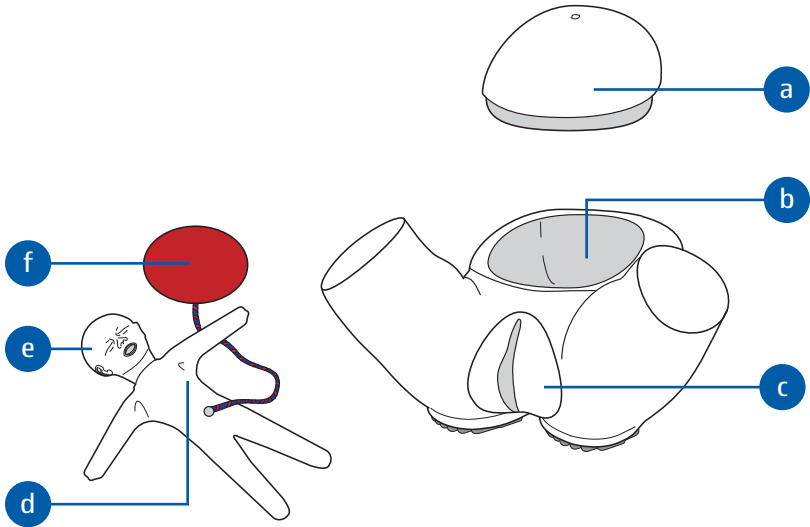

AR57 OBSTETRIC PHANTOM SET, WHITE

AR57-B OBSTETRIC PHANTOM SET, BLACK

As above but also including:

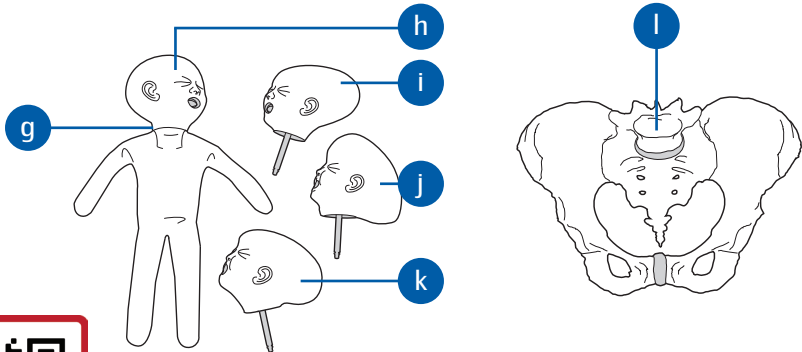

- a Removable abdominal wall
- b Birthing womb
- c Vulva
- d Press stud (to fasten/unfasten cord and placenta)
- e **AR75/AR75-B FETAL DOLL**
- f Detachable cord and placenta

Supplied With

S052 SILICONE LUBRICANT

- g **AR55/AR55-B FETAL DOLL WITH FOUR INTERCHANGEABLE HEADS**
- h Occipito-posterior interchangeable head
- i Occipito-anterior interchangeable head
- j Brow interchangeable head
- k Face interchangeable head
- l **AR35 FEMALE PELVIS**



If you require replacement parts please contact our Sales Department, quoting codes where applicable.



Scan the QR code to access the product video.
<https://youtu.be/8GV3JY4B1dU>

During Use

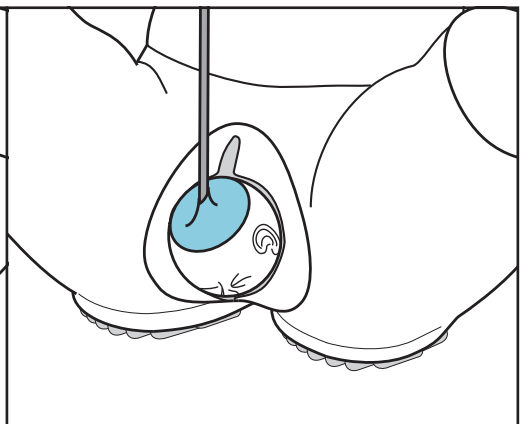
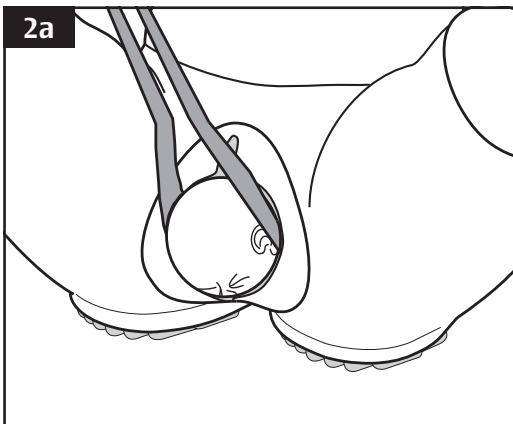
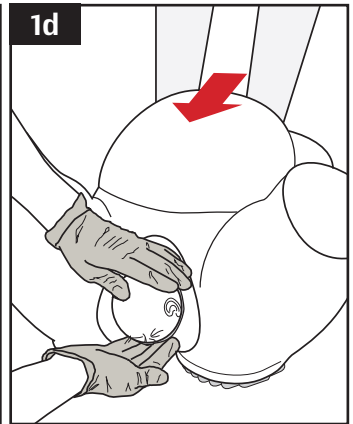
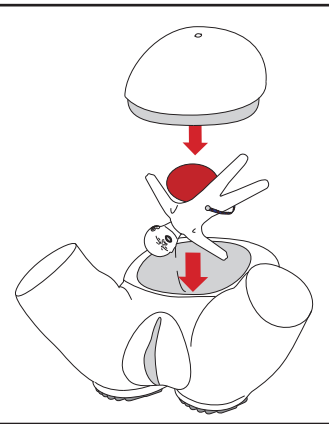
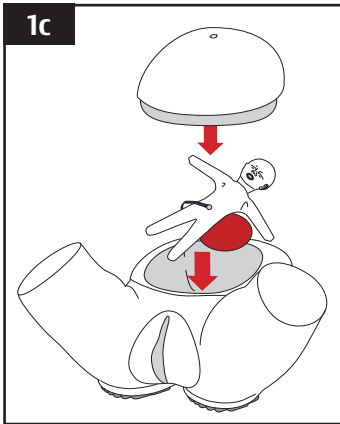
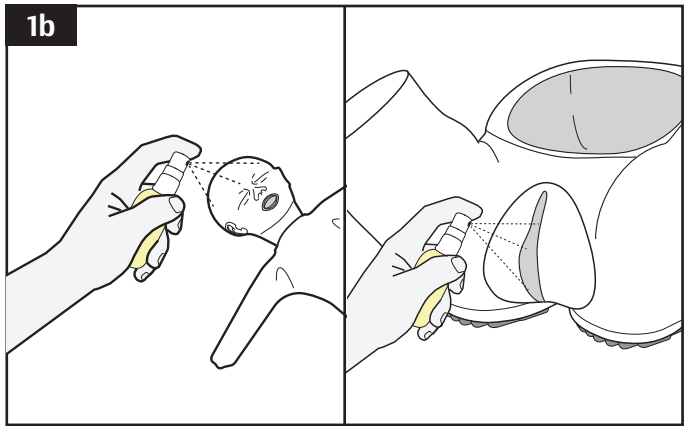
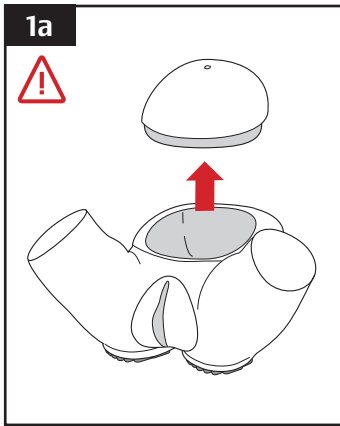

Normal and Breach Delivery

Ensure the work area is clean and dry.

Place the trainer on a stable, flat surface.

1a

Remove the abdominal wall from the phantom.



The phantom is best used in a reasonably warm atmosphere, as room temperature or above makes the plastic vulva more pliable.

1b

The supplied lubricant is non-flammable, non-toxic and virtually odourless.

Spray the fetal doll head with lubricant. Apply lubricant to the vulva by opening the lips slightly with your fingers and coating the inner surface.

Lubrication should be done each time a delivery is attempted.

1c

Place the fetal doll into the birthing phantom, always placing the placenta and cord before the doll. If the placenta and cord are not required, they may be removed simply by detaching the press stud from the fetal doll.

The fetal doll may be placed into the phantom in different positions to simulate different birthing positions. Place the doll head first into the inside of the vulva for normal delivery, legs first for breach delivery etc.

For added realism, the abdominal wall may be re-attached to the phantom.

1d

During the delivery training session, the fetal doll will need to be pushed from inside the phantom. Hands may be inserted into the phantom by lifting the back of the abdominal wall cover.

Forceps and Ventouse Delivery

2a

Forceps and Ventouse delivery methods may be performed using the phantom, after setting up and lubricating the trainer as above.

During Use (Continued)

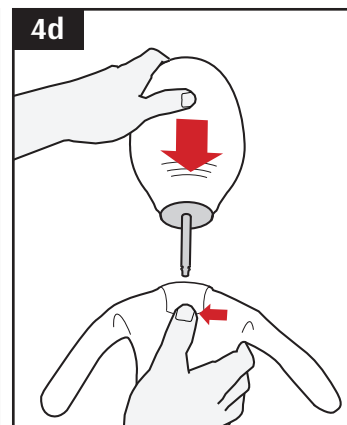
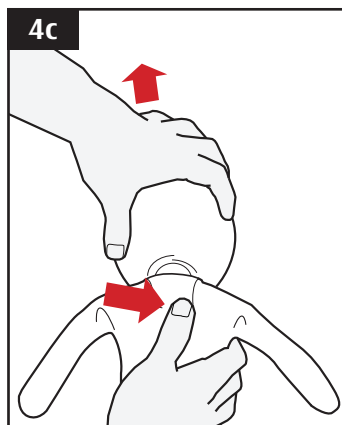
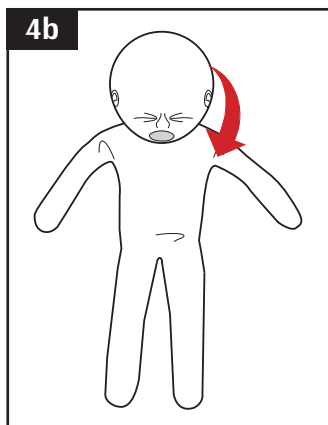
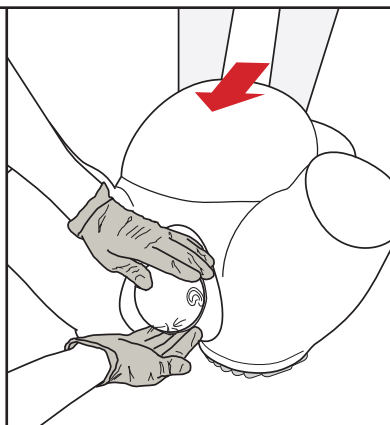
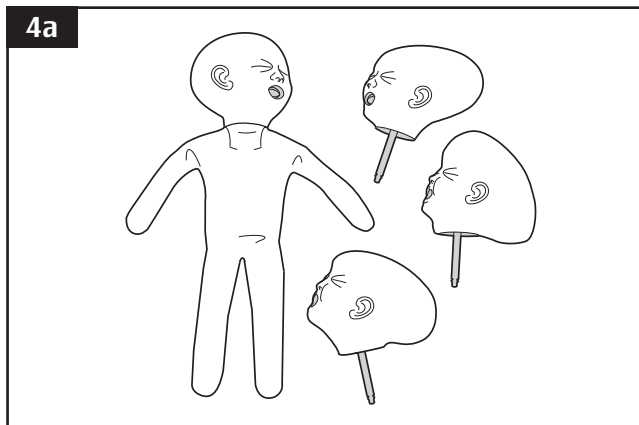
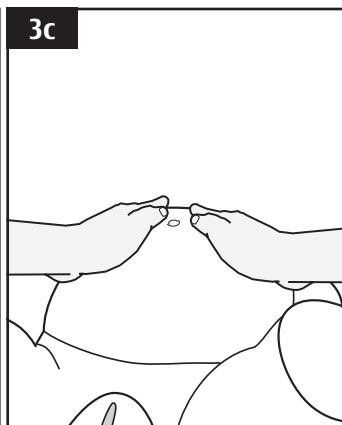
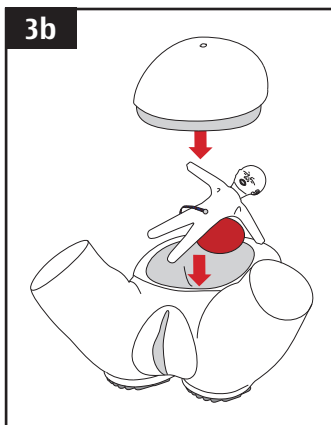
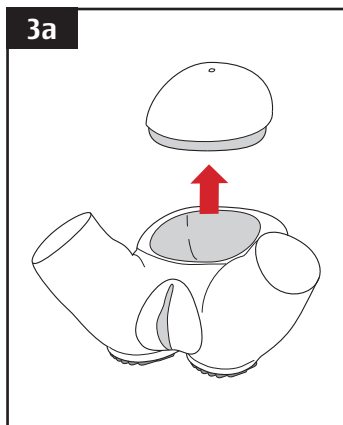

Abdominal Palpation

- 3a** Remove the abdominal wall from the phantom.
- 3b** Place the fetal doll in the phantom in any desired position for the training session. Replace the abdominal wall cover.
- 3c** The phantom is ready for abdominal palpation.

Using the **AR55/AR55-B FETAL DOLL WITH FOUR INTERCHANGEABLE HEADS** (For **AR57/AR5&-B OBSTETRIC PHANTOM SET** only)

- 4a** The AR55 Fetal Doll included in the AR57 and AR57-B Obstetric Phantom Sets has four interchangeable heads to demonstrate different fetal head positions.

The doll may be used with the birthing phantom in exactly the same way as described in steps **1a** to **1d**.

- 4b** To change the head of the fetal doll, bend the head forward as far as possible until the chin rests on the chest.

- 4c** With the back of the doll facing you, locate the spring catch under the fabric between the shoulder blades. Move the spring catch towards the right shoulder and pull the head gently upwards to release it.

- 4d** Release your finger from the catch and ensure the catch returns to its original position.

Be sure the new doll head faces the correct way and simply insert the plastic rod into the doll neck until it clicks into place.

Raise the head to its original position.

The doll is ready for use again.

During Use (Continued)

5a

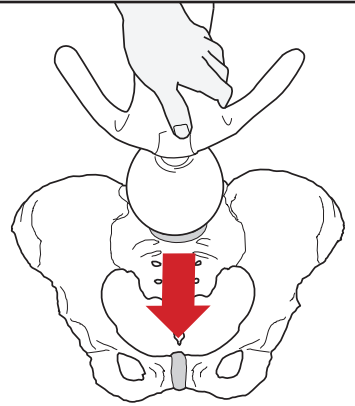
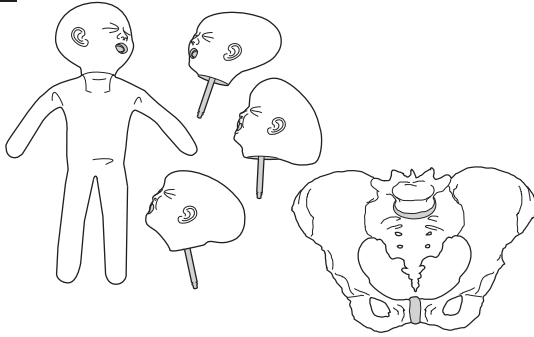

After Use

6a

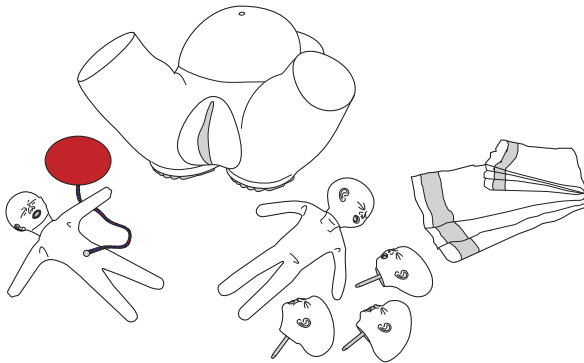

Using the **AR35 FEMALE PELVIS**
(For **AR57/AR57-B OBSTETRIC PHANTOM SET** only)

5a

The AR35 Female Pelvis may be used in conjunction with the AR55 Fetal Doll with Four Interchangeable heads for demonstration.

Cleaning

6a

After use, the phantom and fetal dolls should be cleaned with a soft, dry and absorbent cloth.

2 Year Guarantee



All products manufactured by Adam,Rouilly are covered by our full 2 Year Guarantee. This guarantee applies to models which have been used correctly and covers durability and functionality.

Adam,Rouilly

As part of our policy of continual product development, the specification of products may alter without prior notice.

Adam,Rouilly has over 100 year's experience in providing quality medical models and simulators.

Should you require any further information please contact our Sales Department who will be pleased to help with your enquiry.

Adam,Rouilly Limited
Castle Road
Eurolink Business Park
Sittingbourne
Kent
United Kingdom
ME10 3AG

T: +44(0)1795 471378

F: +44(0)1795 479787

E: sales@adam-rouilly.co.uk

www.adam-rouilly.co.uk