



Cable and hydraulic hose management

Re: 2018 model cable management

Dear Rocky Mountain customers,

This bulletin details the best practices for securing the lower cable loop on your 2018 Altitude, Pipeline, or Instinct.

The following steps must be followed to prevent contact and wear between the cable loop, and your front triangle at the bottom bracket shell*:

1. Install the cables in the correct sides of the cable clamp at the downtube, as shown. Do not install 5mm (brake) hose in the 4mm (shift) side of the two-piece cable port, as this can cause damage to the brake system.
2. Ensure a clearance of 30-45mm between the cable loop, and the bottom bracket shell.
3. Use a zip-tie to secure the shift cable to the brake cable under the bottom bracket shell.

**Improperly secured brake and shift cabling can result in component failure, which can lead to serious injury.*

Please see the following pages for a pictorial cable installation guide. As always, thank you for your assistance in ensuring that our bikes run as intended.

Quality Assurance Team

1. Cable Placement at Clamp

Orient the cables as shown, at the downtube port clamp.

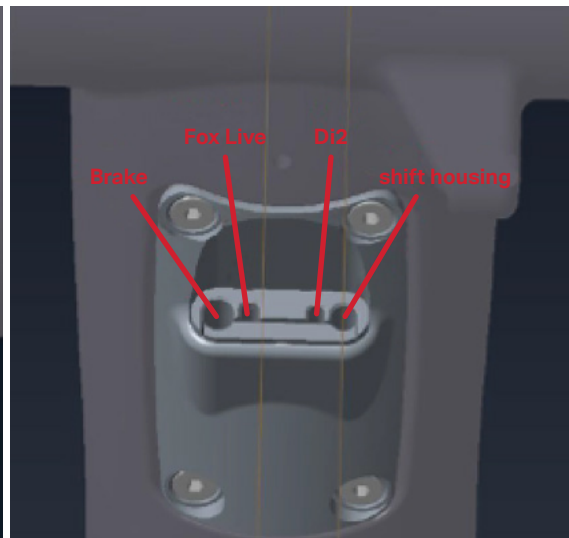
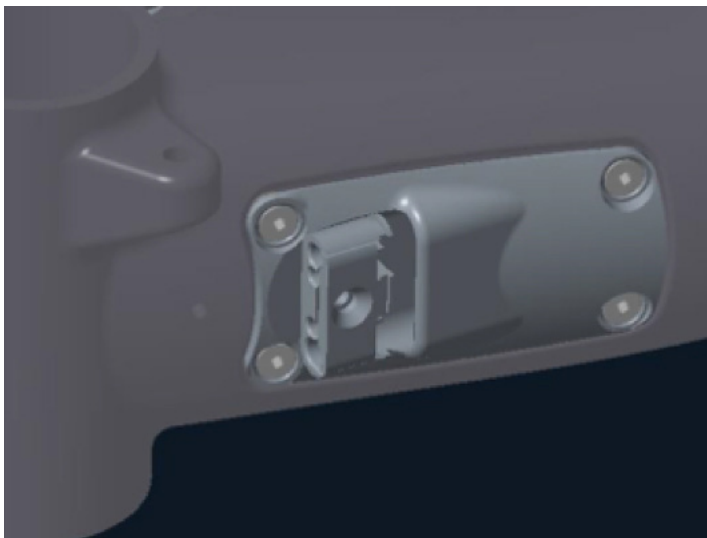

2. Cable Length

Ensure a minimum clearance of 30-45mm between the cable loop, and the bottom bracket shell.

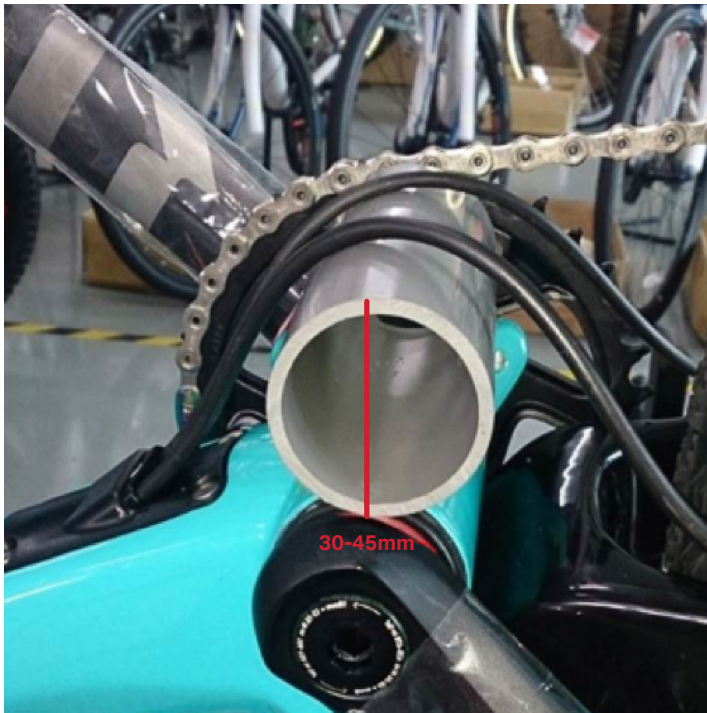

3. Bottom Bracket Zip-Tie

Use a zip-tie to secure the shift cable to brake cable under the bottom bracket shell.

