

IMPORTANT SAFETY INFORMATION	1
PRODUCT PARTS LIST	3
INSTALLATION - CEILING FAN	4
INSTALLATION - LIGHT KIT	8
INSTALLATION - TROUBLE SHOOTING TIPS	9
CARE AND CLEANING	11
PRODUCT WARRANTY	13



# DC-3 CEILING FAN

INSTALLATION MANUAL

# IMPORTANT SAFETY INFORMATION

Thank you for choosing an Iconic Ceiling Fan. We are confident that your new ceiling fan will provide many years of service and enjoyment.

## GENERAL PRECAUTIONS

It is important that you read and follow these instructions carefully, and be mindful of all warnings shown throughout this manual. Please retain these instructions for future reference.

**The mounting of the suspension system shall be performed by the manufacturer, its service agent or suitably qualified persons. This ceiling fan must be installed by a licenced and qualified electrician in accordance with SAA Standards and all local authority regulations.**

Only Iconic Fan Company approved wall or remote controls should be used for the operation of this fan. The use of unauthorised wall or remote controls will void the manufacturer's warranty.

## SAFETY PRECAUTIONS

Be cautious! Read all instructions and safety information, and review the accompanying assembly diagrams before installing your new fan.

To reduce the risk of electric shock, do not install this fan in a location where it may be exposed to rain, moisture or liquid of any kind.

**A double pole isolation switch providing full disconnection of power to both the fan and the light must be fitted in accordance with the requisite wiring rules (AS/NZ 60335.1 c1.7.12.2).**

Do not attempt to operate the fan if it has or appears to have been damaged in any way, or if it malfunctions after installation.



**WARNING: If unusual oscillating movement is observed, immediately stop using the ceiling fan and contact the manufacturer, its service agent or suitably qualified persons.**

Do not use this fan for any purpose other than its intended use, as described in these instructions. Avoid contact with moving fan blades and ensure that hair, clothing and other articles are kept well clear of the fan. Contact with moving ceiling fan blades may cause serious injury.

This appliance is not intended for use by persons (including children) with reduced physical, sensory or mental capabilities or by persons who lack the experience and knowledge to safely operate the fan, unless they are under the supervision of, or have been given instruction concerning the safe use of the appliance by a person responsible for their safety and well-being. Close supervision is necessary when the product is used by children. Do not allow children to use it as a toy.

# LOCATION AND INSTALLATION REQUIREMENTS

## MECHANICAL ISSUES

To provide adequate clearance, the fan is to be installed so that the blades should be 2.3m or more above the floor.

Make sure the chosen location will not allow the rotating fan blades to come into contact with any object.

The mounting bracket must be firmly screwed to a load bearing structure, e.g. a concrete ceiling, steel structure or timber frame. The fixing means for attachment to the ceiling such as hooks or other devices shall be fixed with a sufficient strength to withstand 4 times the weight of the ceiling fan.

To reduce the risk of fire, electric shock or personal injury, ensure that the fan mounting bracket is supported directly from the building structure. DO NOT mount to an outlet box.

The replacement of parts/mounting of the suspension system shall be performed by the manufacturer, its service agent or suitably qualified persons.

After the fan is completely installed, check to make sure that all connections are secure to prevent the fan from falling and/or causing damage or injury.

To reduce the risk of personal injury, do not bend or damage the Down Rod or Fan Blades when handling or installing them.

## ELECTRICAL ISSUES

To avoid possible electric shock during installation, be sure that the electricity supply is turned off at the main power box before commencing work. Disconnect the power by removing the fuse or turning off the circuit breaker before installing the fan.

The fan and mounting bracket must be earthed. Ensure all spliced connections are adequately insulated.

**Do not attempt to control the operation of this fan from any wall or remote control that is not approved by The Iconic Fan Company for use with this fan. DO NOT use a solid state wall controller. The use of an unapproved wall or remote control will void the manufacturer's warranty.**

This fan can be used in conjunction with some home automation systems. For further information please contact the distributor.

### NOTE:

Nothing in this manual is intended to instruct or assist untrained or unqualified persons to install this product. Additionally, it is the responsibility of the installer and user to apply common sense and care at all times.

# PRODUCT PARTS LIST

3

**iconic**  
FAN COMPANY

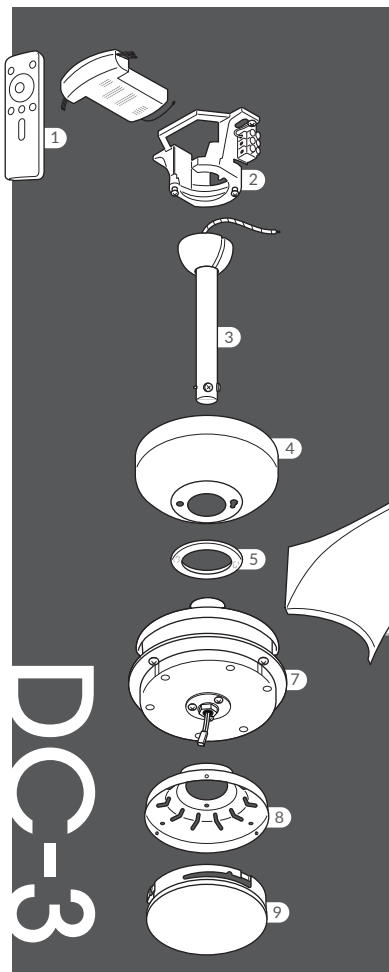
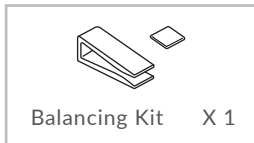
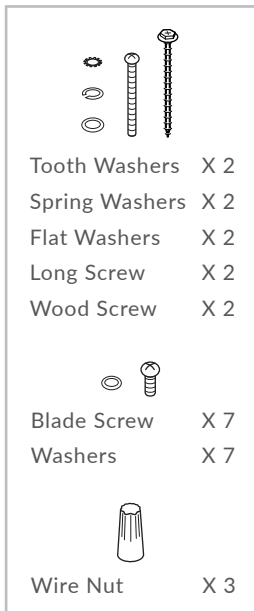

Optional Accessories  
Light kit (Sold separately)



10. LED Assembly

11. Light Diffuser

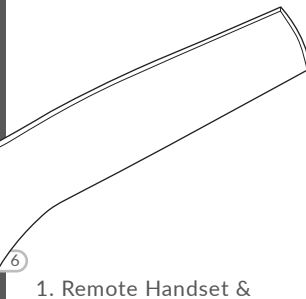

1. Remote Handset & Receiver
2. Mounting Bracket
3. Down Rod Assembly
4. Ceiling Canopy
5. Ring Cap
6. Blade Set
7. Motor Assembly
8. Cover Plate
9. Bottom Cap

# INSTALLATION

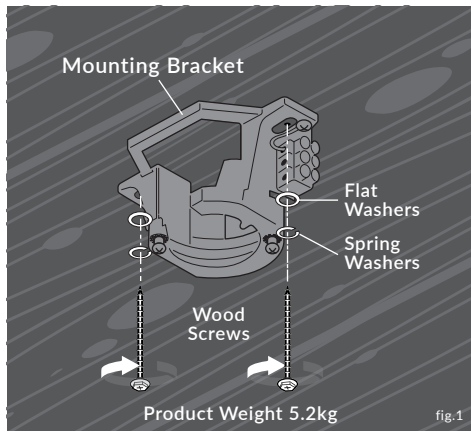

## Step 1

**!** Make sure the electricity supply is turned off.

### On Timber Beam

Secure the Mounting Bracket to the timber beam or support using the 2 wood Screws provided. If no timber or support exists, that must be installed prior to commencing this step. The beam or support must be of adequate strength to support a 40kg load.

### On Concrete Ceiling

Use 2 expansion anchor bolts (not included) in place of the Wood Screws.

### \*\*Slope Ceiling\*\*

If the slope of the ceiling is greater than the original Mounting Bracket allows, Slope Ceiling Kit is available as an accessory and it can be installed at ceiling up to 45 degrees. In most cases, accessory extension down rod will be required to keep the fan blades from contacting the ceiling.

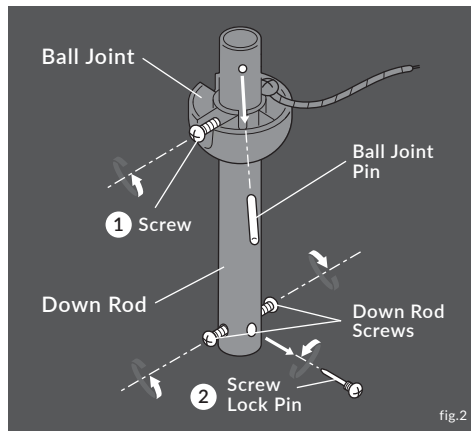

## Step 2

1. Loosen the screw in the Ball Joint and remove the Ball Joint Pin inside.
2. Loosen the 2 Down Rod Screws at bottom of the Down Rod and remove the Screw Lock Pin.

### \*\* Extension Down Rod \*\*

If you are installing the fan with an accessory Extension Down Rod, replace it before completing this step. The cut side of the Extension Down Rod should always be on the Ball Joint end.

# INSTALLATION

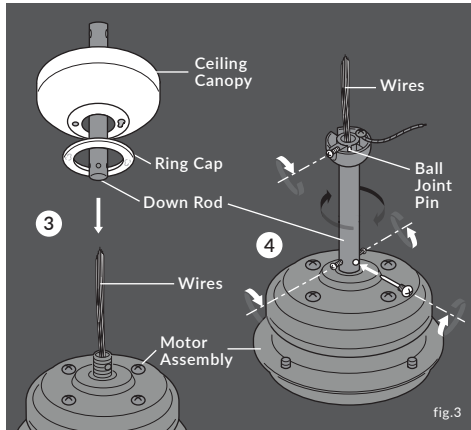

## Step 3

3. Place the Ceiling Canopy and Ring Cap onto the Down Rod as show. Feed the wires through the Down Rod.

4. Screw the Down Rod onto the Motor Assembly, make sure the wires are not twisted or tangled, reinstall the Screw Lock Pin, then tighten the 2 Down Rod Screws. Place the Ball Joint, Ball Joint Pin back on the Down Rod, then tighten the screw to secure the Ball Joint.

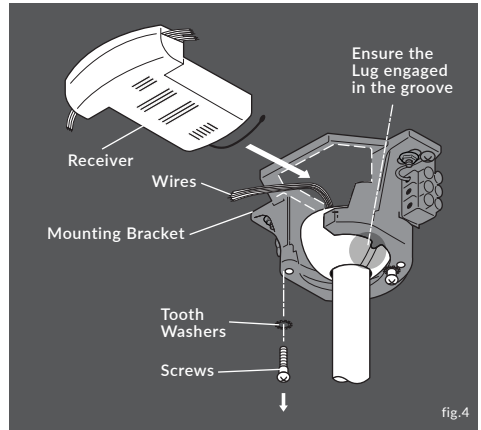

## Step 4

Hang the Ball Joint onto the Mounting Bracket. Ensure the Lug on the Mounting Bracket is engaged in the groove on the Ball Joint.

Remove either 1 of the Screws with its Washer from the Mounting Bracket for Step 6.

Place the receiver into the Mounting Bracket. Use the terminal block provided at the Mounting Bracket and connect the wires as per the diagram next.

# INSTALLATION

## Wiring Diagram

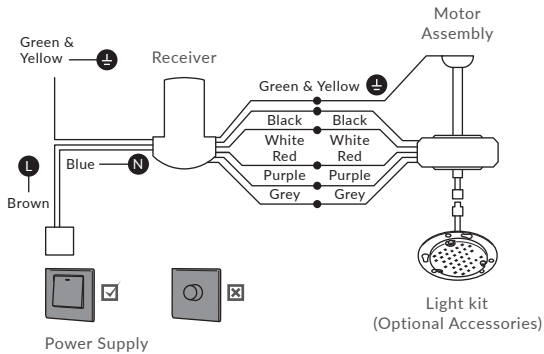
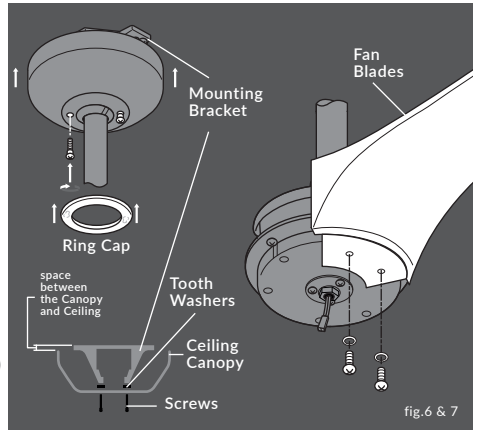

fig.5



## Receiver Installation



**Make sure the electricity supply is turned off.**



**Never connect the fan wires direct to AC power supply. Doing so will damage the motor and warranty voided.**

## Step 5

Connect the wires as per the wiring diagram shown. Terminate the Light Wires (black & white) if no Light Kit is to be installed. Ensure the termination is adequately insulated.

## Step 6

Put the Screw through the round hole and place its Washer over the Screw inside the Ceiling Canopy. Line the keyhole up with the other Screw and lock the Ceiling Canopy in place, tighten both Screws. Then attach the Ring Cap and lock it in place.

Checking to ensure the Ceiling Canopy does not make contact with the ceiling. Add packing washers to provide clearance if necessary.

## Step 7

Attach the Fan Blades to the Motor Assembly and secure them with the Screws and Washers provided.

# INSTALLATION

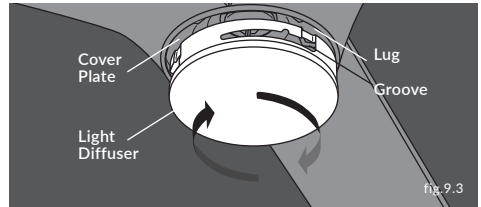
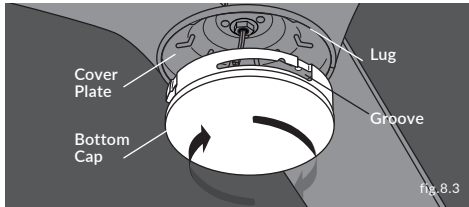
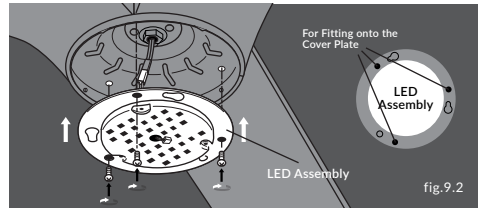
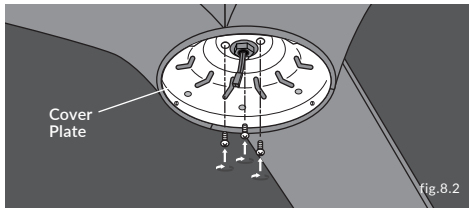
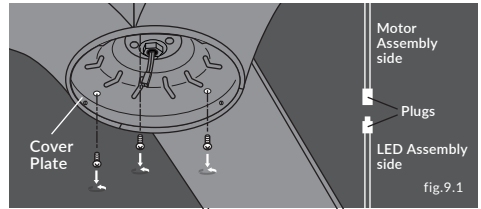
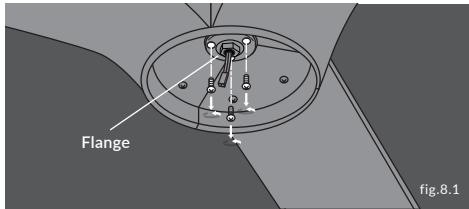

## Step 8

Attach the Cover Plate to the Flange with the 3 screws provided. Install the Bottom Cap onto the Cover Plate by turning it clockwise. Ensure the lug and the groove are engaged properly.

**\*\*If you have purchased the accessory Light Kit, see next Step. Otherwise, see Step 10.**

## Step 9

Connect the plugs and attach the LED Assembly to the Cover Plate with the 3 screws provided. Follow the Screw Holes as shown.

Install the Light Diffuser onto the Cover Plate by turning it clockwise. Ensure the lug and the groove are engaged properly.



# INSTALLATION

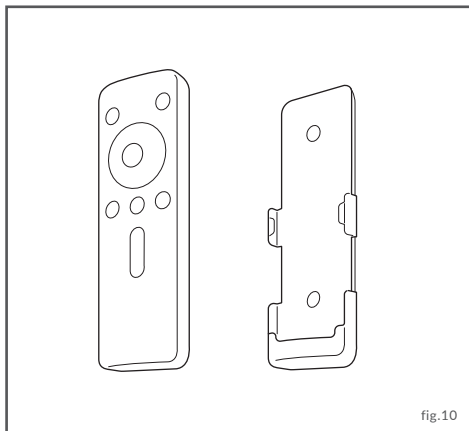

## Step 10

Set the remote control as per the remote control manual included and the installation is completed.

### THE FAN DOES NOT OPERATE / THE REMOTE CONTROL DOES NOT FUNCTION

1. Check that the Remote Control is set correctly as per the manual.
2. Check / replace the battery of the Remote Control.



**WARNING: The following items require access to areas of the fan which carry lethal voltage. These checks must only be carried out by a licenced and qualified electrician.**

3. Check the wire connections at the receiver and terminal blocks, ensure all electrical connections are good, and that unused wires are correctly terminated.
4. If a remote control other than the one provided by the Iconic Fan Company has been installed, it should be replaced with an approved remote control or the warranty will be void.

### THE FAN WOBBLER WHEN ROTATING

1. Ensure that the Ball Joint Screw is tightened, the lug on the Mounting Bracket is engaged in the groove in the Ball Joint, and that the Ball Joint is correctly seated in the bracket.
2. Check the Blade Screws are tightened firmly.
3. Make sure the Fan Blades are a matching set. Matching sets of Fan Blades vary in weight by no more than 3 grams. Most Fan Blades have a weight label on the top surface (only apply to some models).
4. If necessary, use the Balancing Kit provided to reduce the wobble.

## INSTALLATION - Trouble Shooting Tips

### THE FAN MAKES A NOISE

1. Check that all screws and fasteners are tight, and that all parts are firmly secured.



**Warning: The following items require access to areas of the fan which carry lethal voltage. These checks must only be carried out by a licenced and qualified electrician.**

2. Ensure there are no loose parts inside the Ceiling Canopy and Motor Housing. Check if the mounting bracket is firmly attached to the ceiling and the ceiling canopy does not make contact with the ceiling.
3. If a remote control other than the one provided with the fan has been installed, it should be replaced with the original remote control. Use of an unapproved remote control will damage to the motor, and will void the warranty.

#### **Note:**

In some areas, signals are sent through the power lines by the electricity supplier for the control of off peak hot water, street lights and so on. These signals may cause an intermittent humming in the fan. Filters are available in Australia at customer cost. It is not a fault with the ceiling fan.

### THE LIGHT DOES NOT SWITCH ON OR FLICKERS

1. Check that the plugs for the LED assembly are connected properly.



**Warning: The following items require access to areas of the fan which carry lethal voltage. These checks must only be carried out by a licenced and qualified electrician.**

2. Check the wire connections of the plugs for the LED assembly, the terminal block (in the Ceiling Canopy), and the receiver. Ensure all electrical connections are good and that unused wires are correctly terminated.
3. Ensure the LED plate is firmly attached to the metal plate behind.
4. If the Light does not respond to the Remote Control, ensure that the channel settings in the Remote Control Handset and Receiver correspond. (See remote control manual)

# PRODUCT INFORMATION

## CARE AND CLEANING

1. Regular cleaning of fan blades is recommended to prevent dust build up.
2. When cleaning your fan, use only a soft brush or slightly damp lint free cloth to avoid scratching the finish. DO NOT use water when cleaning your ceiling fan as it could damage the motor or the blades and/or create the possibility of electric shock.

## GENERAL INFORMATION

1. All electrical motors, including fan motors make some noise, and may feel hot to the touch. This is NOT a fault.
2. Ceiling fans tend to move during operation due to the fact that they are not rigidly mounted. (Rigid mountings can generate excessive vibration and stress on the mountings). Movement of a couple of centimetres is not unusual and does not suggest that the fan will fall down.
3. Ceiling fans are an environmentally sensitive choice to help keep you cool in your home. They work by creating air flow which causes a cooling sensation on the skin. The faster the

speed of the air flow, the greater the cooling sensation. Ceiling fans do not work by cooling the room, so they can be switched off when there is no one in the room in order to save energy.

4. Threaded components working slightly loose or parts slightly damaged or bent during vigorous cleaning or bumping can cause extra wobble and noise. This is not covered under warranty, but care during maintenance and cleaning generally prevent this from occurring.
5. During winter, your fan can be used on low speed in reverse (Winter mode). Warm air rises to the ceiling, where it cannot be felt by the occupants of a room, especially in areas with high ceilings. Running the fan slowly in reverse moves air gently upwards, forcing warm air down the walls of the room where it mixes with the cooler air below. This may help to reduce heating costs. We recommend that you keep the fan at a low speed, so that the effects of evaporative cooling are minimised.

# PRODUCT WARRANTY

## ICONIC FAN COMPANY WARRANTY

The warranty on your Iconic Fan Company product purchased in Australia is provided by the authorised product distributor (the distributor) in the state or territory where the product was purchased. For contact information, please refer to [iconicfan.com.au](http://iconicfan.com.au).

To obtain the best performance from a ceiling fan, it is crucial that the correct size of fan is properly installed in the optimum location. We cannot arrange for, or cover the cost of, an on-site visit by service personnel in relation to the airflow or other performance of your product except in cases where, following over the telephone trouble-shooting, the distributor has determined that such issues may be a direct result of a manufacturing defect (material or workmanship). Fans that do not perform as expected or desired and which are not faulty will not be replaced or exchanged under warranty.

All ceiling fans and associated products should be installed by a licenced electrician. Installing electricians who are experiencing problems with installation or who cannot get the product to operate correctly once

installed should read the 'Trouble-Shooting Section' of the installation manual or contact the distributor.

The benefits provided to you by this warranty are in addition to other rights and remedies available to you under the law.

### Warranty periods

The warranty on your Iconic Fan Company product purchased in Australia begins from the day of purchase.

### Ceiling fans

The ceiling fan itself, excluding accessories such as the Remote Control Handset and Receiver, Light Kit & Wall Control, is covered by a three (3) year on-site warranty. During this period, the distributor will, at its discretion, repair or replace products considered to be defective due to a manufacturing defect (material or workmanship).

### Accessory

Iconic Fan Company Remote Control Handset and Receiver, accessory Light Kits (integrated or externally mounted) and Wall Controls are covered by a one (1) year on-site warranty

# PRODUCT WARRANTY

under the same conditions as described for fans. No further warranty is offered on these items after the 1 year period.

## Repaired or replaced products

Any replaced or repaired product is covered only by the balance of the warranty remaining on the original article.

## Transfer of warranty

If the premises where the fan or remote control is installed changes hands, the balance of the warranty passes to the new owner, provided that the original bill of sale for the product is retained by the new owner.

## Terms and conditions

The warranty on your Iconic Fan Company product purchased in Australia is provided on the following terms and conditions;

- You should consult the distributor by telephone or email prior to making any arrangements to service or remove the product. Reimbursements for labour or product delivery costs will not be met without prior approval from the distributor. Labour costs (to a maximum of \$100 inc.

GST) and product delivery costs relating directly to a warranty claim will be met by the distributor during this period, however it is the responsibility of the owner to arrange for a licensed electrician to complete any necessary labour.

- The cost of obtaining or using any required special access equipment (scissor lifts, scaffolding, long ladders, etc.) to install or remove the ceiling fan is specifically excluded, and it is the responsibility of the owner to provide such equipment and have it safely installed and operated.
- The warranty for the fan does not cover damage to the fan if it is moved from one dwelling to another during the warranty period. The warranty is voided in total if the product is sold as second hand goods.
- Iconic Fan Company Ceiling Fans not purchased and installed in Australia are not eligible for warranty repair.
- Batteries for remote controls and globes, if supplied, are complimentary only and are not covered by the warranty.

# PRODUCT WARRANTY

- Any damage incurred to the product after delivery to the owner, that is not caused by a fault in the products' materials or workmanship; damage from lightning or power surges; damage to the fan due to incorrect installation; damage to the premises due to incorrect installation; noise or other influence of ripple control or information access systems operation over power delivery infrastructure; water damage of any kind; installation or use outdoors; damage arising from connection to or use with alternative power systems (e.g. inverters, solar, etc.) are not eligible for warranty repair.
  - Ceiling fans used incorrectly, accidentally damaged, modified in any way or not serviced in accordance with the maintenance instructions are not eligible for warranty repair.
  - Subject to any statutory provisions to the contrary, any claims for damage to furniture, carpet, walls, ceilings, foundations or any other consequential loss either directly or indirectly resulting from a faulty ceiling fan will not be met under this warranty.
  - The distributor reserves the right to charge a service call fee where; there is nothing wrong with the ceiling fan or; the defective operation of the ceiling fan is due to failure of electricity or; the installation is not in accordance with Iconic Fan Company instructions and/or applicable local regulations or; the defects have been caused by incorrect application or abuse of the ceiling fan or the damage has been caused by unauthorised persons attempting to repair the fan.
-

## WARRANTY CLAIM DETAILS

Upon installation, please fill in and retain the following details for warranty claim purpose.

Model Name

Installing Electricians Name

Place of Purchase

Installing Electrician's License No.

Date of Purchase

Installing Electrician's Phone No.

Receipt Number

(A copy of your receipt for Proof of Purchase will be required)

## ICONIC FAN COMPANY

### Australia

P: 1300 019 313

E: sales@iconicfan.com.au

W: iconicfan.com.au

### International

P: (852) 2164 7228

E: sales@elar.com.hk

W: elar.com.hk