

DBPOWER

F16



LED

HEADLIGHT

AUTOMOTIVE LED HEADLIGHT

User Manual

AUTOMOTIVE LED HEADLIGHT

ACTIVATE YOUR 36-MONTH WARRANTY

Register within 7 days after receiving your new product.

PLEASE VISIT US NOW

→ warranty.dbpowershop.com

CUSTOMER SERVICE

✉ support@dbpowershop.com 🌐 www.dbpowershop.com



NOTE

1. Do not look directly at the operating lamp for any period of time, as this may cause serious eye injury.
2. Do not touch the area with hands or allow any skin contact as it may result in severe burns.
3. Do not disassemble or modify the product in any way.
4. Do not wash the vehicle with the lights turned on.

A Big Thank You

We're thrilled that you have chosen to purchase the DBPOWER LED HEADLIGHT. At DBPOWER, we're committed to providing you with products that enhance your daily life. We also aim to give our customers excellent support. Should you have any questions or feedback about your new product, simply get in touch with our customer support team at 1-855-888-5533, or by email at support@dbpowershop.com

Enjoy your new product!

PRE-INSTALLATION NOTICE

PRODUCT PARTS INTRODUCTION	02
PRODUCT SPECIFICATIONS	03
PRE-INSTALLATION NOTICE	04
LIGHTING TEST	05
PRECAUTIONS FOR INSTALLATION	06
WARNINGS FOR USE	07
INSTALLATION	08
TROUBLE SHOOTING	11
NOTICE	12

PRODUCT PARTS INTRODUCTION

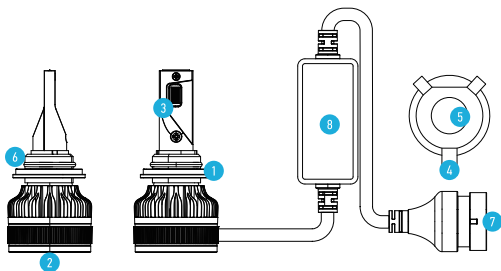

1. Locking ring
2. Heat sink and fan
3. LED component
4. Tab (Locking ring, different model different shape)
5. Groove (Locking ring)
6. Tab (LED bulb)
7. Bulb connector
8. Driver

PRODUCT SPECIFICATIONS

Mode	F16
Operating Voltage	DC9-60V
IP Rate	IP68
Light Source Model	Philips Chip
Color Temperature	6000~6500K
Heat Dissipation	Theory Aviation aluminum 6063
Operating Life	50000 hours
Operating Temperature	-40 °C ~ +80 °C
LED Component	CSP

PRE-INSTALLATION NOTICE

- *Please make sure this product has been purchased from a legal sales channel.
- *This product can only be used on road-legal automotive vehicles.
- *This product may contain small parts, and we strongly advise you to keep this product away from infants and children, so as to prevent a choking hazard or possible injury.
- *Please test the LED bulbs before fully installing them in your vehicle.
- *Before installing, please make sure the LED bulbs are not damaged or broken, and have not been dropped on the ground. If any of these conditions exist, please do not install the LED bulbs in your vehicle.
- *Store this product only in a cool and dry place. Keep away from moisture and dust, otherwise it may become damaged.
- *Keep the LED bulb away from areas or materials that are exposed to flames or prone to combustion,

Please read this instruction manual carefully before installing this product.

After completing the installation, please keep this manual in a safe place for future reference,

LIGHTING TEST

1. Remove the original bulb from the vehicle connector.
2. Attach the LED bulb connector to the vehicle connector.
3. Turn on the LED bulb and test for correct lighting.
4. Check if any warning signs show up on the vehicle dashboard. If no warnings occur, the test is finished.

NOTE:

If one of the LED bulbs does not work, it could be attributed to poor contact. Make sure the connection is good. If the problem cannot be solved, swap the left side bulb with the right side bulb and test again.

WARNING:

Please wear work gloves during installation.

Do not switch on the LED bulb until the connection is finished.

If the LED bulb flashes or warnings show up on the vehicle dashboard, please connect the resistors (CANbus) to ensure correct operation.

If any problems still cannot be resolved under the guidance of this manual please feel free to contact our customer support team.

PRECAUTIONS FOR INSTALLATION

- * Be sure not to touch the LED element of the LED bulb.
- * Prevent any type of oil, dirt or moisture from adhering to the product, so as to prevent a potential failure.
- * Bulb installation should be done safely in environments where a large amount of space is available. Before installation, stop the vehicle engine, apply the parking brake, place the shift in the park or neutral position, and remove the key.
- * Be sure not to apply excessive force to the LED bulb during installation. If damage occurs, it may cause a lighting malfunction and other potential failures.
- * After installation, please check whether the high and low beams and other electrical equipment on the dashboard work normally and no warnings occur.
- * Please ensure the LED driver box and cable ties are not below the vehicle's heating system or near moveable components inside the engine compartment, as this may cause damage and a potential failure.
- * Please ensure that the LED driver box and cable ties do not interfere with other components or the engine hood itself.
- * Do not bend the cables excessively, especially near the LED driver or heat sink area.

WARNINGS FOR USE

- * Do not look directly at the operating lamp for any period of time, as this may cause serious eye injury.
- * Do not disassemble or modify the product in any way, as this may damage the product or cause fire and/or personal injury.
- * If there is any abnormal vibration or sound when the vehicle is moving, stop immediately in a safe location and check the vehicle.
- * Do not wash the vehicle with the lights turned on, as sudden changes in temperature may cause an unexpected reaction from the LED bulb.
- * The LED bulb body and LED surface can reach very high temperatures. Do not touch the area with hands or allow any skin contact as it may result in severe burns.
- * During heavy rain or when putting the vehicle through a car wash, condensation may build up inside the bulb compartment due to the difference in temperatures inside and outside the bulb compartment. Please note that this will not affect the overall function of the LED bulb.

INSTALLATION

H1/H4/H7



Remove the socket



Install and fix the socket

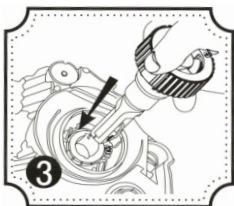

Insert the lamp body as the direction of arrow

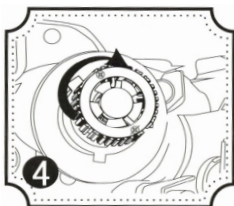

Fix the lamp body by rotate 360° clockwise

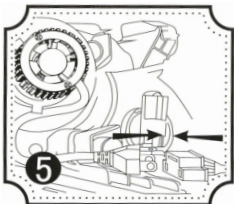

Connect the power line with original car lamp connector

H8/H9/H10/H11/H13/H16JP/P13/9005/9006/9012/PSX26

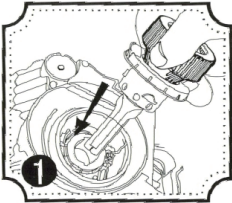

Insert the lamp body as the direction of arrow

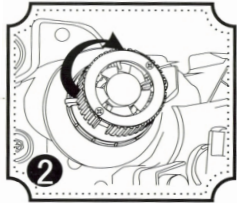

Fix the lamp body by rotate 45° clockwise

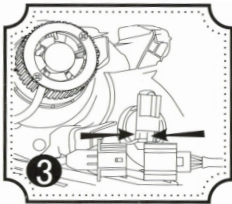

Connect the power line with original car lamp connector

9004/9007/PSX24/H16(EU)

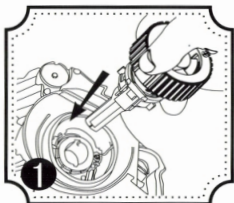

Insert the lamp body as the direction of arrow

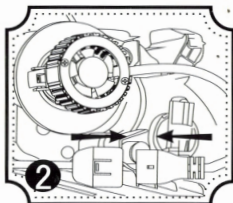

Fix the lamp body by rotate 45° clockwise

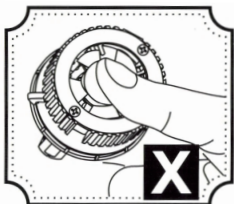

Notice

When installing do not press the fan by your hand avoiding influence the performa of fan.



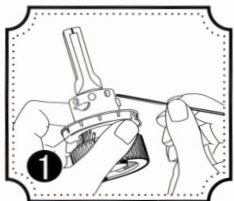

Chuck Adjustment Instruction





The socket of H13/9004/9007 is adjustable for better lighting pattern



TROUBLE SHOOTING

Please follow the below solutions to confirm the defective problems
Before asking for warranty service.

	PHENOMENON	SOLUTION
SEPARATE BULB	 Light off	Defective lamp body: please connect a new lamp body with the original driver, if it works well, then it means the previous lamp body is defective, please cut down the power line of the defective lamp body for warranty.
	 Light off	Defective drive: please connect another new driver with the original lamp body, if it works well, then it means the previous driver is defective, please cut down the power line of the defective driver for warranty.
	 Abormal light	Please connect suitable canbus decoder to solve the canbus problem
	 Flicking	Please connect suitable canbus decoder to solve the canbus problem
	 Flicking	If encounter the situation when lighting up the bulb for some times it do not work suddenly, and then turn off the power start it again work well, please change the dust cover with more space for heat dissipation to solove it.

ALL IN ONE BULB	 Flicking	Please connect suitable canbus decoder to solve the canbus problem
	 Light off	Please make sure of correct installation, if the lamp body is still not work, please cut down the power line of the defective lamp body for warranty.
	 Abormal light	Please connect suitable canbus decoder to solve the canbus problem.
	 Flicking	If encounter the situation when lighting up the bulb for some times it do not work suddenly, and then turn off the power start it again work well, please change the dust cover with more space for heat dissipation to solve it.

Attention:

The following conditions are beyond warranty scope.

1. Canbus problem: when replace the original halogen bulb with LED bulb, some vehicles may meet with canbus problem like light flickering etc, please connect suitable decoder to solve the cabus problems.
2. Man-made reason: man-made reason lead to broken led chip, chapped wire, user modify or repair the bulb themselves etc.
3. Installation problem: some vehicles may can not install our product because of small installation space or installation position doesn't fit etc.
4. Natural dlsaster: damage because of irresistible natural disaster like earthquake, flood etc.

NOTICE

1. The resistor (CANbus) is polarity sensitive. If the LED bulbs do not function properly after installation, please reverse the resistor (CANbus) male connector 180 degrees and try again
2. If the problem still cannot be resolved after using the resistors (CANbus) or if you have any questions, please contact our customer support team.

support@dbpowershop.com

1-855-666-9888

- * This device complies with Part 15 of the FCC Rules. Operation is subject to the following two conditions: (1) this device may not cause harmful interference, and (2) this device must accept any interference received, including interference that may cause undesired operation.”

 **24/7 LIVE CHAT
SUPPORT**

To learn more about **DBPOWER**,
please visit us at:

www.dbpowershop.com



or

Scan QR Code & Start Chatting



FC **CE** **DOT** **RoHS** 
COMPLIANT

Model NO. F16

Made in China