

# MENDOZA 902

Firepit



## EQUIPMENT SHEET | MENDOZA 902 Firepit

### AVAILABLE SIZES

- Equipment available in 2 sizes: from 985mm/38,77" to 1185mm/46,65".

| Equipment Measurement (Firebox + Grill)             |
|---|
| 400+585mm/15,74+23,03" (total length 985mm/38,77")  |
| 400+785mm/15,74+30,90" (total length 1185mm/46,65") |

### BENEFITS

- Stainless steel structure, ensuring robustness, corrosion resistance and excellent durability to the equipment;
- Steering wheel with antireverse technology (grille remains at the desired height without the need for locking);
- Fire box for bench with refractory bricks and thermal insulation.

### EQUIPMENT INSTALLATION

- Easy installation, just place the equipment inside the bench;
- Do not install the product exposed to the weather or sea air.

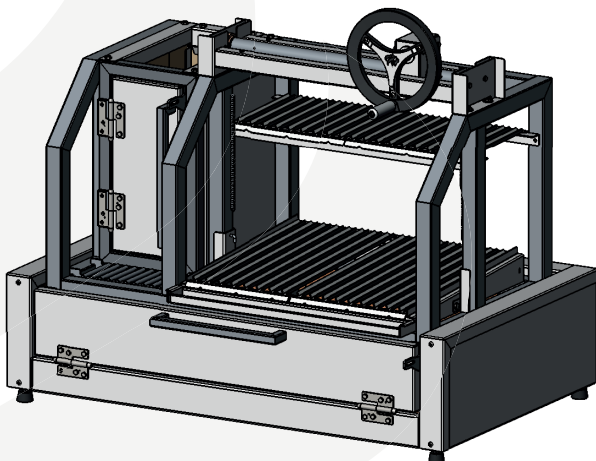

Example of the photo: Parrilla Mendoza 902 - 400+585mm/15,74+23,03"

## FIREPIT INSTALLATION

PROJECTED VIEW

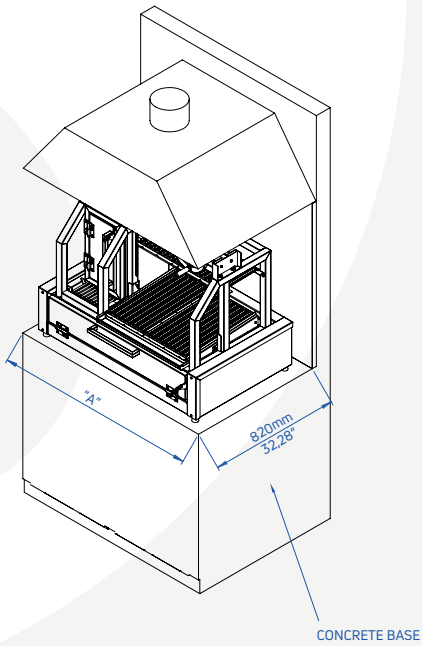

CUTTING SIDE VIEW

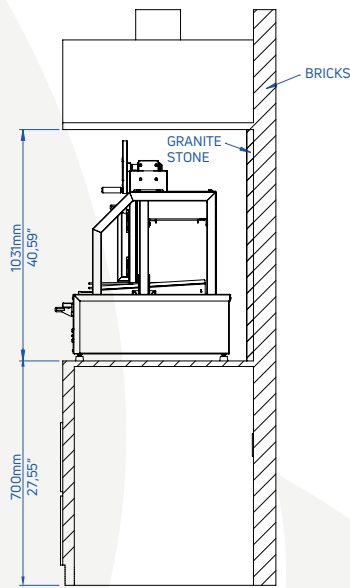

FRONT VIEW

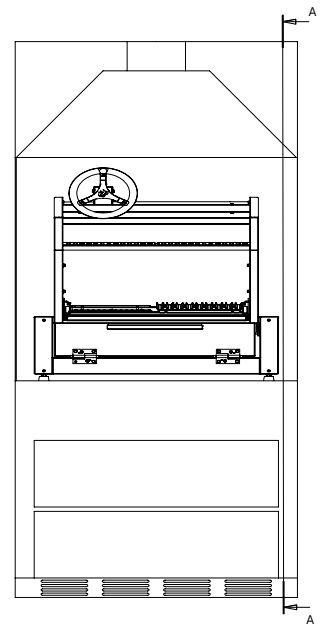

MEASUREMENT TABLE A

| Equipment Measurement                               | Measure A     |
|---|---------------|
| 400+585mm/15,74+23,03" (total length 985mm/38,77")  | 1320mm/51,96" |
| 400+785mm/15,74+30,90" (total length 1185mm/46,65") | 1520mm/59,84" |

- All dimensions in millimeters (mm) and inches (").
- Other dimensions upon request.
- It is recommended to install a hood with a suction system to eliminate gases and smoke generated by burning coal and to remove heat generated inside the bench.
- The width of the hood must be greater than the width of the equipment.

## EQUIPMENT PACKAGING

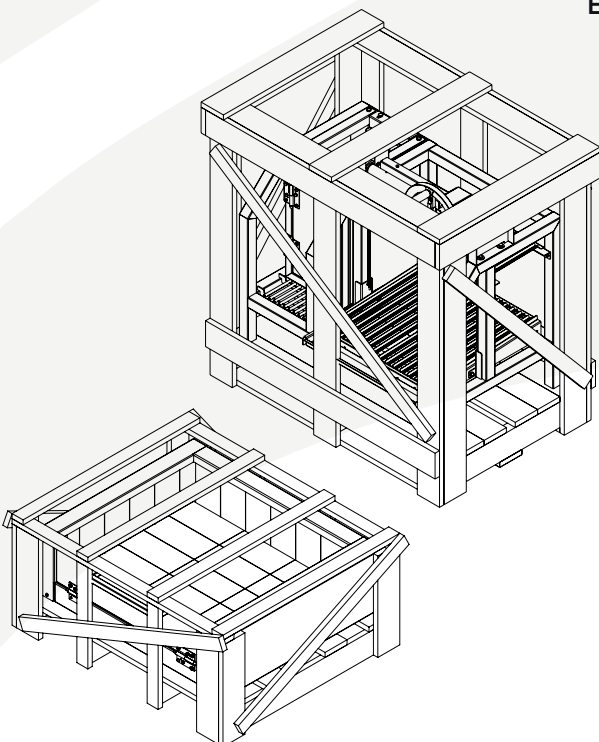

WEIGHTS AND MEASURES CONSIDERING STANDARD MEASUREMENT

| Size of Mendoza 902 | Weight (net) | Dimensions with packaging (in millimeters and inches) | Weight (gross) |
|---------------------|--------------|---|----------------|
| 985mm/38,77"        | 241Kg/531lb  | 1200 x 750 x 1060mm/47,24 x 29,52 x 41,73"            | 282Kg/621lb    |
| 1185mm/46,65"       | 290Kg/639lb  | 1400 x 750 x 1060mm/55,11 x 29,52 x 41,73"            | 339Kg/747lb    |

WEIGHTS AND MEASURES CONSIDERING STANDARD MEASUREMENT

| Size of Firepit | Weight (net) | Dimensions with packaging (in millimeters and inches) | Weight (gross) |
|-----------------|--------------|---|----------------|
| 1120mm/44,09"   | 165Kg/364lb  | 1290 x 970 x 490mm/50,78 x 34,25 x 19,29"             | 200Kg/440lb    |
| 1320mm/36,22"   | 185Kg/409lb  | 1490 x 870 x 490mm/58,66 x 34,25 x 19,29"             | 223Kg/491lb    |



## OPTIONAL ACCESSORIES

To make your barbecue even better, Scheer offers you accessories of the highest quality and performance.



Charcoal Spreader

## IMPORTANT

- It is possible to use combustible materials, as long as they are inside the firebox;
- Burning wood must only be done inside the firebox, allowing the use of firewood, wood or sticks on the barbecue.

### SCHEER CHURRASQUEIRAS E PARRILLAS

Address: KM 148, BR-116, 17204 | CEP 95054-780  
Sagrada Família | Caxias do Sul | RS | Brasil

Website: [www.scheer.com.br](http://www.scheer.com.br)  
Contact: +55 54 3224.3066  
E-mail: [scheer@scheer.com.br](mailto:scheer@scheer.com.br)



### USA:

+1 9544152161 – ZAFILL.COM

### EUROPE:

+31 6 82902464 – ABMBBQ.NL

### JAPAN:

+81 3 3280 1035 – SCHEER.JP

### AUSTRALIA:

+61 2 9986 2004 – PROLINEEQUIPMENT.COM.AU

### SOUTH AFRICA:

+27 11 568 4598 – SCHEER.CO.ZA

