



# sanitame

**COMMERCIAL GRADE  
HAND SANITIZER DISPENSER STATION  
FOOT PEDAL OPERATED**

## **ASSEMBLY INSTRUCTIONS**

MODEL NUMBERS:

**MKC-HSS-P-2020-WB-003**

**MKC-HSS-P-2020-BL-004**

**MKC-HSS-P-2020-RR-002**

**MKC-HSS-P-2020-WB-001**



**Thank you for choosing SANITAME!**

**PLEASE READ BEFORE RETURNING THIS PRODUCT FOR ANY REASON.**

If you have question or experience a problem with your SANITAME Hand Sanitizer Station purchase, go to [sanitame.com](http://sanitame.com)

If you can't find the answer or do not have access to the Internet, call 800-999-4521 from 10:30am to 6:30pm, EST Mon-Fri to speak with an agent.

Please have the model number available when you call.

**SAVE THIS MANUAL FOR FUTURE REFERENCE.**

# **ASSEMBLY & SET UP**

**IMPORTANT:  
THE UNIT COMES 3 DIFFERENT HOLDER TYPES  
TO ACCOMODATE:**

- 1 LITER 32OZ. CONTAINERS**
- HALF GALLON CONTAINERS**
- ONE GALLON CONTAINERS**

**PLEASE USE THE CORRECT ACTUATOR TAB AND  
CONTAINER HOLDERS FOR YOUR PREFERRED CONTAINER CHOICE**

# ASSEMBLY & SET UP

## DIAGRAM (FRONT VIEW) 32 OZ. - 1 LITER BOTTLE USAGE

ID	QTY	DESCRIPTION
2	2	Base Legs
3	1	Actuator Rod
4	1	1 Liter Container (not included)
5	1	1 Liter Container Holder (Bottom)
6	1	1 Liter Container Holder (Top)

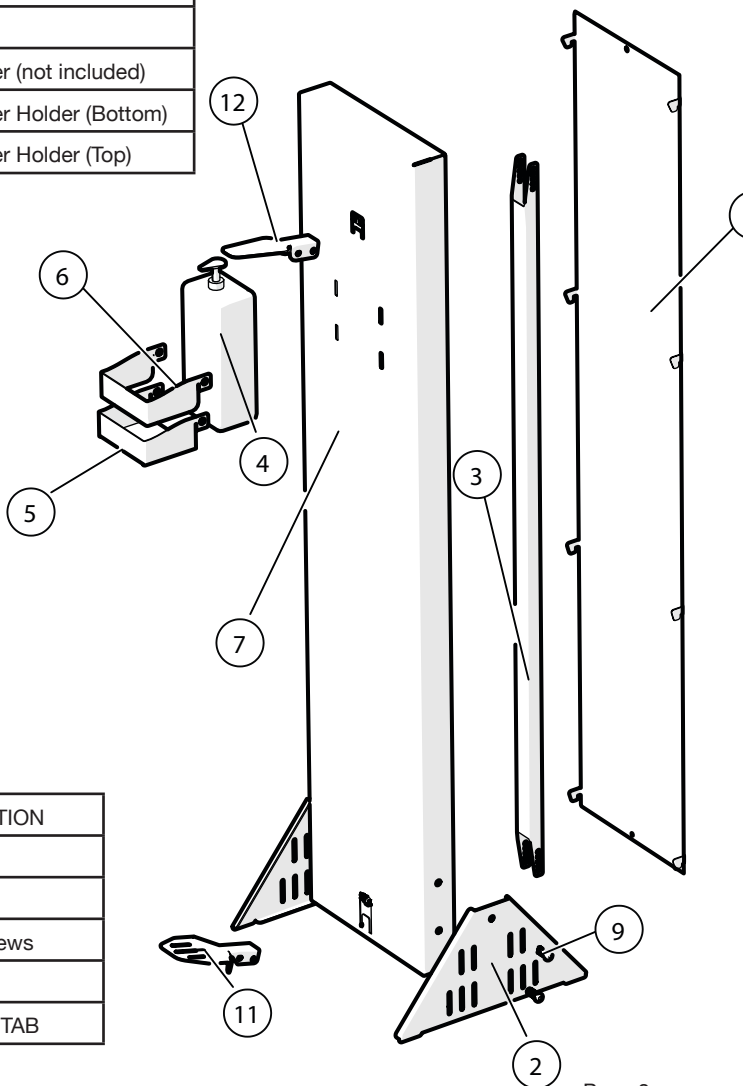

ID	QTY	DESCRIPTION
7	1	Station Body
8	1	Back Cover
9	4	M8x20mm Screws
11	1	Foot Pedal
12	1	Short Actuator TAB

# ASSEMBLY & SET UP

## DIAGRAM (FRONT VIEW) HALF GALLON BOTTLE USAGE

ID	QTY	DESCRIPTION
2	2	Base Legs
3	1	1/2 Gallon Container (not included)
4	1	1/2 Gallon Container Holder (Bottom)
5	1	1/2 Gallon Container Holder (Top)
6	1	Station Body

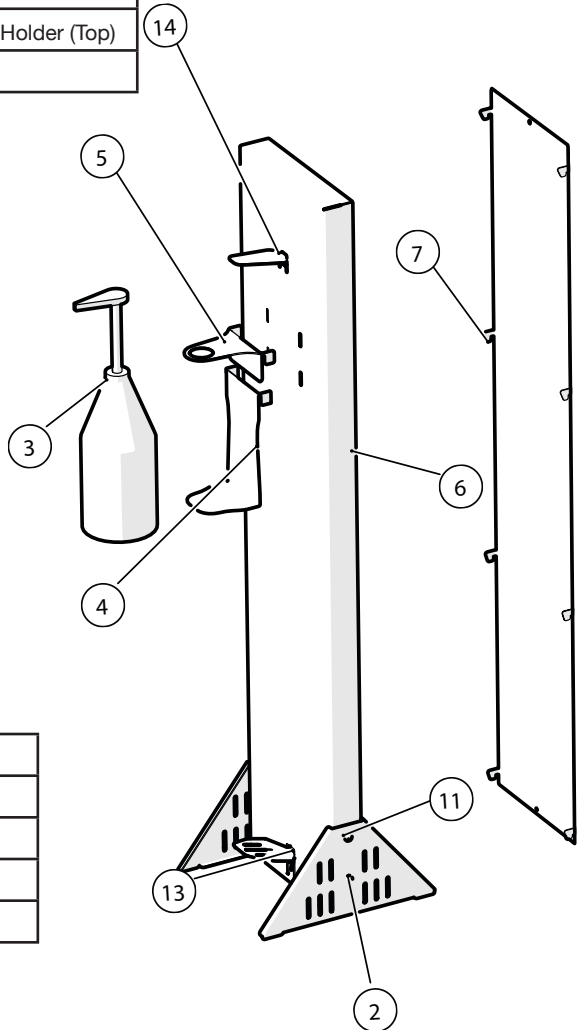

ID	QTY	DESCRIPTION
7	1	Back Cover
11	4	M8x20mm Screws
13	1	Foot Pedal
14	1	Long Actuator TAB

# ASSEMBLY & SET UP

## DIAGRAM (FRONT VIEW) 1 GALLON BOTTLE USAGE

ID	QTY	DESCRIPTION
1	1	1 Gallon Container Holder (Bottom)
2	1	Actuator Rod
3	2	Base Legs
4	1	1 Gallon Container (not included)
5	1	Station Body
6	1	Back Cover

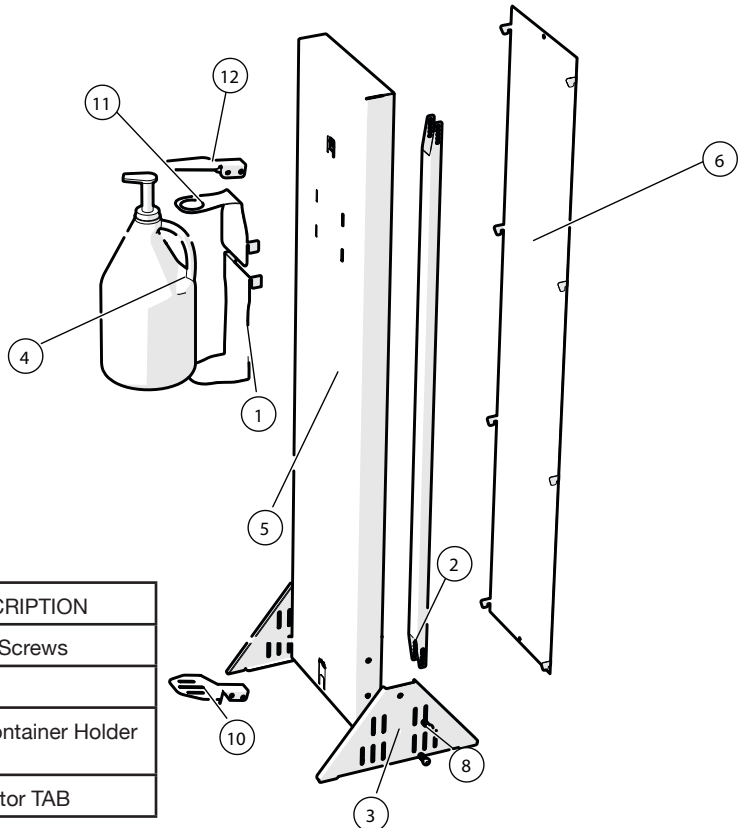

ID	QTY	DESCRIPTION
8	4	M8x20mm Screws
10	1	Foot Pedal
11	1	1 Gallon Container Holder (Top)
12	1	Long Actuator TAB

# ASSEMBLY & SET UP

## DIAGRAM (REAR VIEW)

ID	QTY	DESCRIPTION
2	2	Base Legs
3	1	Station Body
4	1	1/2 Gallon Container Holder (Bottom)
5	1	1/2 Gallon Container Holder (Top)
6	1	Actuator Rod
7	2	M5 Screws
8	4	M6x45mm Screws
9	4	M6 Nuts
10	4	M8x20mm Screws
11	1	Foot Pedal

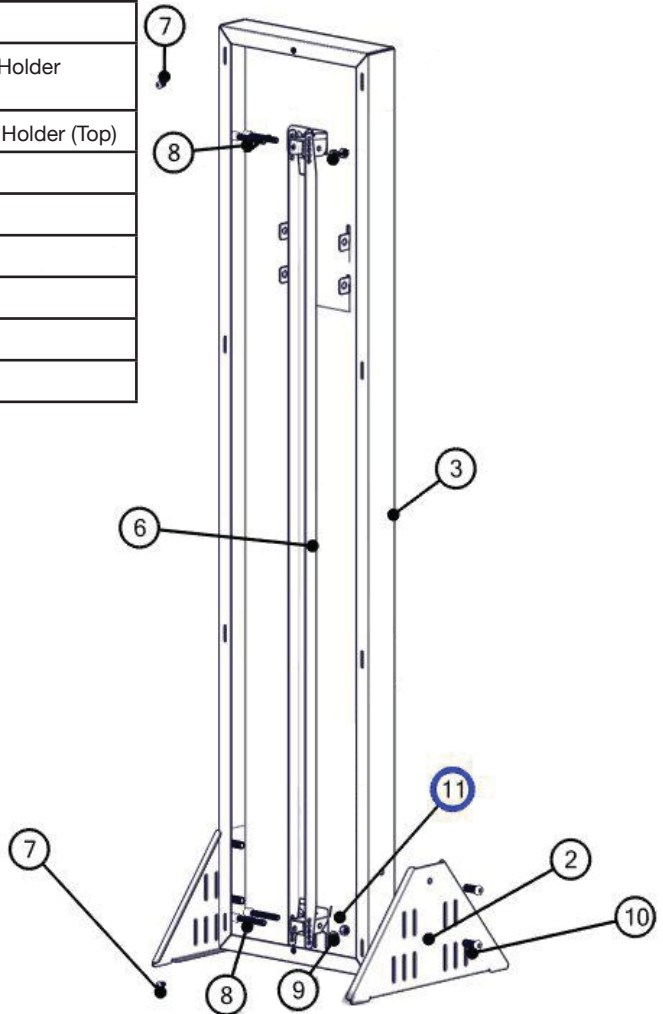

# ASSEMBLY & SET UP

## DIAGRAM (DETAIL VIEW) Pedal Assembly & Actuator Tab

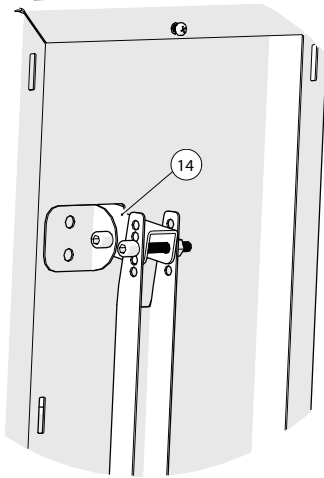

ID	QTY	DESCRIPTION
1	1	Actuator Rod
2	4	M8x20mm Screws
9	4	M6x45mm Screws
11	2	Base Legs
13	1	Foot Pedal
14	1	Actuator Tab

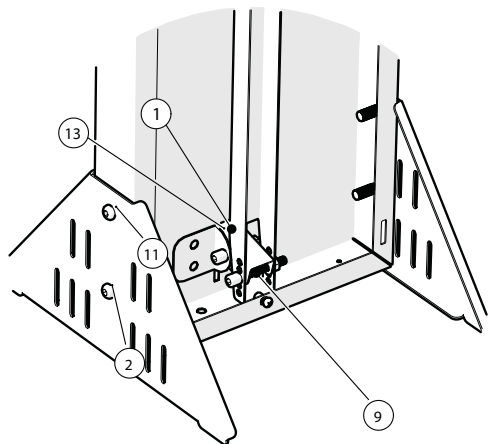

# ASSEMBLY & SET UP

## STEP 1 - OPENING THE BODY & PREPARATION



Fig 1.

1- Remove the screw on the back cover to expose parts.  
(See Fig 2)

2- Open the back cover of the body,  
and remove the components.  
(See Fig 3)

3- Lay down all parts on a flat surface.

### NOTE:

There are 2 pump push actuator tabs, and 3 different container holders for your convenience on using your preferred container size.  
(1 Liter - 32oz., Half Gallon, One Gallon.)

### REQUIRED TOOLS:

- Screwdrivers (medium size phillips)

\*Container Bottles not included.



Fig 2.



Fig 3.



# ASSEMBLY & SET UP

## STEP 2 - INSTALLATION OF LEGS

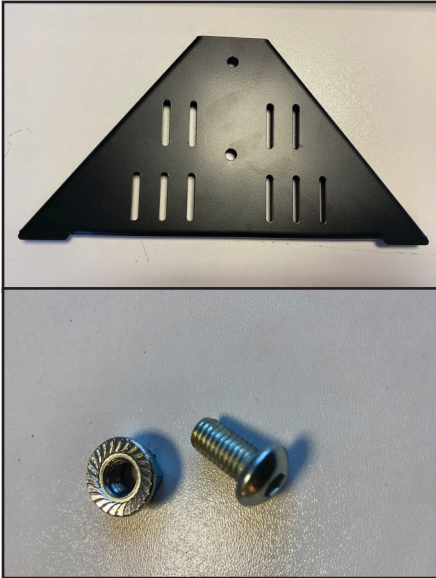

Fig 1.

1- Locate and prepare two legs, 4 screws and 4 nuts, and the main body of the unit.

(See Fig 1)

2- Insert the screws to the legs.

(See Fig 2)

3- Insert the legs to the holes on the sides of the body.

(See Fig 2)

4- Tighten the screws and nuts using the wrench and allen key.

(See Fig 3)

5- Repeat steps for both sides.

### REQUIRED TOOLS:

- Allen Key (included)
- Mini Wrench (included)

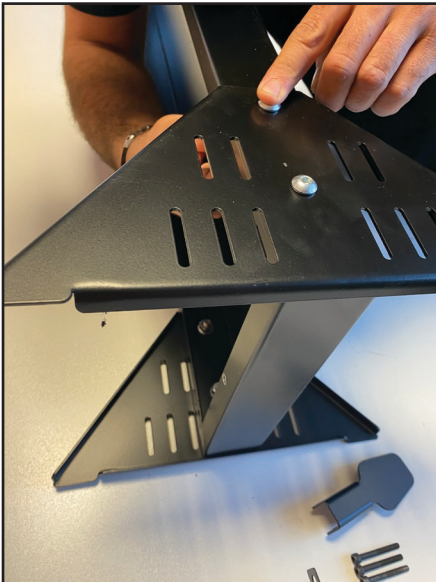

Fig 2.



Fig 3.

# ASSEMBLY & SET UP

## STEP 3 - INSTALLATION THE PEDAL



Fig 1.

1- Insert the pedal (13) mechanism into the body from the groove.  
(See Fig 2)

2- Insert the long screw and nut into the first hole of the pedal and install.  
(See Fig 3)

### IMPORTANT:

DO NOT OVERTIGHTEN THE SCREW AS THE PEDAL MUST BE ABLE TO MOVE UP & DOWN FREELY

(See Fig 3)

### REQUIRED TOOLS:

- Allen Key (included)
- Mini Wrench (included)



Fig 2.

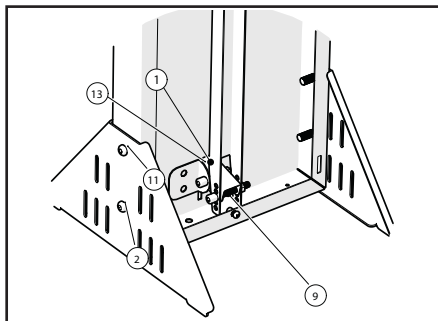

Fig 3.

# ASSEMBLY & SET UP

## STEP 4 - INSTALLATION THE ACTUATOR TAB



Fig 1.

1- Select desired pump actuator tab for your use:

-**LONG** Actuator tab version is designed for **Half Gallon & 1 Gallon** Containers.

-**SHORT** Actuator tab version is designed for **1 Liter - 32 oz.** Containers.

(See Fig 1)

2- Insert the long screw and nut into the first hole of the actuator tab and install.

(See Fig 3 - 14)

3- Make sure actuator tab mechanism can move up and down easily.

(See Fig 2)

### **IMPORTANT:**

DO NOT OVERTIGHTEN THE SCREW AS THE PEDAL MUST BE ABLE TO MOVE UP & DOWN FREELY.

(See Fig 3)



Fig 2.

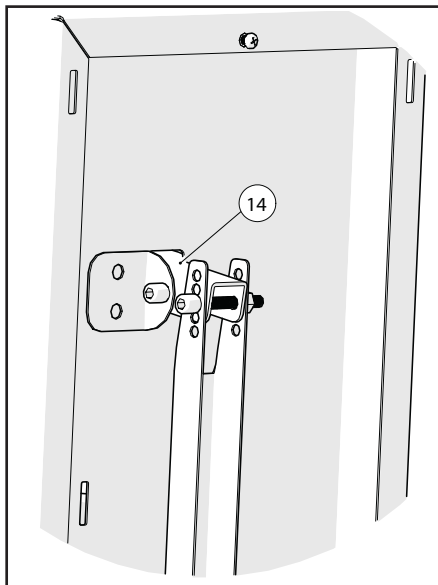

Fig 3.

# ASSEMBLY & SET UP

## STEP 5 - INSTALLATION ACTUATOR ROD



Fig 1.

- 1- Place the Actuator Rod as shown on picture (See Fig 1)
- 2- Insert the long screws and nuts into the first holes of the rod, connecting the Pedal Assembly and Actuator Rod (See Fig 1)
- 3- Install the screw and nut. (See Fig 3)
- 4- Make sure rod mechanism can move up and down easily. (See Fig 2)

### **IMPORTANT:**

DO NOT OVERTIGHTEN THE SCREW AS THE PEDAL & ACTUATOR TAB MUST BE ABLE TO MOVE UP & DOWN FREELY.

(See Fig 2)



Fig 2.



Fig 3.

# ASSEMBLY & SET UP

## STEP 6- INSTALLATION CONTAINER HOLDERS



Fig 1.

There are 3 sets of container holders  
Each set consists of 2 components.

- **1 Liter - 32 OZ** version.
- **Half Gallon** version.
- **One Gallon** version.

1- Select desired holders.

(See Fig 2)

2- Insert the top and bottom assembly  
into slots of the desired height.

(See Fig 3)

3-Make sure the mechanism can  
move freely up and down

(See Fig 3)

### **IMPORTANT:**

Mechanism will not work properly without a  
container with a pump in place. It will stay down  
when there is no container in place. This is Normal. (See Fig 1)



Fig 2.



Fig 3.

# ASSEMBLY & SET UP

## STEP 7 - PLACEMENT OF CONTAINER BOTTLE



Fig 1.



Fig 2.

1 - Place a full sanitizer bottle into the holder.

-For 1 Liter 32oz. Bottles you can just place them in the holder.

-Half Gallon & One Gallon Bottles require the holder to be secured between neck of the bottle and the pump nozzle.

2 - Check if the operation of the pedal is functioning.

**NOTE:**

Adjust Actuator rod crew holes, and/or holder slots if necessary.



Fig 3.

# ASSEMBLY & SET UP

## STEP 8- INSTALLATION OF BACK COVER



Fig 1.

1- Insert the back the back cover in the same way you removed before installation, and slide down on the slots.

Make sure the teeth of the slot tabs look down. and they all align in slots (See Fig 2)

2- Align the top and bottom screw holes. (See Fig 1)

4- Screw and tighten. (See Fig 3)

### REQUIRED TOOLS:

- Allen Key (included)
- Mini Wrench (included)



Fig 2.



Fig 3.

## PRODUCT VISUALS

### HAND SANITIZER DISPENSER STATION with 1 liter/32oz. Holders & Container





# PRODUCT VISUALS

## HAND SANITIZER DISPENSER STATION with 1 Gallon. Holders & Container



# PRODUCT VISUALS

## HAND SANITIZER DISPENSER STATION with 1/2 Gallon. Holders & Container



# TROUBLESHOOTING & WARRANTY

## BEFORE YOU CALL FOR SERVICE

### IF THE DISPENSER FAILS TO OPERATE:

- A) Check to make sure if you have followed all the assembly steps
- B) Check to see if you have a working sanitizer container with operational pump and liquid inside. Check proper operation of the sanitizer before placing in slot.
- C) Make sure you are using the correct SET of container holders.
- D) Make sure the screws holding the pedal, actuator tab. and actuator rod are not overtighten, and mechanism can move easy, and freely.

IF NONE OF THE ABOVE SOLVES THE PROBLEM, CONTACT SANITAME BY **support@sanitame.com** WE REPLY AND RETURN ALL SUPPORT INQUIRIES WITHIN 48 HOURS DURING WEEKDAYS.

## CUSTOMER SERVICE

## IMPORTANT

### DO NOT RETURN THIS PRODUCT TO THE STORE

If you have a problem with this product please contact the Sanitame Customer Satisfaction Center at 800-999-4521 or [support@sanitame.com](mailto:support@sanitame.com)

### DATED PROOF OF PURCHASE, MODEL # REQUIRED FOR WARRANTY SERVICE

### LIMITED WARRANTY

MK Creatives LLC. warrants to the original purchaser that the product will be free from defects in material parts and workmanship for the period designated for this product. The warranty commences the day the product is purchased and covers up to a period of 1 year for labor and parts (manufacturer defects only.)



sanitame

*“For a clean and healthier environment”*

SANITAME logos and product names and the color scheme are trademarks of MK Creatives Limited Liability Company. All rights reserved.

Product in this box may differ slightly from that pictures. Does not affect function. Not all accessories shown in photography are included in this package.

MK Creatives LLC, 8000 River Road Unit 9C, North Bergen, NJ 07047  
October 2020 - V1.0

Printed in Turkey