



# SPA DESIGNER HUMIDIFIER LAMP

USER MANUAL USER MANUAL USER MANUAL USER MANUAL USER MANUAL



To open: Hold the bottom of the humidifier and twist the top clockwise.

To close: Twist the top component counter clockwise.

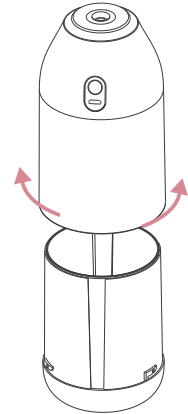

Charging indicator

Micro-USB port

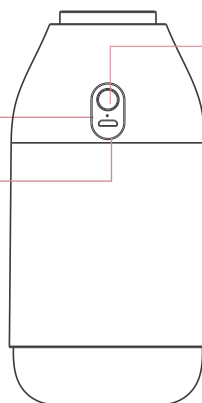

Back of product

## On/off button

### HUMIDIFIER MODE

Press once to turn the humidifier on.

Press again for intermittent spray mode.

Press a third time to turn the humidifier off.

### LAMP MODE

Press and hold the button for 1.5 seconds to turn on the built-in lamp (bright light setting).

Press and hold again for the low light setting.

Press and hold a third time to turn the lamp off.

The lamp will automatically turn off after 6 hours.

## Instructions to replace cotton wick:

1. Remove the bottom water tank. Pull down the plastic tube to reveal cotton wick inside (do not lose the inner spring inside the tube - keep it where it is)
2. Remove and replace cotton wick. Then, place the new cotton wick inside the plastic tube and twist into the humidifier.

\* We recommend replacing the cotton wick every month. Additional cotton wicks can be purchased directly from [multitasky.com](http://multitasky.com).

## WARNINGS

Do not touch the mist diffusing hole to prevent congestion.

When replacing the cotton wick, do not remove the inner spring (humidifier will not work without the inner spring).

Do not add hot water and do not fill up the container fully (90% full is the maximum level)

Wait 10-15 minutes for the cotton wick to soak up water fully before using

Only use tap water - not filtered or distilled.

Still have questions?  
E-mail us at [support@multitasky.com](mailto:support@multitasky.com)!