



G80 & G100 STEEL LIFTING COMPONENTS

G80 Master Links	25
G80 Connecting Links & Hooks	26 - 30
G80 Trigger, Load Pin, and Pin & Sleeve Kits	31
G80 Insulated Swivels & Coupling Components	32 - 34
G100 Master Links	35
G100 Connecting Links & Hooks	36 - 41
G100 Trigger, Load Pin, and Pin & Sleeve Kits	41 - 42
G80 Weld-On Bucket Hooks & Lifting Points	43 - 45
Lifting Eye Key Points	46 - 47
Swivel Hoist Rings	48 - 51

LINK - MASTER LINK, GRADE 80

- Material: Alloy Steel, Grade 80
- Standard: EN 1677-4 / ASTM A952/952M
- Finish: Powder Coated, Yellow
- Design Factor: 5:1
- Identification: Trademark, Size/WLL,
- Batch Code, Grade

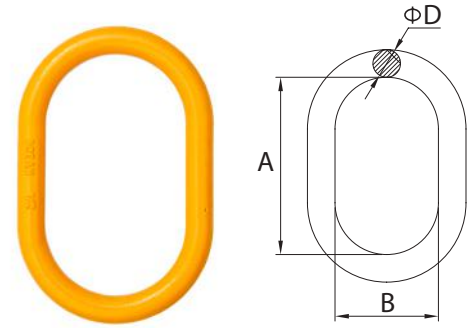

Trade Size (in)	WLL (lb)	Chain Size (in)		I.L. (in)	I.W. (in)	Dia. (in)	Wt. / ea. (lb)	Qty. / Box	Price / ea.	Part Number
		1-Leg	2-Leg							
1/2"	7 400	5/16"	7/32"	4.72	2.76	0.55	1.1	50	28.13	3-1/2"ML
5/8"	9 000	3/8"	5/16"	5.51	3.15	0.67	1.6	30	42.60	3-5/8"ML
3/4"	12 300	1/2"		5.91	3.54	0.85	2.4	20	57.90	3-3/4"ML
7/8"	15 200	1/2"	3/8"	6.30	3.74	0.87	3.5	16	73.28	3-7/8"ML
1"	26 000	5/8"		7.48	4.33	0.98	5.1	7	90.55	3-1"ML
1-1/8"	30 000	5/8"	1/2"	7.09	4.13	1.10	5.9	8	112.05	3-1-1/8"ML
1-1/4"	39 100	3/4"		7.87	4.72	1.18	7.6	5	139.05	3-1-1/4"ML
1-3/8"	42 000	7/8"	5/8"	9.45	5.51	1.34	11.7	4	255.38	3-1-3/8"ML
1-1/2"	61 100	1"		9.84	5.91	1.50	15.8	3	340.50	3-1-1/2"ML

LINK - CONNECTING LINK, GRADE 80

- Material: Alloy Steel, Grade 80
- Standard: EN 1677-1/ ASTM A952/952M
- Finish: Powder Coated, Yellow
- Design Factor: 4:1
- Identification: Trademark, Size/WLL, Batch Code, Grade

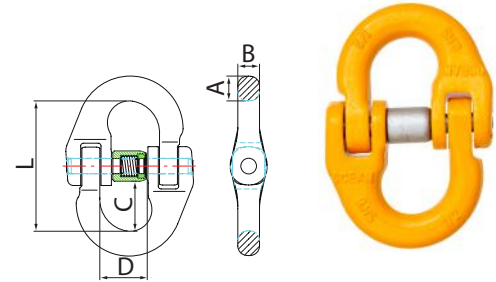

Grade 80 Chain (in)	WLL (lb)	Dimensions (in)					Wt. / ea. (lb)	Qty. / Box	Price / ea.	Part Number
		A	B	C	D	L				
9/32"	4 500	0.39	0.34	0.91	0.73	2.30	0.33	150	14.48	3-7-8CL
3/8"	7 100	0.52	0.45	1.04	1.00	2.72	0.71	50	16.95	3-10CL
1/2"	12 000	0.67	0.62	1.42	1.18	3.54	1.68	35	29.28	3-13CL
5/8"	18 100	0.75	0.75	1.50	1.43	3.94	2.73	20	47.10	3-16CL
3/4"	28 300	0.93	0.87	1.77	1.67	4.76	4.21	12	85.10	3-18-20CL
7/8"	34 200	1.11	0.94	2.38	1.94	6.06	7.82	6	140.75	3-22CL
1"	47 700	1.22	1.20	2.56	2.18	6.54	10.80	3	234.05	3-26CL
1-1/4"	72 300	1.54	1.42	3.15	2.75	8.07	20.28	2	429.88	3-32CL

HOOK - CLEVIS GRAB HOOK, GRADE 80

- Material: Alloy Steel, Grade 80
- Standard: EN 1677-1/ ASTM A952/952M
- Finish: Powder Coated, Yellow
- Design Factor: 4:1
- Identification: Trademark, Size/WLL, Batch Code, Grade

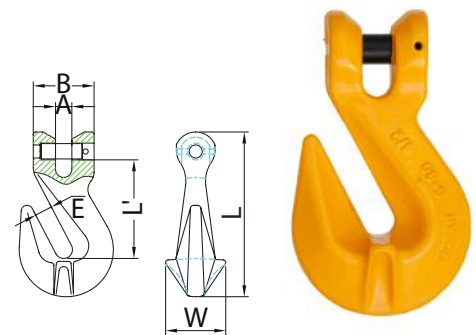

Grade 80 Chain (in)	WLL (lb)	Dimensions (in)							Wt. / ea. (lb)	Qty. / Box	Price / ea.	Part Number
		E	A	B	W	L	L*	M				
9/32"	4 500	0.41	0.37	1.54	1.36	3.50	2.09	2.09	0.71	70	13.20	3-7-8CGH
3/8"	7 100	0.51	0.49	1.83	1.81	5.04	2.95	2.80	1.61	30	25.38	3-10CGH
1/2"	12 000	0.65	0.59	2.09	2.26	6.44	3.62	3.78	3.53	15	54.80	3-13CGH
5/8"	18 100	0.75	0.73	2.74	2.91	7.22	3.90	4.45	6.17	8	76.80	3-16CGH
3/4"	28 300	0.94	0.91	3.19	2.91	8.62	4.84	5.63	11.02	4	167.30	3-18-20CGH
7/8"	34 200	1.06	1.06	3.58	3.54	10.00	5.51	6.30	13.89	4	235.95	3-22CGH
1"	47 700	1.18	1.18	4.61	4.02	12.17	7.36	7.13	31.96	2	748.75	3-26CGH
1-1/4"	72 300	1.61	1.38	5.91	5.12	14.88	8.39	8.66	52.90	1	2,052.50	3-32CGH

HOOK - CLEVIS SLING HOOK, GRADE 80

- Material: Alloy Steel, Grade 80
- Standard: EN 1677-5/ASTM A952/952M
- Finish: Powder Coated, Yellow
- Design Factor: 4:1
- Identification: Trademark, Size/WLL, Batch Code, Grade

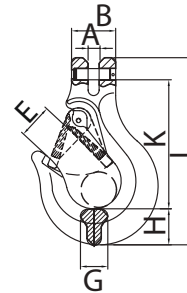

Grade 80 Chain (in)	WLL (lb)	Spare Latch Kit		Dimensions (in)							Wt. / ea. (lb)	Qty. / Box	Price / ea.	Part Number
		Price / ea.	Part #	A	B	E	G	H	K	L				
9/32"	4 500	8.90	3-7-8LK	0.37	1.77	1.02	0.75	0.91	3.84	5.43	1.3	30	24.40	3-7-8CSH
3/8"	7 100	12.18	3-10LK	0.47	1.71	1.30	0.91	1.14	4.72	6.87	2.6	15	43.70	3-10CSH
1/2"	12 000	18.95	3-13LK	0.59	2.24	1.57	1.10	1.50	5.79	8.39	5.1	8	60.00	3-13CSH
5/8"	18 100	25.50	3-16LK	0.73	2.64	1.73	1.54	1.65	6.65	9.65	8.4	6	127.15	3-16CSH
3/4"	28 300	31.08	3-18-20LK	0.98	3.94	2.13	1.85	2.01	7.48	12.76	14.8	4	271.25	3-18-20CSH
7/8"	34 200	39.50	3-22LK	0.98	3.58	2.60	1.97	2.44	8.39	12.60	20.21	2	327.50	3-22CSH
1"	47 700	53.40	3-26LK	1.18	4.61	3.35	2.36	2.95	9.91	15.31	32.99	2	460.00	3-26CSH
1-1/4"	72 300	98.75	3-32LK	1.38	5.91	4.06	2.60	3.46	12.48	18.90	59.51	1	1,262.50	3-32CSH



HOOK - SELF LOCKING SWIVEL HOOK

- Material: Alloy Steel, Grade 80
- Standard: EN 1677-3/ ASTM A952/952M
- Finish: Powder Coated, Yellow
- Design Factor: 4:1
- Identification: Trademark, Size/WLL, Batch Code, Grade

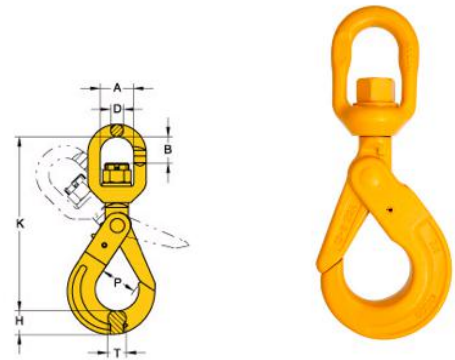

Grade 80 Chain (in)	WLL (lb)	Dimensions (in)							Wt. / ea. (lb)	Qty. / Box	Brass Bushing	
		A	B	D	H	K	P	T			Price / ea.	Part Number
1/4-5/16	4 500	1.42	1.14	0.51	0.94	7.32	1.34	0.79	2.6	12	90.23	3-7-8SSLH
3/8	7 100	1.8	1.49	0.62	1.19	8.9	1.77	1.02	4.4	7	134.75	3-10SSLH
1/2	12 000	1.81	1.86	0.83	1.57	11	2.01	1.26	9	4	228.75	3-13SSLH
5/8	18 100	2.36	2.16	0.91	1.93	13	2.44	1.3	15.9	3	351.90	3-16SSLH
3/4	28 300	2.91	3.23	1.02	2.36	15.28	2.76	2.09	24.9	2	812.50	3-18-20SSLH
7/8	34 200	3.82	3.94	1.3	2.48	17.99	3.14	2.24	39.5	1	1,455.00	3-22SSLH

HOOK - SELF LOCKING EYE HOOK, GRADE 80

- Material: Alloy Steel, Grade 80
- Standard: EN 1677-3/ ASTM A952/952M
- Finish: Powder Coated, Yellow
- Design Factor: 4:1
- Identification: Trademark, Size/WLL, Batch Code, Grade

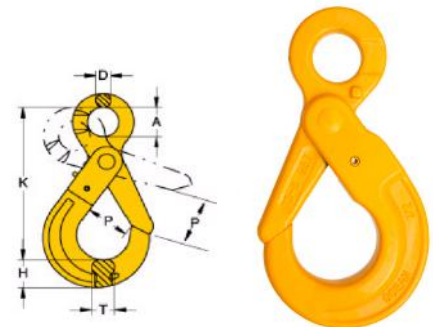

Grade 80 Chain (in)	WLL (lb)	Dimensions (in)						Wt. / ea. (lb)	Qty. / Box	Price / ea.	Part Number
		A	D	H	K	P	T				
1/4 - 5/16	4 500	0.98	0.43	1.02	5.35	1.34	0.79	1.8	20	44.60	3-7-8SLEH
3/8	7 100	1.26	0.51	1.24	6.57	1.73	1.02	3.3	15	69.58	3-10SLEH
1/2	12 000	1.57	0.63	1.65	8.15	2.01	1.18	6.6	8	131.20	3-13SLEH
5/8	18 100	1.97	0.83	2.2	9.92	2.36	1.3	12.5	4	276.75	3-16SLEH
3/4	28 300	2.36	0.91	2.56	11.42	2.76	2.09	22.2	2	478.00	3-18-20SLEH
7/8	34 200	2.76	0.94	2.8	12.56	3.15	2.24	24	2	740.00	3-22SLEH

HOOK - SELF LOCKING CLEVIS HOOK, GRADE 80

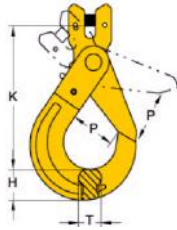

- Material: Alloy Steel, Grade 80
- Standard: EN 1677-3/ ASTM A952/952M
- Finish: Powder Coated, Yellow
- Design Factor: 4:1
- Identification: Trademark, Size/WLL, Batch Code, Grade

Grade 80 Chain (in)	WLL (lb)	Dimensions (in)					Wt. / ea. (lb)	Qty. / Box	Price / ea.	Part Number
		A	P	T	H	K				
1/4 - 5/16	4 500	0.37	1.34	0.79	0.94	4.65	2.07	25	45.25	3-7-8SLCH
3/8	7 100	0.49	1.73	1.02	1.18	5.59	3.1	15	73.20	3-10SLCH
1/2	12 000	0.59	2.05	1.26	1.56	7.01	6.2	8	147.50	3-13SLCH
5/8	18 100	0.73	2.36	1.30	1.97	8.31	12.3	4	298.50	3-16SLCH
3/4	28 300	0.98	2.76	2.09	2.64	9.84	19.8	2	464.00	3-18-20SLCH

HOOK - FOUNDRY EYE HOOK, GRADE 80

- Material: Alloy Steel, Grade 80
- Standard: EN 1677-1/ ASTM A952/952M
- Finish: Powder Coated, Yellow
- Design Factor: 4:1
- Identification: Trademark, Size/WLL, Batch Code, Grade

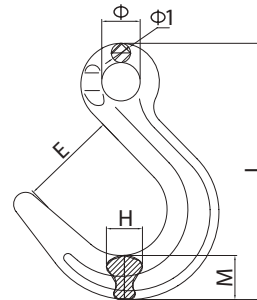

Grade 80 Chain (in)	WLL (lb)	Dimensions (in)						Wt. / ea. (lb)	Qty. / Box	Price / ea.	Part Number
		E	H	M	Φ	Φ1	L				
3/8"	7 100	2.87	0.98	1.18	1.24	0.59	7.76	3.00	12	36.75	3-3/8FEH
1/2"	12 000	3.54	1.30	1.54	1.73	0.75	9.37	5.66	8	82.25	3-1/2FEH
5/8"	18 100	4.13	1.46	1.65	1.93	0.87	10.87	8.73	4	117.63	3-5/8FEH
3/4"	28 300	4.49	1.81	2.24	2.36	1.02	12.83	16.13	3	228.23	3-3/4FEH

HOOK - CONTAINER HOOK, GRADE 80

- Material: Alloy Steel, Grade 80
- Standard: EN 1677-1/ ASTM A952/952M
- Finish: Powder Coated, Yellow
- Design Factor: 4:1
- Identification: Trademark, Size/WLL, Batch Code, Grade
- Rated in Metric Ton(s)

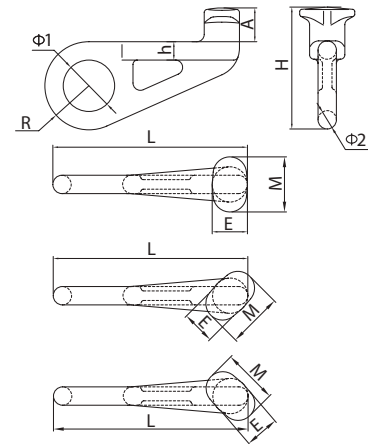

WLL (t)	Type	Dimensions (in)									Wt. / ea. (lb)	Qty. / Box	Price / ea.	Part Number
		A	M	H	E	R	Φ1	Φ2	L					
12.5	Left 45	1.81	2.95	6.54	0.98	1.89	2.36	2.76	0.98	10.43	9.09	6	167.75	3-8-06745LT
12.5	Right 45	1.81	2.95	6.54	0.98	1.89	2.36	2.76	0.98	10.43	9.09	6	167.75	3-8-06745RH

HOOK - SLIDING CHOKER HOOKS, GRADE 80

- Material: Alloy Steel, Grade 80
- Standard: EN 1677-1/ ASTM A952/952M
- Finish: Powder Coated, Yellow
- Design Factor: 5:1
- Identification: Trademark, Size/WLL, Batch Code, Grade
- Based on degree of angle, loads will change.

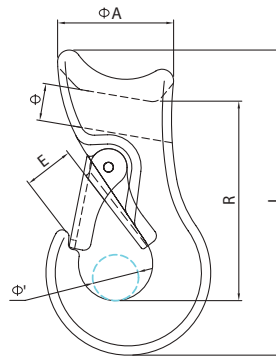

WLL (lb)	Wire Rope Dia. (in)	Latch Kit		Dimensions (in)						Wt. / ea. (lb)	Qty. / Box	Price / ea.	Part Number
		Price / ea.	Part Number	Φ	Φ'	A	E	L	R				
3 800	3/8-1/2	11.18	3-9-13LK	0.67	0.71	1.97	0.71	5.20	3.43	1.50	25	44.75	3-9-13SCH
5 800	9/16-5/8	12.45	3-14-16LK	0.87	0.75	2.50	0.75	5.94	3.98	2.67	20	70.25	3-14-16SCH

HOOK - KIT, SELF-LOCKING RECESSED TRIGGER KIT, GRADE 80/100,

For Grade 80/100 Self-Locking Recessed Hooks



Grade 80/100 Chain (in)	Price / ea.	Part Number
1/4-5/16	15.80	3-7-8TK
3/8	21.80	3-10TK
1/2	42.60	3-13TK
5/8	62.90	3-16TK
3/4	91.60	3-18-20TK
7/8	131.65	3-22TK
1	217.80	3-26TK

HOOK - KIT, CLEVIS, LOAD PIN KIT, GRADE 80

Grade 80 Material only



Grade 80 Chain (in)	WLL (lb)	Price / ea.	Part Number
9/32	4 500	11.50	3-7-8LPK
3/8	7 100	15.75	3-10LPK
1/2	12 000	24.25	3-13LPK
5/8	18 100	42.25	3-16LPK
3/4	28 300	52.75	3-18-20LPK
7/8	34 200	62.75	3-22LPK
1	47 700	73.75	3-26LPK
1 1/4	72 300	85.90	3-32LPK

LINK - KIT, CONNECTING, PIN & SLEEVE KIT, GRADE 80



Grade 80 Chain (in)	WLL (lb)	Price / ea.	Part Number
1/4 - 5/16	4 500	7.70	3-7-8CLP
3/8	7 100	11.18	3-10CLP
1/2	12 000	14.65	3-13CLP
5/8	18 100	22.00	3-16CLP
3/4	28 300	36.70	3-18-20CLP
7/8	34 200	49.98	3-22CLP
1	47 700	73.80	3-26CLP
1 1/4	72 300	120.73	3-32CLP

LINK - COUPLING, HALF LINK & PIN, GRADE 80



- Material: Alloy Steel, Grade 80
- Standard: EN 1677-1
- Finish: Powder Coated, Yellow
- Design Factor: 4:1
- Identification: Trademark, Size/WLL, Batch Code, Grade
- Pin & Sleeve included.

Grade 80 Chain (in)	WLL (lb)	Dimensions (in)				Wt./ea. (lb)	Qty. / Box	Price / ea.	Part Number
		A	D	K	L				
9/32	4500	0.81	0.35	0.94	1.10	0.2	200	9.88	3-9/32CLH
3/8	7 100	1.10	0.50	1.12	1.3	0.4	100	11.73	3-3/8CLH
1/2	12 000	1.18	0.62	1.26	1.77	0.9	40	19.73	3-1/2CLH
5/8	18 100	1.42	0.75	1.63	1.97	1.3	25	29.45	3-5/8CLH
3/4	28 300	1.73	0.87	1.75	2.36	2.4	20	58.95	3-3/4CLH

LINK - COUPLING, ROUND SLING, GRADE 80

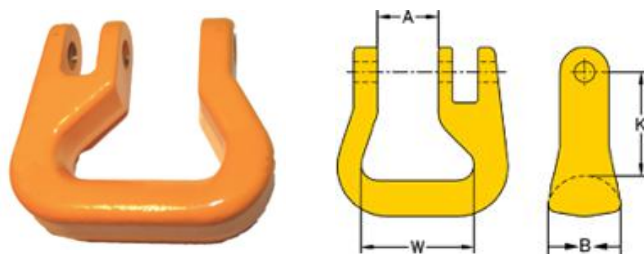

- Material: Alloy Steel, Grade 80
- Standard: EN 1677-1
- Finish: Powder Coated, Yellow
- Design Factor: 4:1
- Identification: Trademark, Size/WLL, Batch Code, Grade

Grade 80 Chain (in)	WLL (lb)	Dimensions (in)				Wt./ea. (lb)	Qty. / Box	Price / ea.	Part Number
		A	B	K	W				
9/32	4500	0.81	0.94	1.30	1.57	0.4	100	16.95	3-9/32CRS
3/8	7100	1.10	1.14	1.65	1.85	0.9	50	22.40	3-3/8CRS
1/2	12 000	1.18	1.38	2.01	2.09	1.5	25	34.98	3-1/2CRS
5/8	18 100	1.42	1.73	2.48	2.64	2.9	15	64.00	3-5/8CRS
3/4	28 300	1.73	2.05	2.87	3.17	4.6	10	87.18	3-3/4CRS

LINK - COUPLING & PIN, GRADE 80

- Material: Alloy Steel, Grade 80
- Standard: EN 1677-1 / ASTM A952/952M
- Finish: Powder Coated, Yellow
- Design Factor: 4:1
- Identification: Trademark, Size/WLL, Batch Code, Grade

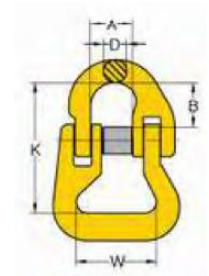

Grade 80 Chain (in)	WLL (lb)	Dimensions (in)					Wt./ea. (lb)	Qty. / Box	Price / ea.	Part Number
		A	B	D	K	W				
1/2	12 000	1.19	1.38	0.62	3.74	2.09	2.4	25	61.38	3-016-13
5/8	18 100	1.42	1.51	0.75	4.53	2.64	4.4	12	105.30	3-016-16
3/4	28 300	1.65	1.81	0.87	6.20	3.15	7.1	8	157.88	3-016-20

SWIVEL - COUPLING, INSULATED BLANK SWIVEL, GRADE 80

- Material: Alloy Steel, Grade 80
- Standard: EN 1677-1 / ASTM A952/952M
- Finish: Powder Coated, Yellow
- Design Factor: 4:1
- Identification: Trademark, Size/WLL, Batch Code, Grade

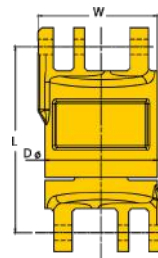

WLL (lb)	Grade 80 Chain (in)	Dimensions (in)			Wt./ea. (lb)	Qty. / Box	Price / ea.	Part Number
		L	D	W				
4500	9/32	2.99	1.89	1.97	1.9	36	332.75	3-9/32BSI
7100	3/8	3.66	2.28	2.44	2.6	16	519.40	3-3/8BSI
12 000	1/2	4.80	2.91	3.09	5.5	8	706.88	3-1/2BSI
18 100	5/8	5.60	3.54	3.74	9.7	4	902.75	3-5/8BSI
28 300	3/4	6.25	4.13	4.33	15.3	3	1,174.38	3-3/4BSI

LINK - COUPLING, MASTER LINK, GRADE 80

- Material: Alloy Steel, Grade 80
- Standard: EN 1677-1 / ASTM A952/952M
- Finish: Powder Coated, Yellow
- Design Factor: 4:1
- Identification: Trademark, Size/WLL, Batch Code, Grade

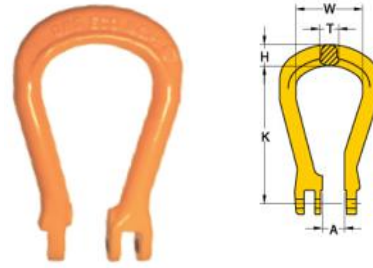

Grade 80 Chain (in)	WLL (lb)	Dimensions (in)					Wt./ea. (lb)	Qty. / Box	Price / ea.	Part Number
		A	H	K	T	W				
9/32	4500	0.81	0.59	3.94	0.59	1.97	0.7	45	29.40	3-9/32MLC
3/8	7100	1.10	0.91	5.00	0.75	2.56	1.5	20	42.90	3-3/8MLC
1/2	12 000	1.18	0.94	5.71	0.91	2.83	2.2	15	57.00	3-1/2MLC
5/8	18 100	1.43	1.02	6.85	0.98	3.15	3.5	12	75.50	3-5/8MLC
3/4	28 300	1.73	1.42	8.11	1.22	4.09	6.6	5	152.88	3-3/4MLC

HOOK - COUPLING, SELF-LOCKING, GRADE 80

- Material: Alloy Steel, Grade 80
- Standard: EN 1677-1/ ASTM A952/952M
- Finish: Powder Coated, Yellow
- Design Factor: 4:1
- Identification: Trademark, Size/WLL, Batch Code, Grade

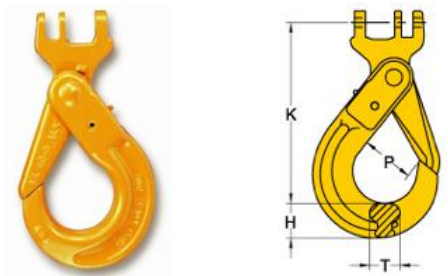

Grade 80 Chain (in)	WLL (lb)	Dimensions (in)				Wt./ea. (lb)	Qty. / Box	Price / ea.	Part Number
		H	K	P	T				
9/32	4500	0.94	5.35	1.34	0.79	1.8	20	47.10	3-9/32CSLH
3/8	7 100	1.19	6.06	1.77	1.02	3.1	12	69.00	3-3/8CSLH
1/2	12 000	1.57	7.95	2.13	1.19	6.4	6	137.10	3-1/2CSLH
5/8	18 100	1.93	9.53	2.44	1.30	11.9	4	255.25	3-5/8CSLH
3/4	28 300	2.56	10.12	2.76	2.09	22.3	2	449.50	3-3/4CSLH

LINK - KIT, CONNECTING, PIN & SLEEVE KIT, GRADE 80

For Coupling assemblies, Grade 80 Material only

Size (in)	WLL (lb)	Price / ea.	Part Number
1/4 - 5/16	4500	8.35	3-9/32CLP
3/8	7100	11.50	3-3/8CLP
1/2	12 000	15.10	3-1/2CLP
5/8	18 100	22.65	3-5/8CLP
3/4	28 300	37.75	3-3/4CLP



LINK - MASTER LINK, GRADE 100

- Material: Alloy Steel, Grade 100
- Standard: EN 1677-4 / ASTM A952/952M
- Finish: Powder Coated, Blue
- Design Factor: 5:1
- Identification: Trademark, Size/WLL,
Batch Code, Grade

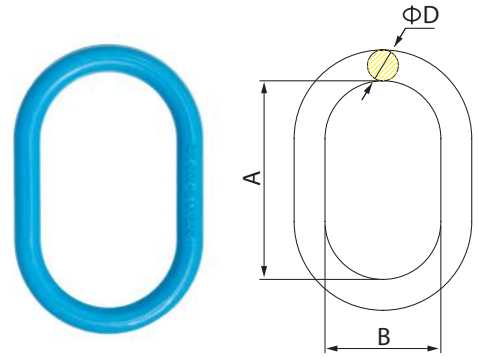

Trade Size (in)	WLL (lb)	Chain Size (in)		I.L. (in)	I.W. (in)	Dia. (in)	Wt. / ea. (lb)	Qty. / Box	Price / ea.	Part Number
		1-Leg	2-Leg							
1/2"	7 400	5/16"	7/32"	4.72	2.76	0.55	1.1	50	31.13	3-X-1/2"ML
5/8"	9 000	3/8"	5/16"	5.51	3.15	0.67	1.6	30	44.88	3-X-5/8"ML
3/4"	12 300	1/2"		5.91	3.54	0.85	2.4	20	65.25	3-X-3/4"ML
7/8"	15 200	1/2"	3/8"	6.30	3.74	0.87	3.5	16	76.88	3-X-7/8"ML
1"	26 000	5/8"		7.48	4.33	0.98	5.1	7	104.58	3-X-1"ML
1-1/8"	30 000	5/8"	1/2"	7.09	4.13	1.10	5.9	8	121.50	3-X-1-1/8"ML
1-1/4"	39 100	3/4"		7.87	4.72	1.18	7.6	5	173.00	3-X-1-1/4"ML
1-3/8"	42 000	7/8"	5/8"	9.45	5.51	1.34	11.7	4	298.00	3-X-1-3/8"ML
1-1/2"	61 100	1"		9.84	5.91	1.50	15.8	3	359.38	3-X-1-1/2"ML

LINK - CONNECTING LINK, GRADE 100

- Material: Alloy Steel, Grade 100
- Standard: EN 1677-1 / ASTM A952/952M
- Finish: Powder Coated, Blue
- Design Factor: 4:1
- Identification: Trademark, Size/WLL, Batch Code, Grade

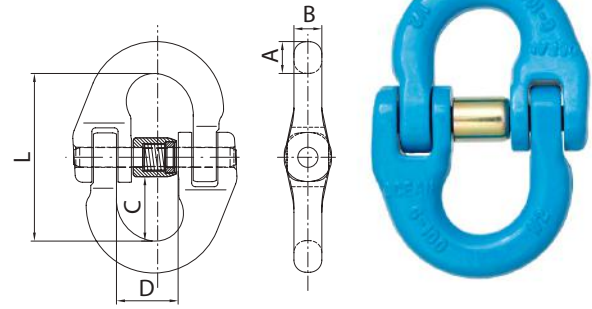

Grade 100 Chain (in)	WLL (lb)	Dimensions (in)					Wt. / ea. (lb)	Qty. / Box	Price / ea.	Part Number
		A	B	C	D	L				
9/32"	5 700	0.39	0.34	0.91	0.73	2.30	0.33	150	16.75	3-X-7-8CL
3/8"	8 800	0.52	0.45	1.04	1.00	2.72	0.71	50	17.75	3-X-10CL
1/2"	15 000	0.67	0.62	1.42	1.18	3.54	1.68	35	37.23	3-X-13CL
5/8"	22 600	0.75	0.75	1.50	1.43	3.94	2.73	20	47.10	3-X-16CL
3/4"	35 300	0.93	0.87	1.77	1.67	4.76	4.21	12	95.00	3-X-18-20CL
7/8"	42 700	1.11	0.94	2.38	1.94	6.06	7.82	6	148.45	3-X-22CL
1"	59 700	1.22	1.20	2.56	2.18	6.54	10.80	3	241.05	3-X-26CL
1-1/4"	90 400	1.54	1.42	3.15	2.75	8.07	20.28	2	456.65	3-X-32CL

HOOK - CLEVIS GRAB HOOK, GRADE 100

- Material: Alloy Steel, Grade 100
- Standard: EN 1677-1 / ASTM A952/952M
- Finish: Powder Coated, Blue
- Design Factor: 4:1
- Identification: Trademark, Size/WLL, Batch Code, Grade

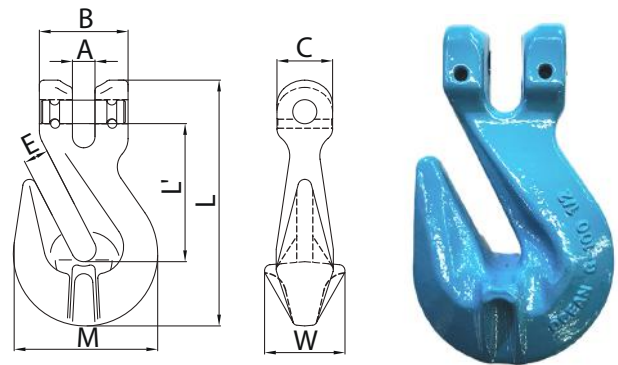

Grade 100 Chain (in)	WLL (lb)	Dimensions (in)								Wt. / ea. (lb)	Qty. / Box	Price / ea.	Part Number
		A	B	C	E	M	W	L*	L				
9/32"	5 700	0.37	1.42	0.94	0.43	2.13	1.32	2.09	3.66	0.75	70	19.45	3-X-7-8CGH
3/8"	8 800	0.49	1.81	1.16	0.53	2.83	1.65	2.87	5.00	1.81	30	29.53	3-X-10CGH
1/2"	15 000	0.59	2.32	1.46	0.59	3.78	2.11	3.62	6.46	3.86	15	59.75	3-X-13CGH
5/8"	22 600	0.73	2.76	1.81	0.75	4.53	2.91	4.06	7.40	6.35	8	104.43	3-X-16CGH
3/4"	35 300	0.94	3.35	2.05	0.98	5.71	3.43	4.84	8.78	10.67	4	189.70	3-X-18-20CGH
7/8"	42 700	1.06	3.94	2.40	1.06	6.26	3.54	5.55	10.24	18.29	4	327.98	3-X-22CGH
1"	59 700	1.18	4.33	2.76	1.34	7.48	4.33	7.36	12.60	30.24	2	819.50	3-X-26CGH

HOOK - CLEVIS GRAB HOOK WITH PIN, GRADE 100

- Material: Alloy Steel, Grade 100
- Standard: EN 1677-1 / ASTM A952/952M
- Finish: Powder Coated, Blue
- Design Factor: 4:1
- Identification: Trademark, Size/WLL, Batch Code, Grade

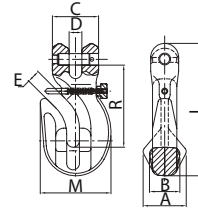

Grade 100 Chain (in)	WLL (lb)	Dimensions (in)								Wt. / ea. (lb)	Qty. / Box	Price / ea.	Part Number
		A	B	C	R	D	E	L	M				
5/16"	5 700	1.40	0.98	1.50	2.60	0.39	0.41	4.29	2.20	1.37	70	55.75	3-X-5/16"CGHSP
3/8"	8 800	1.73	1.26	1.81	3.23	0.47	0.51	5.28	2.72	2.56	30	90.40	3-X-3/8"CGHSP
1/2"	15 000	2.24	1.57	2.34	4.21	0.59	0.61	6.91	3.66	5.73	15	147.63	3-X-1/2"CGHSP

HOOK - CLEVIS SLING HOOK, GRADE 100

- Material: Alloy Steel, Grade 100
- Standard: EN 1677-5 / ASTM A952/952M
- Finish: Powder Coated, Blue
- Design Factor: 4:1
- Identification: Trademark, Size/WLL, Batch Code, Grade

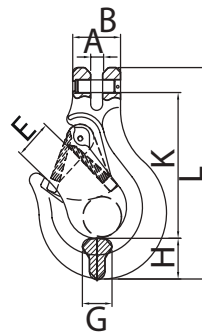

Grade 100 Chain (in)	WLL (lb)	Spare Latch Kit		Dimensions (in)							Wt. / ea. (lb)	Qty. / Box	Price / ea.	Part Number
		Price / ea.	Part #	A	B	E	G	H	K	L				
9/32"	5 700	8.90	3-7-8LK	0.37	1.77	1.02	0.75	0.91	3.84	5.43	1.3	30	29.75	3-X-7-8CSH
3/8"	8 800	12.18	3-10LK	0.47	1.71	1.30	0.91	1.14	4.72	6.87	2.6	15	55.50	3-X-10CSH
1/2"	15 000	18.95	3-13LK	0.59	2.24	1.57	1.10	1.50	5.79	8.39	5.1	8	80.25	3-X-13CSH
5/8"	22 600	25.50	3-16LK	0.73	2.64	1.73	1.54	1.65	6.65	9.65	8.4	6	172.88	3-X-16CSH
3/4"	35 300	31.08	3-18-20LK	0.98	3.94	2.13	1.85	2.01	7.48	12.76	14.8	4	307.18	3-X-18-20CSH
7/8"	42 700	39.50	3-X-22LK	1.06	3.94	2.56	1.97	2.44	8.43	12.83	26.7	2	616.70	3-X-22CSH
1"	59 700	53.40	3-X-26LK	1.20	4.65	2.83	2.36	2.87	9.72	15.08	35.5	2	1,000.65	3-X-26CSH

HOOK - SWIVEL SELF LOCKING HOOK BRASS BUSHING, GRADE 100

- Material: Alloy Steel, Grade 100
- Standard: EN 1677-3 / ASTM A952/952M
- Finish: Powder Coated, Blue
- Design Factor: 4:1
- Identification: Trademark, Size/WLL, Batch Code, Grade

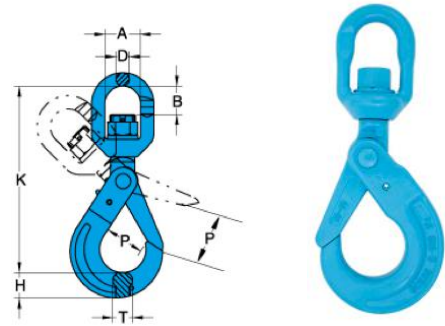

Grade 100 Chain (in)	WLL (lb)	Dimensions (in)							Wt. / ea. (lb)	Qty. / Box	Brass Bushing	
		A	B	D	H	K	P	T			Price / ea.	Part Number
1/4-5/16	5 700	1.42	1.14	0.51	0.94	7.32	1.34	0.79	2.6	12	105.53	3-X-7-8SSLH
3/8	8 800	1.8	1.49	0.62	1.19	8.9	1.77	1.02	4.4	7	154.63	3-X-10SSLH
1/2	15 000	1.81	1.86	0.83	1.57	11	2.01	1.26	9	4	270.00	3-X-13SSLH
5/8	22 600	2.36	2.16	0.91	1.93	13	2.44	1.3	15.9	3	400.45	3-X-16SSLH
3/4	35 300	2.91	3.23	1.02	2.36	15.28	3.54	2.09	24.9	2	835.00	3-X-18-20SSLH
7/8	42 700	3.82	3.94	1.3	2.48	17.99	3.14	2.15	39.5	1	1,722.50	3-X-22SSLH
1	59 700	4.84	4.53	2.09	2.72	21.06	3.90	2.20	69.3	1	3,115.00	3-X-26SSLH

HOOK - SWIVEL SELF LOCKING HOOK BALL BEARING, GRADE 100

- Material: Alloy Steel, Grade 100
- Standard: EN 1677-3 / ASTM A952/952M
- Finish: Powder Coated, Blue
- Design Factor: 4:1
- Identification: Trademark, Size/WLL, Batch Code, Grade

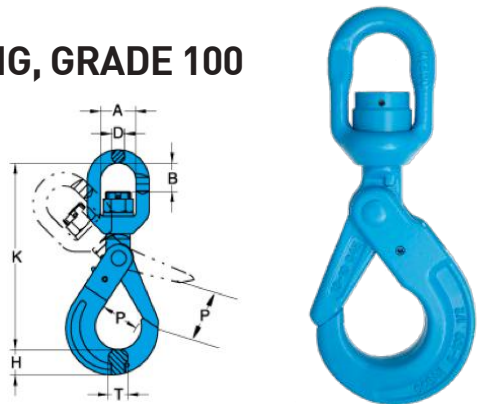

Grade 100 Chain (in)	WLL (lb)	Dimensions (in)							Wt. / ea. (lb)	Qty. / Box	Ball Bearing	
		A	B	D	H	K	P	T			Price / ea.	Part Number
3/8	8 800	1.8	1.49	0.62	1.19	8.9	1.77	1.02	4.4	7	169.55	3-X-10SWBB
1/2	15 000	1.81	1.86	0.83	1.57	11	2.01	1.26	9	4	327.50	3-X-13SWBB
5/8	22 600	2.36	2.16	0.91	1.93	13	2.44	1.3	15.9	3	557.50	3-X-16SWBB
3/4	35 300	2.91	3.23	1.02	2.36	15.28	3.54	2.09	24.9	2	873.75	3-X-18-20SWBB
7/8	42 700	3.82	3.94	1.3	2.48	17.99	3.14	2.15	39.5	1	1,735.00	3-X-22SWBB
1	59 700	4.84	4.53	2.09	2.72	21.06	3.90	2.20	69.3	1	3,333.50	3-X-26SWBB

HOOK - SELF LOCKING EYE HOOK, GRADE 100

- Material: Alloy Steel, Grade 100
- Standard: EN 1677-3 / ASTM A952/952M
- Finish: Powder Coated, Blue
- Design Factor: 4:1
- Identification: Trademark, Size/WLL, Batch Code, Grade

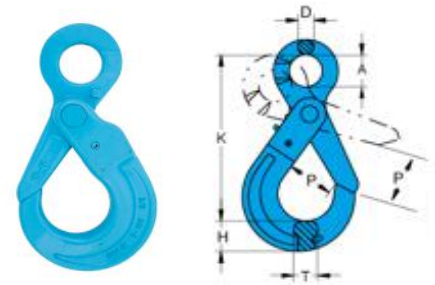

Grade 100 Chain (in)	WLL (lb)	Dimensions (in)						Wt. / ea. (lb)	Qty. / Box	Price / ea.	Part Number
		A	D	H	K	P	T				
1/4 - 5/16	5700	0.98	0.43	1.02	5.35	1.34	0.79	1.8	20	51.75	3-X-7-8SLEH
3/8	8800	1.26	0.51	1.24	6.57	1.73	1.02	3.3	15	81.70	3-X-10SLEH
1/2	15 000	1.57	0.63	1.65	8.15	2.01	1.18	6.6	8	151.00	3-X-13SLEH
5/8	22 600	1.97	0.83	2.2	9.92	2.36	1.42	12.5	4	288.50	3-X-16SLEH
3/4	35 300	2.36	0.91	2.56	11.42	2.76	2.09	22.2	2	528.23	3-X-18-20SLEH
7/8	42 700	2.76	0.94	2.8	12.56	3.15	1.93	24	2	740.38	3-X-22SLEH

HOOK - SELF LOCKING CLEVIS HOOK, GRADE 100

- Material: Alloy Steel, Grade 100
- Standard: EN 1677-3 / ASTM A952/952M
- Finish: Powder Coated, Blue
- Design Factor: 4:1
- Identification: Trademark, Size/WLL, Batch Code, Grade

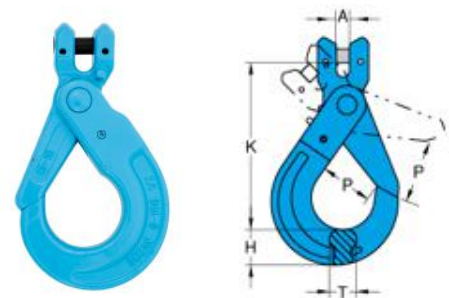

Grade 100 Chain (in)	WLL (lb)	Dimensions (in)					Wt. / ea. (lb)	Qty. / Box	Price / ea.	Part Number
		A	P	T	H	K				
1/4 - 5/16	5700	0.37	1.34	0.79	0.94	4.65	2.07	25	52.35	3-X-7-8SLCH
3/8	8800	0.49	1.73	1.02	1.18	5.59	3.1	15	79.75	3-X-10SLCH
1/2	15 000	0.59	2.05	1.26	1.56	7.01	6.2	8	159.75	3-X-13SLCH
5/8	22 600	0.73	2.36	1.30	1.97	8.31	12.3	4	307.25	3-X-16SLCH
3/4	35 300	0.98	2.76	2.09	2.64	9.84	19.8	2	547.25	3-X-18-20SLCH
7/8	42 700	0.98	3.15	2.24	2.56	12.60	24	2	784.00	3-X-22SLCH

HOOK - EYE SLING HOOKS, GRADE 100

- Material: Alloy Steel, Grade 100
- Standard: EN 1677-5 / ASTM A952/952M
- Finish: Powder Coated, Blue
- Design Factor: 4:1
- Identification: Trademark, Size/WLL, Batch Code, Grade

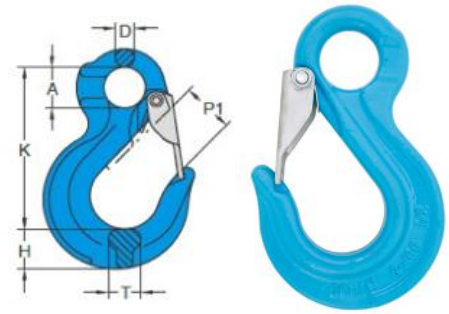

Grade 100 Chain (in)	WLL (lb)	Dimensions (in)						Wt. / ea. (lb)	Qty. / Box	Price / ea.	Part Number
		D	P1	A	T	K	H				
9/32	5 700	0.47	1.10	0.98	0.79	3.88	0.89	1.10	50	26.25	3-X-7-8ESH
3/8	8 800	0.57	1.42	1.26	0.91	4.76	1.20	2.20	25	39.35	3-X-10ESH
1/2	15 000	0.73	1.57	1.57	1.12	6.02	1.48	4.63	12	70.30	3-X-13ESH
5/8	22 600	0.87	1.77	1.97	1.46	7.28	1.81	6.80	6	136.98	3-X-16ESH

HOOK - FOUNDRY EYE HOOKS, GRADE 100

- Material: Alloy Steel, Grade 100
- Standard: EN 1677-1 / ASTM A952/952M
- Finish: Powder Coated, Blue
- Design Factor: 4:1
- Identification: Trademark, Size/WLL, Batch Code, Grade

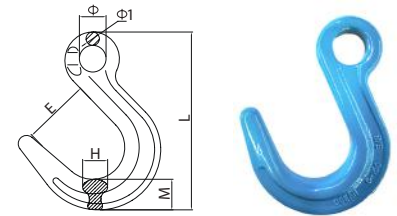

Grade 100 Chain (in)	WLL (lb)	Dimensions (in)						Wt. / ea. (lb)	Qty. / Box	Price / ea.	Part Number
		E	H	M	Φ	Φ1	L				
3/8"	8 800	2.87	0.98	1.18	1.24	0.59	7.83	3.00	12	57.88	3-X-3/8FEH
1/2"	15 000	3.54	1.30	1.54	1.73	0.75	9.37	5.66	8	111.45	3-X-1/2FEH
5/8"	22 600	4.13	1.46	1.65	1.93	0.87	10.98	8.73	4	175.98	3-X-5/8FEH
3/4"	35 300	4.49	1.81	2.24	2.36	1.02	12.99	16.09	3	319.75	3-X-3/4FEH

HOOK - FOUNDRY CLEVIS HOOKS, GRADE 100

- Material: Alloy Steel, Grade 100
- Standard: EN 1677-1 / ASTM A952/952M
- Finish: Powder Coated, Blue
- Design Factor: 4:1
- Identification: Trademark, Size/WLL, Batch Code, Grade

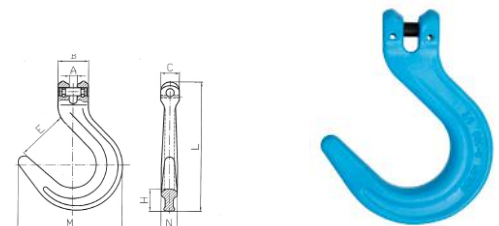

Grade 100 Chain (in)	WLL (lb)	Dimensions (in)								Wt. / ea. (lb)	Qty. / Box	Price / ea.	Part Number
		A	B	C	E	M	N	H	L				
3/8	8 800	0.49	1.89	1.16	2.83	6.02	0.98	1.22	7.56	3.13	12	62.22	3-X-3/8FCH
1/2	15 000	0.59	2.32	1.38	3.46	7.32	1.30	1.54	9.13	6.35	8	117.59	3-X-1/2FCH
5/8	22 600	0.73	2.76	1.81	4.06	8.58	1.57	1.97	11.18	11.24	4	191.82	3-X-5/8FCH

HOOK - WEB AND ROUND SLING HOOK, GRADE 100

- Material: Alloy Steel, Grade 100
- Standard: EN 1677-1 / ASTM A952/952M
- Finish: Powder Coated, Blue
- Design Factor: 4:1
- Identification: Trademark, Size/WLL, Batch Code, Grade

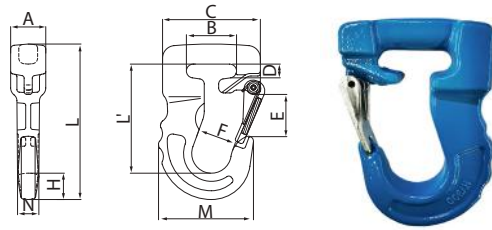

Size (t)	WLL (lb)	Dimensions (in)											Wt./ea. (lb)	Qty. / Box	Price / ea.	Part Number
		A	B	C	D	M	E	F	L	L*	H	N				
1	2200	1.10	1.57	3.07	0.43	2.98	1.26	1.22	4.88	3.43	0.83	0.67	1.61	30	46.58	3-X-032-01
2	4400	1.38	1.75	3.58	0.49	3.54	1.57	1.54	5.83	4.06	1.06	0.83	2.80	15	74.40	3-X-032-02
3	6600	1.77	2.13	4.45	0.61	4.33	1.57	1.85	6.89	4.53	1.30	1.02	5.07	10	133.95	3-X-032-03
4	8800	2.20	3.01	5.24	0.83	5.47	1.97	2.36	8.78	5.79	1.59	1.26	10.14	5	243.13	3-X-032-04
5	11000	2.20	3.01	5.24	0.83	5.47	1.97	2.36	8.78	5.79	1.59	1.26	10.14	5	243.13	3-X-032-05
6	13200	2.20	3.01	5.24	0.83	5.47	1.97	2.36	8.78	5.79	1.59	1.26	10.14	5	243.13	3-X-032-06

HOOK - KIT, SELF-LOCKING RECESSED TRIGGER KIT, GRADE 80/100



For Grade 80/100 Self-Locking Recessed Hooks

Grade 80/100 Chain (in)	Price / ea.	Part Number
1/4-5/16	15.80	3-7-8TK
3/8	21.80	3-10TK
1/2	42.60	3-13TK
5/8	62.90	3-16TK
3/4	91.60	3-18-20TK
7/8	131.65	3-22TK
1	217.80	3-26TK

HOOK - KIT, CLEVIS, LOAD PIN KIT, GRADE 100

Grade 100 Material only



Grade 100 Chain (in)	WLL (lb)	Price / ea.	Part Number
9/32	5 700	11.50	3-X-7-8LPK
3/8	8 800	15.75	3-X-10LPK
1/2	15 000	24.25	3-X-13LPK
5/8	22 600	42.25	3-X-16LPK
3/4	35 300	52.75	3-X-18-20LPK
7/8	42 700	62.75	3-X-22LPK
1	59 700	73.75	3-X-26LPK

LINK - KIT, CONNECTING, PIN & SLEEVE KIT, GRADE 100

For Coupling assemblies, Grade 100 Material only



Grade 100 Chain (in)	WLL (lb)	Price / ea.	Part Number
1/4 - 5/16	5 700	7.70	3-X-7-8CLP
3/8	8 800	11.18	3-X-10CLP
1/2	15 000	14.65	3-X-13CLP
5/8	22 600	22.00	3-X-16CLP
3/4	35 300	36.70	3-X-18-20CLP
7/8	42 700	49.98	3-X-22CLP
1	59 700	73.80	3-X-26CLP
1 1/4	94 000	120.73	3-X-32CLP

HOOK - WELD ON BUCKET HOOK, GRADE 80

- Material: Alloy Steel, Grade 80
- Standard: EN 1677-1
- Finish: Powder Coated, Yellow
- Design Factor: 5:1
- Identification: Trademark, Size/WLL, Batch Code, Grade
- Rated in Metric Ton(s)

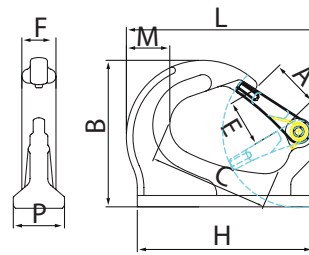

WLL (t)	Latch Kit		Dimensions (in)									Weld Bead X (mm)	Wt. (lb)	Price / ea.	Part Number
	Price / ea.	Part Number	A	B	C	E	F	H	M	P	L				
3	34.75	3-3TWOHL	1.18	4.17	2.95	1.18	0.94	4.57	1.18	1.42	5.04	10	2.80	76.80	3-3TWOH
5	47.55	3-5TWOHL	1.54	5.24	3.86	1.42	1.10	6.30	1.69	1.71	6.69	10	5.95	159.50	3-5TWOH
8	48.00	3-8TWOHL	1.42	5.39	3.90	1.36	1.54	6.54	1.97	2.01	6.89	12	7.71	206.50	3-8TWOH
10	55.98	3-10TWOHL	1.93	6.65	5.51	1.93	1.50	8.07	2.17	2.09	8.74	15	11.46	307.20	3-10TWOH
20	132.25	3-20TWOHL	2.48	7.56	3.23	2.48	2.01	11.50	3.07	3.35	11.50	15	25.35	460.00	3-20TWOH

Welding Instructions

The welding should only be carried out by qualified welder according to Standards, e.g. EN 287 or AWS.

Support Material

- The support material ST 52-3.
- Prior to welding, the contact areas must be free from impurities, oil, paint, rust, scale, etc., for example by grinding.
- If the surface is at all corroded, all rust must be completely removed from the weld area. Painted surface must be prepared in the same way.
- The steel support member must have a carbon content of no less than 0.25% and no more than 0.40%.
- The hook must be positioned that the weld is loaded only in shear. No bending moment can be permitted on weld seam.
- In ambient temperature of 10°C and below, pre-heating of the weld area prior to welding must be carried out.

Seam Welding

- The welds must be sufficiently strong to take the required loads.
- A minimum weld-seam width must be maintained to give adequate weld strength (see table).
- The gauging points on the supports guarantee the gap necessary for the root pass (approx. 3mm).

- Start both, the root pass and final weld pass from the centre of the support to be welded.
- Before starting the final weld pass, clean well the root pass to avoid inclusions.
- The complete welding operation must be carried out continuously so that the parts do not have time to cool.

MIG Arc Welding

- Wire diameter 0.8 - 1.2 as per DIN 8559-SG 3.
- Important: do not weld in the open air during bad weather.

Manual Electric: Direct Current Supply Welding:

- Electrodes according to EN ISO 2560-A - E 42 6 B 3 2, AWS A 5.5: E 8018-G.
- Electrode: root pass & final weld pass, type E5154 B10 as per DIN 1913, used in accordance with the manufacturers.

Alternating current supply welding:

- Electrode as per DIN 1913, modified for alternating current use.
- HV welding and final weld pass, type E5155 B10.

RING - WELD ON LIFTING POINT, GRADE 80

- Material: Alloy Steel, Grade 80
- Standard: EN 1677-1
- Finish: Powder Coated, Yellow
- Design Factor: 5:1
- Identification: Trademark, Size/WLL, Batch Code, Grade
- Rated in Metric Ton(s)

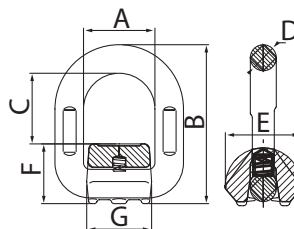

WLL (t)	Dimensions (in)							Wt. (lb)	Qty. / Box	Price / ea.	Part Number
	A	B	C	D	E	F	G				
1	1.61	3.15	1.38	0.51	1.50	1.32	1.46	1.04	45	23.50	3-057-1T
3	1.81	3.78	1.65	0.67	1.69	1.46	1.73	1.52	25	38.00	3-057-3T
5	2.17	4.76	1.89	0.87	2.40	1.97	1.97	3.22	12	63.50	3-057-5T
8	2.76	5.67	2.44	1.04	2.78	2.13	2.60	5.55	10	76.98	3-057-8T
10	3.35	6.61	3.07	1.10	2.99	2.46	3.07	7.91	8	103.45	3-057-10T
15	3.82	7.36	3.39	1.34	3.54	2.83	3.54	12.76	5	210.50	3-057-15T

Welding Instructions

The welding should only be carried out by qualified welder according to Standards, e.g. EN 287 or AWS

Support Material:

- Material of the welding block is S355J2+N (1.0577+N, St 52-3N, B.S. 4360.50D, AISI 1019 etc.).
- Prior to welding, the contact areas must be free from impurities, oil, paint, rust, scale, etc., for example by grinding. If the surface is at all corroded, all rust must be completely removed from the weld area.
- Painted surface must be prepared in the same way.
- The steel support member must have a carbon content of no less than 0.25% and no more than 0.40%.
- In ambient temperature of 10°C and below, pre-heating of the weld area prior to welding must be carried out.

Seam Welding:

- The welds must be sufficiently strong to take the required loads.
- The distance lugs assist in achieving the required root weld (approx. 3 mm).
- A minimum weld-seam width must be maintained to give adequate weld strength (see table).
- Start both, the root pass and final weld pass from the centre of the support to be welded.
- Before starting the final weld pass, clean well the root pass to avoid inclusions.

- The complete welding operation must be carried out continuously so that the parts do not have time to cool.
- Do not weld at the yellow powder coated tempered load ring.
- After welding, ensure bail pivots full 180° without interfering with the weld.

Effects of Temperature:

- The lifting points for weld on, types DAA, can together with the load (e.g. weld construction) be annealed.
- Temperature \leftarrow 600° C, stress-release without reduction of WLL.
- The complete construction can be annealed stress release at \leftarrow 600°C without reduction of WLL.
- Do not rapidly cool the weld.
- A thorough inspection of the weld should be performed. No cracks, pitting, inclusions, notches or undercuts are allowed. If doubt exists, use a suitable NDT method, such as magnetic particle or liquid penetrant to verify.
- If repair is required, grind out the defect and re-weld using the original qualified procedure.

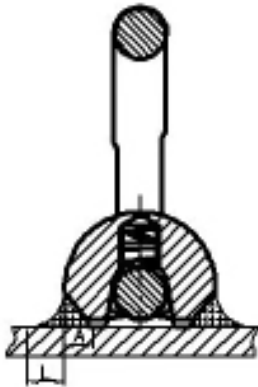

Part Number	WLL (t)	Thickness A (mm)	Weld Size L (mm)
3-057-1T	1	7.5	10
3-057-3T	3	7.6	12
3-057-5T	5	12.7	18
3-057-8T	8	16.4	20
3-057-10T	10	15.8	22
3-057-15T	15	20.6	25

Item Number	Weld Size A (mm)	Weld Size L (mm)
3-057-1T	7.5	10
3-057-3T	7.6	12
3-057-5T	12.7	18
3-057-8T	16.4	20
3-057-10T	15.8	22
3-057-15T	20.6	25



WARNING!



For welding

Pay attention to the following points during welding:

- The welding should be carried out by a qualified welder acc. to DIN EN 287-1, or applicable standards.
- Material of welding block is St 52-3 (1.0570).
- The connecting surfaces must be free from dirt, oil, colour, etc.
- Do not weld at the red, powder coated tempered load ring.
- The complete construction can be annealed stress-free for several times at 600°C without reduction of WLL.
- The welding spot has to be suitable for the corresponding force introduction.
- The distance lugs assist in achieving the required root weld (approx. 3 mm).

Important

By the arrangement of weld (continuous HV), the following requirements are fulfilled:

DIN 18800 for steel building prescribes

At outdoor sites or in case of special danger of corrosion, the welds should only be designed as continuous, fillet welds. The HV weld at the LBS assures a connection via the whole cross section of the material. This corresponds to the closed weld showing no signs of corrosion.

15T	18	28	25	
8T	14	24	20	
6T	12	22	18	
3T	10	15	12	
2T	8	16	12	
1T	6	12	10	
CODE No	(S) Min thickness of baseplate	(B) welding lead width	L (Min)	

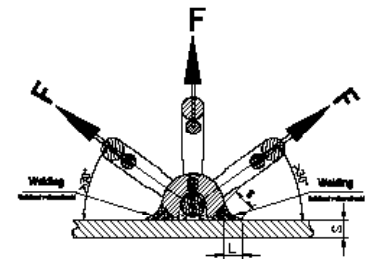

Welding and using schematic diagram of L ring

SWIVEL - LIFTING EYE KEY POINT - UNC THREAD, GRADE 80

- Material: Alloy Steel, Grade 80
- Standard: EN 1677-1, Bolt: ANSI B18.3.1M, ISO 4762
- Finish: Powder Coated, Yellow
- Design Factor: 4:1
- Identification: Trademark, Size/WLL, Batch Code, Grade
- Rated in Metric Ton(s)

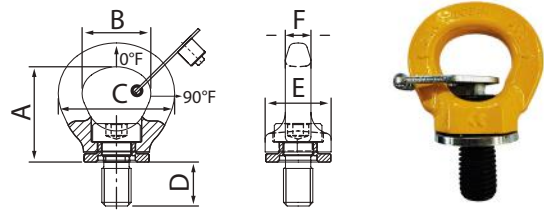

# of Leg	Load Direction	Part No.	Thread (in)	WLL (t)											
				1 0°	2 0°	1 90°	2 90°	2 0-45°	2 45-60°	2 unsym.	3-4 0-45°	3-4 45-60°	3-4 unsym.		
		3-292K-003	5/16	1	2	0.3	0.6	0.42	0.3	0.3	0.63	0.45	0.3		
		3-292K-004	3/8	1	2	0.4	0.8	0.56	0.4	0.4	0.8	0.6	0.4		
		3-292K-007	1/2	2	4	0.75	1.5	1	0.75	0.75	1.5	1.1	0.75		
		3-292K-015	5/8	4	8	1.5	3	2.1	1.5	1.5	3.1	2.2	1.5		
		3-292K-023	3/4	6	12	2.3	4.6	3.2	2.3	2.3	4.8	3.4	2.3		
		3-292K-025	7/8	6	12	2.3	4.6	3.2	2.3	2.3	4.8	3.4	2.3		
		3-292K-032	1	8	16	3.2	6.4	4.5	3.2	3.2	6.7	4.8	3.2		
		3-292K-045	1 1/4	12	24	4.5	9	6.3	4.5	4.5	9.4	6.7	4.5		
		3-292K-070	1 1/2	16	32	7	14	9.8	7	7	14.7	10.5	7		
		3-292K-090	1 3/4	24	48	9	18	12.6	9	9	18.9	13.5	9		
		3-292K-120	2	32	64	12	24	16.8	12	12	25	18	12		

WLL (t)		Thread		Dimensions (in)						Torque (Nm)	Wt./ea. (lb)	Price / ea.	Part Number
0°	90°	Size	Pitch UNC	A	B	C	D	E	F				
0.8	0.3	5/16	18	1.50	1.02	1.78	0.45	0.98	0.31	6~10	0.24	38.93	3-292K-003
1	0.4	3/8	16	1.50	1.02	1.78	0.55	0.98	0.31	6~10	0.26	41.38	3-292K-004
2	0.75	1/2	13	1.71	1.26	2.13	0.67	1.30	0.39	10~15	0.44	53.75	3-292K-007
4	1.5	5/8	11	2.05	1.48	2.50	0.94	1.42	0.55	20~30	0.77	62.25	3-292K-015
6	2.3	3/4	10	2.48	1.75	3.09	1.18	1.87	0.81	50~70	1.45	90.50	3-292K-023
8	3.2	7/8	9	2.91	2.03	3.62	1.39	2.09	0.79	120~150	2.42	100.40	3-292K-025
12	4.5	1	8	3.62	2.56	4.65	1.77	2.68	0.94	200~250	4.56	151.45	3-292K-032
16	7	1 1/4	7	4.13	2.99	5.35	2.24	3.23	1.18	280~400	8.82	249.13	3-292K-045

SWIVEL - LIFTING EYE KEY POINT, METRIC THREAD, GRADE 80

- Material: Alloy Steel, Grade 80
- Standard: EN 1677-1, Bolt: ANSI B18.3.1M, ISO 4762
- Finish: Powder Coated, Yellow
- Design Factor: 4:1
- Identification: Trademark, Size/WLL, Batch Code, Grade
- Rated in Metric Ton(s)

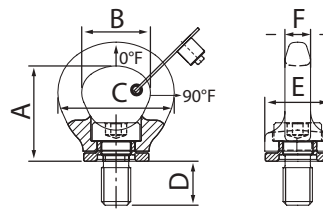

# of Leg	Load Direction	Part No.	Thread (mm)	WLL (t)											
				1 0°	2 0°	1 90°	2 90°	2 0-45°	2 45-60°	2 unsym.	3-4 0-45°	3-4 45-60°	3-4 unsym.		
		3-291K-003	M8	1	2	0.3	0.6	0.42	0.3	0.3	0.63	0.45	0.3		
		3-291K-004	M10	1	2	0.4	0.8	0.56	0.4	0.4	0.8	0.6	0.4		
		3-291K-007	M12	2	4	0.75	1.5	1	0.75	0.75	1.5	1.1	0.75		
		3-291K-015	M16	4	8	1.5	3	2.1	1.5	1.5	3.1	2.2	1.5		
		3-291K-023	M20	6	12	2.3	4.6	3.2	2.3	2.3	4.8	3.4	2.3		
		3-291K-032	M24	8	16	3.2	6.4	4.5	3.2	3.2	6.7	4.8	3.2		
		3-291K-045	M30	12	24	4.5	9	6.3	4.5	4.5	9.4	6.7	4.5		
		3-291K-070	M36	16	32	7	14	9.8	7	7	14.7	10.5	7		
		3-291K-090	M42	24	48	9	18	12.6	9	9	18.9	13.5	9		
		3-291K-120	M48	32	64	12	24	16.8	12	12	25	18	12		
		3-291K-140	M56	34	68	16	32	22.4	16	16	32	24	16		
		3-291K-150	M64	36	72	18	36	25.2	18	18	36	27	18		

WLL (t)		Thread		Dimensions (in)						Torque (Nm)	Wt./ea. (lb)	Price / ea.	Part Number
0°	90°	Size	Pitch UNC	A	B	C	D	E	F				
0.8	0.3	M8	1.25	38.0	26.0	45.3	11.5	25.0	8.0	6~10	0.11	38.93	3-291K-003
1	0.4	M10	1.5	38.0	26.0	45.3	14.0	25.0	8.0	6~10	0.12	41.38	3-291K-004
2	0.75	M12	1.75	43.5	32.0	54.0	17.0	33.0	10.0	10~15	0.20	47.25	3-291K-007
4	1.5	M16	2	52.0	37.5	63.5	24.0	36.0	14.0	20~30	0.35	54.75	3-291K-015
6	2.3	M20	2.5	63.0	44.5	78.5	30.0	47.5	20.6	50~70	0.66	78.00	3-291K-023
8	3.2	M24	3	74.0	51.6	92.0	35.3	53.0	20.0	120~150	1.10	95.50	3-291K-032
12	4.5	M30	3.5	92.0	65.0	118.0	45.0	68.0	24.0	200~250	2.07	142.63	3-291K-045
16	7	M36	4	105.0	76.0	136.0	56.8	82.0	30.0	280~400	4	237.00	3-291K-070



- All swivel Hoist Rings meet or exceed all the requirements of ASME B30.26
- Hoist Ring Bail are designed by forged alloy steel, quenched and tempered
- Each forged part and cap screw have batch coding and are linked to test certificate sheet
- Hoist rings are 360° swivel with 180° pivot function
- Bolt galvanized alternative phosphate treatment
- 20,000 cycle fatigue rated to 1.5 times WLL
- Rated 100% at 90° angle
- 100% magnaflux crack detection
- Self aligns in direction of load

SWIVEL - HOIST RING, UNC THREAD, GRADE 80

- Material: Alloy Steel, Grade 80
- Standard: ASME B30.26, Bolt: ASTM A574
- Finish: Dacromet Coating
- Design Factor: 5:1
- Identification: Trademark, Size/WLL, Batch Code, Grade

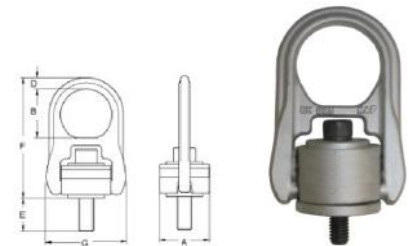

WLL (lb)	Thread Size	Torque ft. (lb)	Dimensions (in)						Wt./ ea. (lb)	Swivel Hoist Ring	
			A	B	D	E	F	G		Price / ea.	Part Number
800	5/16"-18 x 2	7	1.57	1.61	0.35	0.71	4.02	2.56	0.9	52.57	3-204-004
1000	3/8"-16 x 2	12	1.57	1.61	0.35	0.71	4.02	2.56	0.9	57.00	3-204-005
2500	1/2"-13 x 2.5	28	2.56	2.32	0.59	0.75	6.26	4.13	3.7	125.15	3-204-010
2500	1/2"-13 x 3.0	28	2.56	2.32	0.59	1.26	6.26	4.13	3.7	138.15	3-204-010L
4000	5/8"-11 x 2.5	60	2.56	2.32	0.59	0.74	6.26	4.13	4.0	138.15	3-204-019
4000	5/8"-11 x 3.25	60	2.56	2.32	0.59	1.69	6.26	4.13	4.0	161.40	3-204-019L
5000	3/4"-10 x 2.75	100	2.56	2.32	0.59	1.18	6.26	4.13	4.0	148.10	3-204-021
5000	3/4"-10 x 3.25	100	2.56	2.32	0.59	1.65	6.26	4.13	4.2	165.77	3-204-021L
7000	3/4"-10 x 3.0	100	3.35	2.87	0.87	0.79	8.03	5.28	9.0	288.30	3-204-030
7000	3/4"-10x3.75	100	3.35	2.87	0.87	1.75	8.03	5.28	9.1	318.27	3-204-030L
8000	7/8"-9 x 3.5	160	3.35	2.87	0.87	1.43	8.03	5.28	9.3	319.32	3-204-042
8000	7/8"-9 x 4.25	160	3.35	2.87	0.87	2.37	8.03	5.28	9.7	322.62	3-204-042L
10 000	1"-8 x 3.5	230	3.35	2.87	0.87	1.36	8.03	5.28	9.5	330.37	3-204-045
10 000	1"-8 x 4.5	230	3.35	2.87	0.87	2.36	8.03	5.28	9.7	365.00	3-204-045L
15 000	1-1/4"-7x4.5	470	3.95	3.15	1.0	2.25	8.58	6.30	14.5	436.50	3-204-070
24 000	1-1/2" - 6 x 6.5	800	4.72	4.29	1.38	2.17	12.09	8.66	36.4	922.50	3-204-125
30 000	2" - 4.5 x 6.5	1100	4.72	4.29	1.38	3.01	12.09	8.66	38.6	955.00	3-204-135

- Minimum Ultimate Load is 5 times the Working Load Limit
- Proof Load is 2.5 times the Working load Limit
- The depth of thread needs to be a minimum of 1 times the thread diameter for steel, 1.25 times for cast iron, 2 times for aluminium

SWIVEL - HOIST RING, UNC THREAD (OCEAN), GRADE 80

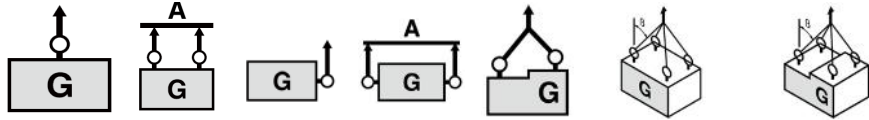

# of Leg	Load Direction	Item No.	Thread (in)	WLL (lb)	1		2		3-4			
					0°	0°	90°	90°	45-60°	unsym.	45-60°	unsym.
		3-204-004	5/16	800	800	1600	800	1600	800	800	1200	800
		3-204-005	3/8	1000	1000	2000	1000	2000	1000	1000	1500	1000
		3-204-010	1/2	2500	2500	5000	2500	5000	2500	2500	3750	2500
		3-204-010L	1/2	2500	2500	5000	2500	5000	2500	2500	3750	2500
		3-204-019	5/8	4000	4000	8000	4000	8000	4000	4000	6000	4000
		3-204-019L	5/8	4000	4000	8000	4000	8000	4000	4000	6000	4000
		3-204-021	3/4	5000	5000	10000	5000	10000	5000	5000	7500	5000
		3-204-021L	3/4	5000	5000	10000	5000	10000	5000	5000	7500	5000
		3-204-030	3/4	7000	7000	14000	7000	14000	7000	7000	10500	7000
		3-204-042	7/8	8000	8000	16000	8000	16000	8000	8000	12000	8000
		3-204-042L	7/8"	8000	8000	16000	8000	16000	8000	8000	12000	8000
		3-204-045	1"	10000	10000	20000	10000	20000	10000	10000	15000	10000
		3-204-045L	1"	10000	10000	20000	10000	20000	10000	10000	15000	10000
		3-204-070	1-1/4"	15000	15000	30000	15000	30000	15000	15000	22500	15000
		3-204-125	1-1/2"	24000	24000	48000	24000	48000	24000	24000	36000	24000
		3-204-135	2"	30000	30000	60000	30000	60000	30000	30000	45000	30000



- All Swivel Hoist Rings meet or exceed all the requirements of ASME B30.26
- Bolts are metric thread ASME / ANSI B18.3.1 M
- Hoist Ring Bail are designed by forged alloy steel, quenched and tempered
- Each forged part and cap screw have batch coding and are linked to test certificate sheet
- Hoist rings are 360° swivel with 180° pivot function
- Bolt galvanized alternative phosphate treatment
- 20,000 cycle fatigue rated to 1.5 times WLL
- Rated 100% at 90° angle
- 100% magnaflux crack detection
- Self-aligns in direction of load

SWIVEL - HOIST RING, METRIC THREAD, GRADE 80

- Material: Alloy Steel, Grade 80
- Standard: ASME B30.26, Bolt: ASTM A574
- Finish: Dacromet Coated
- Design Factor: 5:1
- Identification: Trademark, Size/WLL, Batch Code, Grade
- Rated in Metric Ton(s)

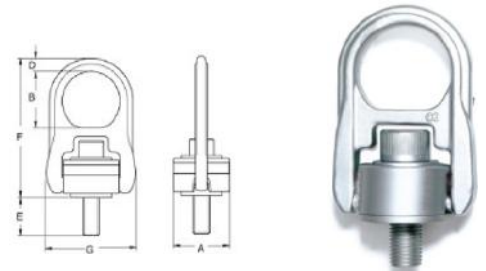

WLL (t)	Thread Size	Torque (Nm)	Dimensions (mm)						Wt./ea. (kg)	Swivel Hoist Ring	
			A	B	D	E	F	G		Price /ea.	Part Number
0.40	M8-1.25 x 50	10	40	41	9	17	102	65	0.4	52.57	3-203-004
0.45	M10-1.50 x 45	16	40	41	9	11	102	65	0.5	57.00	3-203-005
0.45	M10-1.50 x 60	16	40	41	9	26	102	65	0.5	78.10	3-203-005L
1.05	M12-1.75 x 60	38	65	64	15	15	158	105	1.7	125.15	3-203-010
1.05	M12-1.75 x 75	38	65	64	15	30	158	105	1.7	138.15	3-203-010L
1.90	M16-2.00 x 65	81	65	64	15	20	158	105	1.8	138.15	3-203-019
1.90	M16-2.00 x 80	81	65	64	15	35	158	105	1.8	161.40	3-203-019L
2.15	M20-2.50 x 70	136	65	64	15	25	158	105	1.9	148.10	3-203-021
2.15	M20-2.50 x 90	136	65	64	15	45	158	105	2.1	165.77	3-203-021L
3.00	M20-2.50 x 80	136	85	79	19	25	204	134	4.2	288.30	3-203-030
4.20	M24-3.00 x 80	312	85	79	19	26	204	134	4.2	330.37	3-203-042
4.20	M24-3.00 x 105	312	85	79	19	56	204	134	4.3	365.00	3-203-042L
7.00	M30-3.50 x 135	637	100	100	25	81	241	160	6.7	436.50	3-203-070
11.00	M36-4.00 x 160	1005	120	111	30	76	286	194	15.5	925.95	3-203-110
12.50	M42-4.50 x 175	1005	120	111	30	65	286	194	16.5	922.50	3-203-125
13.50	M48-5.00 x 190	1350	120	111	30	70	286	194	16.8	955.00	3-203-135

- Minimum Ultimate Load is 5 times the Working Load Limit
- Proof Load is 2.5 times the Working load Limit
- The depth of thread needs to be a minimum of 1 times the thread diameter for steel, 1.25 times for cast iron, 2 times for aluminum

SWIVEL - HOIST RING, UNC THREAD (OCEAN), GRADE 80

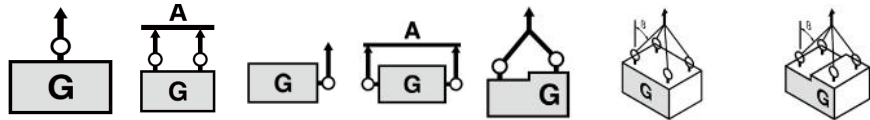

# of Leg	Load Direction	Item No.	Thread (in)	WLL (lb)	1		2		3-4			
					0°	0°	90°	90°	45-60°	unsym.	45-60°	unsym.
		3-203-004	M 8	0.40	0.5	1.0	0.5	1.0	0.5	0.5	0.75	0.5
		3-203-005	M 10	0.45	0.55	1.1	0.55	1.1	0.55	0.55	0.83	0.55
		3-203-010	M 12	1.05	1.3	2.6	1.3	2.6	1.3	1.3	1.95	1.3
		3-203-010L	M 12	1.05	1.3	2.6	1.3	2.6	1.3	1.3	1.95	1.3
		3-203-019	M 16	1.90	2.4	4.8	2.4	4.8	2.4	2.4	3.60	2.4
		3-203-019L	M 16	1.90	2.4	4.8	2.4	4.8	2.4	2.4	3.60	2.4
		3-203-021	M 20	2.15	2.7	5.4	2.7	5.4	2.7	2.7	4.05	2.7
		3-203-021L	M 20	2.15	2.7	5.4	2.7	5.4	2.7	2.7	4.05	2.7
		3-203-030	M 20	3.00	3.75	7.5	3.75	7.5	3.75	3.75	5.63	3.75
		3-203-042	M 24	4.20	5.25	10.5	5.25	10.5	5.25	5.25	7.88	5.25
		3-203-042L	M 24	4.20	5.25	10.5	5.25	10.5	5.25	5.25	7.88	5.25
		3-203-070	M 30	7.00	8.75	17.5	8.75	17.5	8.75	8.75	13.13	8.75
		3-203-110	M 36	11.00	13.75	27.5	13.75	27.5	13.75	13.75	20.63	13.75
		3-203-125	M 42	12.50	15.6	31.2	15.6	31.2	15.6	15.6	23.40	15.6
		3-203-135	M 48	13.50	16.9	33.8	16.9	33.8	16.9	16.9	25.35	16.9

Rated in Metric Ton(s)