



goTenna Mesh 5.0 User Manual

Table of Contents

Welcome to the Mesh Network!

What is goTenna Mesh?	4
Hardware Specs	5
Onboarding & Initial Setup	6
Having Trouble Pairing?	10

Chat

1-to-1 Chat	12
Group Chat	14
Shout Chat	16
Emergency Chat	17

Emergency Beacon

Send an Emergency Beacon	18
--------------------------	----

Contacts

Create a Contact	20
------------------	----

Mapping & Location

Download a Map	21
Delete a Downloaded Map	22
Find your Location	23
Create a Pin	24
Share your Location	25

Settings

Settings	28
Confirm your goTenna Firmware is Up-to-Date	30
Pair your goTenna Mesh Device	31
Unpair your goTenna Mesh Device	32

Stationary Relay Mode 34

goTenna Plus Features

Location Tethering	36
SMS Network Relay	38
Trip Statistics	40
Topographic Maps	42

Welcome to the Mesh Network!

In this manual, you'll find information to help orient yourself with your goTenna Mesh. You'll learn about the goTenna Mesh device, how to set up and use the goTenna app, and how your device works in conjunction with the app.

What is goTenna Mesh?

goTenna Mesh is the first 100% off-grid, mobile, long-range, consumer-ready mesh network. The device pairs with smartphones to enable communication among users without any reliance on cell towers, WiFi routers, or satellites. Additionally, goTenna Mesh enables automatic and private message relay, effectively doubling or tripling any device's range, creating a network that gets stronger the more people join it.

Hardware Specs



DIMENSIONS

4.2 × 0.9 × 1.3 in (106.5 × 18 × 13 mm)

WEIGHT

1.7 oz (48 g)

WEATHERPROOF

Onboarding & Initial Setup

You can download the goTenna app through the Apple App Store or the Google Play Store. Access to WiFi or 4G-LTE is required to download the app. The first time you open the goTenna app, you'll be prompted to create a goTenna account and pair your goTenna Mesh device.

Android

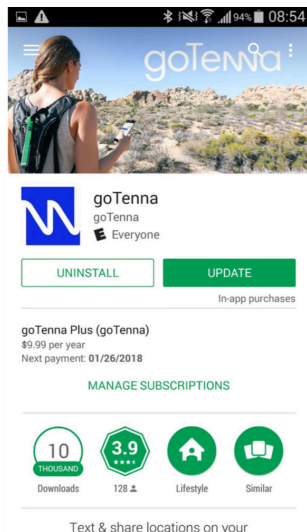

If you have an Android device, you can download the app in the Google Play Store.

iPhone

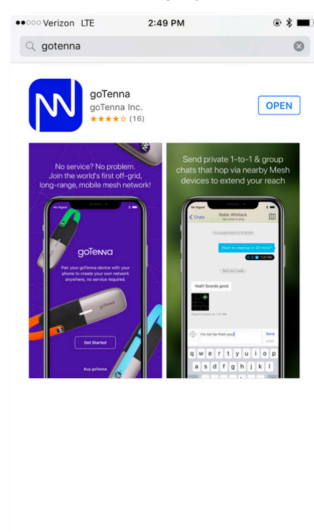

If you have an iPhone, you can download the app in the Apple App Store.

Step 3

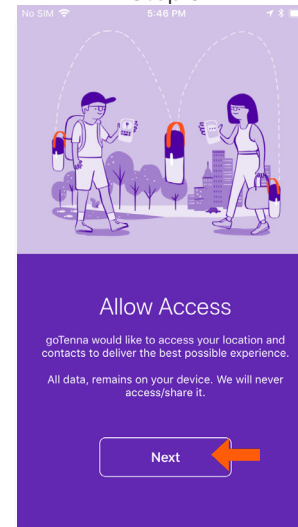

Select **'Next'** to allow location & contact access.

Step 4

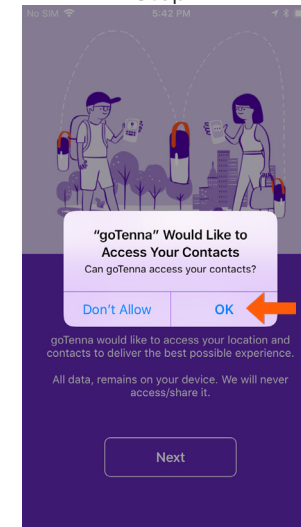

Select **'OK'** for goTenna to access your contacts.

Step 1



Select **'Get Started'**.

Step 2

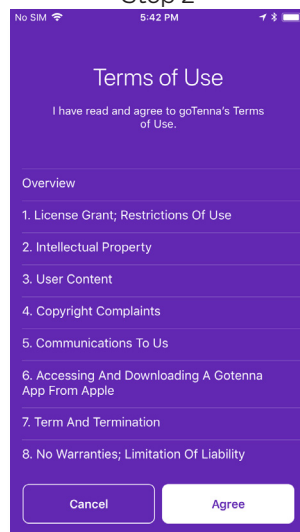

To use the goTenna app, you'll need to select **'Agree'** to the Terms of Use.

Step 5

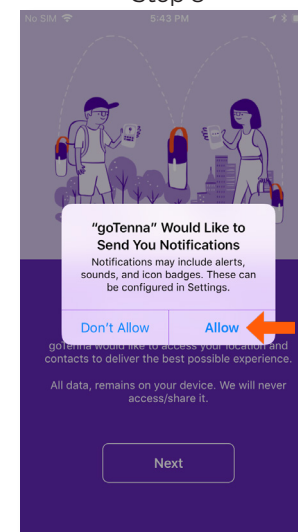

Select **'Allow'** to allow goTenna to send you notifications.

Step 6

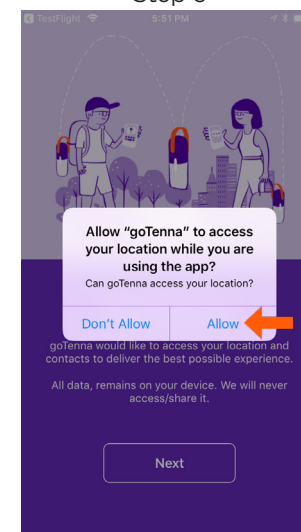

Select **'Allow'** to allow goTenna to access your location.

Step 7

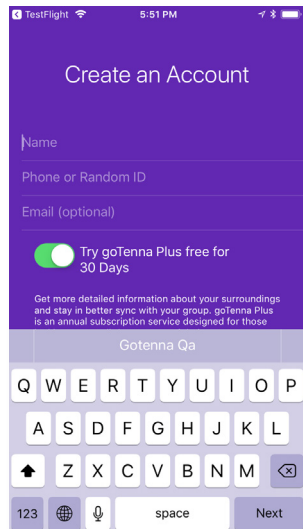

Enter your phone number (recommended) or have goTenna create a randomly generated ID. If you entered your phone number, you'll be asked to verify your phone number via SMS text.

Step 8

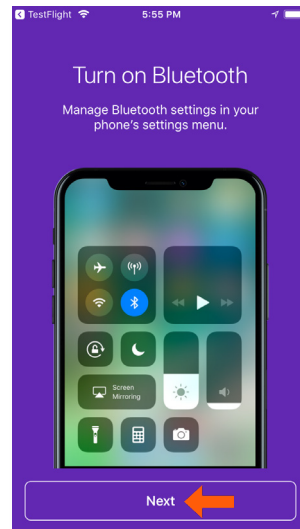

Never pair your goTenna Mesh through your bluetooth settings, always pair directly through the goTenna app. Select '**Next**'.

Step 11

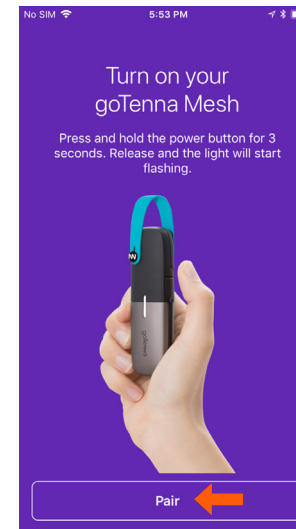

Hold down the power button until the white light turns on. Select '**Pair**' to pair with your goTenna Mesh device.

Step 12

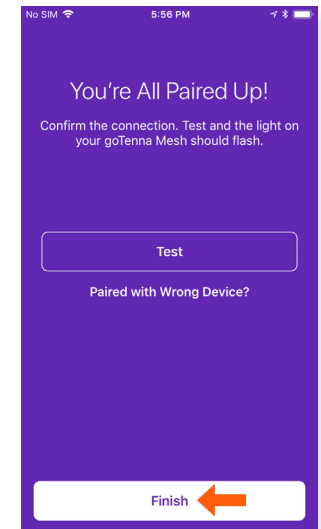

Once your device pairs, you are finished. Select '**Finish**'.

Step 9



Select '**goTenna Mesh**'.

Step 10

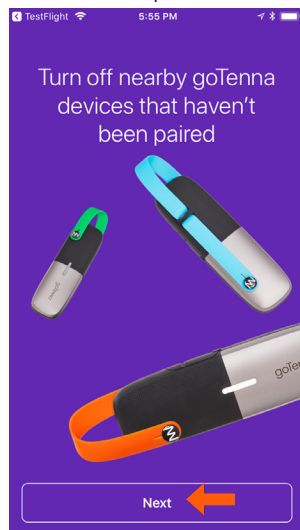

Turn off nearby goTenna devices that haven't been paired. In order to pair seamlessly, you should only pair one device at a time. Select '**Next**'.

Step 13

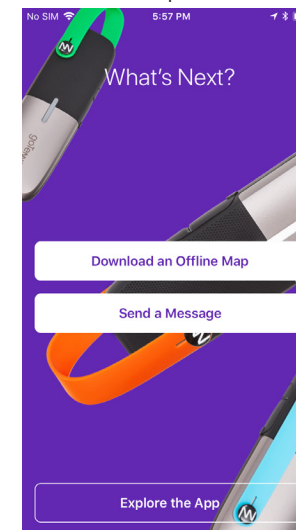

On this page you have the option to download an offline map, send a message, or continue exploring the app.

Having Trouble Pairing?

If you have trouble pairing, make sure you have location services enabled for the goTenna app.

If you continue to have trouble, try pairing the goTenna Mesh device to another device. This will help determine what settings you need to update on your first device.

If this does not work, close the goTenna app, reset your device's network settings, then power your device off/on. Open the goTenna app and attempt setup again.

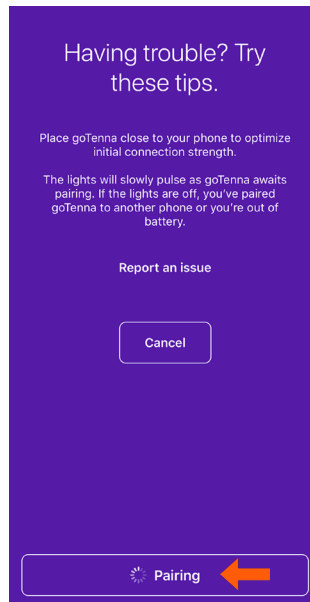

Place goTenna close to your phone to optimize initial connection strength. The light will slowly pulse as goTenna awaits pairing. If the light is off, you've paired goTenna to another phone or do not have sufficient battery.

Chat

1-to-1 Chat

A 1-to-1 Chat is a private, encrypted message between you and another goTenna Mesh user. They are automatically meshed via other goTenna Mesh devices if the person you are trying to reach is not directly within range.

Step 1

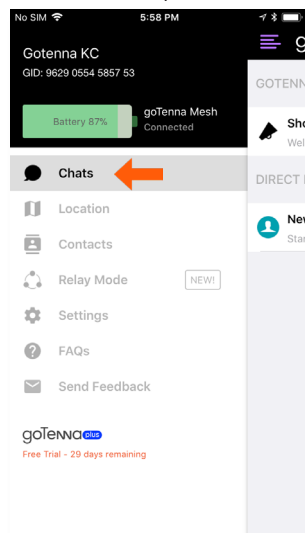

Select **'Chats'** from the side menu.

Step 2

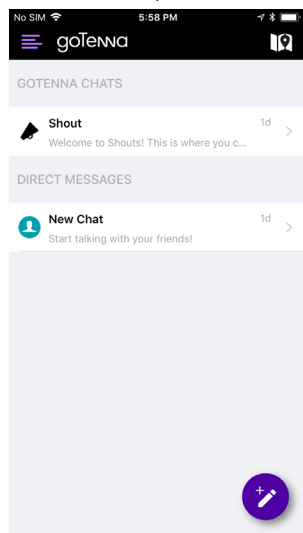

Choose an existing chat or create a new chat.

Step 3

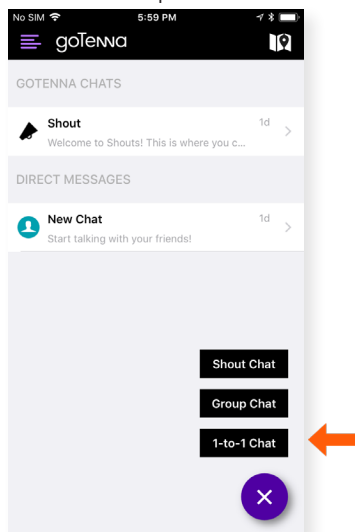

Select **'1-to-1 Chat'**.

Step 4

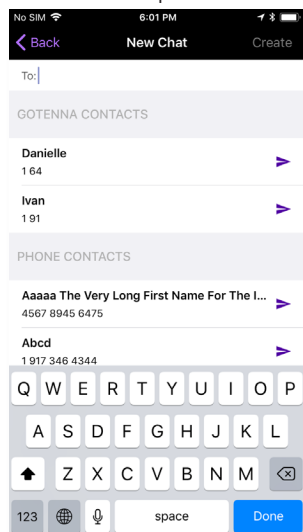

Select the intended recipient.

Step 5

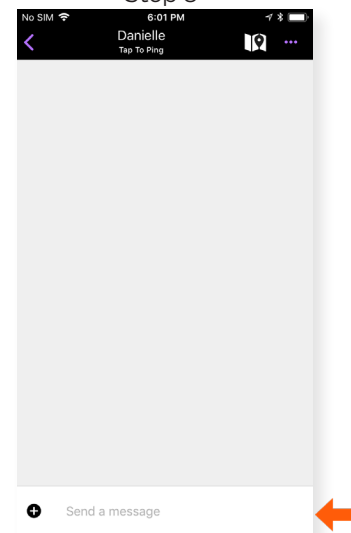

Type your message.

Step 6

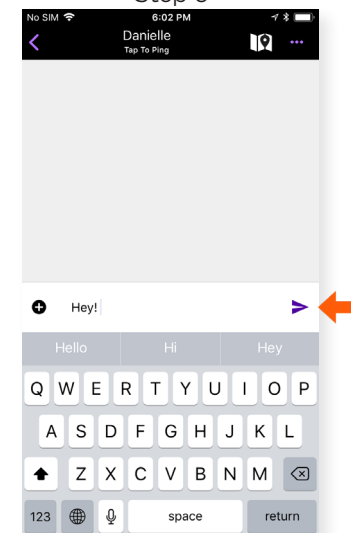

Select the send button.

Step 7

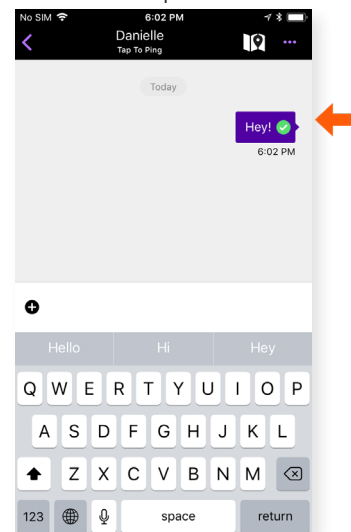

A green check mark shows it was successfully delivered.

Group Chat

Group Chat is a private message shared between you and up to 9 additional contacts. Like 1-to-1 Chats, Group Chats are end-to-end encrypted and mesh.

Step 1

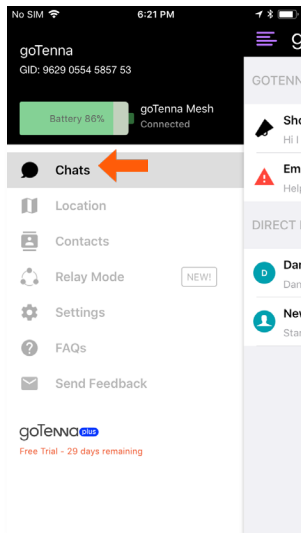

Select '**Chats**' from the side menu.

Step 2

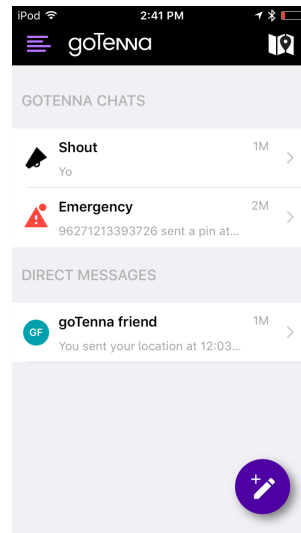

Click the compose icon.

Step 5

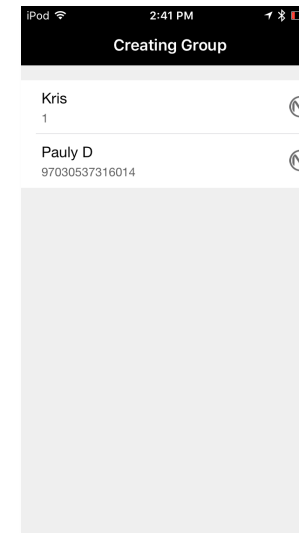

Group chat contacts must be within range and connected to a goTenna Mesh.

Step 6

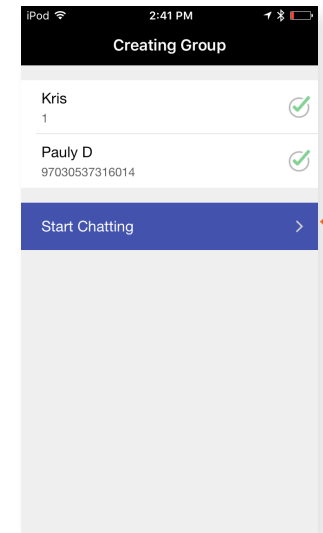

Select '**Start Chatting**'.

Step 3

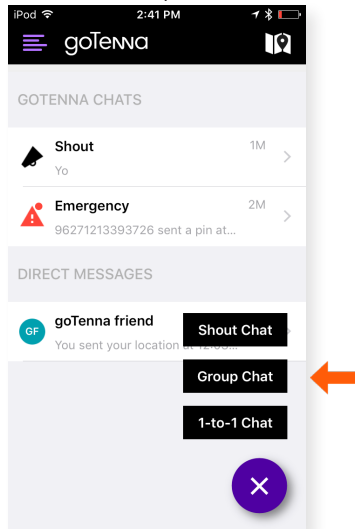

Select '**Group Chat**'.

Step 4

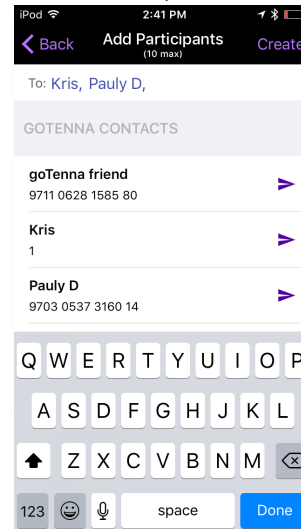

Choose the contacts you want to include and select '**Create**'.

Step 7

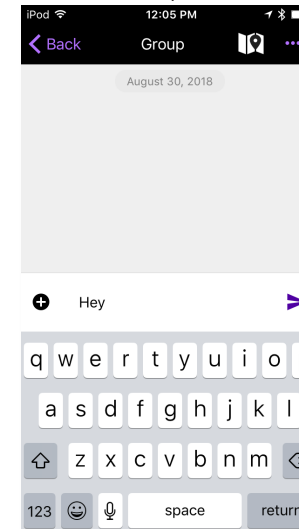

Type your message.

Step 8

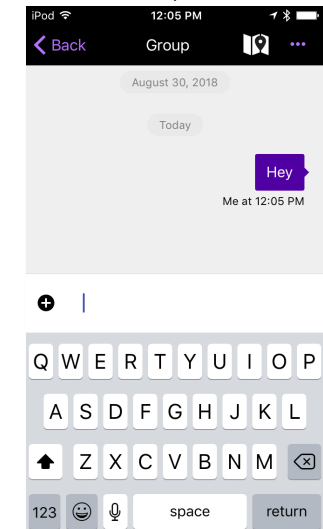

Send your message. Delivery confirmation is not supported for Group Chats.

Shout Chat

Shout Chat allows you to publicly broadcast to any goTenna Mesh user within range. Because these messages are public, they are not end-to-end encrypted and any user within range will receive it. Shout Chats do not mesh.

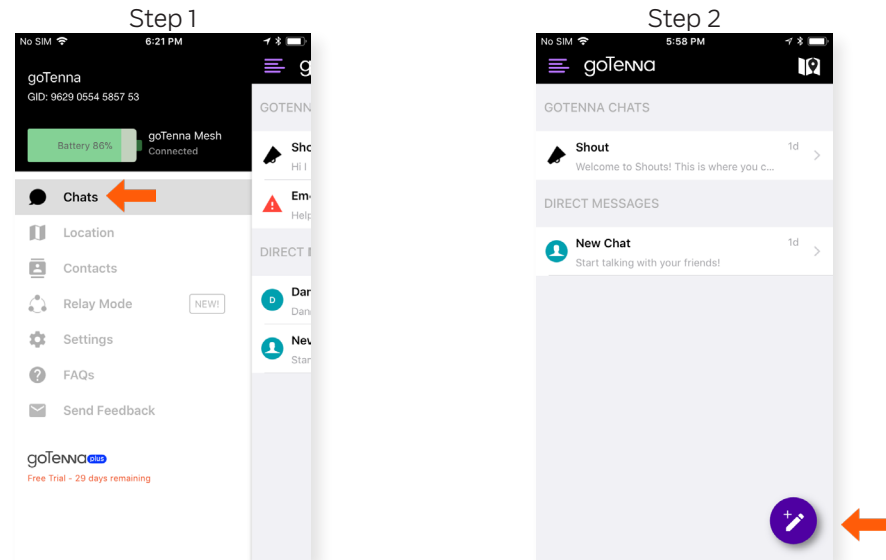

Select **'Chats'** from the side menu.

Click the compose icon.

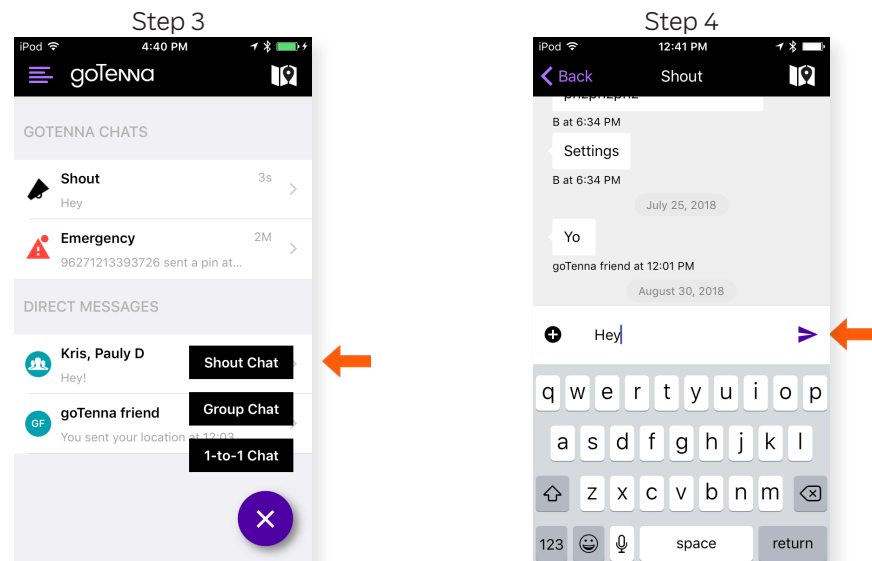

Select **'Shout Chat'**.

Type your message. Send your message. Delivery confirmation is not supported for Shout Chats.

Emergency Chat

Emergency Chat transmits messages to all goTenna Mesh users within range. These messages mesh through other goTenna Mesh devices to extend their range. **Only use Emergency Chat during emergencies.**

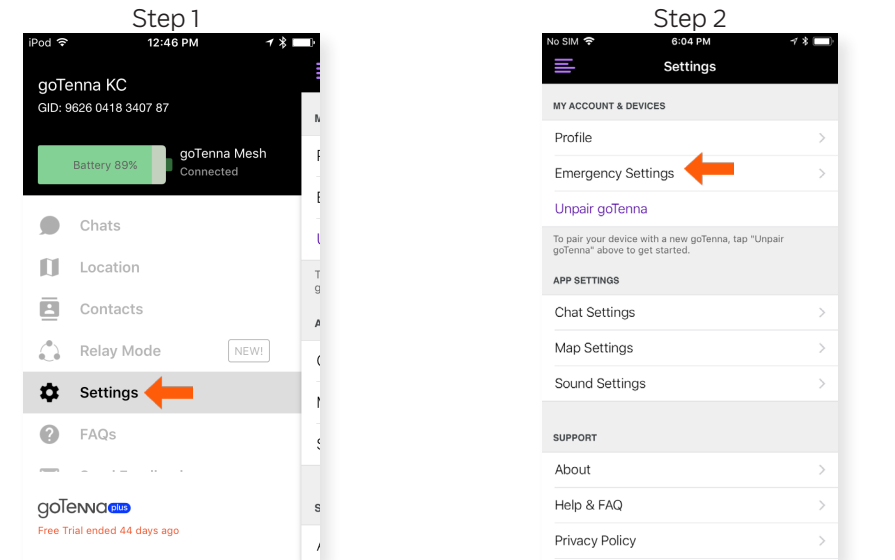

Select **'Settings'** from the side menu.

From the Settings menu, select **'Emergency Settings'**.

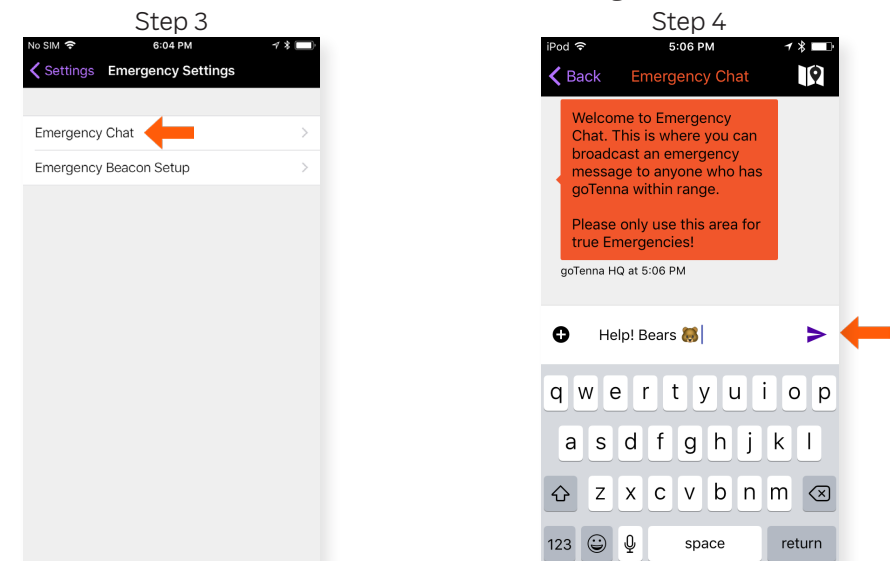

Select **'Emergency Chat'**.

Type and send your message.

Emergency Beacon

The 'Push for help' Emergency Beacon system allows you to broadcast a custom Emergency Beacon along with your location and critical info to all goTenna Mesh users within range (emergency messages always travel 6 hops!). Tapping the power button on your device 5 times allows you to broadcast your Emergency Beacon. You can customize the message in settings. **Only use Emergency Beacon during emergencies.**

Send an Emergency Beacon

Step 1

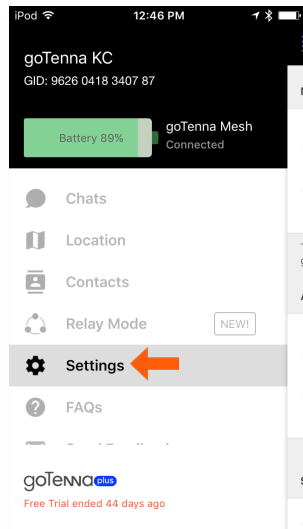

Select '**Settings**' from the side menu.

Step 2

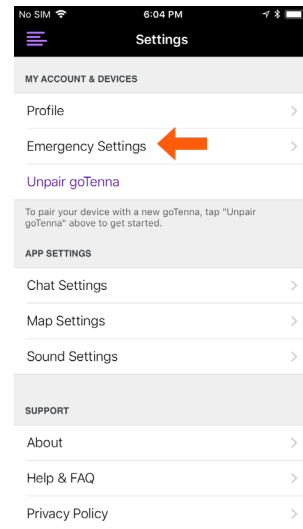

From the Settings menu, select '**Emergency Settings**'.

Step 3

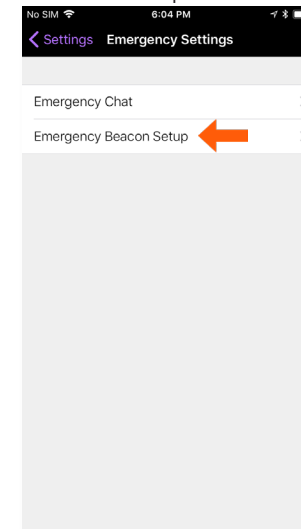

Select '**Emergency Beacon Setup**'.

Step 4

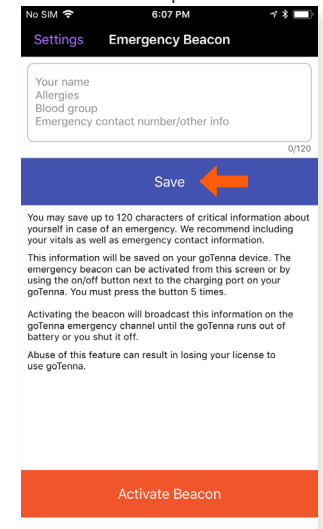

Type your info and select '**Save**'.

Contacts

You can access and manage your goTenna contacts from the side menu. If you haven't allowed the goTenna app access to your contacts, you'll need to manually add contact information.

Create a Contact

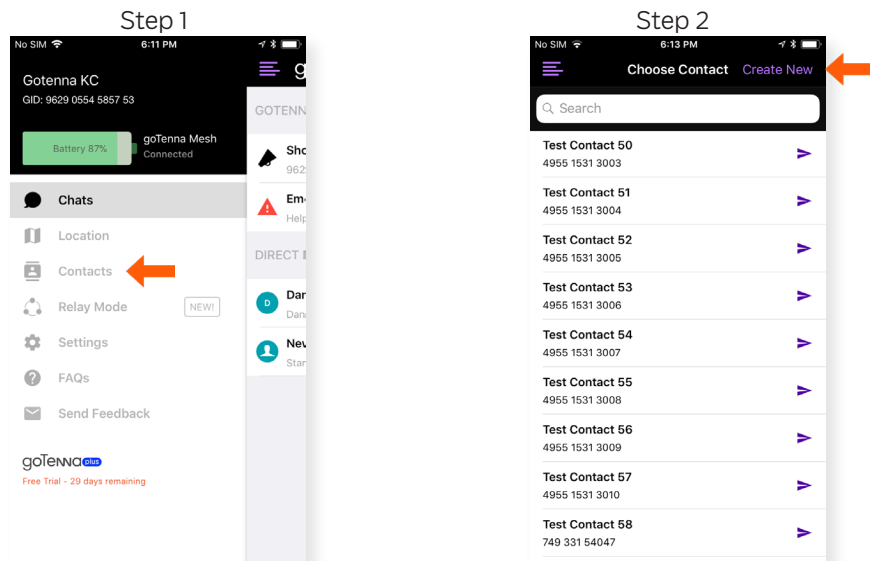

Select '**Contacts**' from the side menu.

Tap '**Create New**' in the upper right corner.

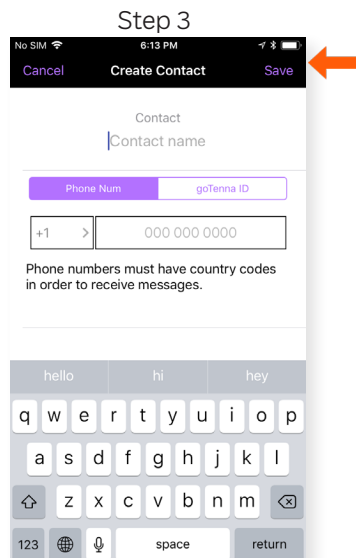

Type the contact info and select '**Save**'.

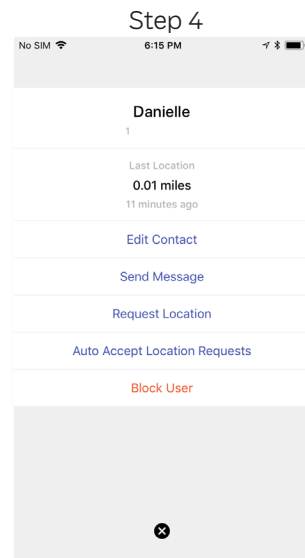

You can edit, send a message, request location, auto accept location requests, or block the user.

Mapping & Location

The goTenna app allows you to download free, detailed maps of anywhere in the world that can be used entirely offline. Maps must be downloaded first with WiFi or LTE. Once the map is installed within the app, you can use it 100% offline.

Download a Map:

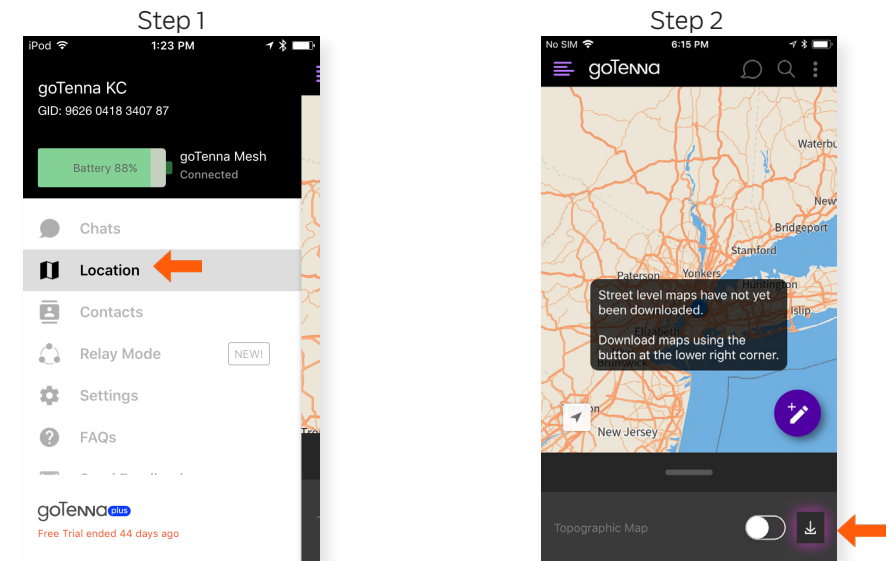

Select '**Location**' from the side menu.

Select the download icon on the bottom right.

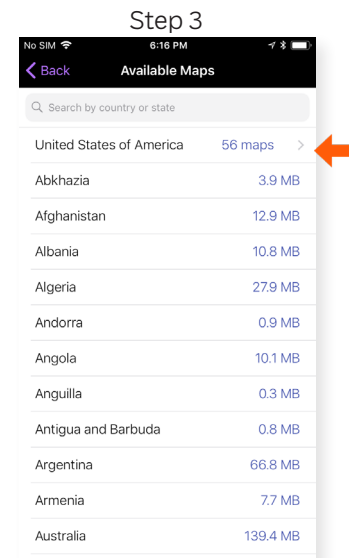

Select the country and state of the map you'd like to download.

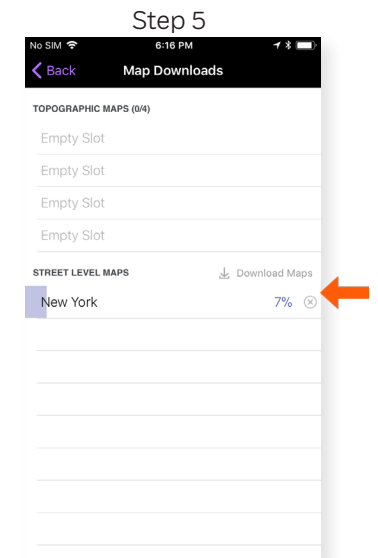

Your map will be downloaded and saved here.

Delete a Downloaded Map:

Step 1

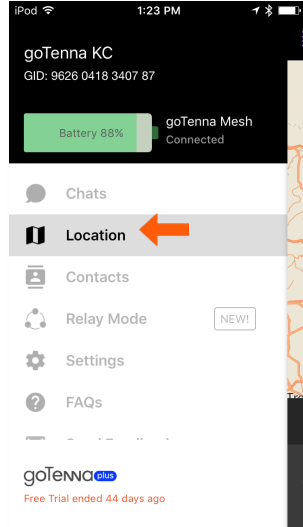

Select **'Location'** from the side menu.

Step 2

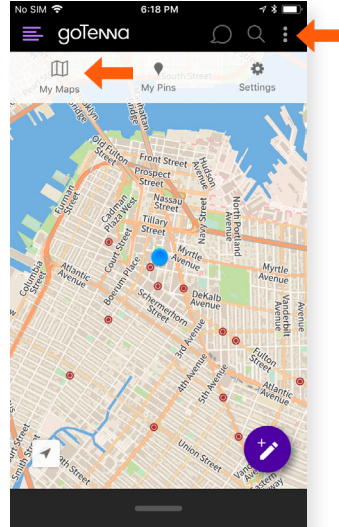

Select the three dot icon in the upper right corner, then select **'My Maps'**.

Step 3

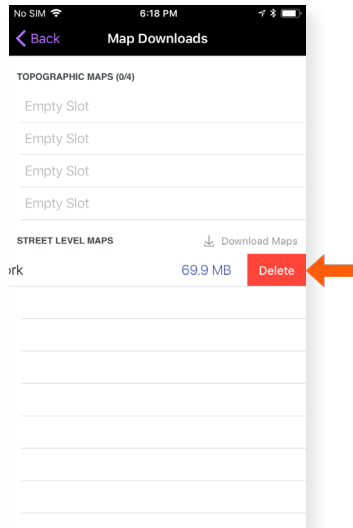

Under Street Level Maps, swipe left on the map you would like to delete and select **'Delete'**.

Step 4

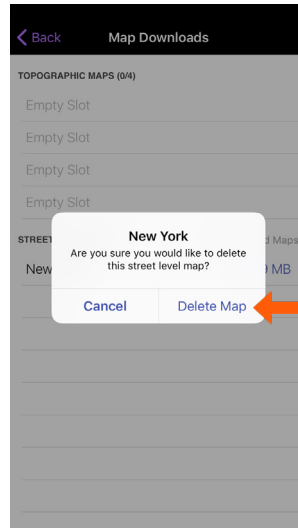

Select **'Delete Map'**.

Find your Location:

Step 1

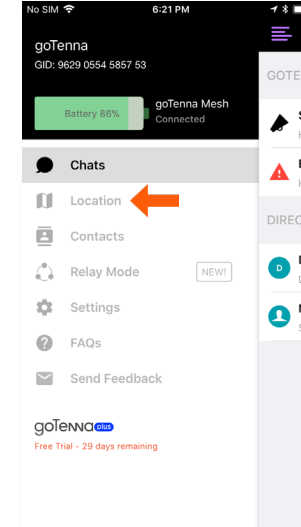

Select **'Location'** from the side menu.

Step 2

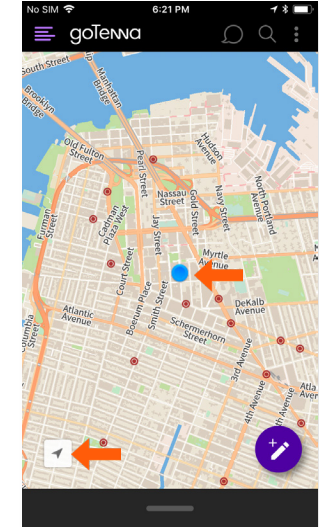

Tap the arrow icon in the lower left corner of the map. Your location will be displayed by a blue dot.

Create a Pin:

Share your Location:

You can follow these steps to auto-accept location requests, request a user's location, attach a pin, or attach your location.

Step 1

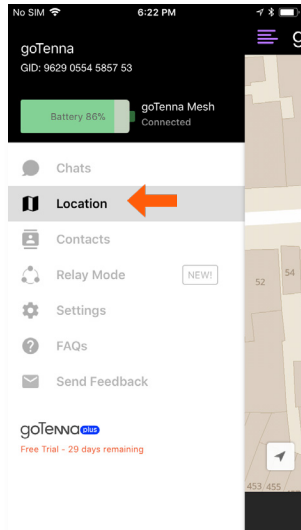

Select '**Location**' from the side menu.

Step 2

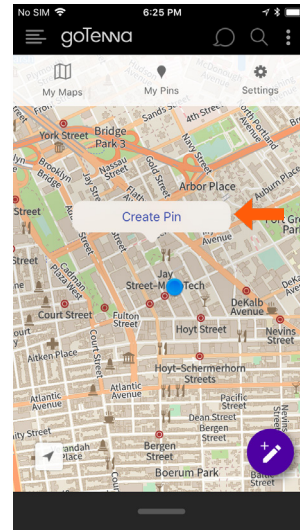

Drop a pin by long pressing the location where you'd like to create a pin. Tap '**Create Pin**' when the bubble pops up.

Step 3

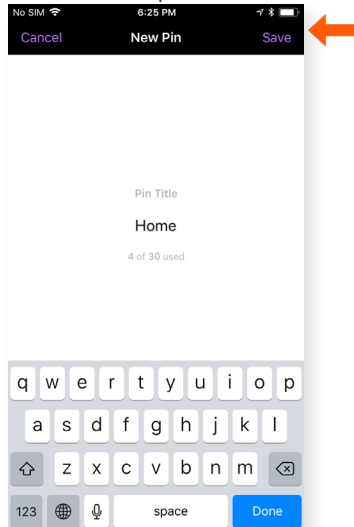

Create a name for your pin under Pin Title. Select '**Save**' in the upper right corner of the screen.

Step 4

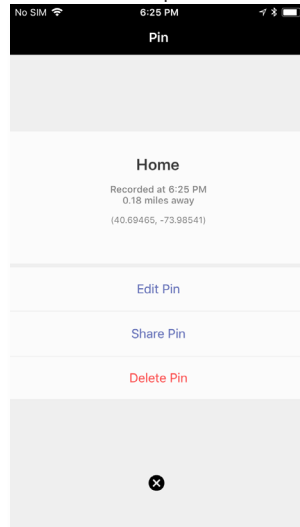

You now have the option to edit, share, or delete the pin. Alternatively, you can exit the screen by selecting the **X** icon at the bottom of the screen.

Step 1

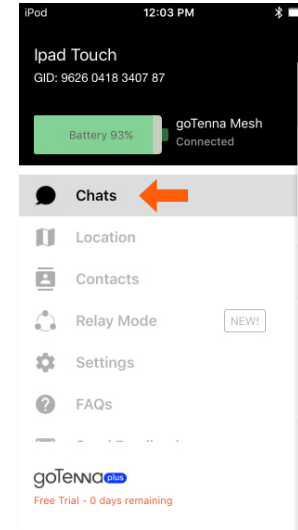

Select '**Chats**' from the Side Menu.

Step 2

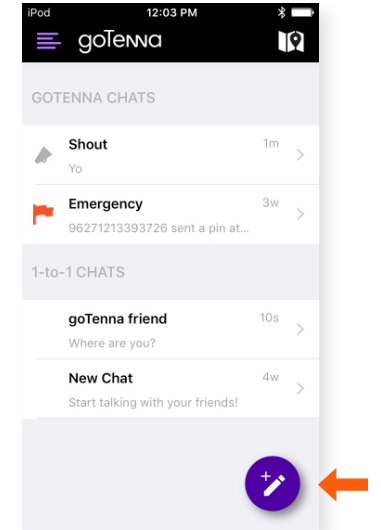

Choose an existing chat in which you'd like to share a location, or create a new chat by clicking the compose icon at the bottom right corner of the screen.

Step 3

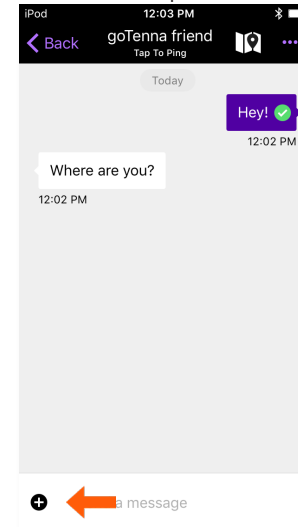

Select the plus icon to the left of the text box.

Step 4

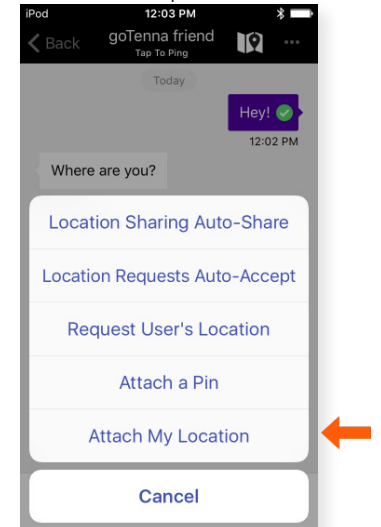

Select '**Attach My Location**' or any of the location sharing options.

Step 5

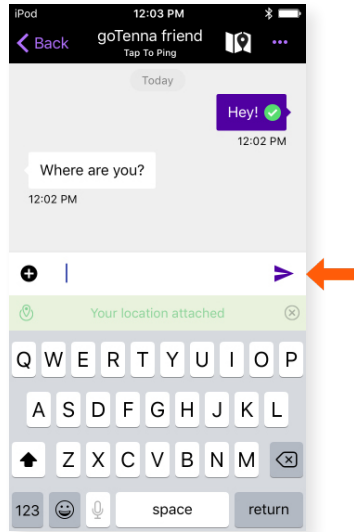

Type a message if desired.
Select the send button.

Step 6

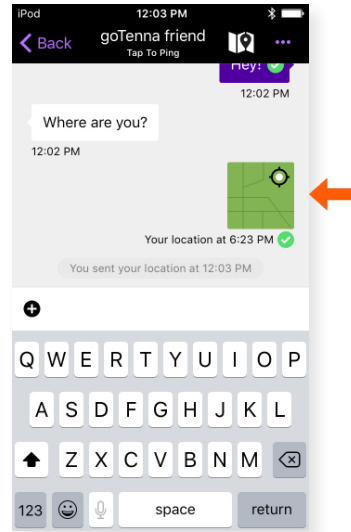

Click on the location to view
the map.

Settings

Within Settings you can fine tune your goTenna app.

MY ACCOUNT & DEVICES:

- Profile - Username, Phone Number or GID, Last Shared Location, Email Updates
- Emergency Settings - Emergency Chat, Emergency Beacon Setup
- Pair/Unpair goTenna

APP SETTINGS:

- Chat Settings - Shouts (Accept/Don't Accept Incoming), Block List
- Map Settings - Downloaded Maps, Saved Pins, Units, Saved Trips
- Sound Settings - Sounds (On/Off), Vibration (On/Off), Sending Messages Tones, Receiving Messages Tones

SUPPORT:

- About - App Information (App Version, Build Number, Install Date, Source), Device Information (Battery, Serial, Firmware Installed, Region)
- Help & FAQ - Answers to questions regarding Messaging, Maps & Location, Range & Performance, etc.
- Privacy Policy
- Logout - If you log out, you'll need to undergo account setup again to use goTenna Mesh.

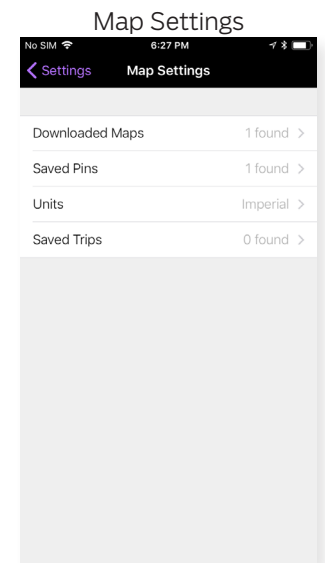
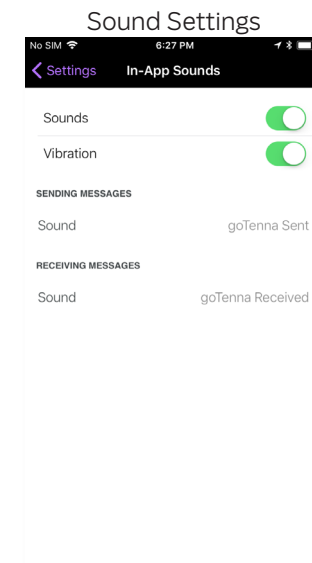
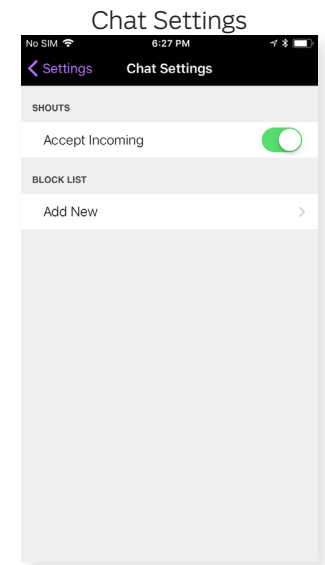
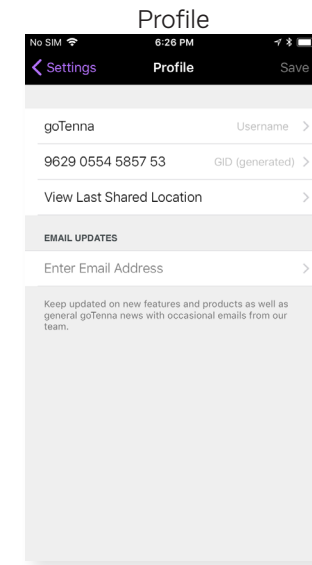

Confirm your goTenna Firmware is Up-to-Date:

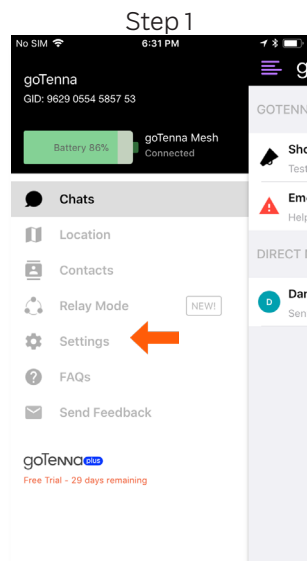

Select **'Settings'** from the Side Menu.

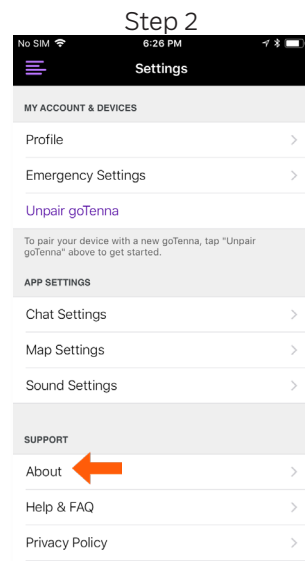

Select **'About'**.

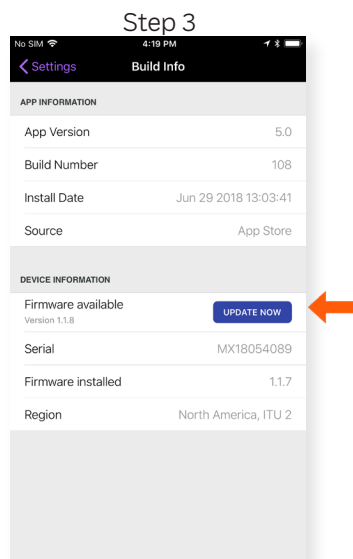

If you need to update your firmware, you'll see a blue button that says **'UPDATE NOW'**. Select this button to update your firmware. If you don't need to update, you'll see the latest firmware version listed with no action button.

Pair your goTenna Mesh Device:

Turn your goTenna Mesh device on. When the light is blinking on your goTenna Mesh device, follow these steps:

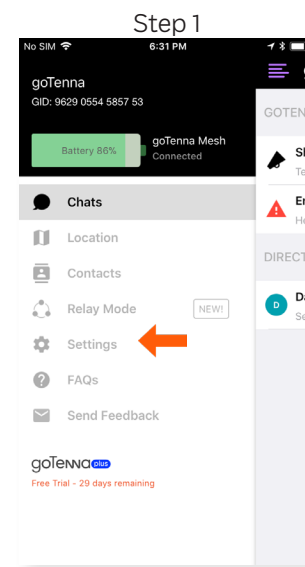

Select **'Settings'** from the Side Menu.

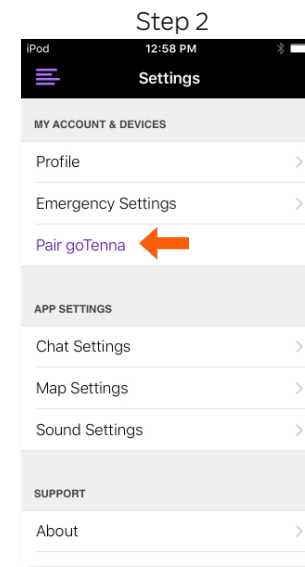

Select **'Pair goTenna'**.

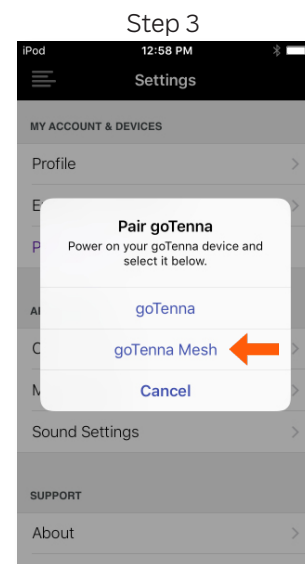

Select **'goTenna Mesh'**. You should only attempt to pair one goTenna Mesh device at a time.

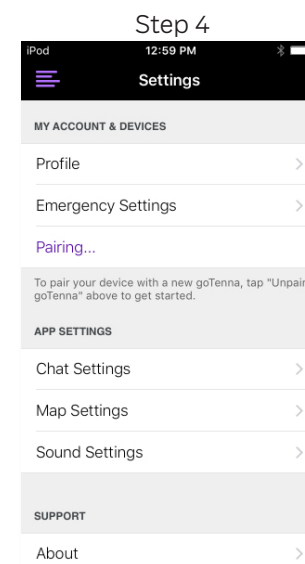

goTenna Mesh will pair.

Unpair your goTenna Mesh Device:

Step 1

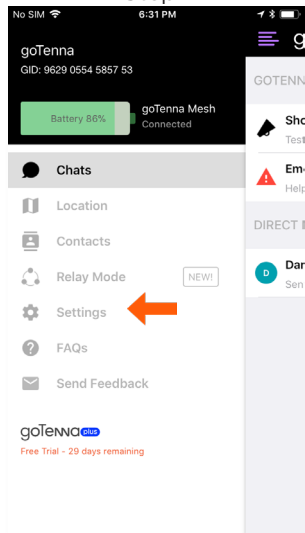

Select '**Settings**' from the Side Menu.

Step 2

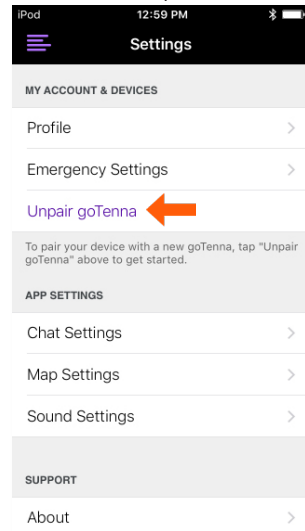

Select '**Unpair goTenna**'.

Step 3

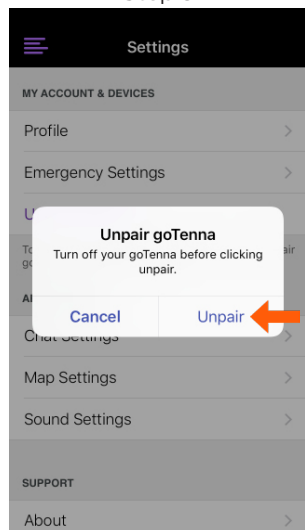

Select '**Unpair**'.

Stationary Relay Mode

Your goTenna Mesh device can be set up as a dedicated relay node in order to increase range. A goTenna Mesh device does NOT need to be actively paired to a device to serve as a relay node, but it does have to be powered on.

1-to-1 Chat, Group, and Emergency Chat will relay through other goTenna Mesh devices or through goTenna Mesh devices that are set up in Stationary Relay Mode. Shouts do not relay.

To set up Stationary Relay Mode:

1. Turn on your goTenna Mesh device by pressing and holding the power button on the side of the device for 3 seconds until the light turns on.
2. Triple-press the power button and wait for the light to stay on. Once the light stays on, quickly triple-press the power button once again to confirm Stationary Relay Mode. The light will blink 3 times then turn off.

To confirm Stationary Relay Mode is on at any point, press the power button and the light will blink 3 times.

To deactivate Stationary Relay Mode:

1. Press and hold the power button on your goTenna Mesh device for 5 seconds until the light turns off.
2. Turn the goTenna Mesh device back on by holding the power button for 3 seconds until the light turns on.
3. When the light is blinking, you can re-pair your goTenna Mesh device to your smartphone to continue using all the app features.

Users can also now 'pair' to a relay node in order to view battery life. When a node is set up as a relay, any pairing that occurs does not take the goTenna Mesh device out of Stationary Relay Mode. This pairing can ultimately be done "in passing".



goTenna Plus Features

goTenna Plus is our subscription service that gives users access to Location Tethering, SMS Network Relay, Trip Statistics, and Topographic Maps. You can receive a free 30-day, no-strings-attached trial to test out these features.

Location Tethering:

This feature broadcasts a user's location every 1-10 minutes for up to 12 hours to designated recipients. The times are customizable upon setup.

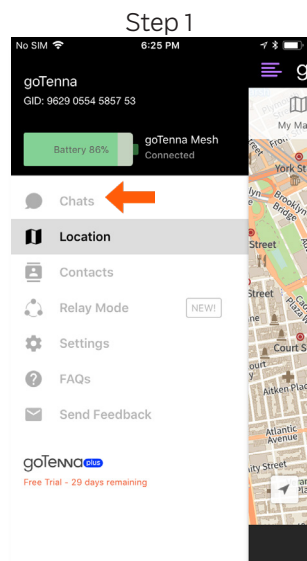

Select '**Chats**' from the Side Menu.

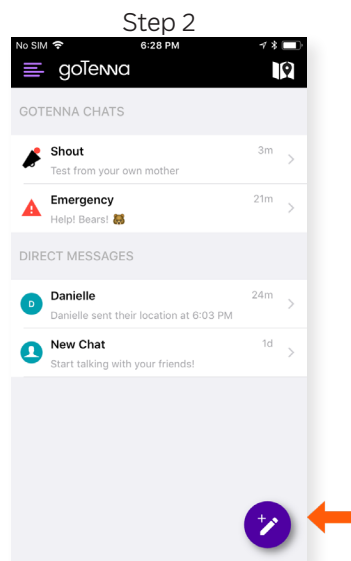

Create a new chat, or select the existing chat with the user you'd like to location tether with.

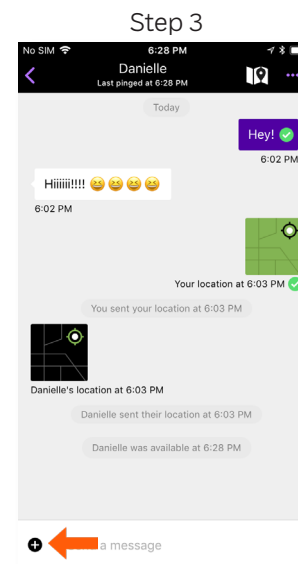

Select the plus icon to the left of the text box.

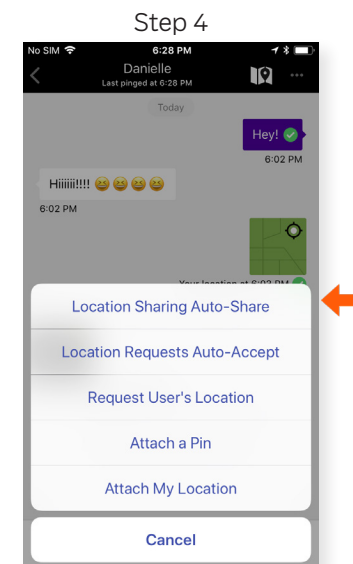

Select '**Location Sharing Auto-Share**'.

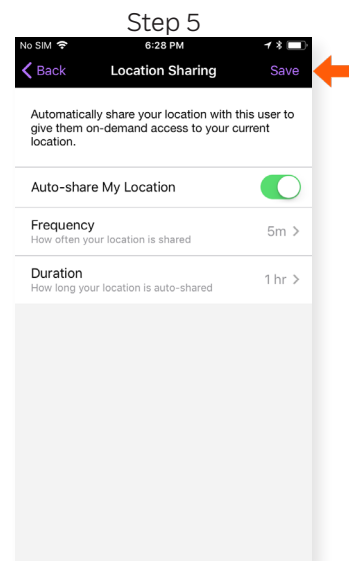

From here, you'll toggle location tethering on/off. Select the frequency (every 1, 5, or 10 minutes) & duration (15, 30 minutes, or any duration between 1 - 12 hours) at which you'd like to update and share your location.

SMS Network Relay

SMS Network Relay enables users to send messages to other users that are not within range or using goTenna Mesh by utilizing another goTenna Mesh user's internet connection to send out SMS messages. Messages sent out via SMS Network Relay will show confirmation with a green check mark and will appear in the user's text messaging application.

Send a Message via SMS Network Relay:

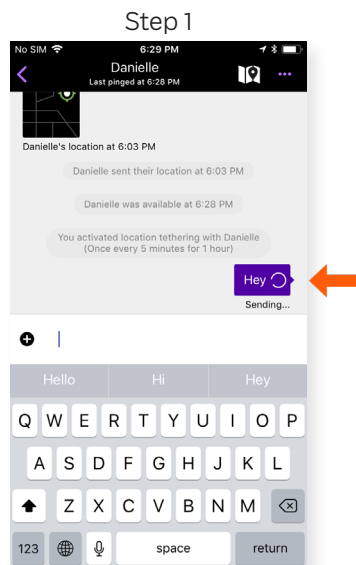

Open a chat message and send a message.

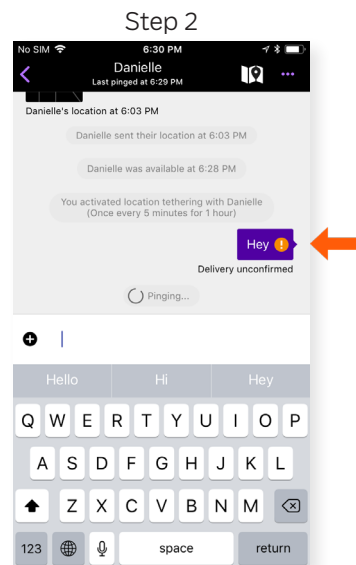

When the message is marked as '**Delivery unconfirmed**', select the orange exclamation point.

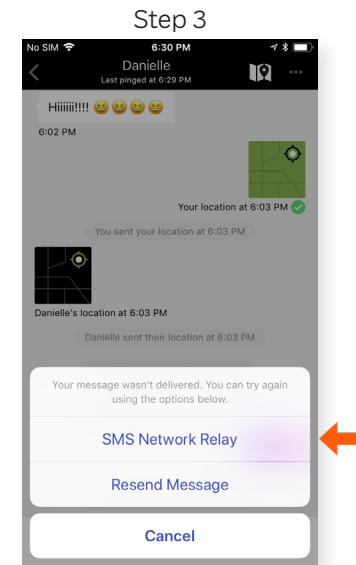

Select '**SMS Network Relay**'.

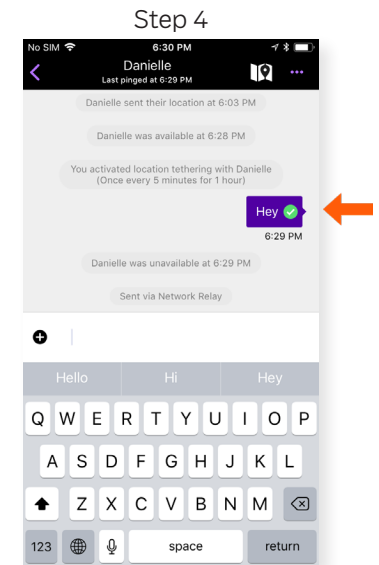

Your message will be sent via SMS. You'll see a green check mark when the message is confirmed as sent. If delivery cannot be confirmed, you'll see '**Delivery unconfirmed**'.

Trip Statistics

Enabling trip statistics will record your exact trip and document it along the way. Statistics visible at the bottom of the screen can be changed by the user. Options include: altitude, stopped time, moving time, distance, current speed, average speed and pace. Saving your trip will reveal all options on one summary page.

Record Trip Statistics:

Step 1

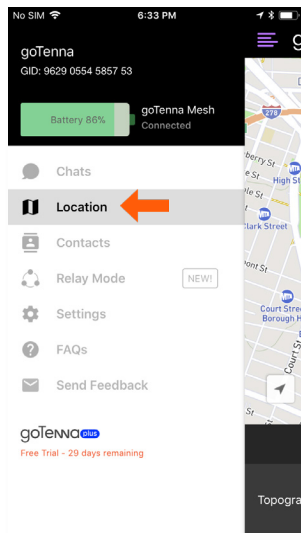

Select '**Location**' from the Side Menu.

Step 2

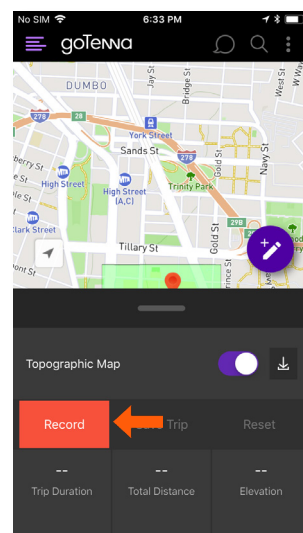

Swipe up on the black bottom bar. Tap '**Record**' to begin recording your trip. When recording, this button will show '**Recording...**'.

Step 4

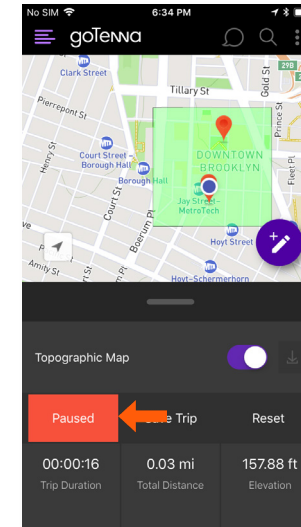

To pause recording, tap '**Recording...**', which will then show '**Paused**'. To reset your trip, tap '**Reset**'.

Step 5

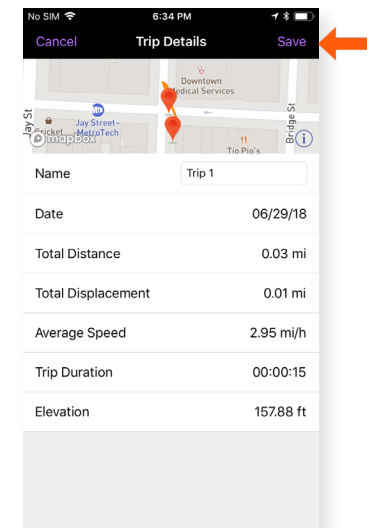

To save your trip, tap '**Save**'.

Topographic Maps:

Step 1

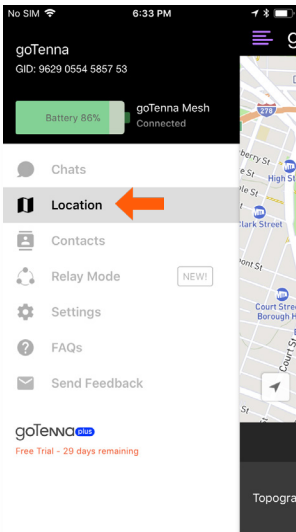

Select '**Location**' from the Side Menu.

Step 2

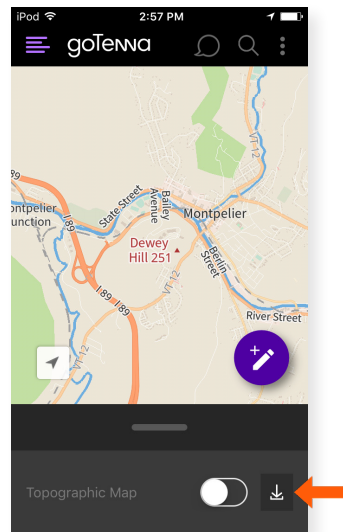

Toggle '**Topographic Map**'.

Step 3

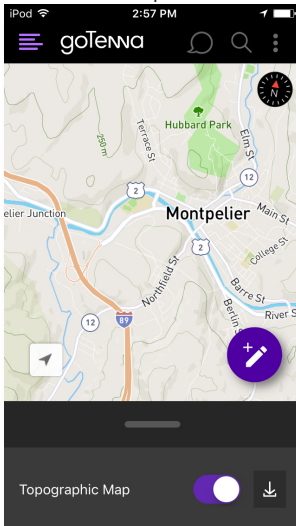

Here is the Topographic Map.