



WideMAXX™ Suspension Kit

Tip: Refer to the exploded views included with your truck to assist with installation of the Wide Maxx® Suspension Kit.

Suspension Tuning

1. Remove the two front and two rear shocks from the truck.
2. Remove the shock springs from all four shocks. Install the rear shock springs on the front shocks. **The front springs are not used with the Wide Maxx suspension.**
3. Install the new shock springs (included) on the rear shocks.
4. For optimal suspension performance, replace the 30wt silicone shock oil in the rear shocks with 50wt silicone shock oil (part #5034, sold separately). Be sure to fill the shocks with 100% pure silicone shock oil to help prolong the life of the seals. When adding shock oil, be sure to allow any air bubbles to escape. **Note: The rear shocks use the 1.2mm shock piston.**
5. Reinstall the front and rear shocks on the truck.

If you have questions or need technical assistance, call Traxxas at

1-888-TRAXXAS

(1-888-872-9927) (U.S. residents only)

Covers Part #8995, 8995A, 8995G, 8995R, 8995T, 8995X

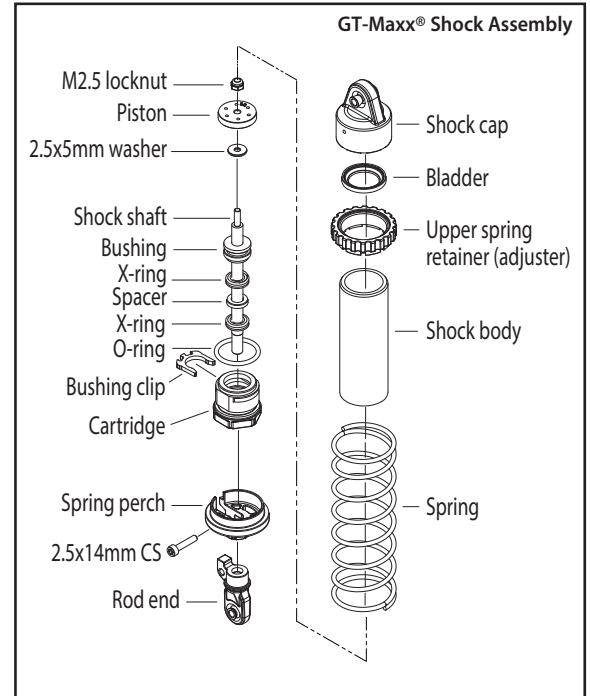
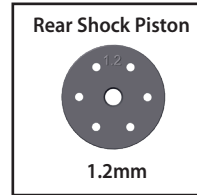

TRAXXAS.COM

Traxxas, 6250 Traxxas Way, McKinney, TX 75070, Phone: 972-549-3000, Fax: 972-549-3011, e-mail: support@Traxxas.com

KC2776-R02 Rev 191209