

H-SERIES, J-SERIES, V-SERIES

AIRSTAGE Mobile Wireless LAN Adapter

UTY-TFSXH4 (Wall Mount Indoor Unit / USB Type)

UTY-TFSXJ4 (Non-Wall Mount Indoor Unit / UART Type)



AIRSTAGE Mobile



Control, simplified

Clean interface enables effortless system management.



Home screen



Mode change



Fan speed change



Weekly timer



System Diagram

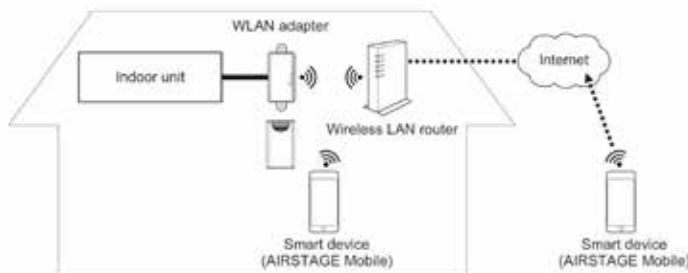

Compatible Indoor Units

H-Series: UTY-TFSXH4: ASUG**LMAS, ASUG**LZAS, ASUG**LZBS, ASUH**LMAS, ASUH**LPAS

UTY-TFSXJ4: ACUH**LUAS1, ADUH**LUAS1, AMUG**LMAS, ARU**RGLX, ARUH12LUAS, ASU30RLE, AUU**RGLX

J-, V-Series: UTY-TFSXJ4 for all TLAV1 except ARUL4TLAV1, ASUB18TLAV1, ASUB24TLAV1; all TLAV2

Features

- Control of your compatible Airstage system from a smartphone app (iOS or Android)
- The air conditioner and the app can also be connected for direct control without a wireless access point
- Control and monitoring of commonly used functions: On/Off, Mode, Airflow Speed and Direction, and Scheduling
- Outdoor and Room Temperature display
- Group functions for monitoring and on/off control of the group
- User access levels
- Error handling and history
- Specialty functions, if available on your system, include: Economy, Energy Saving Fan, Occupancy, Powerful, and Outdoor Unit Low Noise
- Over-the-air updates

Centralized operation for flexible remote management of all Indoor Units

AIRSTAGE Mobile is ideal for a wide range of applications, from residential to commercial spaces such as offices and stores.

Anyone who has a smartphone and an adapter can easily install the system. Multiple user accounts allow the main user to control access to specific units. Ideal for multi-family housing.

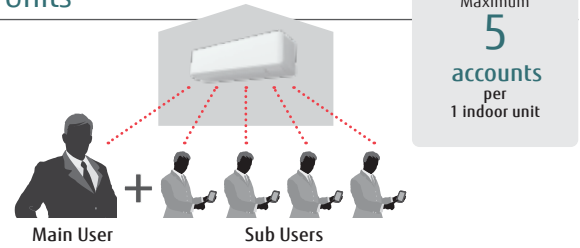

Group Control

Multiple indoor units can be combined into a single group for centralized operation. Several groups can also be organized at once.

Grouping the units by building, floor, or room makes it easy for users to monitor their operation status and operate them quickly.

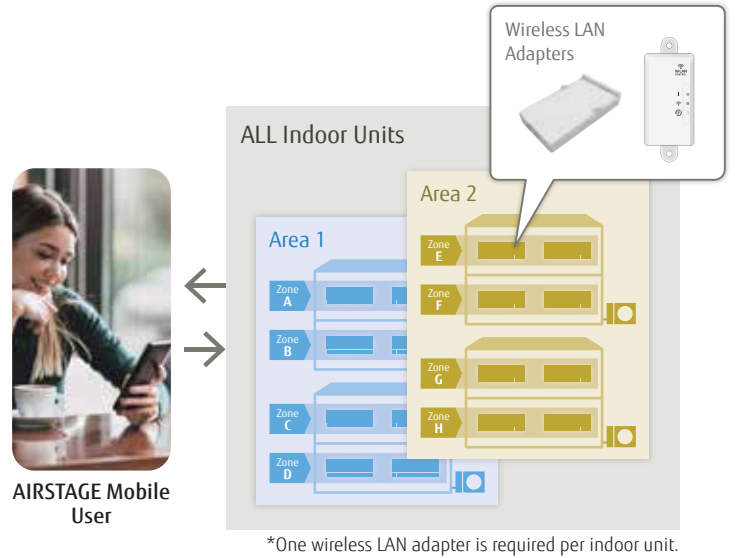
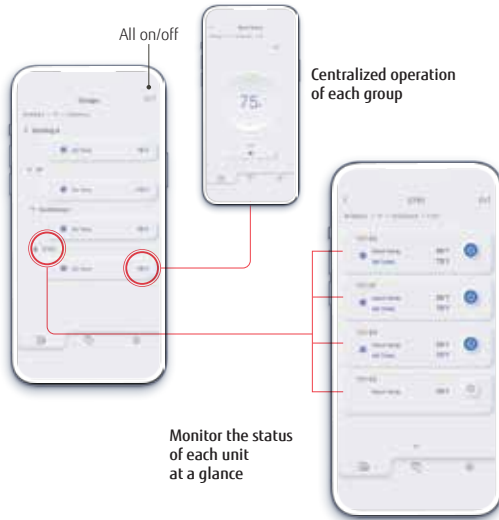

Voice activated control (Alexa/Google Home)

Connecting with a smart speaker allows voice activation so the user can operate the system and check its status with simple voice commands.

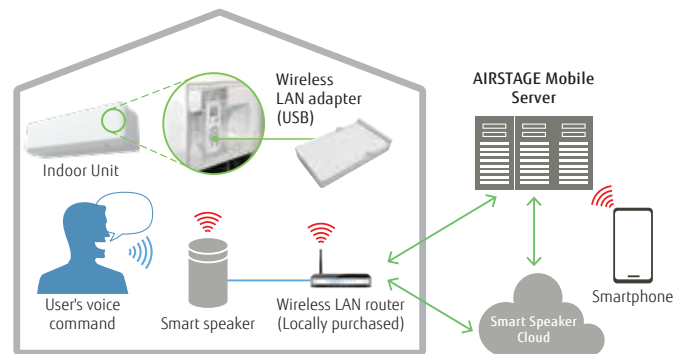

FUJITSU

FUJITSU GENERAL AMERICA, INC.
fujitsugeneral.com

A subsidiary of
FUJITSU GENERAL LIMITED