

kreon inti

kreon inti is a fully recessed downlight with a refined patented* optical system.

kreon inti fixed downlight has a built in dome set above a black or white internal louvre. The faceted dome adds a scattering play of brilliance and creates a first layer of ambiance.

kreon inti directional combines the dome effect of the downlight with a decentralized directional spotlight that has an angular adjustment of 30°. The diffused light from the



dome neutralizes the shadow of the directional spotlight in the light effect. The directional light creates the second layer of focused light.

The unique combination of a diffused downlight with a directional projector make kreon inti a two-in-one recessed ceiling luminaire.

* 2020/5084



inti 80 directional, white, trim



inti 80, black, no shadowgap



inti 80, white, shadowgap

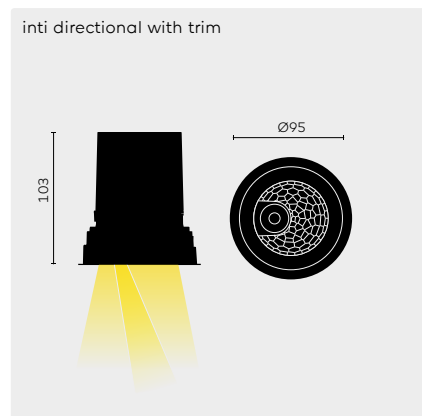
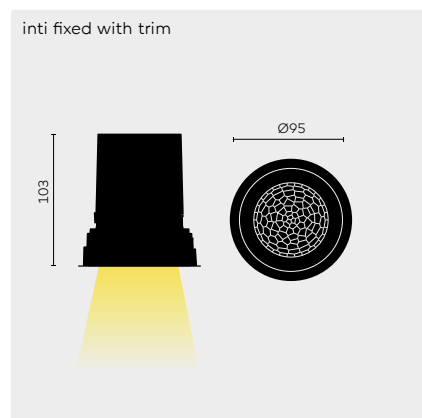
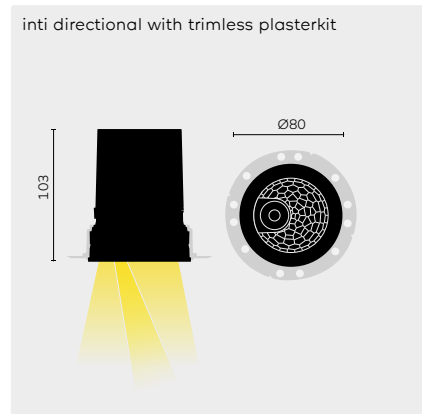
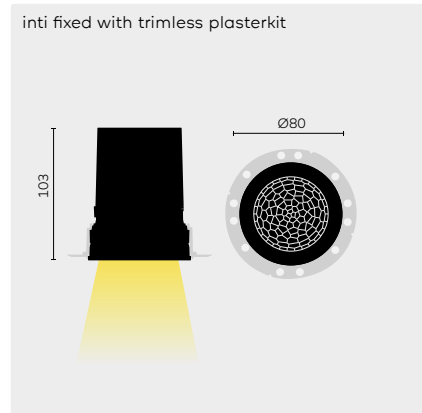

	Colour	KR-code	Light sources	9027 2700K, CRI90+	9030 3000K, CRI90+	SP spot (20°)	DL dark light (33°)	MDL wide dark light (56°)	D3 dome, matt	Required accessories	Optional accessories
inti 80 fixed D 110 Gear: excl., IP20	○	KR997111	①	●	●				●	■	■
	●	KR997112	①	●	●				●	■	■
inti 80 fixed dim-to-warm (3000K to 1800K) D 110 Gear: excl., IP20	○	KR997611	②						●	■	■
	●	KR997612	②						●	■	■
inti 80 directional ① D 110 Gear: excl., IP20	○	KR997121	③	●	●	●	●	●	●	■	■
	●	KR997122	③	●	●	●	●	●	●	■	■
inti 80 directional dim-to-warm (3000K to 1800K) ① D 110 Gear: excl., IP20	○	KR997621	④	●	●	●	●	●	●	■	■
	●	KR997622	④	●	●	●	●	●	●	■	■

■ Required accessories

Installation kit	KR717104	Plasterkit, no shadowgap, trimless finishing Ⓞ Ø 102
	KR717108	Plasterkit, with shadowgap, trimless finishing Ⓞ Ø 102
	○ KR717021	Installation kit with trim, white Ⓞ Ø 90
	● KR717022	Installation kit with trim, black Ⓞ Ø 90
Plasterkit concrete	KR717101	Plasterkit for concrete installation, no shadowgap (430x430)
	KR717102	Plasterkit for concrete installation, no shadowgap, small (200x200)
	KR717109	Plasterkit for concrete installation, shadowgap (430x430)
	KR717107	Plasterkit for concrete installation, shadowgap, small (200x200)
Removal tool	KR797000	Removal tool for kreon inti fixed ②

■ Optional accessories

Driver	KR747064	LED driver, 350mA, 19W, ON/OFF
	KR739102	LED driver, 350mA, 15W, 0-10V/1-10V
	KR747266	LED driver, 350mA, 15W, DALI
	KR747163	LED driver, 350mA, 18W, 0-10V/1-10V, dim-to-warm
	KR747267	LED driver, 350mA, 17W, DALI, dim-to-warm
Distance ring (for plasterkit concrete)	KR717307	Distance ring 2mm (set of 5 pcs.)
	KR717308	Distance ring 3mm (set of 5 pcs.)
	KR717309	Distance ring 5mm (set of 5 pcs.)

	CRI	CCT	Wattage	Drive current	Fixture lumen
① LED	CRI90+	2700K/3000K	12W	350mA	825lm
② LED	CRI90+	2700K/3000K	12,6W	350mA	637lm
③ LED dome	CRI90+	2700K/3000K	12W	350mA	576lm
LED spot 33° / 56°			4W		250lm
20°			1W		100lm
④ LED dome	CRI90+	2700K/3000K	12,6W	350mA	442lm
LED spot 33° / 56°			4W		250lm
20°			1W		100lm

REMARKS

- ① The dome and directional spot need to be driven separately
- ② Tool is for use with kreon inti 80 fixed. One per project is recommended.

Thickness boardmaterial:
9-26mm
Gear excluded
IP20

Plasterkit

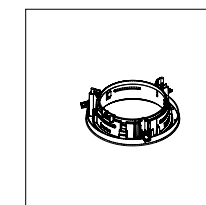

Installation kit

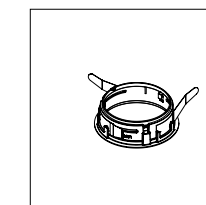

Plasterkit concrete

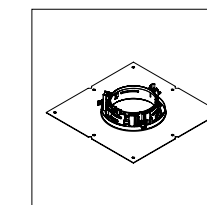

Removal tool

