





# STIPO

14-Mar.- 2017

<b>1.0</b>	
LED 7W   220-240VAC   50-60Hz   COB 3-step   incl. PS	
CE IP65 $\odot$ $\square$ $\triangle$ $\nabla$ 0,3m $\curvearrowright$ 135°	
3000K   >80 CRI   460lm   2m cable	
 dark grey texture	737157D4
 dark brown texture	737157Y4

<b>2.0</b>	
LED 7W   220-240VAC   50-60Hz   COB 3-step   incl. PS	
CE IP65 $\odot$ $\square$ $\triangle$ $\nabla$ 0,3m $\curvearrowright$ 135°	
3000K   >80 CRI   460lm   2m cable	
 dark grey texture	737267D4
 dark brown texture	737267Y4

<b>OPTIONAL</b>	
groundspike	90013106

Fix to the base plate

Fix to the groundspike

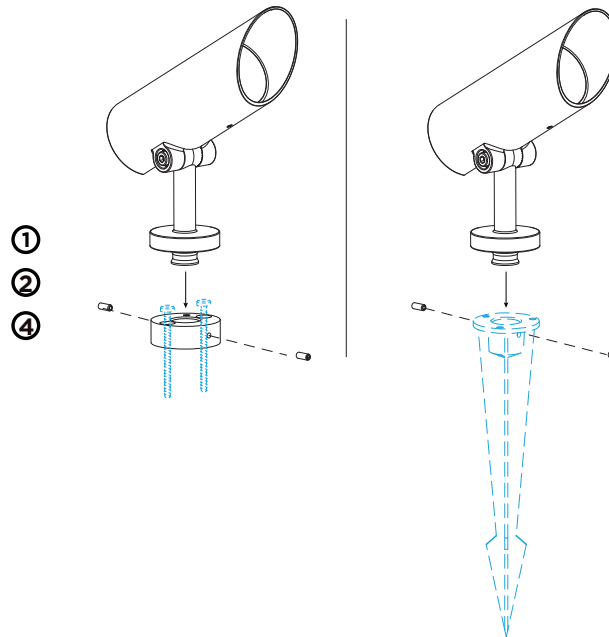

## DIMENSIONS

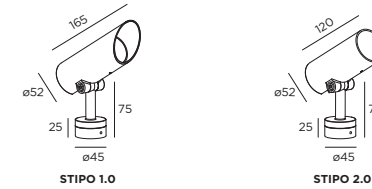

## MOUNTING INSTRUCTION

- ① Remove the base plate
- ② Fixate the base plate to the ground with screws  
OPTIONAL  
Fixate the base plate to the groundspike with screws

## POWER CONNECTION

- ③ Connect the wires with waterproof connections

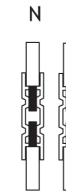

base plate dimensions

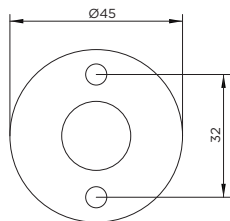

groundspike dimensions

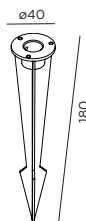

- ④ Fixate the luminaire to base plate or the groundspike with side screws

- ⑤  $\nabla$  85 The product has an auto-recovery thermal fuse. In order to avoid product early failure in some extreme condition; If the internal components reach a temperature of 85°C, the product will switch off and then restart when cooling down.

# STIPO

14-Mar.-2017

## 3.0

LED 7W | 220-240VAC | 50-60Hz | COB 3-step | incl. PS

CE IP65 135°

3000K | >80 CRI | 460lm | 2m cable

dark grey texture  
 dark brown texture

737357D4  
737357Y4

## 4.0

LED 7W | 220-240VAC | 50-60Hz | COB 3-step | incl. PS

CE IP65 135°

3000K | >80 CRI | 460lm | 2m cable

dark grey texture  
 dark brown texture

737467D4  
737467Y4

## ALWAYS USE

dark grey pole 200 excl. spike  
dark brown pole 200 excl. spike  
dark grey pole 400 excl. spike  
dark brown pole 400 excl. spike  
dark grey pole 600 excl. spike  
dark brown pole 600 excl. spike  
dark grey pole 800 excl. spike  
dark brown pole 800 excl. spike

910062D0  
910062Y0  
910064D0  
910064Y0  
910066D0  
910066Y0  
910068D0  
910068Y0

## OPTIONAL

groundspike

90019021

groundspike dimensions

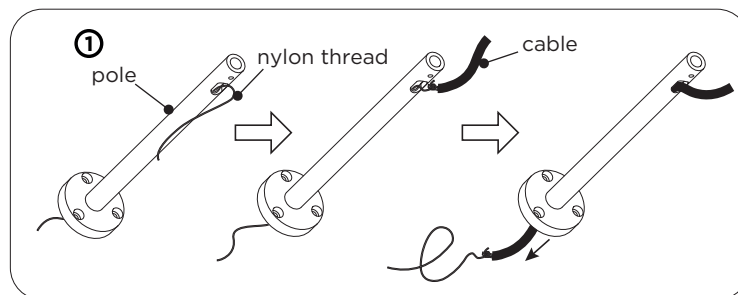
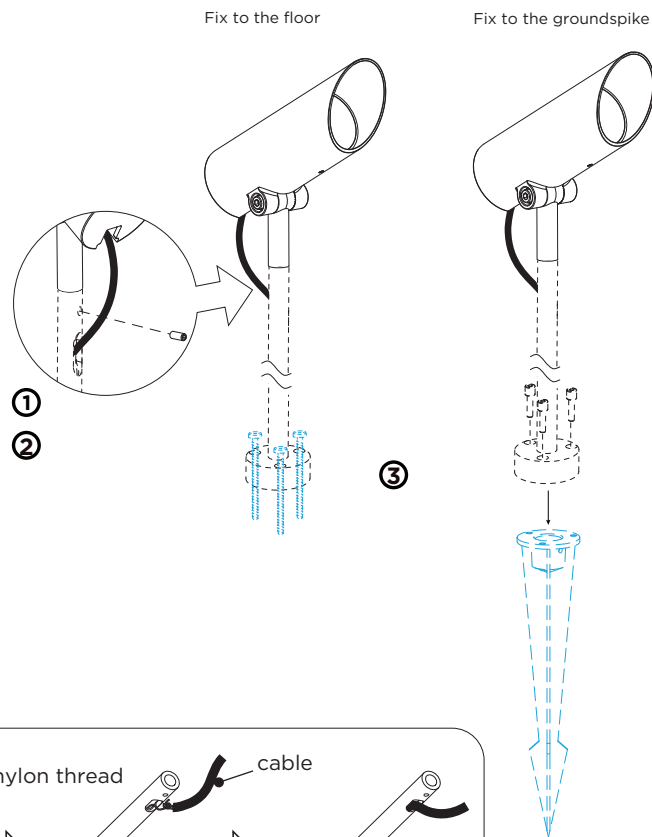
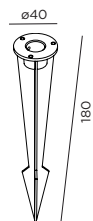

## DIMENSIONS

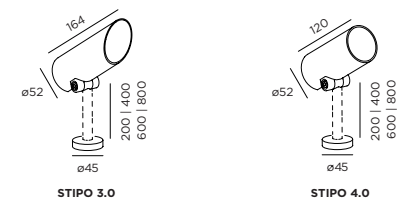

## MOUNTING INSTRUCTION

- Let the luminaire cable through the pole. **(There is a nylon thread attached in the pole, that is an auxiliary tool to help the user to pull the cable through the pole)**
- Fix the luminaire and the pole together with a screw.
- Fix the pole base to the ground with screws.  
OPTIONAL  
Fix the pole base to the groundspike with screws

## POWER CONNECTION

- Connect the wires with waterproof connections

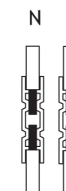

- 85 The product has an auto-recovery thermal fuse. In order to avoid product early failure in some extreme condition; If the internal components reach a temperature of 85°C, the product will switch off and then restart when cooling down.