

BOX

21-09-2015

1.0 LED

LED 8W | 220-240VAC | 50-60Hz | COB 2-step | incl. PS | phase-cut dim

CE IP20 960°C 0,3m 36° P

white texture	146164W
aluminium brushed	146164L
gold	146164G
bronze	146164Q
copper	146164P
black texture	146164B

LIGHT COLOUR

2200K >80CRI 315lm	1
2700K >80CRI 480lm	2
3000K >80CRI 480lm	4

1.0 PAR16

PAR16 max. 35W | GU10 | 220-240VAC | 50-60Hz

CE IP20 960°C 0,9m

white texture	146120W0
aluminium brushed	146120L0
gold	146120G0
bronze	146120Q0
copper	146120P0
black texture	146120B0

OPTIONAL
for PAR16 lamps see our catalogue

OPTIONAL
inner cover max. 10W

white texture	911011W1
gold	911011G1
black texture	911011B1

base plate dimensions

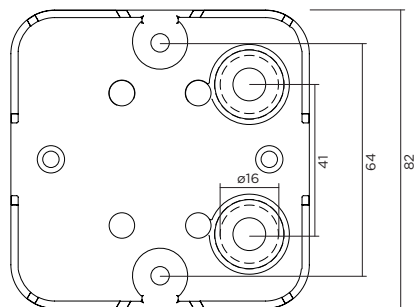

1.0 LED

①

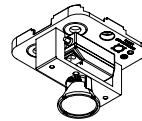

1.0 PAR16

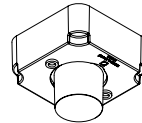
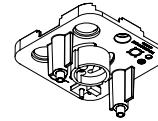

③

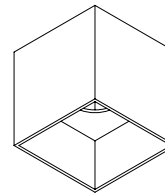
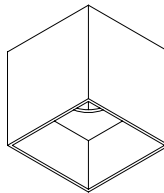

④

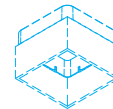
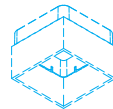

DIMENSIONS

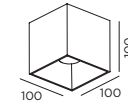

1.0 LED

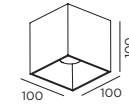

1.0 PAR16

① MOUNTING INSTRUCTION

Remove the screws of the top part, put the cables through the opening and mount the base on the ceiling.

② POWER CONNECTION

Connect wiring to the power supply (for LED) or to terminal block (for PAR16)
interior connection: STANDARD version

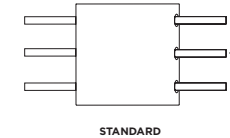

③ For LED:
fix the plastic part together with the cover on the base with the screws.

For PAR16:
fix the cover on the base with the screws.

④ **OPTIONAL** inner cover:
put the inner cover in the outer cover and turn partially.



WEVER & DUCRÉ
LIGHTING

www.weverducre.com

**INSTALLATION
INSTRUCTIONS**

PAGE 1/2

BOX

12-05-2015

1.0 LED

LED 8W | 220-240VAC | 50-60Hz | COB 2-step | incl. PS | phase-cut dim

CE IP65 960°C 0,3m 36° P

3000K | >80CRI | 480lm

white texture
dark grey texture
black texture

146164W4
146164D4
146164B4

OPTIONAL

inner cover max. 10W

white texture
dark grey texture
black texture

911011W1
911011D1
911011B1

base plate dimensions

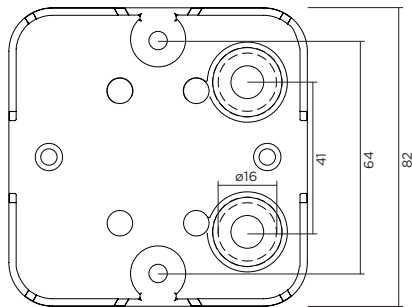

1.0 LED

①

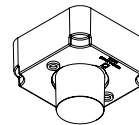
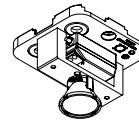

③

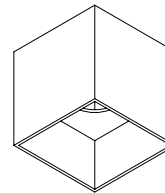

④

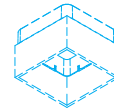

DIMENSIONS

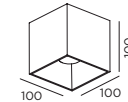

1.0 LED

① MOUNTING INSTRUCTION

Remove the screws of the top part, put the cables through the opening and mount the base on the ceiling.

② POWER CONNECTION

Connect wiring to the power supply
exterior connection: WATERPROOF version (only for LED)

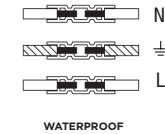

③ For LED:
fix the plastic part together with the cover
on the base with the screws.

④ OPTIONAL inner cover:
put the inner cover in the outer cover and turn
partially.



WEVER & DUCRÉ
LIGHTING

www.weverducre.com

INSTALLATION
INSTRUCTIONS

PAGE 2/2