

OVERVIEW

The SR/F/S Centerstand (p/n 10-08217) provides extra stability for parking a loaded Zero SR/F or Zero SR/S and protects your tires when it is stored for long periods. Rugged, black powder-coated steel construction offers improved ground clearance to ease wheel maintenance as well.

Install Time: Approx. 45 minutes.

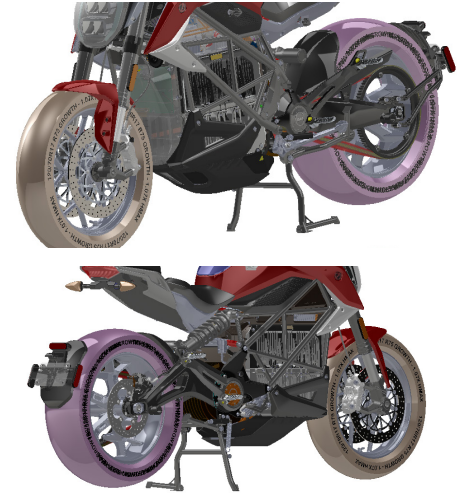

Figures 1 & 2. SR/F Centerstand Installed Views

REQUIRED TOOLS AND PARTS

SPECIAL TOOLS REQUIRED

- None

PARTS REQUIRED

The SR/F Centerstand assembly (p/n 10-08217) includes:

ITEM	PART NUMBER	QTY	ITEM NAME
1	20-02455	2	X Brake Pedal Spacer
2	20-02465	4	IGlide Bearing GFM-1416-06
3	26-08315	1	Sidestand Spring Sleeve
4	26-08366	1	Centerstand Bumper
5	26-08386	1	Centerstand Pivot Plate Right
6	26-08387	1	Centerstand Pivot Plate Left
7	26-08388	1	Centerstand
8	90-07833	1	Rotor Bolt M8x23mm Shoulder Screw
9	90-08125	4	Hex Flange Bolt Star Drive M8x20mm 10.9
10	90-08133	1	Countersunk Head Screw Star Drive M8x20mm 10.9
11	90-08217	2	Hex Flange Bolt Star Drive M10x35mm 8.8
12	90-08219	1	Sidestand Spring Outer Stainless Passivated

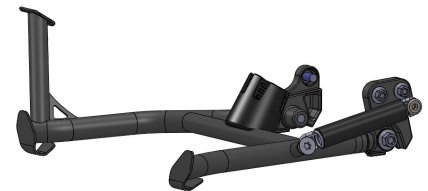

Figure 3. SR/F/S Centerstand Assembly

INSTALLATION INSTRUCTIONS

1. Confirm that you have all parts before starting the installation. If any parts are missing, please contact the Zero Motorcycles Aftersales Team with your order number and the missing items will be sent promptly.
2. Lift the rear wheel of the motorcycle. We recommend that you either use a swingarm stand or a hoist connected to the rear sub-frame as shown in Figure 1.

WARNING: NEVER RAISE THE MOTORCYCLE BY USING A JACK UNDER THE CONTROLLER CARRIER AS THIS COULD DAMAGE IT.

3. Remove the phase lead cover on the right side of the motor using a T40 Torx bit socket and ratchet. See Figure 2.
4. Install the Centerstand Pivot Plate Right (Item 5) using two of the M8x20mm Hex Flange Bolt Star Drive (Item 9). Torque to 18 ft-lbs (24.4 Nm). See Figure 3.
5. Place the side stand in the down position. Install the Centerstand Pivot Plate Left (Item 6) using two of the M8x20mm Hex Flange Bolt Star Drive (Item 9). Torque to 18 ft-lbs (24.4 Nm). See Figure 4.



Figure 1. SR/F Lifted With Hoist From Rear



Figure 2. Location of Right Beauty Cover on Motor



Figure 3. Centerstand Pivot Plate Right Installed



Figure 4. Centerstand Pivot Plate Left Installed

INSTALLATION INSTRUCTIONS (CONT'D)

6. Insert two of the IGlide Bearings (Item 2), one on each side, into the centerstand pivot hole on the right pivot plate.
7. Insert the other two IGlide Bearings (Item 2), one on each side, into the centerstand pivot hole on the left pivot plate.
8. Insert an X Brake Pedal Spacer (Item 1) into each of the centerstand pivot holes in the left and right pivot plates. See Figure 5 for example.
9. Attach left side of Centerstand (Item 7) to left pivot plate using a Hex Flange Bolt Star Drive M10x35mm (Item 11). Do not tighten. Allow room for adjustment on the right side. See Figure 6 for Centerstand sides reference.
10. Attach the right side of Centerstand (Item 7) to right pivot plate using a Hex Flange Bolt Star Drive M10x35mm (Item 11). Once both sides are attached, torque the bolts to 20 ft-lbs (27 Nm). Right side bolt also shown in Figure 5.
11. Slide Sidstand Spring Sleeve (Item 3) over Sidestand Spring Outer (Item 12). Completed spring assembly shown in Figure 7.
12. Attach one end of the spring assembly to the Centerstand (Item 7) using the Countersunk Head Screw Star Drive M8x20 (Item 10). Leave approximately 2mm of space between the head and the Centerstand to allow for the free rotation of the spring. See Figure 8.

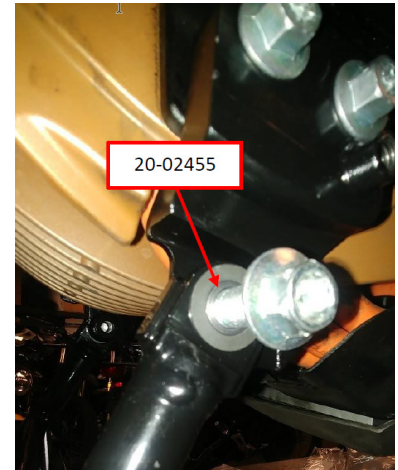

Figure 5. Bearings and Pedal Spacer Inserted

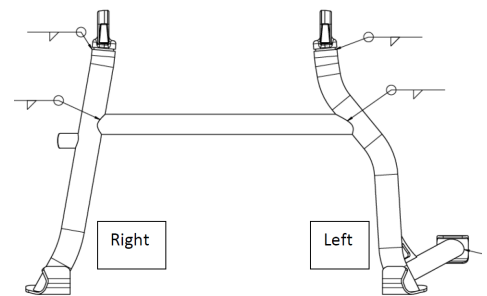

Figure 6. Centerstand Right and Left Sides



Figure 7. Completed Centerstand Spring Assembly

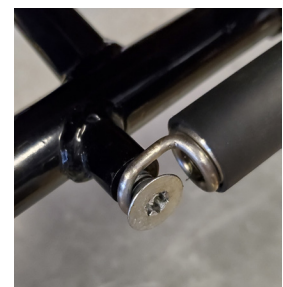

Figure 8. Spring Attached to Centerstand

INSTALLATION INSTRUCTIONS (CONT'D)

13. Apply grease to the upper shoulder portion of the Rotor Bolt M8x23 (Item 8). See Figure 9.
14. Pass the Rotor Bolt M8x23 (Item 8) through the open end of the centerstand spring assembly. Using the bolt pull the spring until it aligns with the hole on the right pivot plate. Insert bolt into the hole and begin to tighten without cross threading. Once aligned and danger of cross threading is avoided, tighten the bolt to 18 ft-lbs (24.5 Nm). See Figure 10.
15. Insert Centerstand Bumper (Item 4) into motor fins as shown in Figure 11, but only enough to hold it in place. Carefully, check alignment with the centerstand cross bar to ensure it will absorb the impact of a retracted centerstand. Once the Centerstand Bumper is aligned, seat it fully. The bumper will stay on with the existing friction.
16. Fully test centerstand function including spring return by raising motorcycle on centerstand and then lowering a few times.



Figure 9. Greased Shoulder of Rotor Bolt



Figure 10. Spring Attached To Pivot Plate



Figure 11. Centerstand Bumper Aligned