

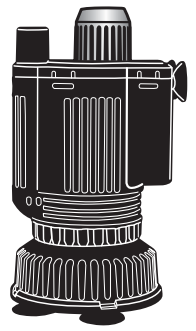

TERRA PUMP™



ITEM#: TC-70

AQUATIC HABITAT DRAIN PUMP INSTRUCTIONS

Congratulations on your purchase of Zoo Med's Terra Pump™. The following instructions will assist you with the proper setup and operation of this item. Please read these instructions carefully, and if you have any questions regarding the proper use of Zoo Med's Terra Pump™, please contact Zoo Med Customer Service by emailing zoomed@zoomed.com or by calling (888) 496-6633 (US and Canada only). Customers in other countries, please call (805) 542-9988.

FEATURES:

- Compact design is easy to maneuver around the aquarium
- Suction cups secure the pump to the bottom or side of the tank to remove water to a desired level
- Power switch for precise flow control
- Removable fish guard protects fish and excludes debris
- 9 foot power cord for easy accessibility
- 6 foot flexible, clear vinyl hose to drain water directly into a bucket for removal
- High volume pump to quickly drain or fill any aquatic habitat
- 28 watts
- 370 GPH
- 5 Ft. Max Head: Can pump water a total of 5 ft. high
- Safe for continual use as Booster or Waterfall pump

INSTRUCTIONS FOR USE:



SET UP PUMP:

1. Remove the pump and all components from the package and make sure there are no missing parts. Refer to the parts diagram above to identify all parts. If any parts are missing or damaged, please contact Zoo Med Customer Service.
2. Securely connect the power cord by plugging the 2 pieces together and securing them using the threaded coupling. Attach the fish guard to the bottom of the pump if desired.



3. Attach the vinyl hose to the return spout and place the other end of the hose into a large bucket or other drain option (such as a household drain or outdoor garden bed).



4. Plug the pump into a GFCI protected outlet. Be sure that the switch is set to OFF before plugging in.

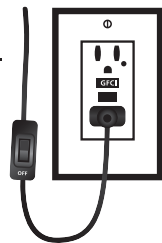

5. Place the pump in the aquatic habitat to be drained. Be sure that the drain end of the hose is securely in your bucket* or alternate draining option.

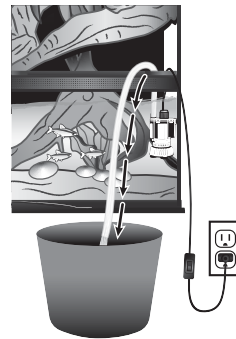

*Use clamp or hold.

PRO TIP: To drain to a desired level, use the suction cups on the back of the pump to secure it to the side of your tank with the bottom of the pump (NOT THE BOTTOM OF THE FISH GUARD) at the level you wish to drain the tank to.



DRAIN TANK:

Use the switch to turn the pump on and begin draining water.

FILL TANK:

Empty "dirty" tank water into a planter or garden bed to water plants! To reduce lifting, the pump can also be used to drain water from your bucket into a drain.

After draining the tank to the desired level, this pump may also be used to fill the tank. Fill your bucket with prepared water. (*Note- be sure that water temperature is correct* and that water has been treated with ReptiSafe® to remove chlorine and chloramines – making it safe for fish and other inhabitants). The pump may be placed into the bucket with the return hose placed into the tank. Switch the pump on to pump water from your bucket into the tank. This method can decrease the physical strain of lifting buckets and reduce splashing and disturbance caused by pouring water into a tank.

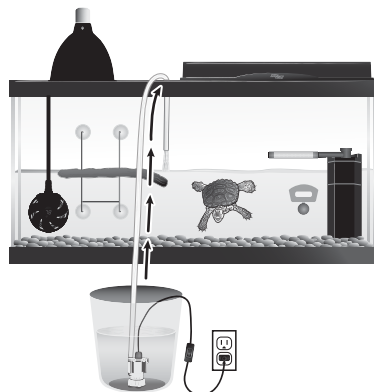

PRO TIP: To reduce or eliminate disturbance while refilling, use a dish or plate to diffuse water flow and protect aquascaping.

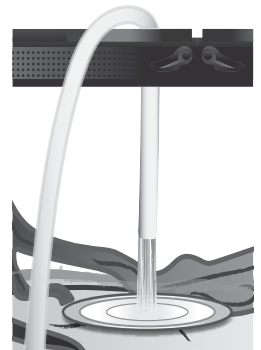

*Make sure your bucket water temperature is at the same temperature as the aquarium water.

MAINTENANCE:

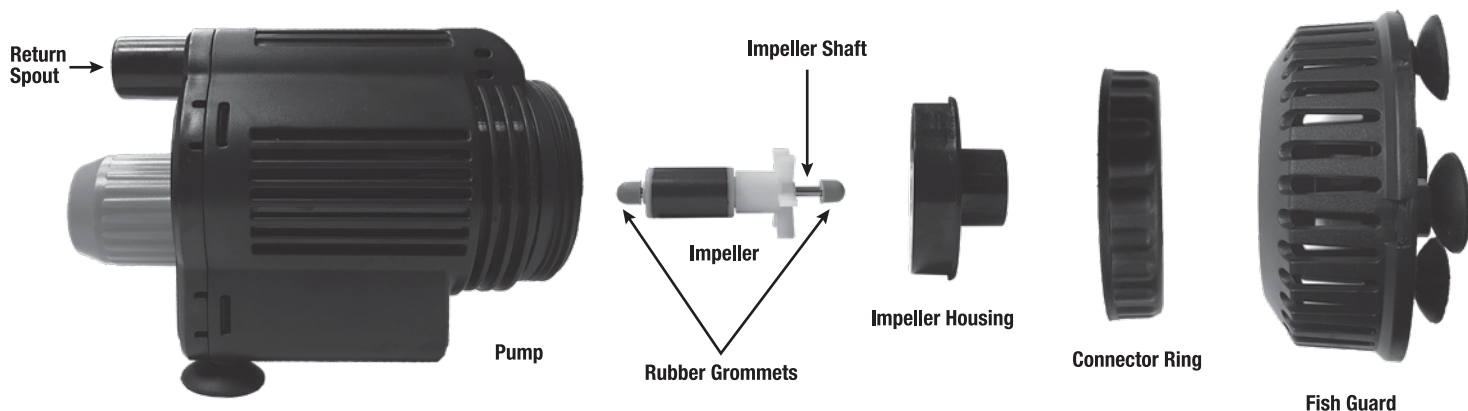

Periodic maintenance should be done to keep the pump performing at its best. If the flow rate decreases, follow this procedure for regular maintenance and troubleshooting:

1. Unplug the pump and remove it from the tank. Remove the fish guard by pulling it straight off.
2. Remove the impeller housing by unscrewing the connector ring, then pull the impeller housing off first. Now grasp the impeller by the metal shaft and pull it out of its chamber.
3. Clean the impeller, impeller chamber, and impeller housing and inspect for damage. If any parts are missing or damaged, please contact Zoo Med customer service for replacement parts or further troubleshooting.
4. Put the impeller back into the chamber and replace the impeller housing, making sure to seat the rubber grommet on the end of the impeller shaft and within the impeller housing. Secure the impeller housing using the connector ring.

OTHER USES FOR TERRA PUMP:

- Mixing saltwater for marine tanks
- Return pump for sump filters (ie. refugium, wet/dry filter)
- Extra large waterfall pump for large Paludariums, etc.

VERY IMPORTANT SAFETY INSTRUCTIONS:

WARNING! To guard against injury, basic safety precautions should be observed, including the following:

READ AND FOLLOW ALL SAFETY INSTRUCTIONS

DANGER – To avoid possible electric shock, special care should be taken since water is employed in the use of aquarium equipment. For each of the following situations, do not attempt repairs by yourself; return the appliance to Zoo Med for service or discard the appliance:

- Carefully examine the appliance after installation. It should not be plugged in if there is water on parts not intended to be wet.
- Do not operate any appliance if it has a damaged cord or plug, if it is malfunctioning, has been dropped, or damaged in any manner.
- To avoid the possibility of the appliance, plug, or receptacle getting wet, position tank/aquarium stand and tank to one side of a wall-mounted receptacle to prevent water from dripping onto the receptacle or plug. A “drip loop,” shown in image (A), should be arranged by the user for each cord connecting an aquarium appliance to a receptacle. The “drip loop” is that part of the cord below the level of the receptacle, (or the connector, if an extension cord is used), to prevent water from traveling along the cord and coming in contact with the receptacle. If the plug or receptacle does get wet, **DON'T** unplug the cord. Disconnect the fuse or circuit breaker that supplies power to the receptacle. Then unplug and examine for presence of water in the receptacle.
- Close supervision is necessary when any appliance is used by or near children.
- To avoid injury, do not contact moving parts.
- Always unplug an appliance from an outlet when not in use, before putting on or taking off parts, and before cleaning. Never yank the cord to pull the plug from the outlet. Grasp the plug and pull to disconnect.
- Do not use an appliance other than for its intended use. The use of attachments not recommended or sold by the appliance manufacturer may cause unsafe conditions. Do not install or store the appliance where it will be exposed to weather or to temperatures below freezing.
- For indoor use only; for aquarium/vivarium use only.
- Make sure an appliance mounted on a tank is securely installed before operating it.
- Read and observe all the important notices on the appliance.
- If an extension cord is necessary, a cord with a proper rating should be used. A cord rated for less amperes or watts than the appliance rating may overheat. Care should be taken to arrange the cord so that it will not be tripped over or pulled.

SAVE THESE INSTRUCTIONS

WARRANTY

This product is guaranteed against manufacturing defects for 12 months from the date of purchase. In the unlikely event of a failure, the unit should be returned to **ZOO MED** within one year of purchase, together with the original sales receipt. It is important that the unit is not tampered with. Please note, this guarantee is not valid if the defects are caused by tampering, negligence, misuse, or by not observing the safety warnings. **ZOO MED** assumes no responsibility for indirect damage that may result from the use of this appliance.

