

OVERHEAD MOUNT **Installation and Operation** (OH Models 1111, 1116, 1130, 1140)

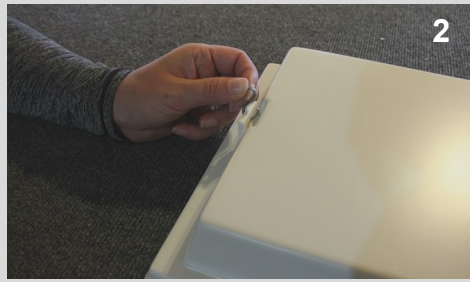

Remove contents of box. Chain & S-hooks provided, but you may need additional hardware dependent upon installation preferences.



Insert S-hook at each end of the heater.



Connect chain to the S-hook at each end of the heater.

Note: one chain is provided for shorter 1111 & 1116 models.

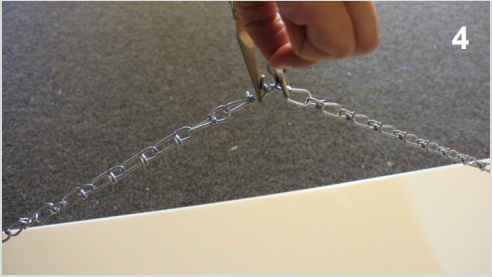

When installing using the supplied chain and S-hook, the S-hook connecting the chains should be pinched shut to secure the unit.



The OH Models are designed to be hung or suspended from a ceiling or bracket from above, approximately 18 to 20 inches over the area to be heated.

Note: You may want to raise the unit for larger pets and lower the unit for smaller pets or in nursery applications where an initial warmer environment is desired. We recommend 6 inches for newly hatched chicks.

Power: Plug into a standard 110-120 volt receptacle. **We recommend using receptacles with ground fault interrupt (GFI) circuits.**

SIDE MOUNT **Installation and Operation** (SM Models 1111, 1116, 1130, 1140)



Remove contents of box. Brackets and screws provided. No chain or S-hooks provided with the Side Mount.



Insert brackets at each end of the heater.



Insert screw into the exposed hole of the bracket on each end.



Mount flush to ceiling, wall or other flat surface, although they may also be suspended.



The SM models should be mounted 18-20 inches above the area to be warmed.

Note: You may want to raise the unit for larger pets and lower the unit for smaller pets or in nursery applications where an initial warmer environment is desired. We recommend 6 inches for newly hatched chicks.

Power: Plug into a standard 110-120 volt receptacle. **We recommend using receptacles with ground fault interrupt (GFI) circuits.**



Thank you for choosing **SWEETER HEATER** Products!

Soft, safe, gentle Infrared Radiant Heat may be a completely different heat principal than you're are used to working with. The Sweeter Heater's Infrared rays are spread over the entire surface area of the panel and are evenly projected straight down. No hot or cold spots in the pattern. The Sweeter Heater has an internal thermal cutout to insure heaters turn off automatically when heat is not allowed to escape. The Sweeter Heater lens temperatures will not exceed 160 to 180 degrees and will not burn your pet.

Properly installed it is the safest and most reliable specific area heater available.



As with any electric heating device, special precautions must be taken:

1. Insure that the heat surface is open to air and that the heat is allowed to escape & circulate.
2. Allow a minimum of 6 inches of air space between the ground surface, bedding, straw hay or any combustible materials.
3. Take special precautions to insure that the unit cannot be allowed to fall with its heating surface enclosed, even with pet or other inadvertent damage. Severe overheating may occur which could result in combustion.



Small screws, shelf brackets, S-hooks, and chains PRESENT HAZARDS TO SMALL CHILDREN

CLEANING INSTRUCTIONS

Warning: Always disconnect electricity before cleaning. Unnoticed damage could cause electrical shock hazard.

The Sweeter Heater units may be carefully washed using mild soap and water. We do not recommend emersion in water as the electrical strain relief fitting around the cord may allow seepage of water into the unit. With reasonable care the Sweeter Heater will provide dependable heat for years to come.

NOTE: UNITS SHOULD ALWAYS BE INSTALLED WITH GROUND FAULT INTERRUPT (GFI) CIRCUITS FOR MAXIMUM SAFETY.



Warranty: The Sweeter Heater units have a three year warranty against defects in materials or workmanship. Power cords are not included in this warranty. Damage from mishandling, abuse or animal damage will void the warranty. In the unlikely event your heater fails to heat, it can be returned for evaluation in cleaned condition to the manufacturer. Please call or email for prior authorization.

Infratherm, Inc.
N2485 County Road P
Sarona, WI 54870
Phone: 715-469-3280
Email: Infratherm@centurytel.net

The date of shipment from the factory is used to determine warranty period if claims are not accompanied by proof of purchase. Infratherm is not liable for loss or damage resulting from alterations, misuse or abuse of products. This warranty is limited to repair or replacement of the product and excludes consequential and special damages.

HEATER INFORMATION AND START UP

All of the materials we use in the Sweeter Heater are completely safe. The lens material is common fiberglass fire rated sheeting used in homes and the food industry. The shell is ABS styrene material (think refrigerator linings, toys, and other molded products). The insulation is a noncombustible Eco-Touch Insulation utility blanket. The **ODOR** that is noted on a new heater is from the escalated final drying of the lens material (fiberglass and adhesives) as the heat is applied. **The odor is normal and will go away in a day or so as the new materials dry out.** Very close examination of the lens sometimes reveals **small hairline cracks** that are created as the lens dries. This is also normal.