



APRAMO UK LTD  
The Old Pumphouse, 1a Stonecross, St Albans,  
Hertfordshire, AL1 4AA

Manufacturer:  
Apramo Child Care Manufacturing Co., Ltd  
Xiweiqiao Village, Zhuangqiao Sub-district, Jiangbei District,  
Ningbo City, Zhejiang Province (No.68, Zhuangxi Road)

[www.apramo.com](http://www.apramo.com)



## ostara fix

**child car seat** • group 2/3 • 15 - 36 kg • approx. 3 to 12 years  
product model: ostara fix

Thank you for choosing APRAMO® OSTARA™ FIX child car seat. We are so excited to be part of your journey with your precious one. To ensure the full protection of your child, please refer to this instruction manual for the safe and appropriate installation and use of this child car seat. If you have any questions about the installation and use of this child car seat, please contact the manufacturer or the retailer.

Please take time to read the instruction manual and familiarise yourself with the child car seat before use.





## contents

<b>1. Important Information</b> .....	<b>02 - 06</b>
1.1 Suitability	
1.2 Approval	
1.3 General safety information	
1.4 3-point vehicle belt components	
1.5 Seat assembly	
1.6 General safety information	
1.7 Installation Notes	
<b>2. Adjusting Headrest (Group II/III)</b> .....	<b>07</b>
<b>3. Installation</b> .....	<b>07 - 09</b>
3.1 Group II/III (15 – 36 KG, from approx. 3 to 12 years) with ISOFIX connectors + 3-point vehicle belt	
3.2 Group II/III (15 – 36 KG, from approx. 3 to 12 years) with 3-point vehicle belt	
3.3 Securing your child	
<b>4. Removal of the Child Car Seat</b> .....	<b>10</b>
<b>5. Care and Maintenance</b> .....	<b>10 - 11</b>
<b>6. Guarantee</b> .....	<b>12</b>

## 1. Important Information

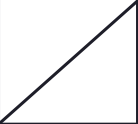
### 1.1 Suitability

This child restraint system is suitable for children from 15 up to 36 KG. (Group II/III, from approx. 3 to 12 years)

GROUP	BODY WEIGHT	INSTALLATION DIRECTION	ISOFIX CONNECTORS	3-POINT VEHICLE BELT	UNIVERSAL / SEMI-UNIVERSAL
II/III	15 - 36 KG	 FF			UNIVERSAL
II/III	15 - 36 KG	 FF			SEMI-UNIVERSAL

ISOFIX: Fix attachment for the connection between child car seat and vehicle seats having two rigid anchorages according to UN ECE Regulation NO. 14.

### 1.2 Approval

This child restraint system has been approved in accordance with UN ECE Regulation No. 44/04, and is suitable for general use in vehicles and is compatible with the majority of vehicle seats.

#### Group II/III - Installation with 3-point vehicle belt and ISOFIX connectors

This child restraint is classified for "Semi-universal" use and is suitable for fixing into the seat positions of the cars listed in "Compatible Vehicles List". This child restraint is suitable for use in the listed vehicles fitted with 3-point vehicle belt approved to UN ECE Regulation No. 16 or other equivalent standards. If in doubt, consult either the child restraint manufacturer or the retailer.

#### Group II/III - Installation with 3-point vehicle belt

This child restraint is suitable for use in the listed vehicles fitted with 3-point vehicle belt approved to UN ECE Regulation No.16 or other equivalent standards.

### 1.3 Product overview

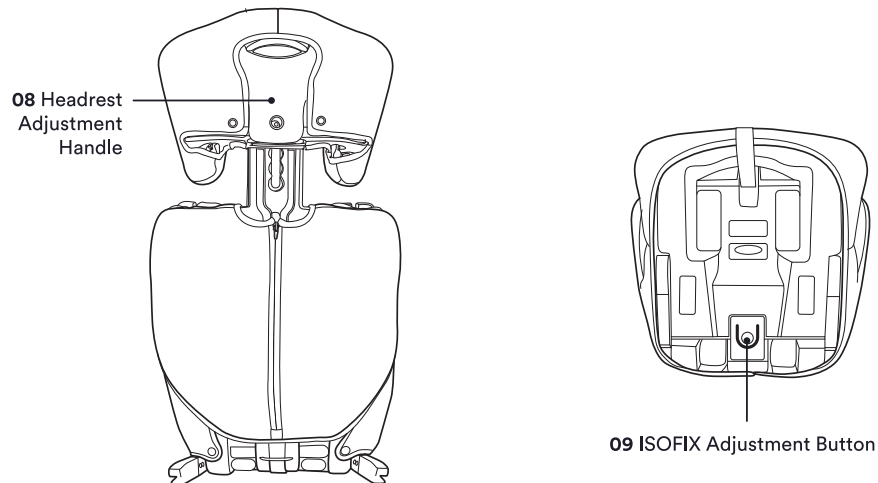
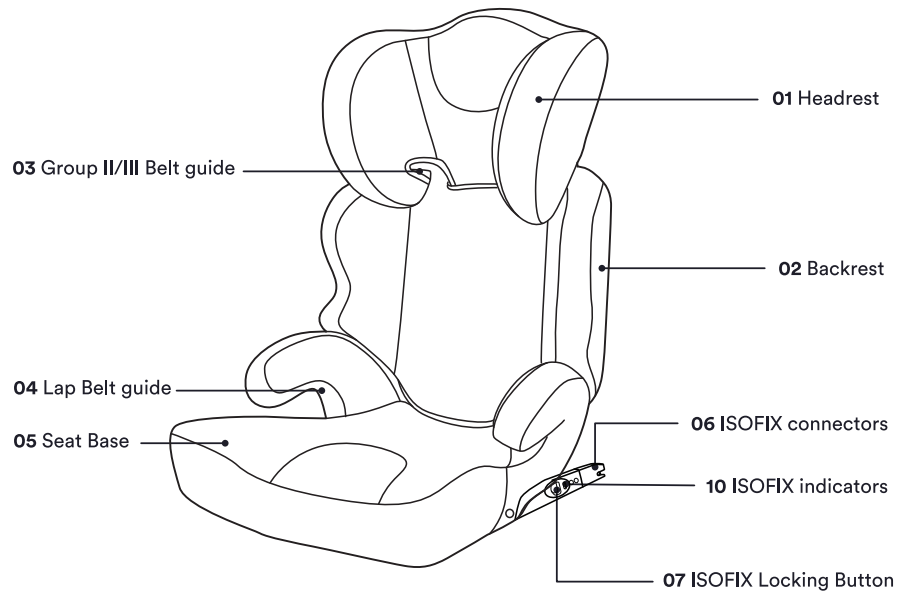

### 1.4 3-point vehicle belt components

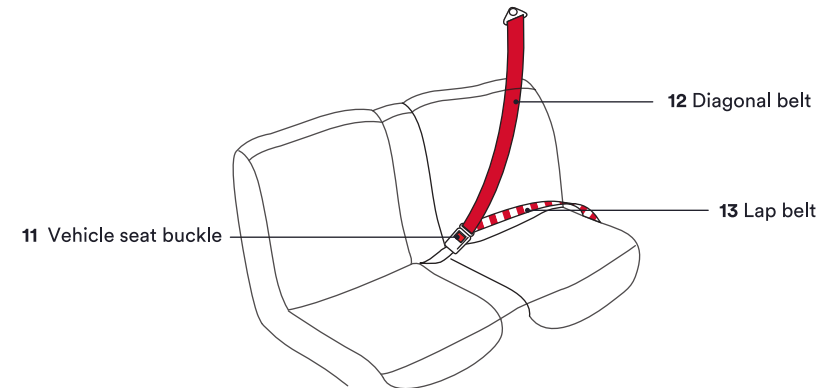

### 1.5 Seat assembly

- 1) With seat base (05) lying flat on the floor, place hooks at seat base (05) bottom as shown. 01
- 2) Attach the backrest hooks to seat mounting points. 02
- 3) Push down on backrest (02) just above hooks until fully engaged. 02
- 4) Rotate backrest (02) to an upright position while maintaining pressure just above the hooks. 03

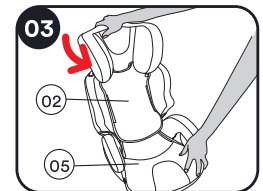
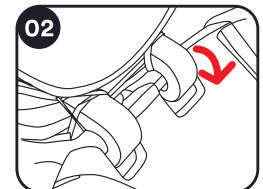
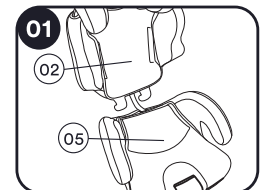

## 1.6 General safety information

# WARNING!



Please follow the instructions in this manual carefully. Failure to follow the instructions may affect your child's safety. The manufacturer is not responsible for the incorrect use of this product

- NEVER use this child car seat without the covers supplied. DO NOT replace the cover with any other than those recommended by the manufacturer, as this may affect the safe use and performance of the child car seat.
- Please avoid the placement of a child directly into the car seat if it has been in the direct heat of the sun, the seat may get too hot, and could cause injury of your child.
- Please replace this child restraint if it has been subject to the violent forces & stresses associated with a road traffic accident. It may have been damaged, but the damage may not be visible. If you require replacement parts, please contact the manufacturer or the retailer.
- Secure properly any heavy or sharp-edge objects which might be liable to cause injury in the event of a collision.
- Once installed, and , during everyday use of the vehicle, please check the child restraint properly to make sure that no part of the seat or seat belt are trapped by a moving seat or in the door of the vehicle.
- DO NOT modify, or add any additional part, or modify the child restraint in any way without the written approval of a competent authority, or the manufacturer, as this will void any warranty and may affect safety and performance.
- Always and continually ensure that the child restraint is securely fastened and installed , even when unoccupied, a loose restraint can cause injuries in the event of a collision.
- NEVER UNDER ANY CIRCUMSTANCES leave your child unattended in the child restraint.
- Dry metal parts after any contact with water to prevent the formation of rust.
- NEVER UNDER ANY CIRCUMSTANCES use this child restraint on a passenger seat fitted with a frontal airbag.

- Please make sure that product is purchased from a reputable retailer. The manufacturer does not warranty or guarantee the quality and reliability of any second hand products.
- The illustrations in this manual are for reference only, and may differ slightly from your seat model.
- ALWAYS retain this instruction manual for future reference. Keep it with the car seat at all times, in the allocated storage space.

## 1.7 Installation Notes

# WARNING!



Never use with a 2-point lap belt

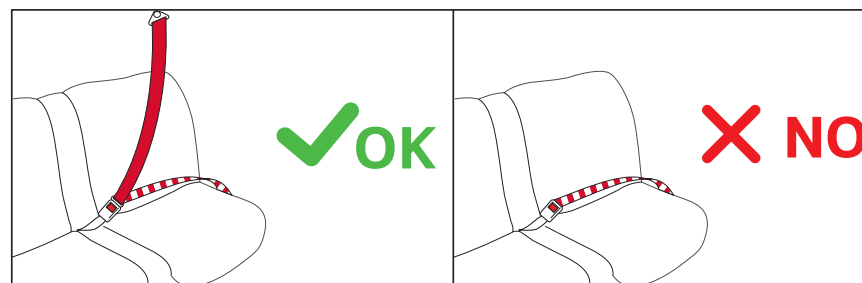

## 2. Adjust Headrest (Group II/III)

A correctly adjusted Headrest (01) ensures optimal protection for your child in the child car seat: The Headrest (01) is in the correct position when the Diagonal seat belt (12) of the 3-point vehicle belt sits on the child's shoulders and when you can fit 2 fingers between the bottom edge of the Headrest (01) and the shoulder of the child.

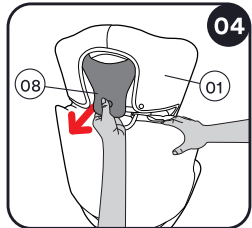

- 1) Grip the Headrest Adjustment Handle (08) on the back of the Headrest (01) and pull it upwards to unlock the Headrest (01). 04

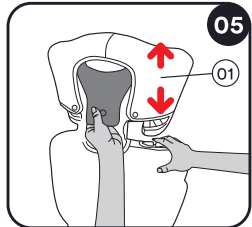

- 2) Move the unlocked Headrest (01) to the desired height. As soon as you release the Headrest Adjustment Handle (08), the Headrest (01) will lock into place when you hear a "CLICK" sound. 05
- 3) Place the child car seat on the vehicle seat.
- 4) Have your child sit down in the child seat and check the height. Repeat this process until the Headrest (01) is at the optimal height.



**CAUTION!** The Headrest (01) is in the correct position when you can fit at least 2 fingers between the bottom edge of the Headrest (01) and the shoulder of the child.

## 3. Installation

### 3.1 Group II/III (15 – 36 KG, from approx. 3 to 12 years) with ISOFIX connectors + 3-point vehicle belt

- 1) If your car is not equipped with the ISOFIX guide socket, please insert the guide socket into the ISOFIX anchor.

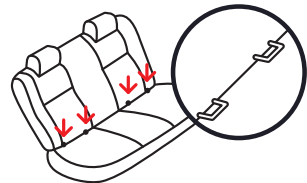

**TIP:** ISOFIX anchors are located between the surface and the backrest of the vehicle seat.

- 2) Move the Headrest (01) of the child car seat to the desired position. (Refer to section 2)

**Tips:** If the headrest of the vehicle seat gets in the way, turn it the other way.

- 3) Place the child car seat on the vehicle seat in the direction of travel.
- 4) Press the ISOFIX adjustment button (09) and flip up the ISOFIX connectors (06) to fully extend the ISOFIX connectors (06), until they are kept in the locked position. 06 07 08
- 5) Push both ISOFIX connectors (06) into the lower anchorage points at the bottom of the vehicle seat backrest, until they are both engaged - by hearing a "CLICK" sound, and the ISOFIX indicators (10) turn to green. 09 10



**CAUTION!** The ISOFIX connectors (06) are secured **ONLY** when both indicators (10) are completely green.

- 6) Push the child car seat backwards into the vehicle seat backrest until it is firmly against the vehicle backrest.
- 7) Follow the steps in section 3.3 to secure your child.

For your child's safety, ensure that the following checks are carried out before every journey:

- The ISOFIX connectors (06) are securely engaged in the anchors and the indicators (10) are both completely green.
- The child car seat is securely fastened.
- The child restraint is sat up against the backrest of the vehicle seat.
- The 3-point vehicle belt is tight and not twisted at any point.
- The Lap belt (13) runs through the armrest on both sides of the child car seat.
- The Diagonal seat belt (12) runs through Group II/III Belt guide (03).

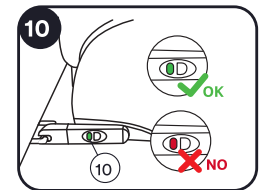
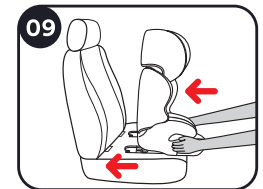
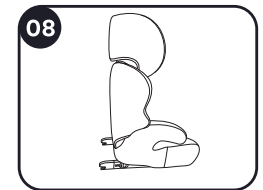
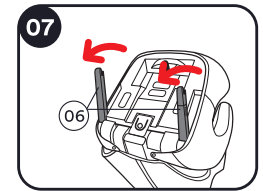
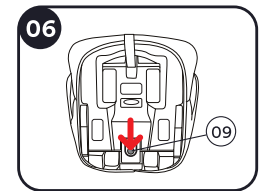

### 3.2 Group II/III (15 – 36 KG, from approx. 3 to 12 years) with 3-point vehicle belt

- 1) Move the Headrest (01) of the child car seat to the desired position. (Refer to section 2)

**Tips: If the headrest of the vehicle seat gets in the way, turn it the other way.**

- 2) Place the child car seat on the vehicle seat in the direction of travel.
- 3) Push the child car seat backwards the vehicle seat backrest until it firmly against.
- 4) Follow the steps in section 3.3 to secure your child.

For your child's safety, ensure that the following checks are carried out before every journey:

- The child car seat is securely fastened.
- The child restraint is sat up against the backrest of the vehicle seat.
- The 3-point vehicle belt is tight and not twisted at any point.
- The Lap belt (13) runs through the armrest on both sides of the child car seat.
- The Diagonal seat belt (12) runs through Group II/III Belt guide (03).

### 3.3 Securing your child

- 1) Have your child sit down in the child car seat.
- 2) Pull the vehicle seat belt and pass it through the Group II/III belt guide (03), and then buckle it up.
- 3) Tighten the vehicle belt by pulling on the Diagonal seat belt (12) section. 11

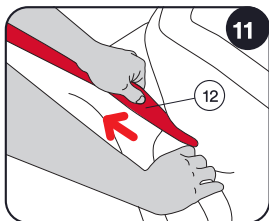

**CAUTION! DO NOT** position Lap belt (13) over top of the armrests. It must pass underneath the armrests of both sides.



**CAUTION!** Check the vehicle belt buckle with a correct position according to the illustrations, please consult the manufacturer or the retailer if necessary



**CAUTION!** The Diagonal (12) and Lap belts(13) must not be twisted.

## 4. Removal of the Child Car Seat

### 4.1 3-point vehicle belt

- 1) Release the buckle tongue from the vehicle seat buckle. Unthread 3-point vehicle belt from the child car seat and allow it to retract.

- 2) Remove the child car seat from the vehicle seat.

### 4.2 3-point vehicle belt + ISOFIX connectors

- 1) Release the buckle tongue from the vehicle seat buckle. Unthread 3-point vehicle belt from the child car seat and allow it to retract.

- 2) Push the ISOFIX Locking Button (07) forward to release the ISOFIX connectors (06). 12

- 3) Remove the child car seat from the vehicle seat. 13

- 4) Press the ISOFIX adjustment button (09) and fold downwards the ISOFIX connectors (06) into the recession slots. 14

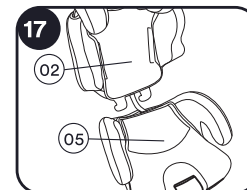
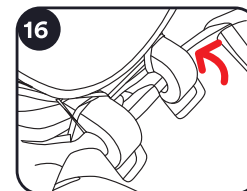
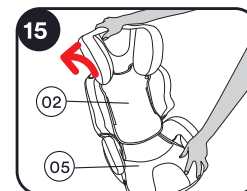
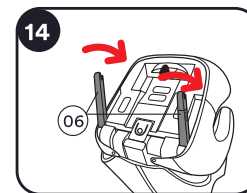
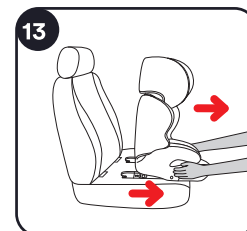
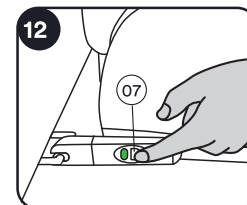

## 5. Care and Maintenance

### 5.1 Removing the child car seat covers

- 1) Disassemble the Seat base (05) from the Backrest (02) by pushing down on the Seat base (05) whilst pushing the Backrest (02) backwards until the two projecting tabs on the Back support (02) disconnect with the openings in the Seat base (05). 15 16 17

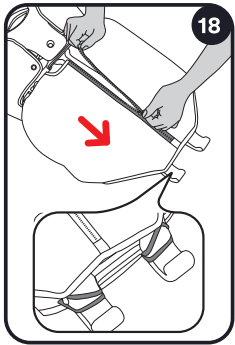

2) Remove the cover from the Backrest (02) by unhooking the elastic sections around the projection tabs, then unzip and pull the cover off over the side wings and remove from the Backrest (02) shell. **18**

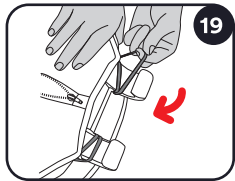

3) Unhook the elastic sections under the shoulder sections of the Headrest (01), unlock the buttons on covers and then pull the cover up over the top of the Headrest (01) shell. **19 20 21**

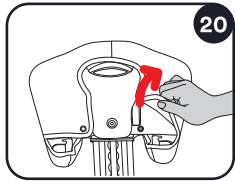

4) Remove the covers from the Seat base (05) by unlocking the buttons on covers and Seat base (05) shell. **22 23**

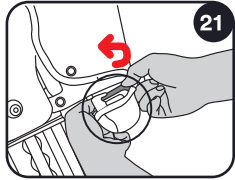

5) The child seat covers can be washed up to 30°C. Please observe the instructions on the washing label.

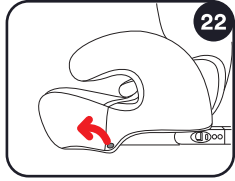

### 5.2 Refitting the child car seat covers

Proceed in reverse order of section 5.1 to put on the cover.

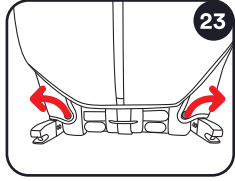

**CAUTION!** NEVER use this child car seat without the covers supplied. Ensure that you ONLY use the original child car seat covers, as the cover is an integral part of the child car seat and fulfillment of important functions.

## 6. Guarantee

### What the Guarantee covers:

- All our products are made from the finest quality materials and are manufactured under the strictest quality controls.
- We guarantee all our products or parts thereof, for a period of two (2) years from the date of purchase against manufacturing defects.
- For guarantee purposes we will require proof of purchase. We recommend that the receipt for your product is kept in a safe place.
- This in no way affects your statutory rights.
- For any claim related with this child car seat guarantee we suggest to contact your retailer who will advise you how to proceed.

### Exclusions:

**WARNING!**

**DO NOT** add to or modify this product in any way.

**NEVER** use spare parts that are not recommended or supplied by the manufacturer.

- Should any modification be made to this child car seat, this guarantee shall be invalidated, the manufacturer solely being authorized to make any modifications to this child safety seat and to provide all necessary original parts.
- Fabric normal wearing and/or colour fading as a result of its use are not covered by this guarantee.
- This guarantee is not effective against damages caused as a result of incorrect usage of the product or against accidental damages.

**CAUTION!** Once quality problem is found, please contact local retailers directly. When making a claim, the depreciation rate will be taken in account.

**journeys we make**