



september 2011

ORIENT EXPRESS

project card

Pendant Express

Endless possibilities abound for these large wooden beads! Once the creative train leaves the station, you just won't be able to stop. Interchange your altered pendants onto the cord or ball chain as you match them with your wardrobe. These mini works of art make great gifts, if you can part with them!

kit ingredients:

- (10) 1-1/4" Wooden Oval Beads
- 28" Cord
- (2) Silver Plated Cord Ends
- Hook and Eye Clasp
- (2) Jump Rings
- Wooden Dowel
- (8) 1/4" Eyelets
- 22" Ball Chain
- (2) Ball Chain Connectors
- Blank Newsprint

tools & supplies:

- Heat Tool
- Clear Embossing Ink
- Clear Embossing Powder
- Rubber Stamps
- Colored Mists
- Assorted Inks
- Pliers
- Printed Text Paper
- Paint
- CS® Bookbinding Glue
- Foam Brush
- CS® Ink Applicator
- Ribbon
- Needle
- 1/4" Hole Punch



preparation

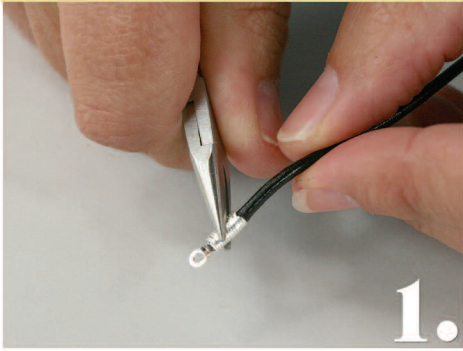

1.



2.



3.

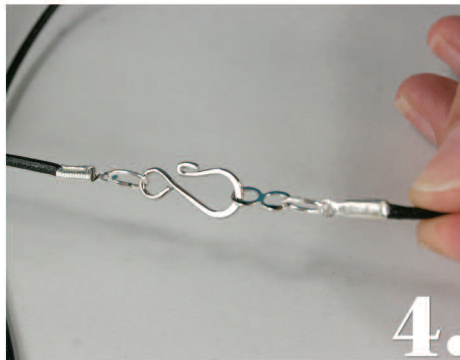

4.



5.

one: Trim the cord to the desired length and attach the silver plated cord end to the end of the cord. Pinch with a pliers to secure.

two: Use a pliers or your fingertips to open the jump ring by bringing the split end forward and back. (Do not pull the ends apart left to right.) Thread the hook of the clasp onto the jump ring

three: Loop the cord end to the jump ring and close ends with fingertips or pliers.

four: Repeat for the other end of the cord, adding a jump ring and eye of the clasp to the cord end.

five: Cut ball chain to desired length and attach one ball chain connector to the end. Two bracelets can be created with the optional second ball chain connector.



printed text



1.



2.



3.



4.



5.



6.

one: Tear or cut a 1.75x3" piece of printed text paper. (Use newsprint, a page from an old dictionary, magazine tear sheet, etc.) Spread a thin layer of Bookbinding Glue onto the paper with a foam brush.

two: Place the wooden bead onto the paper and roll the paper around the bead. Pleat the paper at each end to accommodate the shape.

three: Use the dowel to push the paper ends down into the hole of the bead.

four: Thread the bead onto the dowel and roll onto clear embossing ink.

five: Sprinkle with clear embossing powder and heat to melt. Immediately sprinkle with a second coat of powder and heat.

six: Glue a 1/4" eyelet to each end of the bead to create a finished look.

inked and stamped



one: Trim or tear a 1.75x3" piece of blank newsprint. Sponge with ink colors of your choice.



two: Stamp the paper with an image of your choice. (We selected the ink splatter from the CST Unmounted sheet.)



three: Brush glue onto the back of the newsprint, roll the bead, push paper ends into the bead holes at each end, and heat emboss two coats of clear powder.



stained



one: Sponge your favorite distress ink or spray stain onto the wooden bead.



two: Ink a stamp of your choice and roll the bead over the stamp, pressing firmly. Roll the bead additional times to cover any unstamped areas.



three: If desired, apply two coats of clear embossing powder.

partially painted



one: Paint each end of the bead with black acrylic paint, leaving the center wood exposed.

two: Roll the bead onto a text stamp inked with black to add art to the middle of the bead. Roll the bead ends onto a text stamp inked with white. Heat set the ink.



detail painted



Paint the entire bead with black acrylic paint. Use a detail brush to add dots and swirls with contrasting paint.

misted faux raku

one: Thread the bead onto the dowel and place inside a pizza box "spray tray." Mist the pendant with assorted colors.

two: Mist the bead with Iridescent Memories Mist to add a metallic sheen to the bead. Heat set to dry the spray and blend colors.

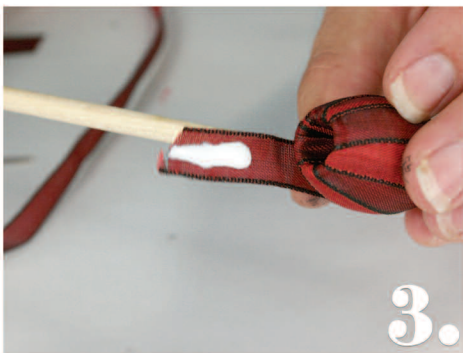

ribbon wrapped

one: Thread ribbon onto needle and bring ribbon through the hole in the bead. Tie ribbon ends into a knot and push the knot into the hole.

two: Continue to wrap ribbon around the bead until the entire surface is covered, pulling firmly to remove all slack.

three: 3. Trim ribbon end, apply glue, and push the glued end into the bead hole with the dowel. (The opening on this particular bead will be very narrow and best suited to a wire necklace.)

four: 4. Glue a 1/4" eyelet to each bead end.

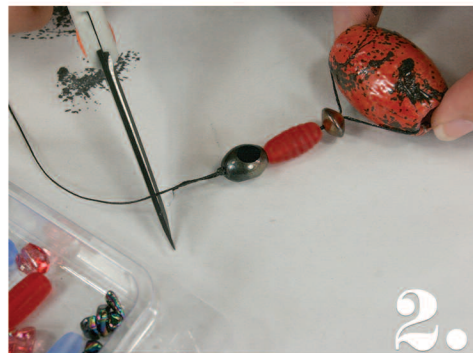

adorned

one: Ink and stamp a piece of newsprint. Glue onto the bead as described in the "printed text" version on page two.

two: Thread bead with a piece of waxed linen thread. Attach additional coordinating beads onto the thread tails. Tie and trim ends.



polka dot

one: Paint bead with black acrylic paint. Punch assorted colors of paper with a 1/4" hole punch; glue onto bead. For best results, cover entire paper punch with glue.

two: Roll bead onto clear embossing ink, sprinkle with clear embossing powder, and heat to melt. Repeat to add a second coat.

