

# STARTING A SPRAY CAN

## DON'T FORGET TO REMOVE THE SAFETY RING AND SHAKE THE CAN WELL

To reduce waste from packaging material, instead of a lid, Montana spray cans have a small black safety ring underneath the cap to prevent the can from being sprayed. To start using a Montana spray can it is necessary to remove the black safety ring under the nozzle first. There are a few Montana spray cans that do have a lid (such as ADHESIVE, GLITTER, GRANIT) - these cans do not have a safety ring and therefore only the lid needs to be removed.

Shake well: Montana products contain the highest quality ingredients and a high pigment load to guarantee an extraordinarily strong coverage. For optimum results, make sure to shake the can to mix the paint very well by using the technique shown here. For optimal lifespan, always make sure to store with the nozzle on the can.



The safety ring is easy to remove - just lift up the nozzle and turn the spray can up side down and the ring will fall out.

### WATCH THE VIDEO:



**MONTANA**  
**CANS**



1.

The safety ring is easy to remove - just lift up the nozzle and turn the spray can up side down and the ring will fall out.



2.

The ring helps to avoid accidental triggering in transport or storage.



3.

Turn the can upside down. Strike the bottom of the can against the palm of your other hand.



4.

Repeat this several times to make sure to loosen up the ball bearings\* from the pigments in the can.



5.

Once the ball bearings\* are moving freely, keep the can turned upside down to take advantage of gravity while shaking.



6.

Then shake the can vertically for at least 2 minutes.



7.

After you have shaken the can well put the nozzle back on the can. Fix carefully with your finger and make sure that it fits.



8.

Make sure to always do the first spray on a test surface first, as the top of the valve system may harbor more solvent than pigment on the first shot. This is normal.

\* the following products do not contain ball bearings: ACETONE and ADHESIVE SPRAY. These cans also need to be shaken well for 2-3 minutes

# GOOD TO KNOW

## GENERAL INFORMATION



**MONTANA**  
**CANS**

### ENVIRONMENTALLY FRIENDLY

Montana sprays are 100 % free of heavy metals and comply with the latest international labelling and safety regulations.

### DISPOSAL

Montana spray cans are made from steel and can be recycled. Recycling procedures from empty cans vs. partially filled cans differ - check with your local recycling facility for details.

### FOR OPTIMAL PERFORMANCE

Store cans with nozzle on in a dry area out of direct sunlight or sources of heat. Use during dry weather in areas protected from the wind. When using indoors, spray in a well ventilated area. When possible apply at temperatures between 10°C (50F) and 27°C (80F). Protect surrounding objects.

### ADVICE FOR SPRAYING SMALL AREAS

When working on small areas it is recommended that the surfaces that should not receive paint (or paint dust), be masked off. Masking can be done by covering the areas with thick paper or cardboard that you want to protect. Or you can creating a mask such as a piece of cardboard with a hole cut in it, which is slightly larger than the area to be sprayed. The mask should be held about 1-2 cm (0.5 inches - 0.75 inches) from the surface. This helps to give more precise control over the surface being sprayed.

### ADVICE FOR SPRAYING LARGE AREAS

To cover large areas precisely, use the Montana Flatjet caps and spray from a further distance. Move the can slowly and evenly back and forth, changing direction only after the spray has moved past the object. This makes it easier to control the amount of paint being applied, as well as helps to avoid drips.

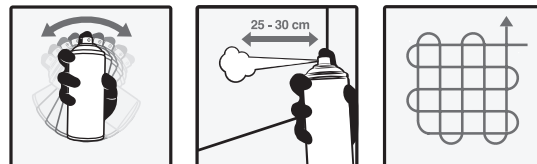

Apply additional coats if desired. Additional coats should be applied before the first coat is completely dry, but within 1-2 minutes of the prior coat being applied. Although waiting time between coats varies subject to conditions, for best results allow each coat to dry over night before applying the next.

Please make sure to always read the safety instructions and application notes on the back of the can. The suggestions here are guidelines for general use - we always recommend to test first in order to avoid unwanted results. More information on the MONTANA-CANS website.

**FIND MONTANA HOW TO USE VIDEOS ONLINE:**

[WWW.MONTANA-CANS.COM/HOWTO](http://WWW.MONTANA-CANS.COM/HOWTO)