

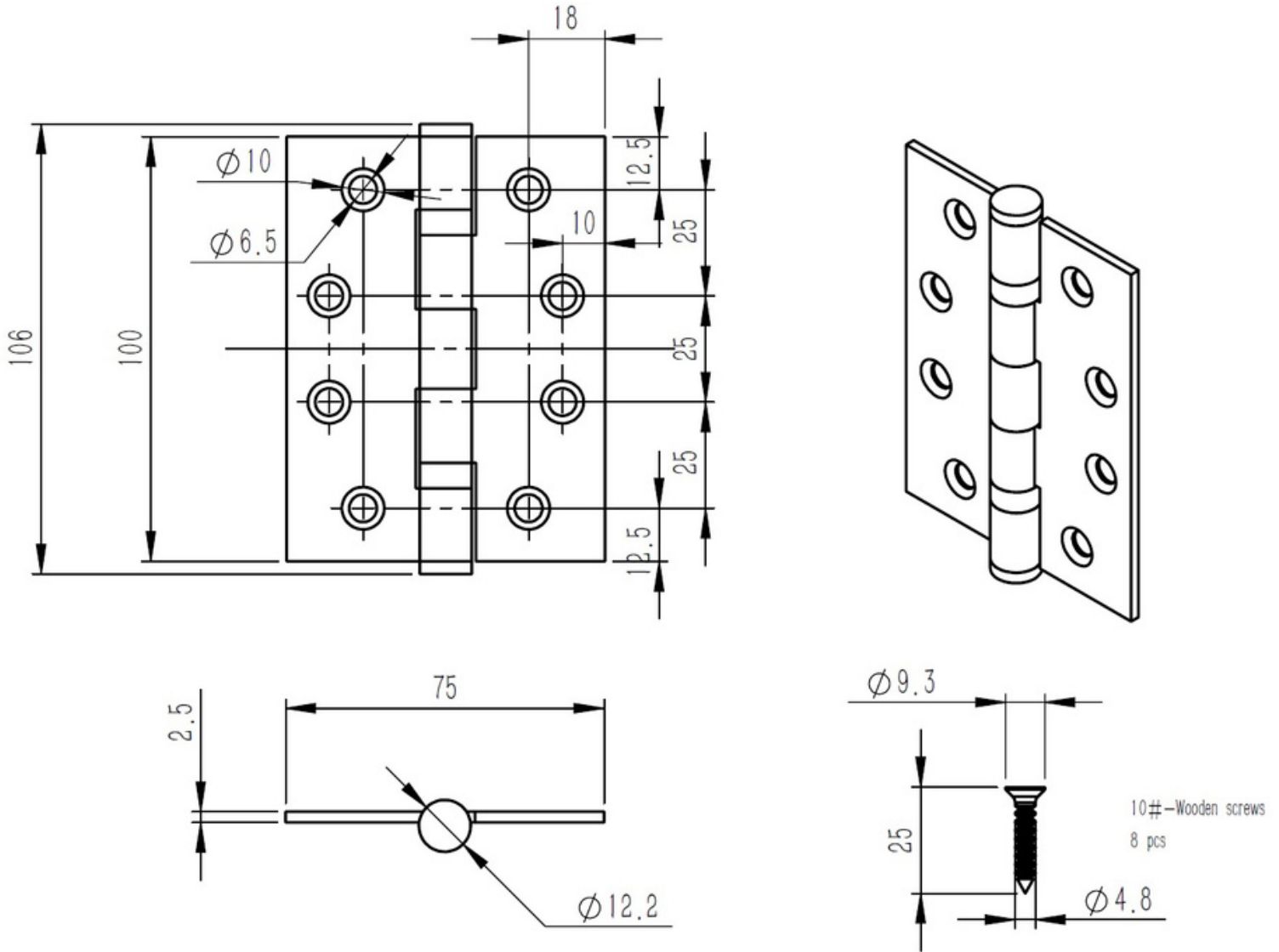



Brass Ball Bearing Hinge (Pair) 100mm x 75mm



| FINISHES | | | |
|---|-------------|---|----------------|
|  | Aged Brass |  | Brushed Nickel |
|  | Satin Brass |  | Matt Black |

Fixings: Supplied with 16 x Timber Fixing Screws in matching finish.

Pack Contents: 2 x Ball Bearing 100mm x 75mm fixed pin hinges plus fixings.

Material: Constructed from 304 grade Stainless Steel.