

SurPro®

Scan QR code
for the latest
Instruction Manual



SINGLE-SIDED STILTS

INSTRUCTION MANUAL

VERSION 21.08

APPLIES TO:

SurPro S Aluminum Drywall Stilts

SurPro S1 Aluminum Drywall Stilts

SurPro S1 Magnesium Drywall Stilts

SurPro S1X Magnesium Drywall Stilts
(Illustrated to right)

Proper reading and understanding this instruction manual is required before operating SurPro S/S1/S1X stilts. Following this guide is the first step towards proper safety, assembly, operation and maintenance.

PROPER ASSEMBLY REQUIRED.



STILTS.com

**Need Help?
1-888-443-8889**

WELCOME

Thank you for choosing SurPro and Stilts.com. This instruction manual will help navigate the safety, assembly, and maintenance of the SurPro S, S1, and S1X Single-Sided Stilts. Please find an alternative instruction manual if your model is not listed on the cover. Keep this manual available for all users; Reading and understanding of all contents is required before authorized user of the stilts. Contact The Forest Group or your local distributor for any questions as well as for replacement parts or warning stickers/graphics for the stilts.

NOTICE

INTENDED USE: CONSTRUCTION TRADES ONLY

SurPro Stilts are professional grade stilts intended and manufactured for commercial use in the construction trades (drywall, insulation, electrical, paint, etc.) only. The stilts covered in this instruction manual are **NOT** to be used for recreation, as a performance prop, or by children. Unintended use is prohibited.

NOTICE

ALWAYS PERFORM A SAFETY INSPECTION

Before each use, ensure stilts are assembled properly, inspect all components for damage (and replace parts when needed), ensure all connections are safe and secure. Stilts require regular maintenance as parts and components wear over time. Use only proper Genuine SurPro parts and spare part kits when needed.

NOTICE

READ, UNDERSTAND AND FOLLOW

Read the manual and follow safety guidelines completely. Understand that SurPro, Stilts.com, The Forest Group, Inc. and dealers of SurPro products are not responsible for incidences resulting from negligence, unintended or improper use, failure due to lack of maintenance, use of improper parts, or use of non-genuine SurPro parts.

NOTICE

LEARN TO WALK SAFELY ON STILTS

New users must learn and demonstrate safe, proper stilt walking techniques. All users must read the "Learning to Walk" section of this manual on page 10. Never supply a new user with stilts without proper training.

WARNING: DO NOT EXCEED load limit of 225 LB

User weight (including tools, clothing, boots, safety equipment, and materials being handled) should not exceed 225 LB.

TABLE OF CONTENTS

NOTICE	2
WARNING & SAFETY PRECAUTIONS	4
PACKAGE CONTENTS	5
ASSEMBLY INSTRUCTIONS	6-8
STILTS ADJUSTMENTS	9-10
LEARNING TO WALK	10
GENUINE PARTS & PARTS DIAGRAM	11-13
PART KITS	13
PARTS LIST	14-15
CONVERT SINGLE-SIDED TO DOUBLE-SIDED	16-17
CARE & MAINTENANCE	18



PRODUCT REGISTRATION & WARRANTY

First things first, register your SurPro stilts for the best in customer care, service, and warranty. Do it online! It's quick and easy.



PG. 19

WARNING & SAFETY PRECAUTIONS



Under no circumstances should the stilts be used while under the influence of alcohol, drugs, or other medications that can impair your balance, judgment, or cause drowsiness. Do not over-reach while on stilts. Do not exceed max load limit (225 LB). Do not operate without proper safety, operation and maintenance knowledge. Always keep your stilts planted firmly on solid ground.

Always inspect your walking area. Perform a jobsite inspection to be sure the area is free of tripping hazards including, but not limited to: extension cords, drop cloths, spilled liquids, debris or obstacles. Your worksite should not have any open stairwells, vents, or windows that would present a fall or tripping hazard. Never use your stilts on scaffolding or on plywood that is placed over any type of opening. Only use stilts on solid, firm and stable ground.

Always inspect your stilts prior to every use. Check for worn or damaged parts and always replace with Genuine SurPro parts. Check and tighten all nuts and bolts, but do not over-tighten any loose nuts, wing bolts or screws. SurPro, Stilts.com and The Forest Group, Inc. are not responsible for any equipment failures if non-genuine SurPro parts are used, or stilts are not maintained.

Clean your stilts regularly. Dirty equipment may obscure excessive wear. Keep soles and walking area clean, dry, and free of lubricants, debris, and obstacles which may cause slipping or tripping.

Keep lubricated. Keep all pivot points and adjustment joints clean and lubricated. Lubricate lightly, when necessary, with silicone or graphite-based lubricants.

Mount and dismount your stilts with the help of a spotter using a clean and level area away from doors, windows, stairwells, floor vents, etc. Never jump on or off stilts. Step down using a work platform of the appropriate height.

PACKAGE CONTENTS

This manual covers SurPro Single-Sided Stilts (Models S, S1 & S1X).

Package contents and assembly instructions will be the same unless otherwise noted.



WHAT'S IN THE BOX

Please ensure that all package contents are present before assembling Stilts. DO NOT walk on Stilts if parts are missing. Contact your supplier, or us, immediately if parts are missing.

- | | |
|---|--|
| 1 | Left Main Body Stilt w/ Arch Strap (Must secure Arch Strap w/ 2 Screws) |
| 1 | Right Main Body Stilt w/ Arch Strap (Must secure Arch Strap w/ 2 Screws) |
| 2 | Upper Side Poles w/ Leg Bands |
| 2 | Leg Band Straps |
| 2 | Lower Side Poles |
| 2 | Side Pole Clamps w/ Bolts |
| 2 | Heel Cups |
| 4 | Heel Cup Bolts & Nuts (2 for each Heel Cup) |
| 4 | Arch Strap Panhead Screws (2 for each Arch Strap - mounted under Foot Plate) |
| 2 | Toe Straps w/ Buckles |
| 4 | Toe Strap Panhead Screws (2 for each Toe Strap) |
| 2 | 11 mm Wrenches |
| 1 | Instruction Manual |
| 1 | Warranty Registration Card |

ASSEMBLY INSTRUCTIONS

1 INSTALL HEEL CUP

Position the heel cup in one of the three mounting points depending on the size of the user's shoe. Secure heel bracket by inserting nuts onto the bottom of the foot plate. While holding the nuts down, insert screws through the top of the heel cup and secure to nuts.

Repeat this step for the other stilt.

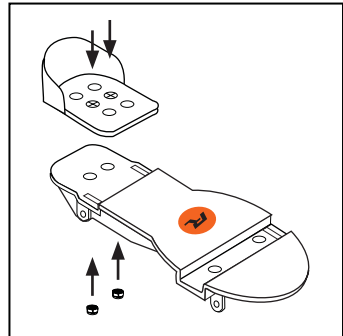

2 TOE & ARCH STRAPS POSITIONING

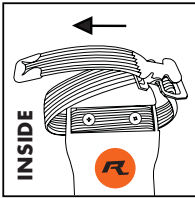

Toe straps must be threaded as depicted and mounted with panhead screws. Position buckle above the foot and oriented so that the strap can be tightened toward the inside.

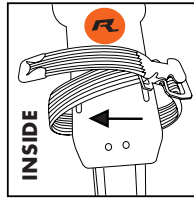

Arch straps can be mounted similar to the toe straps (on the top) - or as shown left - mounted below the foot plate toward the back of the heel. Straps tighten toward the inside of the foot plate.

Positioning and securing the Arch Straps below the Foot Plate

Place your foot on to the foot plate and rotate the arch strap into a comfortable position, where the strap can be tightened securely across the top of your foot/boot. Once you are happy with the positioning, secure the strap to the bottom of the foot plate with screws.

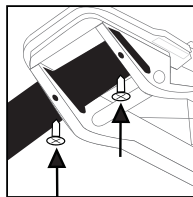
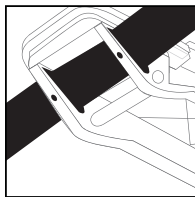
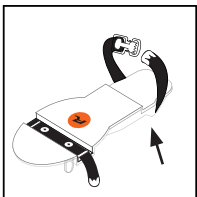

Repeat this step for the other stilt.

Always check your straps for excessive wear and replace when worn or frayed. Never wear or use worn out straps. Replacement straps and parts are available at stilts.com.

ASSEMBLY INSTRUCTIONS

Optional: Positioning and securing Arch Straps on top of the Foot Plate

Arch straps may also be worn directly below the heel, Use alternate mounting instructions as depicted below:

First remove the side pole clamp bracket to provide better access.

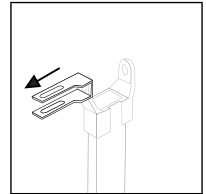
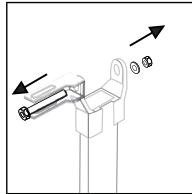

Then, thread the straps through the top portion of the footplate, and secure in place with panhead screws.

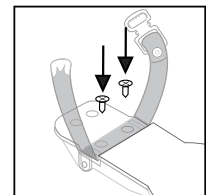
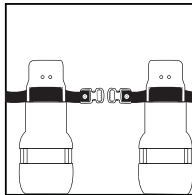

3 SIDE POLE INSTALLATION

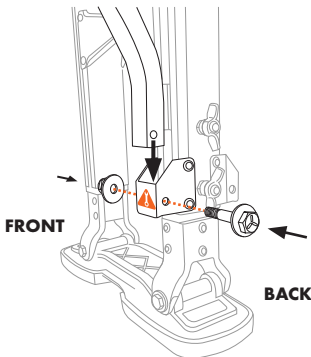

Insert Lower Strut Tube into the Outside Bracket on the main stilt body and secure with bolt, washers and nut. This view is from the rear of the stilt. The extra inside bracket is not used for single-sided stilts, but present in the event you want to upgrade and convert these stilts to double-sided stilts.

Repeat this step for the other stilt.



Caution: Check the Outside Bracket before each use and ensure bolt and nut are secure.

ASSEMBLY INSTRUCTIONS

SIDE POLE INSTALLATION CONTINUED.

SIDE POLE CLAMPS

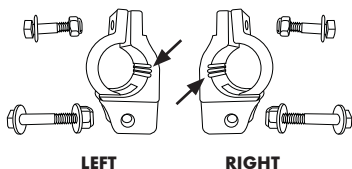

Prepare Side Pole Clamps for use on Lower and Upper Strut Tubes. Remove bolts from clamps. The clamps are a two-piece part that will separate once the bolts are removed. Note the three notches on the inside portion of the clamps. These female grooves will match up with a male groove on the Upper Strut Tube later in this installation. The grooves prevent the side poles from twisting, a feature exclusive to SurPro.

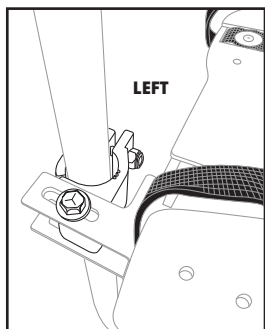

Install Side Pole Clamps loosely around Lower Strut tubes, and position inside Side Pole Clamp Bracket. Position 3 notches towards the main stilt body. Place the bolts in place (long bolt in back, and short bolt in front), and secure hand tight. Leaving this piece loose will allow you to slide the Upper Strut Tube over the Lower Strut tube in the next step. You will secure these bolts with the set of supplied wrenches in later steps.

Repeat this step for the other stilt.

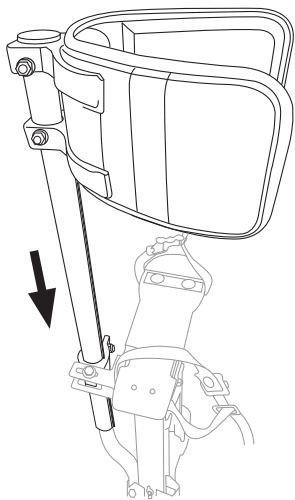

Slide the Upper Strut Tube over the Lower Strut Tube. Match the male notch on the inside of the Upper Strut Tube with one of the 3 female notches on the Lower Strut Tube. This notch will prevent the pole from twisting. Slide the Upper Strut Tube up and down until the Leg Band is positioned correctly on your calf (typically about 3-4 finger widths below your knee or at the widest width of your calf). Once you find the most comfortable and secure height, you can secure in place by tightening the two bolts on each of the Side Pole Clamps (left and right).

Repeat this step for the other stilt.



DO NOT OVERTIGHTEN.

Overtightening can cause damage to the side poles.

STILTS ADJUSTMENTS

SurPro Stilts are designed to maximize the user's comfort and safety. There are three main areas of adjustment to achieve the desired settings for each user: Stilt Height, Side-Pole Rotation and Spring Tension.

1 STILT HEIGHT ADJUSTMENT

SurPro Stilts are designed to be used with 8 Wing Bolts (4 on each stilt). Using all Wing Bolts increases safety and also extends the lifespan of internal parts. The Double Wing Bolt design is an exclusive safety feature that also increases durability.

To adjust height:

Remove all Wing Bolts (HS142S), and slide the Inner Extension Tube to desired height.

Reinstall Wing Bolts and Hand-tighten at desired height.

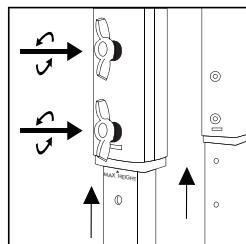
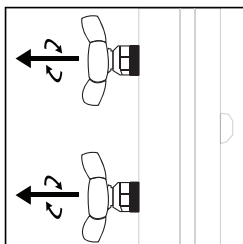

Caution: Do not pull the Inner Extension Tube past the "Max. Height" engraving, or force the Inner Extension Tube out of the Main Leg Strut. A plastic sleeve and tab is present to prevent this from happening, but excessive force will damage the plastic sleeve.

2 SIDE POLE ROTATION

The groove on the side pole, and the three grooves on the side pole clamp, not only prevent the pole from twisting, but also provide three optional positions of rotation.

Simply loosen the side pole clamp and choose a position that feels most comfortable.

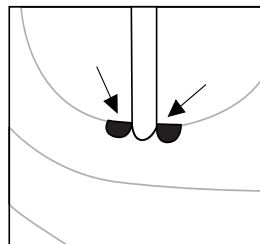
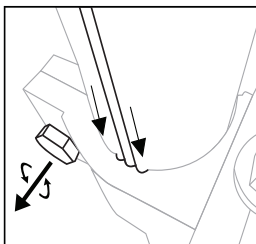

DO NOT OVERTIGHTEN.

Overtightening the clamp can cause damage to the side poles.

STILT ADJUSTMENTS

3 MAIN BODY SPRING TENSION

Note: The upper portion of the spring controls forward motion, whereas the lower portion of the spring controls backward motion.

To correct a tendency to lean forward, tighten the upper spring adjuster (A) to increase tension on the spring (clockwise rotation).

To correct a tendency to lean backwards when walking, tighten the lower spring adjuster (B) to increase tension on the spring (clockwise rotation).

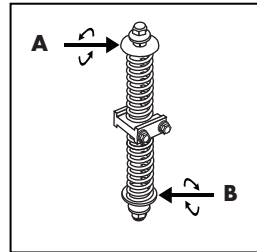

Caution: Always check that all bolts and screws have been tightened after making adjustments and prior to every use.

LEARNING TO WALK



WARNING: Always walk on a level, clean floor free of any tripping hazards. Avoid openings such as doorways, floor vents, stairwells, or windows that you can fall through. A messy jobsite is NOT the right place. Practice with a spotter and within reaching distance of a solid structure to hold to assist with balance.

WALKING INSTRUCTIONS & SAFETY TIPS

- Make sure all parts are installed and functioning properly and make the necessary adjustments to ensure a proper fit.
- Find a colleague/spotter to assist you with putting on the stilts and securing the straps. The spotter should also provide assistance to help maintain your balance.
- Take slow, deliberate, and short steps. Lift your knees to pick up the stilts completely off the ground with each step. Never drag or shuffle your feet (stilts).
- Keep your legs spaced out enough that the stilts do not touch each other when walking.
- To change directions, walk in a wide "U" shaped pattern.
- Practice makes perfect, so take your time and ensure that you are comfortable and secure in the stilts before walking unassisted.
- **DO NOT** take large or over-extended steps, or reach and lean to the point where your balance is compromised.
- **NEVER** walk backwards on stilts, or up and down stairs.
- When walking sideways, look carefully before placing your stilts. Lift one foot at a time and carefully plant your foot on the floor before lifting the other foot.



ALWAYS USE GENUINE SURPRO PARTS



Inspect included parts carefully before use or installation. Look for wear or damage. If any component has been worn out, dented, cracked or bent, or if screws/washers/bolts/parts are missing or damaged, replace with genuine SurPro parts immediately.

Please note:

The Forest Group, Inc. is not responsible for any equipment failures if non-genuine SurPro replacement parts are installed or if the stilt is dismantled and components are not installed correctly.

PARTS DIAGRAM

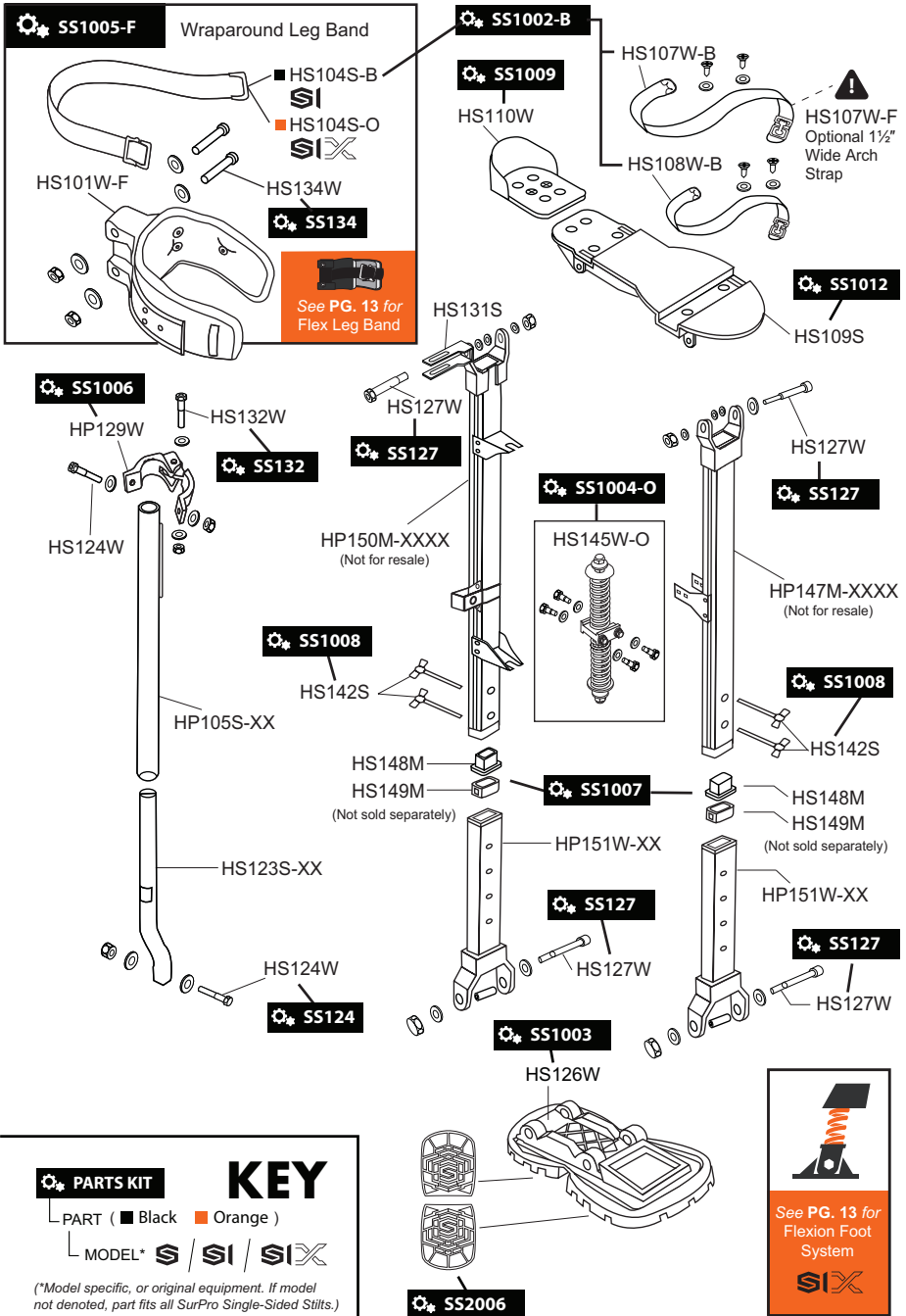

PARTS DIAGRAM

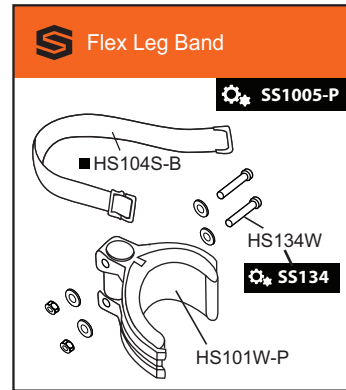

PART KITS

Part Kits fit all single-sided stilts (S, S1 & S1X) unless otherwise noted.

PART NO.	PART KITS DESCRIPTION
SS1002-B	Strap Kit, Black (Pair). (2) Leg Band Straps w/ Buckle (HS104S-B), (2) Arch Straps w/ Buckle, Screws and Washers (HS107S), (2) Toe Straps w/ Buckle, Screws and Washers (HS108W). *This kit includes Leg Bands w/ Black Straps, <u>not</u> w/ Orange Straps (HS104S-O).
SS1003	Floor Plate Kit w/ Super Grip Soles (Pair).
SS1004-O	Main Body Spring Assembly Kit (Pair). (2) Springs w/ Hardware (HS145W-O).
SS1005-F	Wraparound Leg Band Kit (Pair). (2) Wraparound Leg Bands (HS101W-F), (2) Leg Band Straps (HS104S-B), Leg Band Bolt Kit - (4) Bolts, (8) Washers and (4) Nuts (SS134).
SS1005-P	Flex Leg Band Kit (Pair). (2) Flex Leg Bands (HS101W-F), (2) Leg Band Straps (HS104S-B), Leg Band Bolt Kit w/ Washers and Nuts (SS134).
SS1006	Side Pole Clamp and Bracket Kit w/ Hardware (Pair) - (2) Side Pole Clamps (HP129W), (2) Outer Metal Clamp Brackets, (2) Side Pole Bolt Assemblies (HS124W).
SS1007	Nylon Sleeve Kit (Pair). (4) Nylon Sleeve Top (HS148M) and (4) Nylon Sleeve Bottom (HS149M).
SS1008	Wing Bolt Kit. (4) Wing Bolts w/ Washers (HS142S).
SS1009	Heel Bracket Kit w/ Screws (Pair). (2) Heel Brackets w/ (4) Screws (HS110W).
SS1012	Foot Plate Kit (Pair).
SS124	Side Pole Bolt Kit. (2) 1/4"-20 x 1-1/2" Cap Screws w/ (2) Locknuts and (4) Washers.
SS127	Main Strut Bolt Kit. (8) 1/4"-20 x 3" Cap Screws w/ Locknuts, Washers, and Spacers.
SS132	Side Pole Clamp Bolt Kit. (2) 1/4"-20 x 1-3/4" Cap Screws w/ Locknuts and (4) Washers.
SS134	Leg Band Bolt Kit. (4) 1/4"-20 x 2" Cap Screws, (4) Locknuts and (8) Washers.
SS2006	Super Grip Soles w/ Screws (4 soles). Fits all SurPro Stilt models.
SS2007	Flexion Floor Plate w/ Super Grip Soles (Pair). Fits S1X models only.

See pages 14-15 for individual parts.

PARTS LIST

Part Kits fit all single-sided stilts (S, S1 & S1X) unless otherwise noted. Some are size specific.

PART NO.	PARTS DESCRIPTION
HS101W-F	Wraparound Leg Band
HS101W-P	Flex Leg Band
HS104S-B	Leg Band Strap (Black) 1.5" W x 10.5" L
HS104S-O	Leg Band Strap (Orange) 1.5" W x 10.5" L
HP105S	Round Upper Side Pole w/ Key (Fits S1 and S1X, Size: 20"-30" and 26"-40")
HP105S-16	Round Upper Side Pole w/ Key for (Fits S1, Size: 16"-24")
HS107W-B	Arch Strap w/ Accessories 1" W x 23" L
HS107W-F	Arch Strap (Wide) w/ Accessories 1.5" W x 23" L
HS108W-B	Toe Strap w/ Accessories 1.5" W x 17" L
HS109S	Nylon Foot Plate
HS110W	Adjustable Aluminum Heel Bracket w/ Screws
HS116W-O	Flexion Toe Spring with Bushing (Fits S1X)
HS123S	Round Lower Side Pole w/ Key (Fits S1 and S1X, Size: 20"-30" and 26"-40")
HS123S-16	Round Lower Side Pole w/ Key (Fits S1, Size: 16"-24")
HS124W	Side Pole Bolt Assembly (1/4"-20 x 1-1/2" Cap Screw w/ Locknut and Washers)
HS126W	Floor Plate with Super Grip Soles
HS127W	Main Strut Bolt Assembly (1/4"-20 x 3" Cap Screw w/ Locknut and Washers)
HP129W	Side Pole Clamp w/ Key Grooves
HS131S	Outer Metal Clamp Bracket
HS132W	Side Pole Clamp Bolt Assembly (1/4"-20 x 1-3/4" Cap Screw w/ Locknut and Washers)
HS134W	Leg Band Bolt Assembly (1/4"-20 x 2" Cap Screw w/ Locknut and Washers)
HS142S	Wing Bolt w/ Washer
HS145W-O	Spring Assembly
HS147M-16UA	Front Main Leg Strut - Aluminum / Silver (Fits Size: 16"-24") <i>Not Sold Separately</i>
HS147M-16BM	Front Main Leg Strut - Magnesium / Black (Fits Size: 16"-24") <i>Not Sold Separately</i>
HP147M-18UA	Front Main Leg Strut - Aluminum / Silver (Fits Size: 18"-30") <i>Not Sold Separately</i>
HP147M-20UA	Front Main Leg Strut - Aluminum / Silver (Fits Size: 20"-30") <i>Not Sold Separately</i>
HP147M-20BM	Front Main Leg Strut - Magnesium / Black (Fits Size: 20"-30") <i>Not Sold Separately</i>
HP147M-24UA	Front Main Leg Strut - Aluminum / Silver (Fits Size: 24"-40") <i>Not Sold Separately</i>
HP147M-26UA	Front Main Leg Strut - Aluminum / Silver (Fits Size: 26"-40") <i>Not Sold Separately</i>
HP147M-26BM	Front Main Leg Strut - Magnesium / Black (Fits Size: 26"-40") <i>Not Sold Separately</i>

PARTS LIST

Part Kits fit all single-sided stilts (S, S1 & S1X) unless otherwise noted. Some are size specific.

PART NO.	PARTS DESCRIPTION
HS148M	Nylon Sleeve (Top) <i>Sold in Kit</i>
HS149M	Nylon Sleeve (Bottom) <i>Sold in Kit</i>
HS150M-16BM	Back Main Leg Strut - Magnesium / Black (Fits Size: 16"-24") <i>Not Sold Separately</i>
HS150M-16UA	Back Main Leg Strut - Aluminum / Silver (Fits Size: 16"-24") <i>Not Sold Separately</i>
HP150M-18UA	Back Main Leg Strut - Aluminum / Silver (Fits Size: 18"-30") <i>Not Sold Separately</i>
HP150M-24UA	Back Main Leg Strut - Aluminum / Silver (Fits Size: 24"-40") <i>Not Sold Separately</i>
HP150M-20BM	Back Main Leg Strut - Magnesium / Black (Fits Size: 20"-30") <i>Not Sold Separately</i>
HP150M-20UA	Back Main Leg Strut - Aluminum / Silver (Fits Size: 20"-30") <i>Not Sold Separately</i>
HP150M-26BM	Back Main Leg Strut - Magnesium / Black (Fits Size: 26"-40") <i>Not Sold Separately</i>
HP150M-26UA	Back Main Leg Strut - Aluminum / Silver (Fits Size: 26"-40") <i>Not Sold Separately</i>
HP151W-16	Inner Extension Tube w/ Plastic Sleeves (Fits Size: 16"-24" Stilts)
HP151W-18	Inner Extension Tube w/ Plastic Sleeves (Fits Size: 18"-30" Stilts)
HP151W-20	Inner Extension Tube w/ Plastic Sleeves (Fits Size: 20"-30" Stilts)
HP151W-24	Inner Extension Tube w/ Plastic Sleeves (Fits Size: 24"-40" Stilts)
HP151W-26	Inner Extension Tube w/ Plastic Sleeves (Fits Size: 26"-40" Stilts)
HT151W-20	Flexion Inner Extension Tube w/ Sleeves (Fits S1X, Size: 20"-30")
HT151W-26	Flexion Inner Extension Tube w/ Sleeves (Fits S1X, Size: 26"-40")
HT190S	Flexion Upper Spring Block (Fits: S1X)
HT191S	Flexion Spring Pivot (Fits: S1X)
HT192W	Flexion Floor Plate w/ Super Grip Soles (Fits: S1X)
HT201W	Flexion Spring Pivot Bolt w/ Locknut and Washers (Fits: S1X)
HT202W	Flexion Toe Spring Block Bolt w/ Locknut and Washers (Fits: S1X)



NEED HELP LOCATING PARTS?

We are happy to help you locate the correct parts for your stilts or answer any questions.



+1 (888) 443-8889



help@stilts.com

CONVERT SINGLE-SIDED TO DOUBLE-SIDED

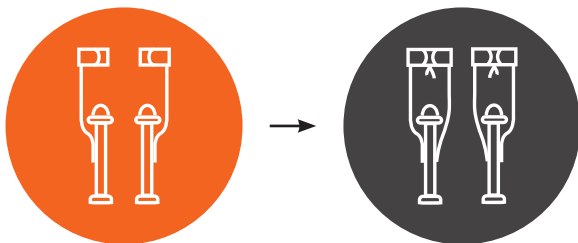

SurPro Single-Sided Stilts can be converted into Double-Sided Stilts by replacing the leg poles and leg bands. We have different conversion kits for different models/sizes, though the how-to instructions for replacing parts is generally the same.

1 ORDER THE CORRECT CONVERSION KIT

Kits include everything needed to convert SurPro single-sided stilts into double-sided stilts: side poles w/ end caps and pole holder, bolt assemblies, leg bands and straps, inner bracket, etc.

ML-DW-5	Double-Sided Conversion Kit for 16"-24" Single-Sided Stilts. Converts single-sided stilts to double-sided stilts.
ML-DW-3	Double-Sided Conversion Kit for 20"-30" Single-Sided Stilts. Converts single-sided stilts to double-sided stilts.
ML-DW-6	Double-Sided Conversion Kit for 26"-40" Single-Sided Stilts. Converts single-sided stilts to double-sided stilts.
ML-AR-6	Double-Sided Conversion Kit w/ S2X Wraparound Rocking Leg Bands for 26"-40" Single-Sided Stilts. Converts single-sided stilts to double-sided stilts w/ S2X Wraparound Rocking Leg Bands.

2 INSTALLING NEW DOUBLE-SIDED SIDE POLE CLAMPS

Before you can install your new conversion kit you will need to remove your single-sided side pole clamps.

Detach your single-sided pole (HP105S-XX) by removing the 1 1/2" bolt, washers and locknut (HS124W) and side pole clamp (HP129W).

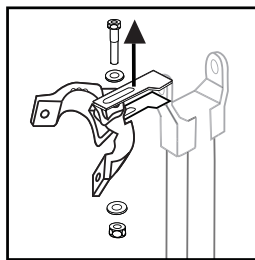
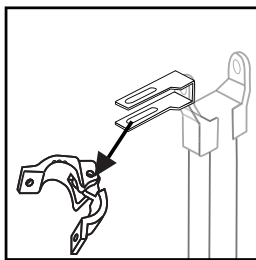

CONVERT SINGLE-SIDED TO DOUBLE-SIDED

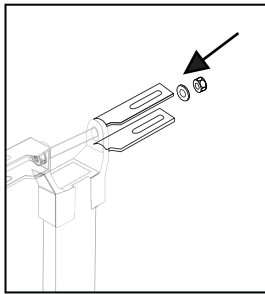
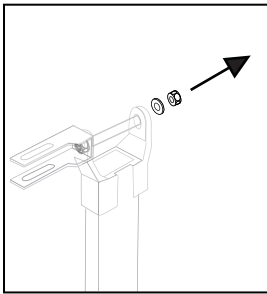

Remove nut and washer from bolt. Attach the second metal clamp bracket (HS131 S) onto the main stilt body with the 3" bolt, washers and locknut (HS127W).

3

INSTALL DOUBLE-SIDED POLES

Once you have the proper parts in hand, remove your existing single-sided poles:

First, insert the right and left side poles (HS123S) into the brackets on the main stilt body. The opening on the legband, where you enter and exist your leg from the stilt, should face the toe (front) of the stilt.

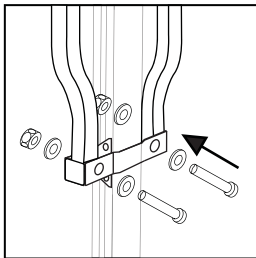
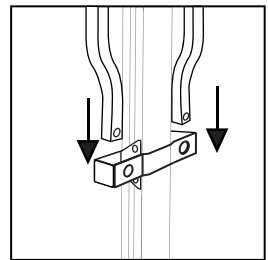

Next, secure each side with a 1½" bolt, two washers (one on the front and back of each bolt) and nylon locknut (HS124W).

Lastly, line up side pole holders with the side pole clamps and secure with 1¾" bolt, two washers and nylon locknut (HS132W).

Position and secure of the bolts at a width that allows for comfortable positioning of your calf between the side poles.

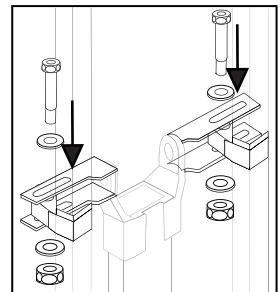
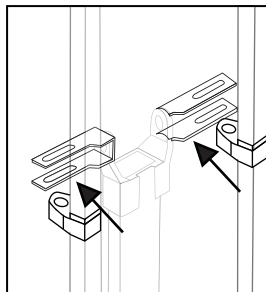

PRODUCT REGISTRATION & WARRANTY

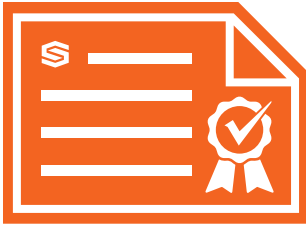

REGISTER YOUR STILTS!

We strongly encourage you to take a minute and register your new SurPro Stilts. Product registration is required for all warranty claims. Do it online, or hover your smart phone camera over the QR code below.

Register online

www.stilts.com/product-registration

Or

Scan QR

Code



1 YEAR LIMITED WARRANTY

The Forest Group, Inc. offers a one-year limited warranty on the structural components of your SurPro Stilts against manufacturing defects from the date of purchase. Excluded are components subject to normal wear, abuse, neglect, or improper assembly. Excluded wear parts include, but are not limited to, nylon bushings, sleeves, leg bands, soles, springs, and straps. The Forest Group, Inc. does not cover damage incurred by misuse of the product. In particular,

SurPro S, S1, and S1X Stilts are designed and intended for use in the construction and drywall industries and are not designed for use as recreational or performance prop. The Forest Group, Inc. is only responsible for the repair and replacement of SurPro products and parts. This warranty does not cover consequential damages, incidental damages, or damages to persons or property connected to the use of our products. The product owner is responsible for inbound shipping costs. Excluded from all warranties are inbound freight and postage for freight losses. The warranty is non-transferable and limited exclusively to the original purchaser.

All warranty returns for repair must include a Return Merchandise Authorization (RMA) number provided by us, and a copy of the original proof of purchase. Unauthorized returns without an RMA number, or proof of purchase, will not be accepted. To obtain an RMA number, please:

Submit a Warranty Service Form Online

www.stilts.com/warranty

Or

Call 1-888-443-8889



Need Help?



+1-888-443-8889



help@stilts.com



5600 Bonhomme Rd Ste C Houston, TX 77036

A division of The Forest Group, Inc.

STILTS.COM