

800002104, 800002104-AB1, 800002104-AB2
 800003104, 800003104-AB1, 800003104-AB2
 800004104, 800004104-AB1, 800004104-AB2

frameitall
 simple modular gardens

RAISED GARDEN BED

16' x 16' Orbital



2 LEVELS



3 LEVELS

2 LEVEL KIT CONTAINS:

- Composite Boards 4' x 34
- Composite Boards 2' x 8
- Composite Curved Boards x 12
- Cut Composite Board (Gate) x 4
- Stacking Brackets x 96
- 4-way Bracing Brackets x 16
- Stacking Stakes x 52
- Plugs x 244
- Finishing Caps x 8
- Adapter cap x 18
- Animal barrier gate (4ft) x 2
- Animal barrier Fencing x 56ft
- Gate to Board Connector x 8

3 LEVEL KIT CONTAINS:

- Composite Boards 4' x 50
- Composite Boards 2' x 12
- Composite Curved Boards x 18
- Cut Composite Board (Gate) x 4
- Stacking Brackets x 144
- 4-way Bracing Brackets x 32
- Stacking Stakes x 78
- Plugs x 336
- Finishing Caps x 8
- Adapter Cap x 18
- Animal barrier gate (4ft) x 2
- Animal barrier Fencing x 56ft
- Gate to Board Connector x 8
- Metal Gate Brace with Screws x 4

Recommended Tools:

- Hammer
- Power Drill
- Flathead Screwdriver



Layout your Boards along the borderline and connect each Board together by inserting the top of the stake through the bracket loops with the stake pointing to the sky. This enables you to freely position your border to get your desired location.

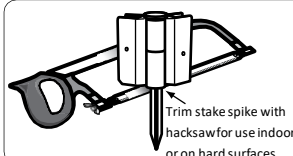

FOR INDOOR & HARD SURFACE:

If you plan to assemble raised bed on a hard surface, use hacksaw to remove the spike of each stake. Use these cut down stakes for the base level only of your raised garden.

Customer Service: 1800-914-9835 |

support@frameitall.com

© Frame It All. All Rights Reserved.



4 LEVELS

4 LEVEL KIT CONTAINS:

- Composite Boards 4' x 66
- Composite Boards 2' x 16
- Composite Curved Boards x 24
- Cut Composite Board (Gate) x 12
- Stacking Brackets x 192
- 4-way Bracing Brackets x 24
- Stacking Stakes x 104
- Plugs x 448
- Finishing Caps x 8
- Adapter Cap x 18
- Animal barrier gate (4ft) x 2
- Animal barrier Fencing x 56ft
- Gate to Board connector x 8
- Metal Gate Brace with Screws x 8

ASSEMBLY INSTRUCTIONS – Level 1

STEP 1:

Assemble the Boards by sliding one end of Board into channel end of one of the brackets. Use plugs to cover the holes on both sides to lock the bracket in place.



1. Connect **18** x 4ft Boards with Stacking Brackets on both ends in alternating orientation.

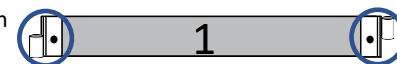

2. Connect **4** x 2ft Boards with a stacking bracket on one end and a mid-section 4-way bracket on the other end in alternating orientation.

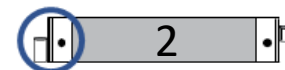

3. Connect **4** x 4ft Boards with a stacking bracket on one end and a top 4-way bracket on the other end in alternating orientation.

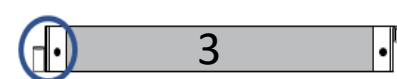

4. Connect **6** x Curved boards with stacking brackets on both ends in alternating orientation .

(Bracket all curved boards exactly as shown to the right)



How the Joints Work

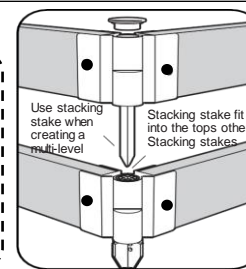
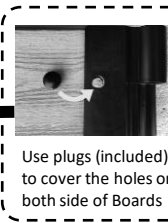
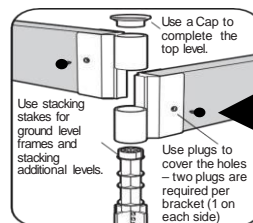

3-Way Connection:

Combine a top 4-way bracket, mid-section 4-way bracket and stacking bracket.

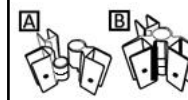

ASSEMBLY INSTRUCTIONS – Level 1 Continued

Step 2: Layout the Boards for the first level according to the number of the board in Step 1.

Note: It is especially important to layout Boards 2 & 3 in the exact orientation shown in the diagram below.

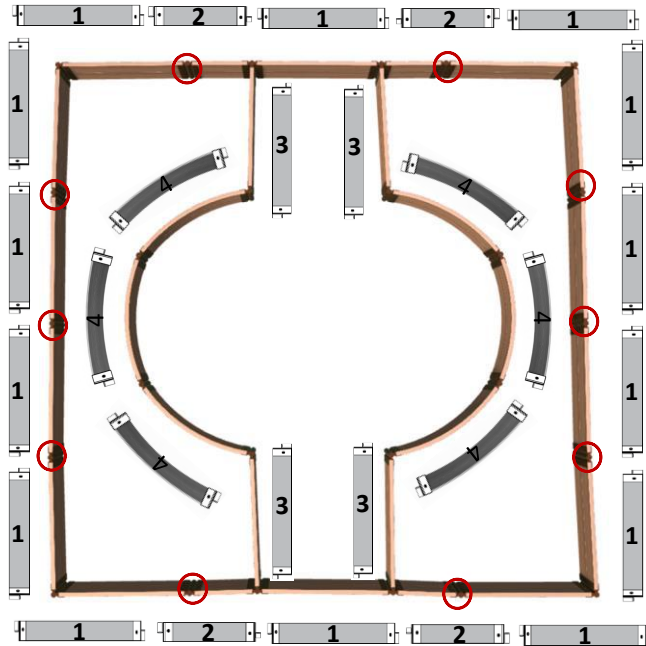

The gate Board (**Board 1**) on level 1 is kept uncut for 2" profile boards to act as a level surface for the gate to swing on. You can choose to cut this Board if you want it to be apart of the swinging gate.

IMPORTANT: If you connect any brackets incorrectly, they can be removed by inserting a flathead screwdriver into the opening of the snap-lock plugs, pushing into the nub and twisting upwards.

Step 3: When connecting the boards for the first level, insert the stacking stakes upside down so the stake is pointing to the sky. This will allow you to adjust the shape of your frame before driving the stakes into the ground. Install anchor stakes on the joints indicated by a circle on the diagram to the left. All other joints on the ground level will use stacking stakes.

Step 4: Once you finish with the adjustments of your base level frame, flip over the stakes and hammer them into the ground.

STEP 5:

Connect the boards for your second level in the quantity and orientation as shown below.

1. Connect 16 x 4ft Boards with Stacking Brackets on both ends in alternating orientation.

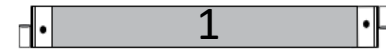

2. Connect a 2ft and 4ft board using the L-Brackets to create a 90° board Segment. Then, connect stacking brackets on both open ends of each board in the orientation shown on the right.

Repeat this step to create 2 sets of 2a and 2b board segments.



3. Connect 6 x Curved boards with stacking brackets on both ends in alternating orientation .
(Bracket all curved boards exactly as shown to the right)



4. Connect 4 x Cut gate Boards with a stacking bracket on the board end with pre-drilled holes.



Step 6: Before stacking your boards, lay them out around your 1st level frame.

NOTE: Stacking stakes will be used for all additional levels and can insert into the top of existing stakes.

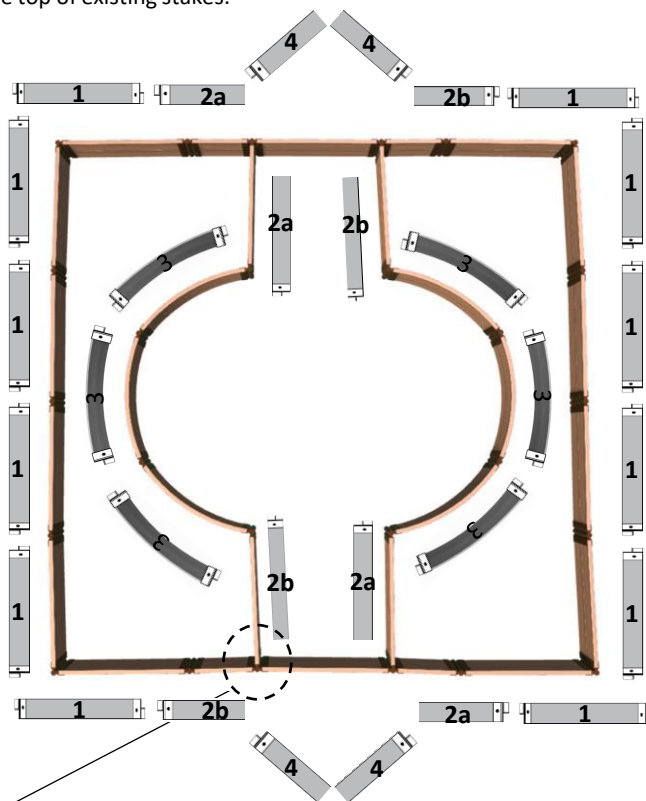

Step 7. Start your 2nd level by connecting the front gate joints. Have the bracket for the gate board (4) on the bottom of the joint as shown in the picture to the left. Then connect the 90° board segments (2) and continue from this point stacking the remaining 2nd level boards.

Skip to step 1 of the Animal Barrier assembly if you are assembling a 2-level bed design.

Step 8: Repeat steps 5, 6, & 7 for each additional level of your design.

ASSEMBLY INSTRUCTIONS – Animal Barrier Gate

KIT CONTAINS:

Quantities doubled for 2 level Barrier

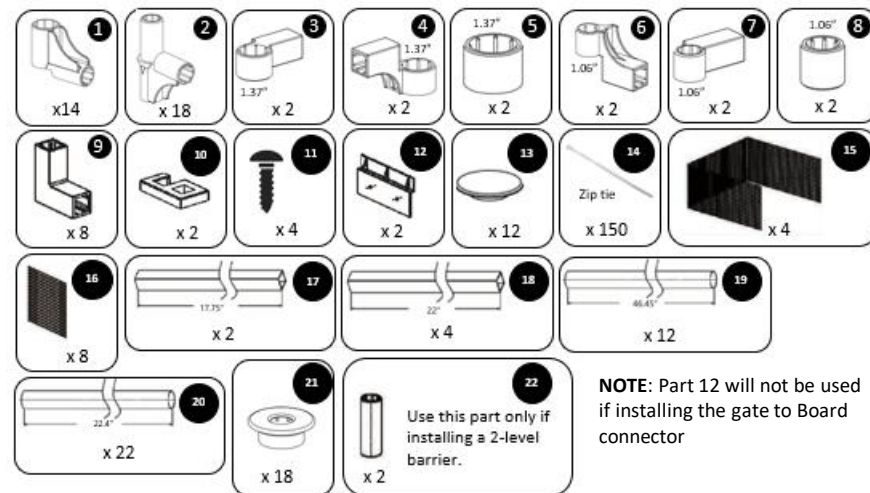

NOTE: Part 12 will not be used if installing the gate to Board connector

Step 1: Install an adapter cap (Part 21) on top of each of the 10 joints on your final level.

NOTE: Your animal barrier kit goes together by sliding the ends of the metal tubes into the plastic connectors to create a frame, then zip-tying netting to the frame.

STEP 2: BUILD THE LEFT GATE

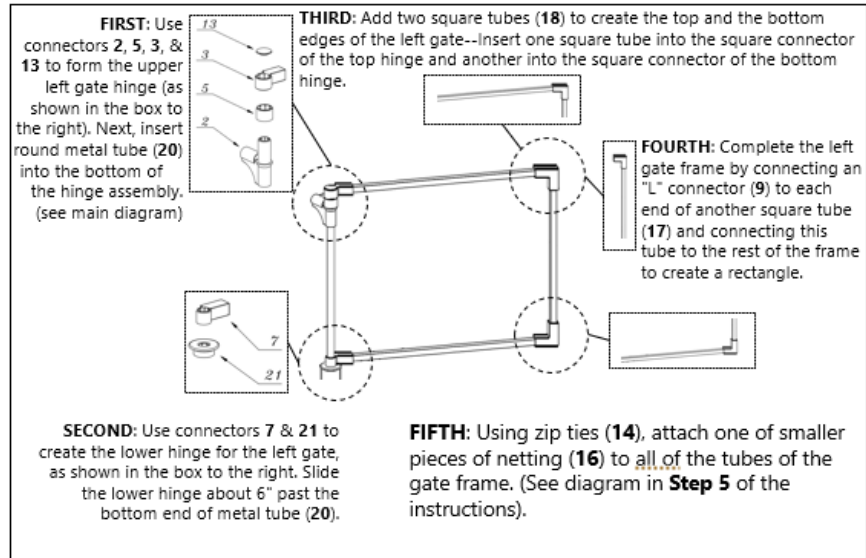

ASSEMBLY INSTRUCTIONS – *continued*

STEP 3: BUILD THE RIGHT GATE

FIRST: Use connectors 2, 4, 5, & 13 to form the upper right gate hinge (as shown in the box to the right). Next, insert round metal tube (20) into the bottom of the hinge assembly. (see diagram in the small box.)

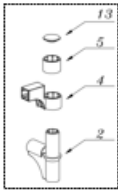

SECOND: Use connectors 6, 8 & 21 to create the lower hinge for the right gate, as shown in the box to the right. Slide the lower hinge about 6" past the bottom end of metal tube (20).

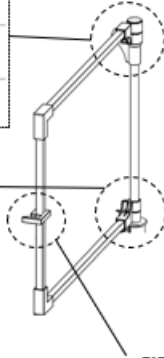
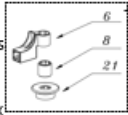

THIRD: Add two square tubes (18) to create the top and the bottom of the right gate frame. Insert one square tube into the square connector of the top hinge and another into the square connector of the bottom hinge.

FOURTH: Add an "L" connector (9) to each end of square tube (17, which has the gate-latch) with the L connectors opening in the opposite direction from the gate latch.

FIFTH: Finish the right gate frame by connecting this tube to the rest of the frame to create a rectangle.

STEP 4: Attach the gates to the raised bed boards

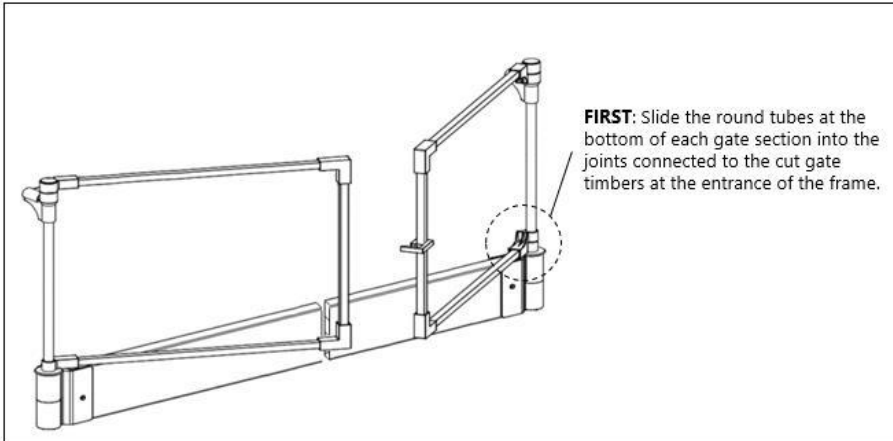

STEP 4a: Take 2 board to timber connectors and fasten them on either side of the bottom animal barrier gate pole with the screws provided and a power drill. This will allow the animal barrier gate and board gate to swing as a complete door. If you are installing this connector onto one-inch profile boards, insert the spacer block in between the gate to board connector and board before drilling in your screws.



STEP 4b: For a 3-level design, take your metal gate brace and fasten it over 2 of the left gate boards with the screws provided and a power drill. Install the gate braces on the inside portion of the garden and make sure that the screw holes are not over the edge where the 2 boards meet (see picture).

Repeat this step for the right gate.

For a 4-level design, install an additional gate brace on each door.

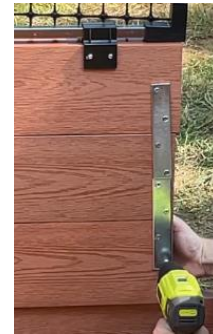

Repeat Steps 2, 3, & 4 for the second gate entrance.

ASSEMBLY INSTRUCTIONS – *continued*

STEP 5: Attach rest of framework to gate frame

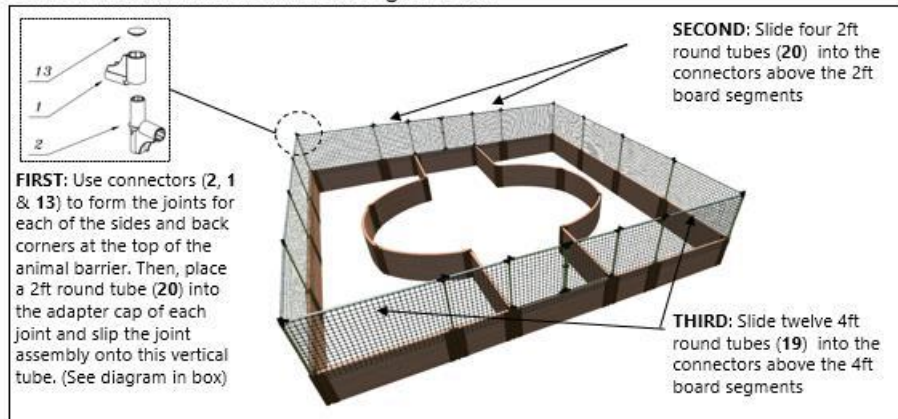

STEP 6: APPLY NETTING

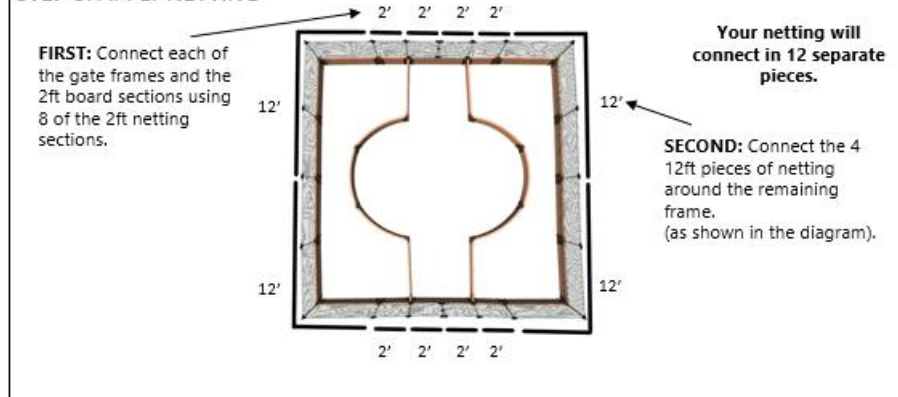

Apply the netting to both the vertical and horizontal tubes of the gates and main frame using zip ties. Attach the top of the netting flush with the upper tubes so the netting hangs over your raised bed.

ASSEMBLY INSTRUCTIONS - 2 Level Animal barrier

If assembling a 2 level Animal Barrier fencing, follow steps 1 through 5 but insert a spacing sleeve (**Part 22**) for the second level animal barrier (see diagram below).

