

# RAISED GARDEN BED

## GARDEN STAR

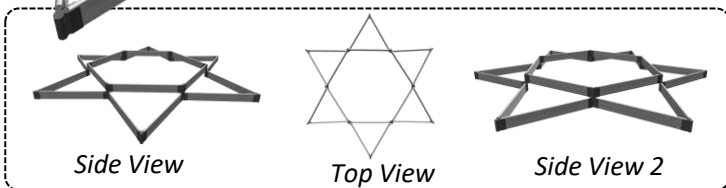
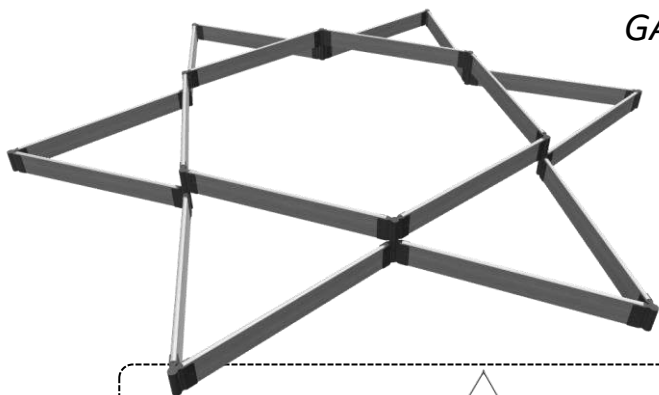

### KIT CONTAINS:

- Composite timbers 4' x 18
- Brackets x 36
- \*\*Stakes x 18
- Plugs x 72
- Caps x 12



Layout your timbers along the borderline and connect each timber together by inserting the top of the stake through the bracket loops with the stake pointing to the sky. This enables you to freely position your border to get your desired location.

### PARTS IDENTIFICATION

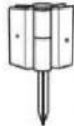

Stacking Stake

#### \*\*NOTE

Stacking stakes can be used on all levels and when creating additional levels. **ONLY** Stacking Stakes can stack!

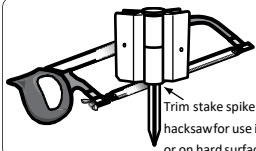

Trim stake spike with hacksaw for use indoor or on hard surfaces

#### FOR INDOOR & HARD SURFACE:

If you plan to assemble raised bed on a hard surface, use hacksaw to remove the spike of each stake. Use these cut down stakes for the base level only of your raised garden.

## ASSEMBLY INSTRUCTIONS

### STEP 1:

Assemble the timbers by sliding one end of timber into channel end of one of the brackets. Use plugs to cover the holes on both sides to lock the bracket in place.



Repeat this process on the opposite end of the timber flipping the bracket in the opposite direction (see image). **Repeat for all timbers.**



### STEP 2:

Layout the base level of your raised garden in a star shape, using 12 x 4' timbers **WITH THE STAKE UPSIDE DOWN**. This will allow the timbers to be angled easily.

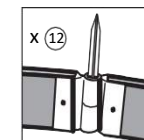

### STEP 3:

Before flipping the stake around and hammering into the ground to lock the base level, line up the 2<sup>nd</sup> level into hexagon shape – using 6 x 4' timbers. Make sure the base level is positioned properly. Once the 2<sup>nd</sup> level is lined up, temporarily remove the 2<sup>nd</sup> level pieces and hammer stakes through brackets to secure base level.

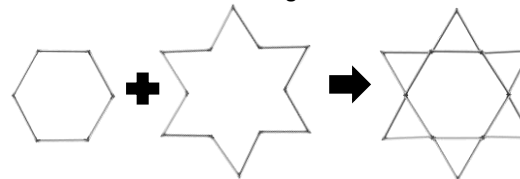

### STEP 3a:

Once base level is secured/lock, assemble 2<sup>nd</sup> level in hexagon shape. Insert stake through the hole of the bracket and into each of the corners to lock all sides in place.

Lastly, add caps to each of the top corner joints to finish off the raised garden.

### How the Joints Work

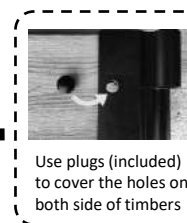
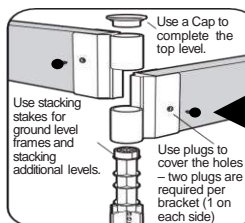

Use plugs (included) to cover the holes on both side of timbers

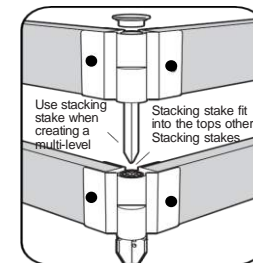

Use stacking stake when creating a multi-level  
 Stacking stake fit into the tops other Stacking stakes