

RAISED GARDEN BED

FORT KNOX

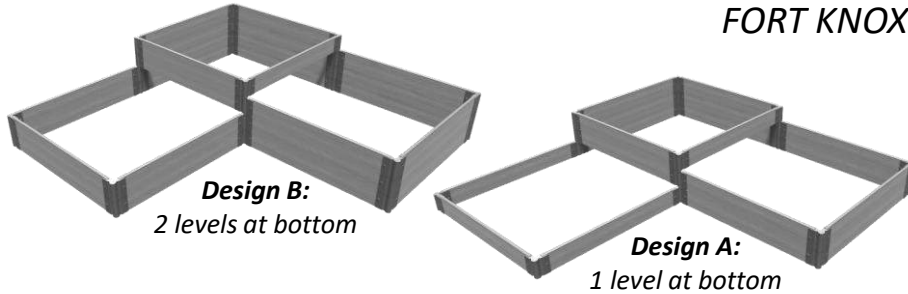

Design B:

2 levels at bottom

Design A:

1 level at bottom

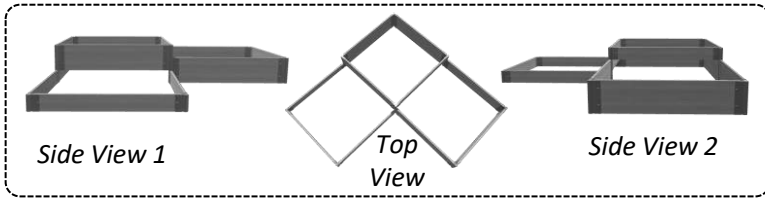

Side View 1

Top View

Side View 2

DESIGN A KIT CONTAINS:

- Composite timbers 4' x 18
- Brackets x 36
- **Stakes x 18
- Plugs x 72
- Caps x 8



Layout your timbers along the borderline and connect each timber together by inserting the top of the stake through the bracket loops with the stake pointing to the sky. This enables you to freely position your border to get your desired location.

PARTS IDENTIFICATION

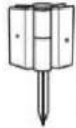

Stacking Stake

****NOTE**

Stacking stakes can be used on all levels and when creating additional levels. **ONLY** Stacking Stakes can stack!

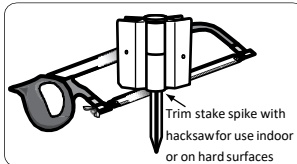

Trim stake spike with hacksaw for use indoor or on hard surfaces

FOR INDOOR & HARD SURFACE:

If you plan to assemble raised bed on a hard surface, use hacksaw to remove the spike of each stake. Use these cut down stakes for the base level only of your raised garden.

ASSEMBLY INSTRUCTIONS

STEP 1:

Assemble the timbers by sliding one end of timber into channel end of one of the brackets. Use plugs to cover the holes on both sides to lock the bracket in place.



Repeat this process on the opposite end of the timber flipping the bracket in the opposite direction (see image). **Repeat for all timbers.**



STEP 2:

Design A & B: Layout the base level of your raised garden in a "L" shape, using 8 x 4' timbers (refer to image on the right). Insert stake through the hole of the bracket and into each of the corners to lock all sides in place. **For Design B, repeat this step.**

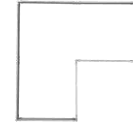

STEP 3:

For the 2nd level, layout the level in rectangular shape on top of 1st level, using 6 x 4' timbers. Insert stake through the hole of the bracket and into each of the corners to lock all sides in place.

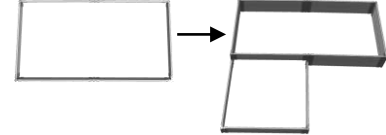

STEP 4:

For the 3rd level, layout the level in the square shape on top of 2nd level, using 4 x 4' timbers. Insert stake through the hole of the bracket and into each of the corners to lock all sides in place.

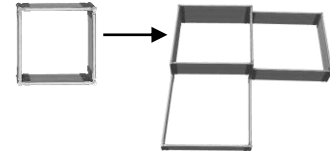

Lastly, add caps to each of the top corner joints to finish off the raised garden.

HAPPY GARDENING!

How the Joints Work

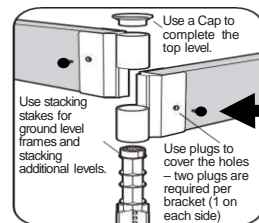

Use plugs (included) to cover the holes on both side of timbers

