

800001001/800002001/800003001/800004001  
 800001002/800002002/800003002/800004002  
 800001003/800002003/800003003/800004003  
 800001004/800002004/800003004/800004004

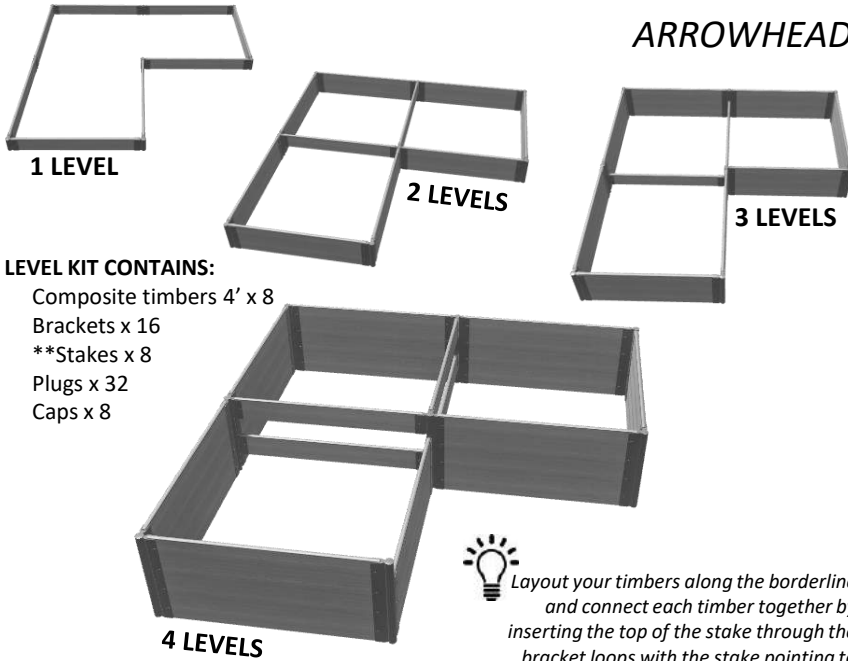

# RAISED GARDEN BED

ARROWHEAD



## PARTS IDENTIFICATION

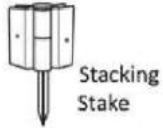

**\*\*NOTE**  
 Stacking stakes can be used on all levels and when creating additional levels. **ONLY** Stacking Stakes can stack!

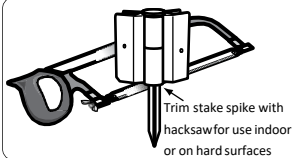

### FOR INDOOR & HARD SURFACE:

If you plan to assemble raised bed on a hard surface, use hacksaw to remove the spike of each stake. Use these cut down stakes for the base level only of your raised garden.

Customer Service: 1800-914-9835 | [support@frameitall.com](mailto:support@frameitall.com)  
 © Frame It All. All Rights Reserved.

## ASSEMBLY INSTRUCTIONS – For the First Level

### STEP 1:

Assemble the timbers by sliding one end of timber into channel end of one of the brackets. Use plugs to cover the holes on both sides to lock the bracket in place.



Repeat this process on the opposite end of the timber flipping the bracket in the opposite direction (see image). **Repeat for all timbers on the First level.**

### STEP 2:

Layout the base level of your raised garden in a "L" shape, using 8 x 4' timbers. Insert stake through the hole of the bracket and into each of the corners to lock all sides in place.

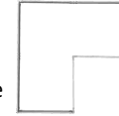

### STEP 2a:

For one level, add caps to each of the top corner joints to finish off the raised garden.

**HAPPY GARDENING!**

## ASSEMBLY INSTRUCTIONS – For Product with Two to Four Levels

### STEP 3:

For the second level, repeat Step 1 using 8 x 4' timbers. Assemble 2 timbers using 3-way connections. **ONLY USE** 3-Way timbers on 2<sup>nd</sup> level – shown on the right. Insert stake through the brackets into the hole on top of the stake beneath it to lock the second level in place.

### STEP 3b:

**Assemble 1 x 4' timber** using 4-Way brackets on each end flipping them in the opposite direction

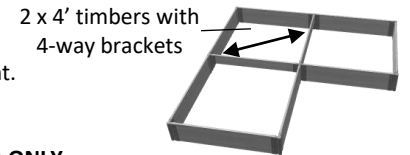

Lastly, add the caps to each of the top corner joint.

### LEVEL 3 & 4: Repeat step 3

The 3-Way timbers will be use on 2<sup>nd</sup> & 4<sup>th</sup> levels **ONLY**.

### 3 LEVELS

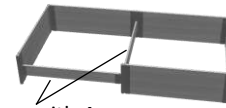

2 x 4' timbers with 4-way brackets on level 2.

### 4 LEVELS

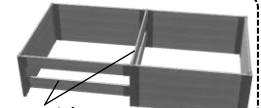

2 x 4' timbers with 4-way brackets on level 2 & 4.

## How the Joints Work

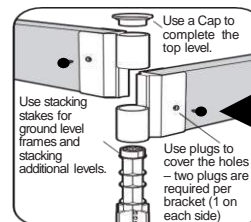

Use plugs (included) to cover the holes on both side of timbers

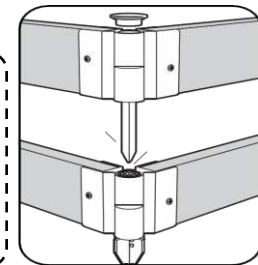

**3-Way Connection:**  
 Combining one half of a 4-way bracket and a stacking bracket (A), will result in a 3-way junction (B).

