

300001063/300001064/300001066/300001067
 300001421/300001423/300001442/300001443
 300001420/300001442/300001440/300001441
 300001090/300001091/300001097/300001098

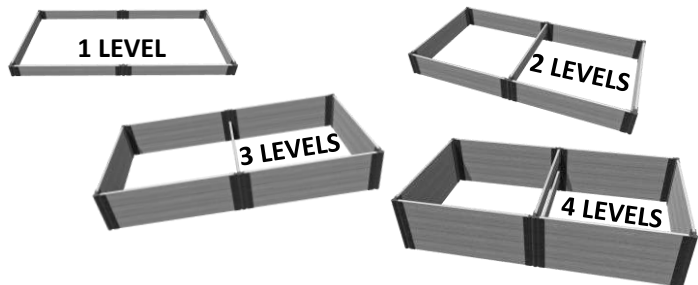

RAISED GARDEN BED

4' x 8'



1 LEVEL KIT CONTAINS:

- Composite timbers 4' x 16
- Stacking Brackets x 12
- Stacking Stakes x 6
- Plugs x 24
- Caps x 6

2 LEVEL KIT CONTAINS:

- Composite timbers 4' x 13
- Stacking Brackets x 22
- 4-way Brackets x 4
- Stacking Stakes x 12
- Plugs x 52
- Caps x 6

3 LEVEL KIT CONTAINS:

- Composite timbers 4' x 19
- Stacking Brackets x 34
- 4-way Brackets x 4
- Stacking Stakes x 18
- Plugs x 76
- Caps x 6

4 LEVEL KIT CONTAINS:

- Composite timbers 4' x 26
- Stacking Brackets x 44
- 4-way Brackets x 8
- Stacking Stakes x 24
- Plugs x 104
- Caps x 6



Layout your timbers along the borderline and connect each timber together by inserting the top of the stake through the bracket loops with the stake pointing to the sky. This enables you to freely position your border to get your desired location.

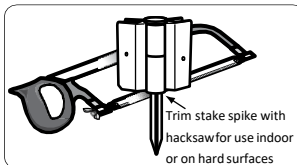

FOR INDOOR & HARD SURFACE:

If you plan to assemble raised bed on a hard surface, use hacksaw to remove the spike of each stake. Use these cut down stakes for the base level only of your raised garden.

Customer Service: 1800-914-9835 | support@frameitall.com

© Frame It All. All Rights Reserved.

ASSEMBLY INSTRUCTIONS – For the First Level

STEP 1:

Assemble the timbers by sliding one end of timber into channel end of one of the brackets. Use plugs to cover the holes on both sides to lock the bracket in place.



Repeat this process on the opposite end of the timber flipping the bracket in the opposite direction (see image). Repeat for all timbers on the first level.



STEP 2:

Layout the base level of your raised garden in a straight rectangular shape, using 6 timbers. Insert stake through the hole of the bracket and into each of the corners to lock all sides in place. If you are installing a 2nd level, insert your stakes upside down so that your base shape can be adjusted.



STEP 2a: For one level, add caps to each of the top corner joints to finish off the raised garden.

HAPPY GARDENING!

ASSEMBLY INSTRUCTIONS – For Product with Two to Four Levels

STEP 3:

For the second level, connect 2 timbers with a stacking bracket on one end and a mid-section 4-way bracket on the other end in alternating orientation.



Then, connect 1 timber with top 4-way brackets on both ends in alternating orientation as shown to the right. These 3 timbers will be used to install the cross timber.

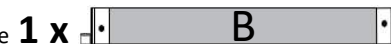

Now connect 4 timbers with stacking brackets on both ends as you did for the first level.



How the Joints Work

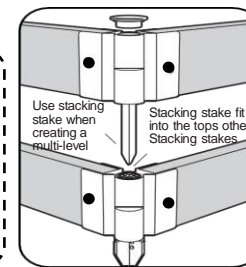
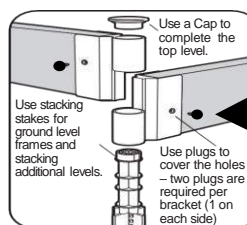

3-Way Connection: Combining two halves of a 4-way bracket and a stacking bracket (A), will result in a 3-way junction (B).



STEP 4:

Layout the timbers for the second level flat on the ground while referencing the diagram below. Place the cross timber for level 2 on top of the upside stakes to ensure it will fit. Once adjustments have been made, the stakes can be hammered into the ground and the second level can be stacked.

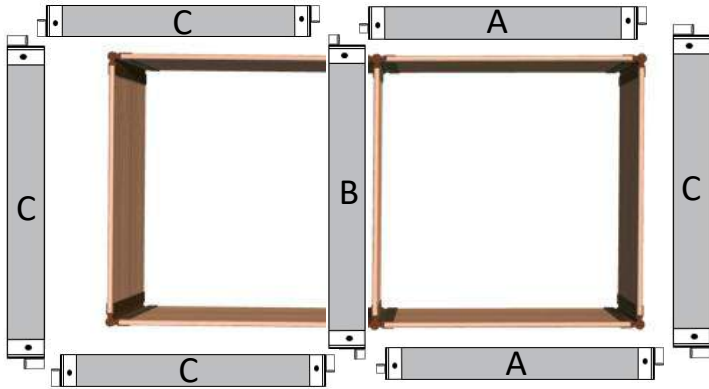

Note: Stacking stakes insert into the top of the previous level stakes.

STEP 5:

Connect 6 timbers for level 3 with stacking brackets on both ends and stack them as you did for level 1..

3 LEVELS

1 x cross timber
for a 3-level design.

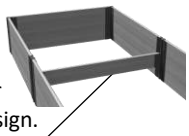

STEP 6:

Connect 7 timbers for level 4 in the same quantity and pattern as you did for level 2. Stack and connect them in the same way as well.

4 LEVELS

2 x cross
timbers on a
4-level design.

