

200001095/200002095/200003095/200004095
 200001096/200002096/200003096/200004096
 200001097/200002097/200003097/200004097
 200001098/200002098/200003098/200004098

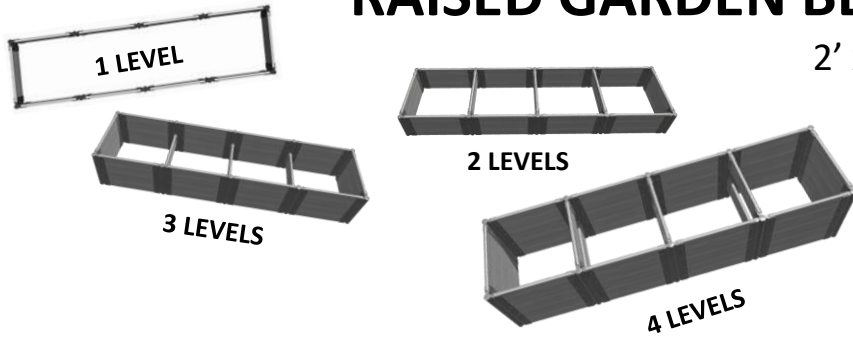

RAISED GARDEN BED

2' x 8'



1 LEVEL KIT CONTAINS:

- Composite timbers 2' x 10
- Stacking Brackets x 20
- Stacking Stakes x 10
- Plugs x 40
- Caps x 10

2 LEVEL KIT CONTAINS:

- Composite timbers 2' x 23
- Stacking Brackets x 32
- 4-way Brackets x 12
- Stacking Stakes x 20
- Plugs x 92
- Caps x 10

3 LEVEL KIT CONTAINS:

- Composite timbers 2' x 33
- Stacking Brackets x 52
- 4-way Brackets x 12
- Stacking Stakes x 30
- Plugs x 152
- Caps x 10

4 LEVEL KIT CONTAINS:

- Composite timbers 2' x 46
- Stacking Brackets x 64
- 4-way Brackets x 24
- Stacking Stakes x 40
- Plugs x 184
- Caps x 10



Layout your timbers along the borderline and connect each timber together by inserting the top of the stake through the bracket loops with the stake pointing to the sky. This enables you to freely position your border to get your desired location.

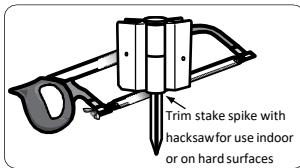

FOR INDOOR & HARD SURFACE:

If you plan to assemble raised bed on a hard surface, use hacksaw to remove the spike of each stake. Use these cut down stakes for the base level only of your raised garden.

Customer Service: 1800-914-9835 | support@frameitall.com
 © Frame It All. All Rights Reserved.

ASSEMBLY INSTRUCTIONS

STEP 1:

Assemble the timbers by sliding one end of timber into channel end of one of the brackets. Use plugs to cover the holes on both sides to lock the bracket in place.



STEP 1a:

Repeat this process on the opposite end of the timber flipping the bracket in the opposite direction (see image below). Repeat for 10 timbers.



STEP 2:

Layout the base level of your raised garden in a straight rectangular shape, using 10 x 2' timbers. Insert stake through the hole of the bracket and into each of the corners to lock all sides in place.



STEP 2a: For one level, add caps to each of the top corner joints to finish off the raised garden.

HAPPY GARDENING!

ASSEMBLY INSTRUCTIONS – For Product with Two to Four Levels

STEP 3:

For the second level, connect 4 boards with a stacking bracket on one end and a mid-section 4-way bracket on the other end in alternating orientation.



Then, connect 2 boards with top 4-way brackets on both ends in alternating orientation as shown to the right. These 3 boards will be used to install the cross Board.



Now connect 4 boards with stacking brackets on both ends as you did for the first level.



How the Joints Work

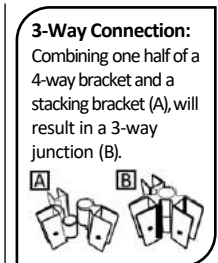
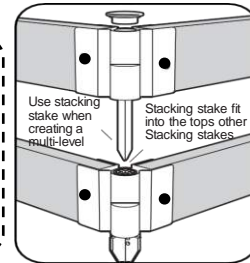
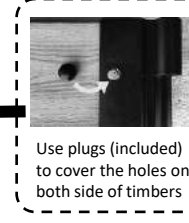
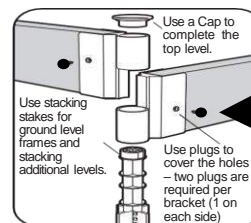

STEP 4:

Layout the boards for the second level flat on the ground while referencing the diagram below. Place the cross boards for level 2 on top of the upside stakes to ensure it will fit. Once adjustments have been made, the stakes can be hammered into the ground and the second level can be stacked.

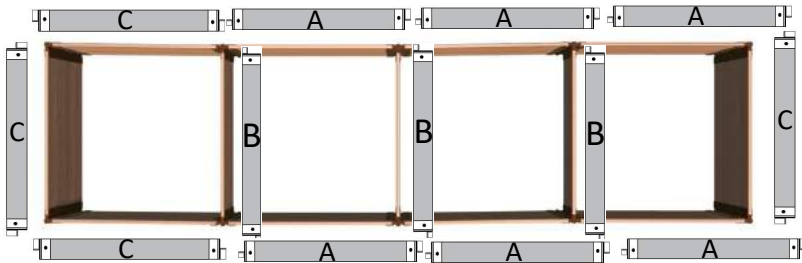

Note: Stacking stakes insert into the top of the previous level stakes.

STEP 5:

Connect 10 boards for level 3 with stacking brackets on both ends and stack them as you did for level 1.

3 LEVELS

3 x cross Board
for a 3-level
design.



STEP 6:

Connect 13 boards for level 4 in the same pattern as you did for level 2. Stack and connect them in the same way as well.

4 LEVELS

6 x cross
boards on a
4-level design

