

# HermanMiller

## Programmable Switch Assembly and Attachment Instructions

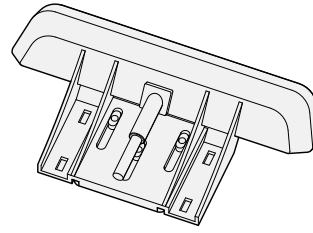

### Parts Included



Switch (1)

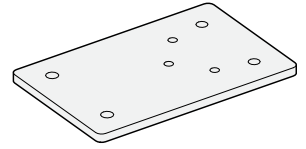

Switch Plate (1)

How to assemble your switch.



3/4" Long Self Tapping  
Screws (3)

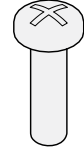

Machine Screws (2)  
M4X8

### On Square Edge Surfaces:

#### Step 1

1.1

Locate switch at desired location.



#### Step 2

2.1

Mark and drill 2 pilot holes, 0.5" deep. Attach the switch to surface with (2) 0.75" long self tapping screws.

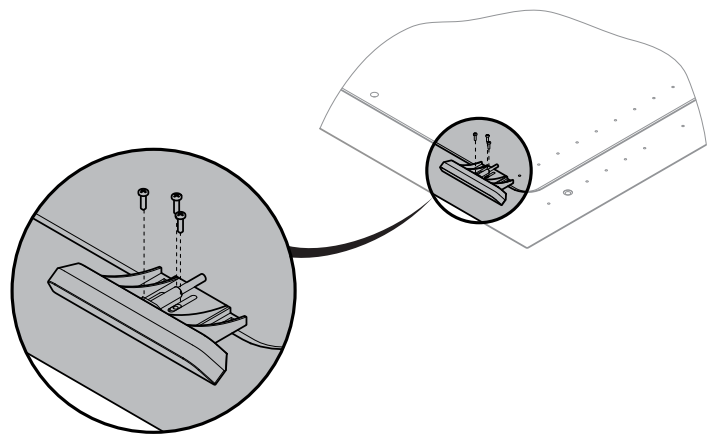

**On Thin Edge Surfaces:**

**Option 1:**

**Step 3**

3.1  
Locate switch in desired location, so that attaching screws will be located on thickest part of the surface.



**Step 4**

4.1  
Mark and drill 3 pilot holes, 0.5" deep. Attach the switch to surface with (3) 0.75" long self tapping screws.

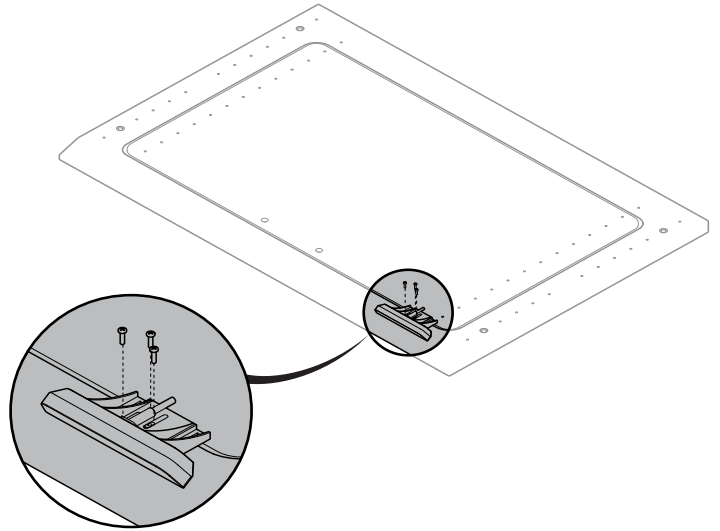

**Option 2 (Thin Edge):**

**(To Extend Switch Forward)**

**Step 5**

5.1  
Attach switch to supplied plate with (3) machine screws. Locate switch at desired location at front of surface.

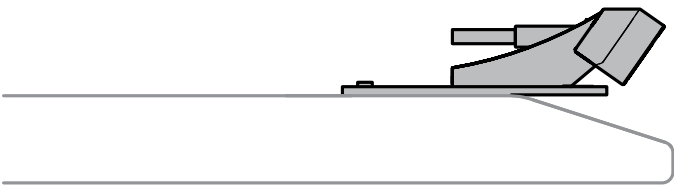

**Step 6**

6.1  
Mark and drill 2 pilot holes, 0.5" deep. Use (2) 0.75" self tapping screws to attach palte to thicker part of surface.

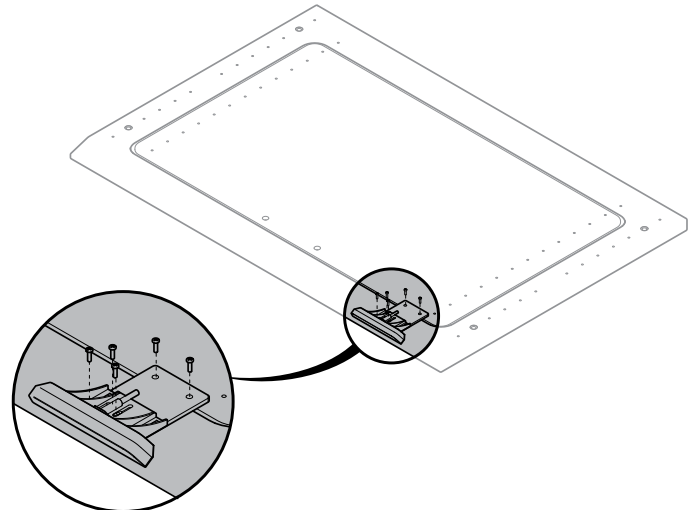

## On Eased Edge Surfaces:

### Option 1:

#### Step 7

7.1

Attach switch to supplied plate with (3) machine screws. Locate switch at desired location at front of surface.

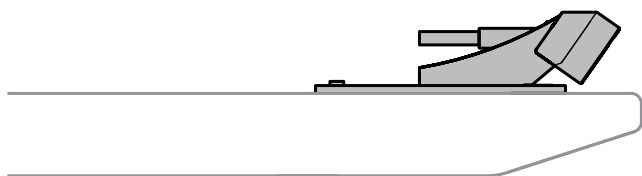

#### Step 8

8.1

Mark and drill 2 pilot holes, 0.5" deep. Use (2) 0.75" long self tapping screws to attach plate to thicker part of surface.

