

SPECIAL PROMOTIONAL SECTION

“Given the environment of our economy, it was encouraging to see so many firms take a leap of faith to produce good development projects.”



2013 KUKULU HALE AWARDS

RECOGNIZING EXCELLENCE IN HAWAII'S
COMMERCIAL REAL ESTATE INDUSTRY

NAIOP

COMMERCIAL REAL ESTATE
DEVELOPMENT ASSOCIATION
HAWAII CHAPTER

CELEBRATING THE INTEGRATION OF ART WITH SUSTAINABLE DESIGN IN A CONTEMPORARY URBAN OASIS CREATED FROM AN ABANDONED POOL.



HAWAII STATE ART MUSEUM SCULPTURE GARDEN

INVESTING IN HAWAII'S FUTURE AND PROSPERITY THROUGH OUR COMMUNITY'S MOST VALUABLE RESOURCE, OUR CHILDREN.



CENTRAL UNION CHURCH PRESCHOOL & KINDERGARTEN



GROUP 70 INTERNATIONAL

CREATING RELATIONSHIPS BY DESIGN

ARCHITECTURE | CIVIL ENGINEERING | INTERIOR DESIGN | PLANNING & ENVIRONMENT | TECHNOLOGY

925 BETHEL STREET, 5TH FLOOR, HONOLULU HI 96813 | 808.523.5866 | WWW.GROUP70INT.COM

2013 KUKULU HALE AWARD /// WINNERS

(Continued)



RENOVATION AWARD -
COMMERCIAL/OTHER 40,000 SF OR LESS

Pali Momi Medical Pavilion

ENTRANT: Architects Hawaii Ltd.
DEVELOPER/OWNER: Hawai'i Pacific Health
LEAD DESIGN FIRM: Architects Hawaii Ltd.

The challenge was to transform a former retail store into an outpatient medical clinic with a spa-like healing environment. Light was brought into the windowless space by creating an open circular staircase and a light well along with solar tubes. A sculptural waterfall symbolizes rebirth and rejuvenation.



RENOVATION AWARD -
COMMERCIAL/OTHER OVER 40,000 SF

Six Eighty Ala Moana

ENTRANT: Architects Hawaii Ltd.
DEVELOPER/OWNER: Kamehameha Schools
LEAD DESIGN FIRM: Architects Hawaii Ltd.

This former office building was converted into a mixed-use building with 54 studio and one-bedroom apartments and 9,000 square feet of commercial space on the ground floor. Targeting the young professional market, the center provides appealing amenities such as a media room, lounge room for gatherings, and small rooftop recreation deck.



RENOVATION AWARD -
COMMERCIAL/OTHER OVER 40,000 SF

The Towers at Kuhio Park

ENTRANT: Architects Hawaii Ltd.
DEVELOPER/OWNER: The Michaels Development Company
LEAD DESIGN FIRMS: Architects Hawaii Ltd. & MVEI Architects

As Hawaii's largest public housing - and first private-public partnership to transform public housing - the renovation of The Towers at Kuhio Park addressed the needs of its residents and the community. From new paint finishes to introducing new amenities and sustainable features, exterior and interior design changes enhance the quality of life for residents and visitors.

"It was encouraging to see so many firms take a leap of faith to produce good development projects."

KUKULU HALE
AWARD
WINNERS
— 2013 —

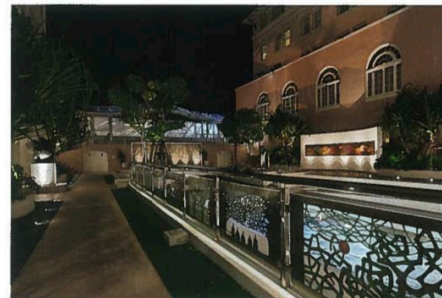

RENOVATION AWARD - PUBLIC/GOVERNMENT

Hawaii State Art Museum Sculpture Garden

ENTRANT: Group 70 International, Inc.
DEVELOPER/OWNER: State of Hawaii
LEAD DESIGN FIRM: Group 70 International, Inc.

The project vision was to create a usable, educational space in the existing unused pool area/courtyard. Art and architecture are integrated to flow seamlessly, discovering new aspects of the pieces like the morning sun casting patterns through Satoru Abe's copper railings and walking in the evening on Doug Young's Waikui water piece.



NONPROFIT PROJECT AWARD

Central Union Preschool & Kindergarten Phase I

ENTRANT: Group 70 International, Inc.
DEVELOPER/OWNER: Central Union Church
LEAD DESIGN FIRM: Group 70 International, Inc.

This is the first step of redevelopment for a school with an 80-plus-year history. The new campus has begun to emerge in forms that are playful and welcoming, but also pay homage to the historical lineage of the church. Integrated landscaping provides historical reference to 1931 foliage while enfolding the school in a garden-like environment.

NONPROFIT PROJECT AWARD

St. Damien of Moloka'i Church

ENTRANT: Nordic PCL Construction, Inc./Territorial Architects Ltd.
DEVELOPER/OWNER: St. Damien Catholic Parish
LEAD DESIGN FIRM: Territorial Architects Ltd.

The church is the first tilt-up, modern construction of its kind on Moloka'i. The project team overcame the challenges of working on an island of remote accessibility, on an extremely narrow building site in urban Kaunakakai, within a restrictive budget and timeframe to complete the new spiritual center long awaited by this close-knit community.

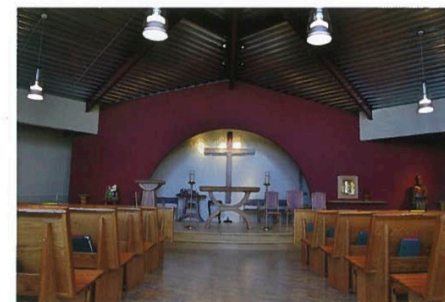



UNIVERSITY
of HAWAII
WEST OAHU

A BEACON of PROMISE

On August 20, 2012, UH West O'ahu students made history. They were the first students at the new 202-acre campus in Kapolei. Thank you to everyone who made this long awaited dream possible.

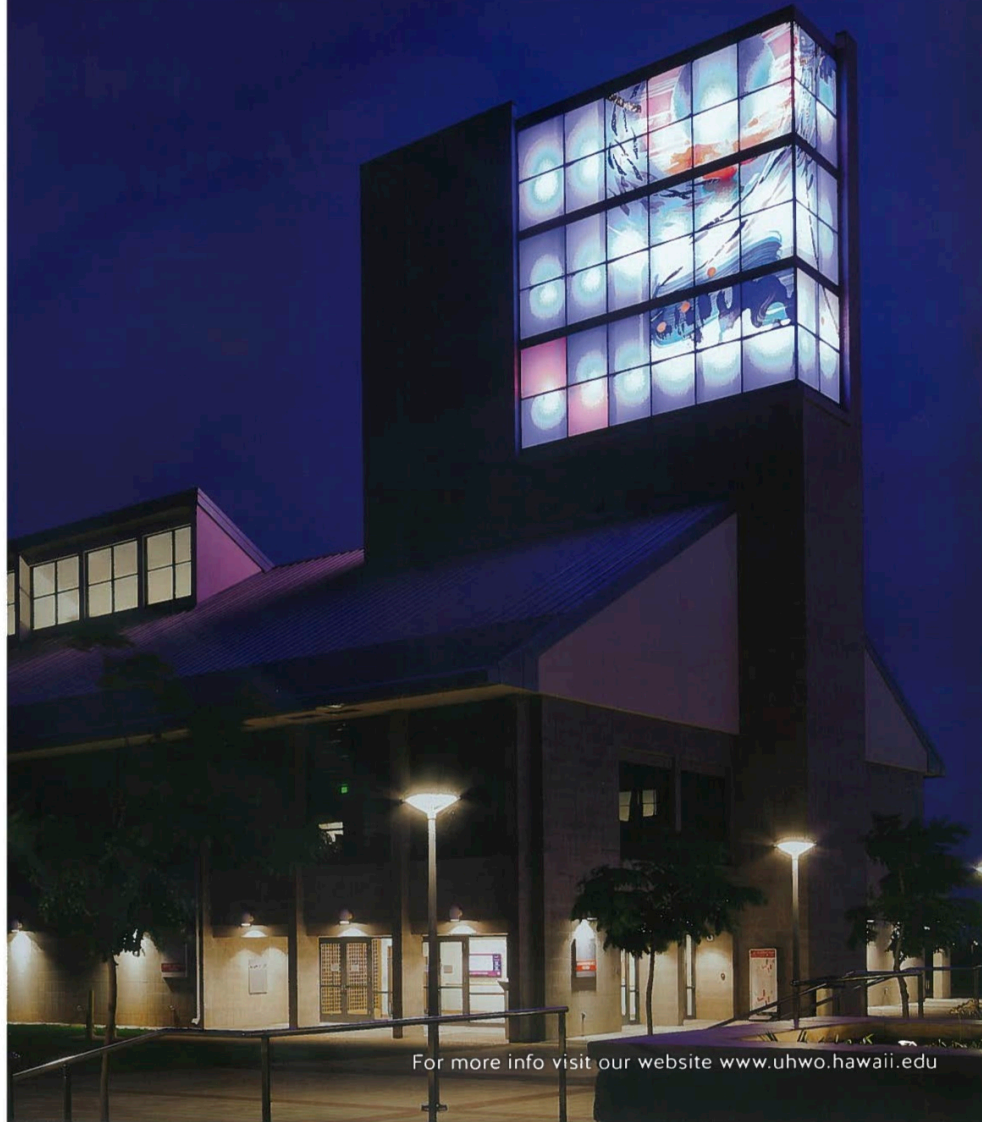

For more info visit our website www.uhwo.hawaii.edu



NEW PROJECT AWARD –
COMMERCIAL/OTHER OVER 40,000 SF

University of Hawaii West Oahu

ENTRANT: John Hara Associates Inc.
DEVELOPER/OWNER: University of Hawaii West Oahu
LEAD DESIGN FIRM: John Hara Associates Inc.

The design for the six buildings that make up the first phase of the new U.H. West Oahu campus is based on the intrinsic idea of a distinct university within a vibrant neighborhood, with a rural, agricultural past and respect for community, history and topography.



NEW PROJECT AWARD – PUBLIC/GOVERNMENT

University of Hawaii Cancer Center

ENTRANT: Shimokawa + Nakamura
DEVELOPER/OWNER: RCUH/University of Hawaii
LEAD DESIGN FIRM: Shimokawa + Nakamura

Designed unlike any other cancer center in the world, the University of Hawaii Cancer Center features open breezeways and outdoor meeting spaces to invite collaboration and interaction in its daily activities. It is one of the first five centers in the country with labs designed as neighborhoods. Glass exteriors provide natural daylight and great views.

RENOVATION AWARD –
COMMERCIAL/OTHER 40,000 SF OR LESS

Hyatt Regency Maui Lobby Transformation

ENTRANT: Armstrong Pacific LLC
DEVELOPER/OWNER: CCHH Maui LLC
LEAD DESIGN FIRM: Huston/Tyner Architects

Enhancing the arrival experience at this premier hotel was the goal of this project. High quality custom design combining natural colors and modern touches created a vibrant, luxurious and inviting entryway that accentuates the surrounding natural beauty. Especially noteworthy is that all work was conducted during occupancy, with minimal disruption to guests.

