

Exhaust Port

Inlet Ports, Use Either
Use Blanking Plug In Other

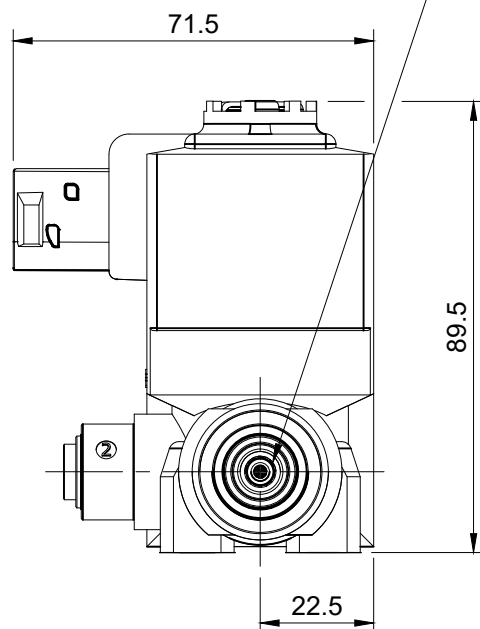

M6 Mount Holes

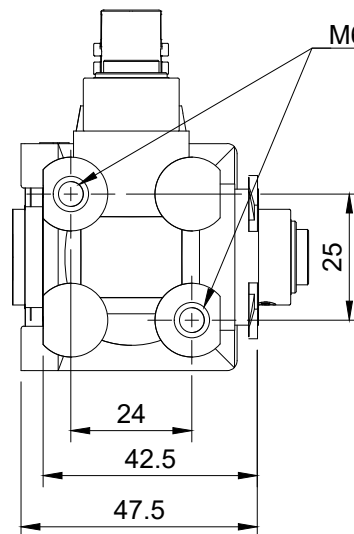

Electrical Connector

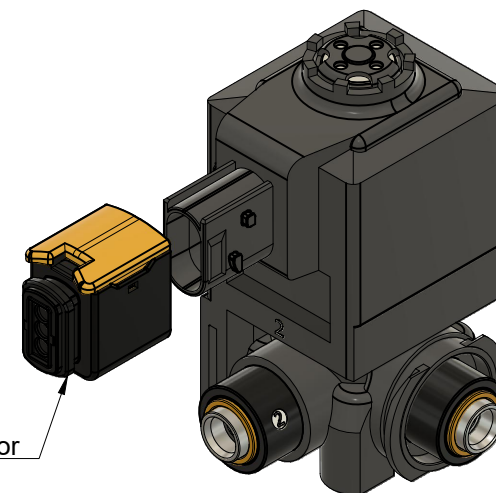

NOR-CV45-8MM
Shown can be stacked in series

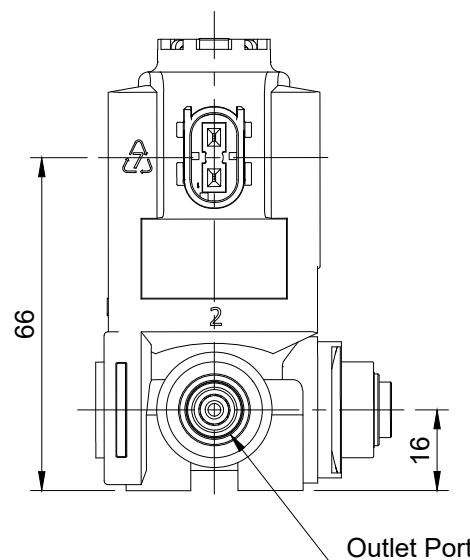

Outlet Port

Voltage:	24 VDC
Operation:	3 Way Normally Closed
Duty cycle:	100% ED
Electrical Connector:	2 Terminal Tyco HDSCS
Protection Diodes:	1 x Free Wheeling 1 x Reverse Polarity
Mounting:	2 x M6 bolts
Air Fitting Connections:	6mm Push In Fittings
Ingress Protection:	IP69
Operating Pressure:	5 to 10 Bar
Operating Temperature:	-40 + 125°C

ALL DIMENSIONS IN MM

24V NC Air Solenoid Valve For Electric/Air Systems

NOR-CV45-8MM



3/07/2023