



endurocide[®]

DISPOSABLE HOSPITAL CURTAINS



Tel: (852) 2892 0033 Fax: (852) 2892 1433
Email: admin@synemed.info

Lightweight & cost effective
alternative to traditional
hospital curtains

endurocide.com

endurocide® DISPOSABLE HOSPITAL CURTAINS

An economical alternative
to traditional, washable
cotton/polyester curtains

Benefits & advantages



**LIGHTWEIGHT &
EASY TO INSTALL**



**NO
LAUNDERING**



**COST
EFFECTIVE**

- ✓ Lightweight
- ✓ Fitted with tiebacks
- ✓ 100% recyclable

- ✓ Fire retardant*
- ✓ Self-auditing & privacy labels
- ✓ No track conversion

* Meets international standards: NFPA 701, AS 2755.2 - 1985,
BS 5867 Part 2 Types B & C 2008, AS 1530.2-1993 Part 2 and CAN/ULC-S109

Available from the
NHS SUPPLY CHAIN



Curtain colours Standard Colours

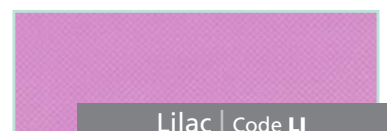
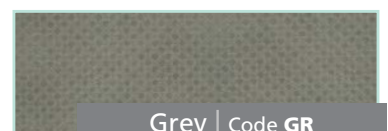
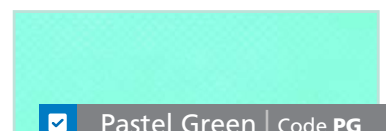
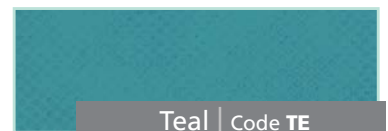

Other colours available on request
Minimum order quantities apply

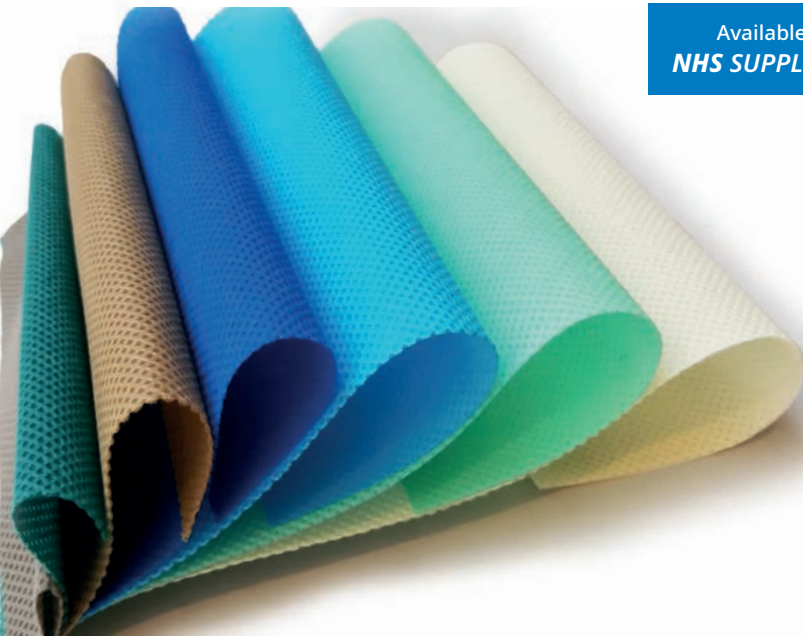

Options & specifications

Curtain Types



Standard

100% polypropylene, designed for use with suspended ceiling rails

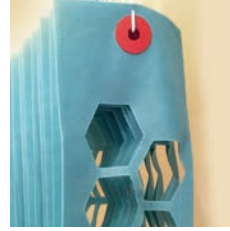

Mesh cut

100% polypropylene, with a hexagonal mesh cut on the upper section and double pleating on the front and back pleats.

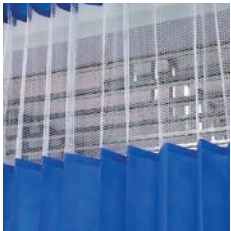

Mesh top

With NFPA 13 compliant (American mesh, designed for use with ceiling-fixed rails)



Long Drop

A longer-length 100% polypropylene curtain, for use with ceiling fixed rails

Hanging systems

Hospital track systems vary, however we have an ex-stock range of alternative glider and hooks which will fit most existing hospital curtain tracks.

Choosing the correct hook

When choosing the type of hook you order with your curtain, it's important that you order the correct size to fit your railing. There are two ways to help ensure the hook will be suitable for your railing:

Take the **measurements of your existing hooks**. The two dimensions you require are head/ glider width (**A**) and neck width (**B**).

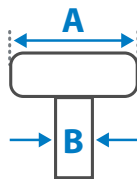

If available, use the **inner measurements of your railing**. The two dimensions you require are inner width (**X**) and channel width (**Y**).

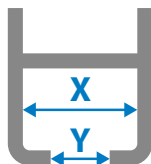

These measurements will make sure your hook fits in your railing and is neither too big (won't fit) nor too small (will fall out)!

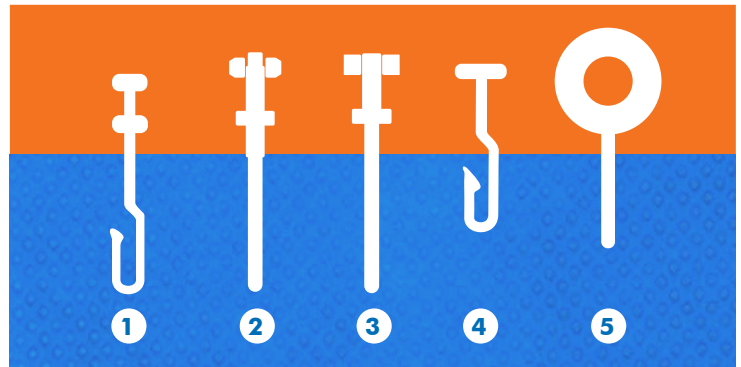
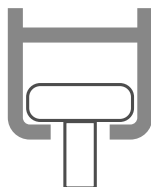

1 Quick-fit

Code **QF**

One piece hook, pre-fitted onto curtains, allows quick and easy fitting onto track.

2 Wide-wheeled

Code **WWH**

Included integral wheels for smoother movement - fit in same railings as Large-top.

3 Metal bar wide-wheeled

Code **MWW**

Similar to the wide-wheeled hook but with a metal axle pin.

4 Large-top

Code **LT**

Similar to the Quick-fit hook but with a larger head to fit wider channels.

5 Eyelet extension

Code **EEH**

Designed for easy fitting with hooks that are already in place.

Quick hook size guide

Hook type	Order code	Head Width (A)	Neck width (B)	Suitable for railing*
Quick -fit	QF	10.0mm	4.0mm	Silent Gliss 6100
Large-top	LT	14.0mm	3.0mm	Movatrack 100
Metal wide-wheel	MWW	14.0mm	4.5mm	Movatrack 100
Wide-wheeled	WWH	12.0mm	4.5mm	Movatrack 100
Eyelet extension	EEH	N/A	N/A	N/A

* The railings given are examples of commonly available systems - it is not meant to suggest that this is the only system that these hooks are suitable for use with.

Curtain dimensions

Curtain Width	Full	Medium	Half
STANDARD CURTAIN			
Height	2.0m	2.0m	2.0m
Width	7.5m	5.55m	3.75m
Pleat width	0.15m	0.15m	0.15m
Eyelets	50	37	25
Hooks (if ordered)	27	20	14
Curtains per box	6	8	12
MESHTOP CURTAIN			
Height (inc 0.55m mesh)	2.55m	2.55m	2.55m
Width	7.5m	5.55m	3.75m
Pleat width	0.15m	0.15m	0.15m
Eyelets	50	37	25
Hooks (if ordered)	27	20	14
Curtains per box	5	7	10

Order codes

Section	Option	Order code
1 CURTAIN TYPE	Standard	SC
	Mesh top	MTC
	Mesh cut	MC
	Long drop	LD
2 WIDTH	Full width	FW
	Medium width	MW
	Half Width	HW
3 HANGING SYSTEM	Eyelets only (ie no hooks)	E
	Quick-fit hooks	QF
	Metal bar wide-wheeled	MWW
	Wide-wheeled hooks	WWH
	Large-top hooks	LT
	Eyelet extension hooks	EEH
4 COLOUR	Medical blue	MB
	Pastel blue	PB
	Pastel green	PG
	Pastel yellow	PY
	Lilac	LI
	Grey	GY
	Teal	TE
	Latte	LA



If you're not sure, please get in touch and we can provide advice as well as sample packs of all the hooks available.

Bio Technics Ltd. Linton Business Park, Gourdon, Aberdeenshire, Scotland, UK DD10 0NH | Tel: +44 (0) 1561 361515 | info@endurocide.com | endurocide.com



Endurocide® is the healthcare division of Bio Technics Ltd, based in the UK. Endurocide® is a Registered Trademark of Bio Technics Ltd.

Disclaimer: Every effort has been made to ensure that the information presented is correct at the time of publication. However, Bio Technics Ltd does not assume and hereby disclaims any liability to any part for any loss, damage, or disruption caused by errors or omissions resulting from negligence, accident, or any other cause. Bio Technics Ltd makes no reference to any specific brand of competitor products. The data supplied is for guidance purposes only and is therefore without guarantee. Any opinions expressed in this publication are not necessarily those of Bio Technics Ltd and are not for onward publication without consent.