

# How Airtraq simplifies Video Intubation

- Airtraq's channel simplifies ETT insertion reducing intubation time.
- No stylet needed. Avoids potential injuries. Eliminates stylet costs.
- 90° shape minimizes hyperextension and reduces force required.
- Reduces hemodynamic reactivity.
- Facilitates intubation from any position (face to face, etc.).
- High intubation success rate in difficult airways.
- Easier to learn than other video laryngoscopes.

Multiple viewing options

90° channel simplifies intubation

Minimum capital investment allows availability in every location

## Visualization Options

for any Airtraq model



Airtraq LLC  
2414 Lawton Ln.  
Rowlet, TX 75089, USA  
Phone: 1-877-624-7929  
E-mail: info.usa@airtraq.com

**Airtraq**  
GUIDED VIDEO INTUBATION  
www.airtraq.com

Prodol Meditec S.A  
Muelle T. Olavarrí, 5  
48930 Las Arenas, Spain  
Phone: +34 944 804 690  
E-mail: info@airtraq.com

**Airtraq**  
GUIDED VIDEO INTUBATION



Simple, effective,  
affordable video  
laryngoscopy

# Two complementary models for one complete solution



## AIRTRAQ AVANT

**Reusable Optics + Disposable Blades**

Minimum cost per intubation.  
VL for frequent use.

## AIRTRAQ SP

**Fully Disposable**

One piece. Ready to use.  
VL for remote locations and emergencies.

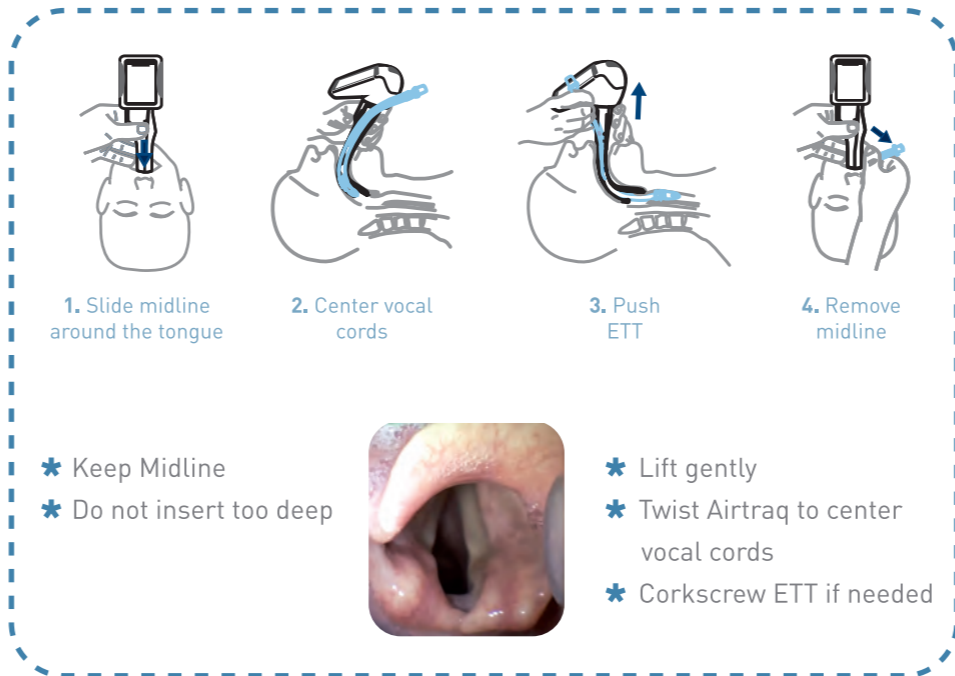

## Airtraq improves routine intubations and it is specially effective for:

- Cervical immobilization
- Obese
- Awake
- In combination with a fiberscope
- Frontal or lateral intubations
- Poor dentition

## Airtraq sp

Adults  
Pediatrics  
Double Lumen  
Nasal (no channel)



Adult regular  
7.0-8.5 ETT  
M.O.\*: 16 mm

Adult small  
6.0-7.5 ETT  
M.O.\*: 15 mm

Double lumen  
28-41 Fr  
M.O.\*: 18 mm

Nasal  
M.O.\*: 15 mm



Pediatric  
4.0-5.5 ETT  
M.O.\*: 12 mm

Infant  
2.5-3.5 ETT  
M.O.\*: 11 mm

**NEW**

**Wi-Fi Camera**

**Airtraq CAM**

iOS / Android  
Mac / Windows



**Phone adapter**



iOS / Android



Adult regular  
7.0-8.5 ETT  
M.O.\*: 17 mm

Adult small  
6.0-7.5 ETT  
M.O.\*: 17 mm



Reusable Optics

Disposable blades

Docking

**Airtraq Avant**

\* Mouth opening