

A quality pen needle for every patient

Designed for a comfortable  
injection experience



**Unifine<sup>®</sup> Pentips<sup>®</sup>**

# How does Unifine® Pentips® needle design deliver a comfortable injection experience?

## Comfort for your patients

Unifine® Pentips® has been designed to provide these benefits:



Prevent needle blockage



Clean and precise skin penetration



Effortless flow of medication



Minimal needle friction



## A product you can trust

Unifine® Pentips® comes with an approachable range of information leaflets, to support you in delivering face-to-face and group patient education about pen needles and injection technique

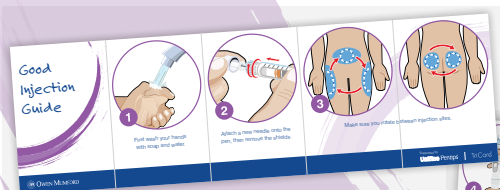

**Good Injection Guide**



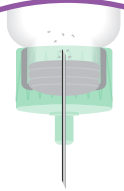

### Anti-coring

Prevents rubber particles from being injected into the cartridge when screwing the needle onto the pen – **just like a drain pipe that doesn't get blocked with leaves**



### Multi-bevel needle

Has very sharp, angled edges that allow the needle to pierce the skin quickly and efficiently – **just as a sharp knife cuts a tomato without the need to apply pressure**



Normal-walled



Thin-walled

### Thin wall technology

Allows effortless flow of medication to be delivered easily and more freely for the same diameter needle – **just as a large shower head enables a volume of water to pass freely**



### Silicone

Smooths the path of the needle as it goes into the skin – **just as using soap during hand washing helps the process by minimising friction**



Comfort for  
your patients

A product you  
can trust



**4mm**

0.23mm (32G) x 4mm  
Box of 100: AN3540  
PIP code: 379-6133  
GMS code: 85361



**5mm**

0.25mm (31G) x 5mm  
Box of 100: AN3550  
PIP code: 368-0881  
GMS code: 85363



**6mm**

0.25mm (31G) x 6mm  
Box of 100: AN3590  
PIP code: 281-5793  
GMS code: 85337



**8mm**

0.25mm (31G) x 8mm  
Box of 100: AN3530  
PIP code: 234-8415  
GMS code: 85393



**12mm**

0.33mm (29G) x 12mm  
Box of 100: AN3529  
PIP code: 234-8423  
GMS code: 85381

Compatible with all major brand injection pens\*,  
for optimum convenience and versatility

\*For latest compatibility information please visit [owenmumford.com/compatibility](http://owenmumford.com/compatibility).

© Copyright Owen Mumford 2017  
UPHCP-UK-A5-LT/MCC/12/17/01