

# ocean.



## BERRY ALLOC



100% water resistant



natural wood design



0 bevels



duoloc



compatible with underfloor heating



lifetime warranty

water resistant laminate.

EN14041  
**CE**  
 DOP: 170-DPLA18-1  
 NB:1161  
 18  
 BerryAlloc nv  
 Industrielaan 100, B-8930 Meneen  
 Belgium  
 Laminate floor covering  
 EN13329

 23

 DS

EUROPEAN LAMINATE  
**EPLF**  
 MADE WITH WOOD



 32

 Cfl-s1

PEFC Certified  
 Laminate comes from  
 Sustainably Managed  
 Forests, recycled or  
 controlled sources.  
**PEFC**  
 PEFC07-31-229 www.pefc.org

ÉMISSIONS DANS L'AIR INTÉRIEUR  
**A+**  
 A+ A B C

 **E1**  
 HCHO

**9** 

2,20 m<sup>2</sup>

1288 L x 190 W x 8 TH (mm)

\*Information sur le niveau d'émission de substances volatiles dans l'air intérieur, présentant un risque de toxicité par inhalation, sur une échelle de classe allant de A+ (très faibles émissions) à C (fortes émissions).

# BERRY ALLOC

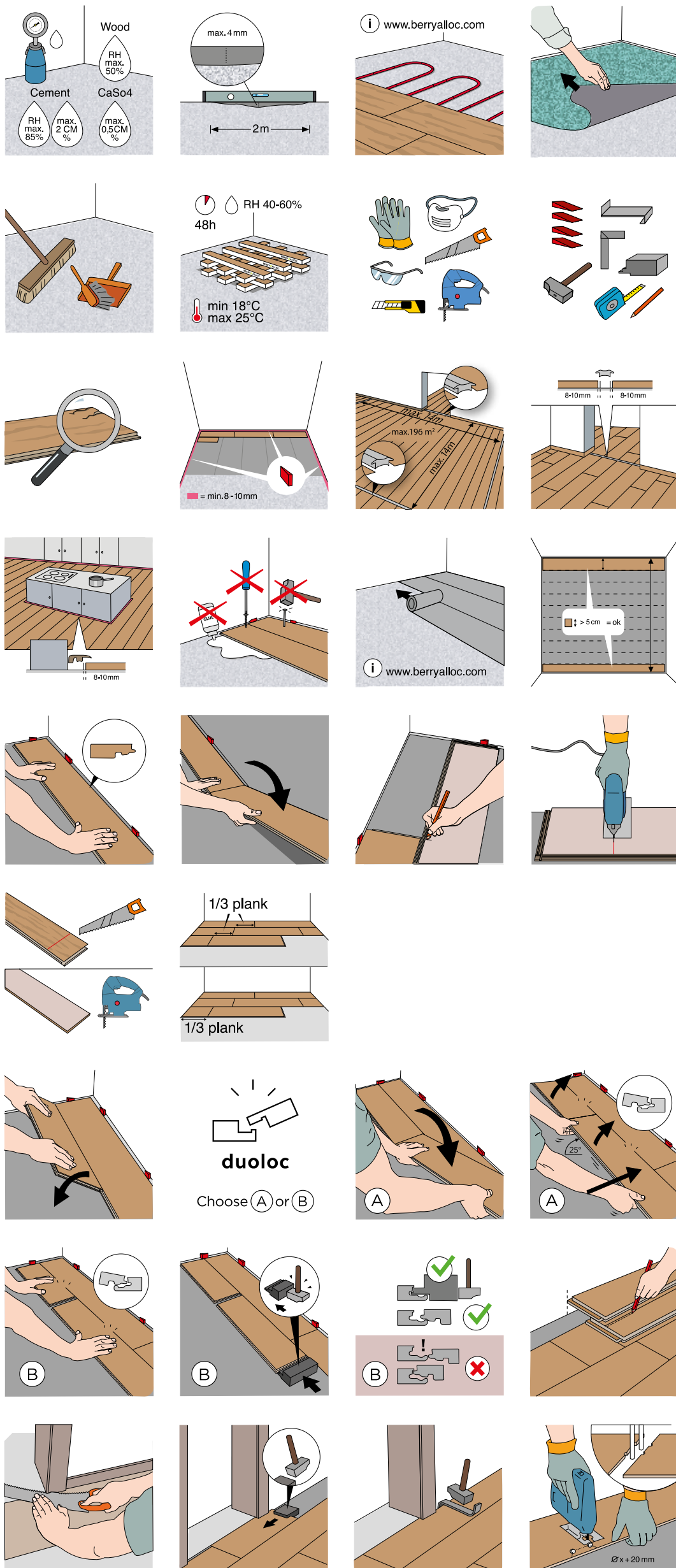

## hydro+ accessories

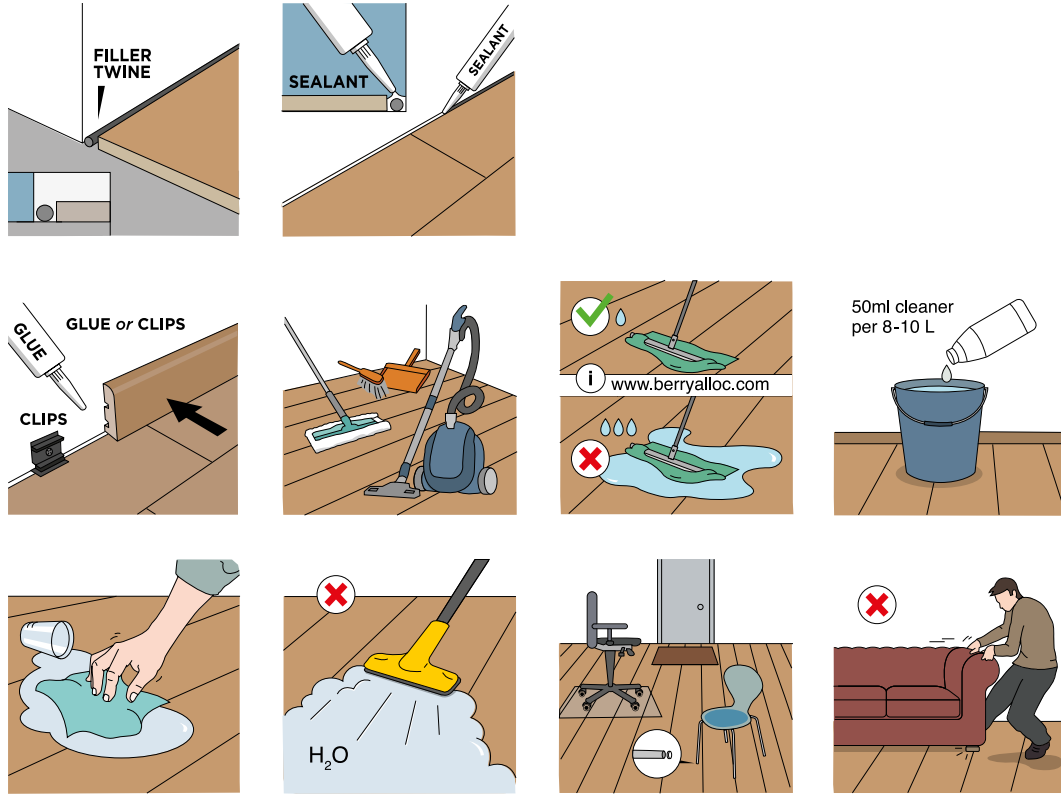

made in  Belgium

Looking for more info? Visit our website [www.berryalloc.com](http://www.berryalloc.com)

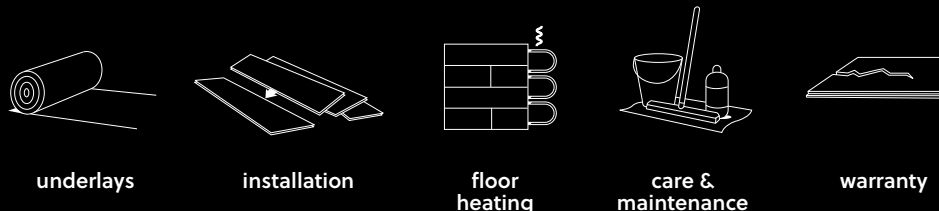

water resistant laminate.