

POCKET DOOR PRO HENDERSON

FOR BI-PARTING DOORS

120kg Wood Interior Soft Stop Self Close Simultaneous Action

Professional sliding door solution that works with cavity walls for doors weighing up to 120kg

Overview

Pocket Door Pro is a professional hardware solution that allows doors to effortlessly slide into a cavity wall. Designed with a high quality, aluminium cavity frame, the system is extremely robust - making it ideal for homes, educational buildings, hospitals, hotels and office blocks. The system is also ideal for disability access areas as well as rooms where space is limited such as bathrooms and ensuites.

The aluminium cavity frame comes with push together parts for easy and rapid installation. The system is available with an optional soft stop which catches the door in its final moments of travel and gently pulls it into position - preventing slamming.

The system is available in seven different kit sizes (which can be cut to size) and for finished wall thicknesses of 120mm and 125mm.

Available accessories include a timber liner kit, self close system, simultaneous action kit and wide range of flush pulls and locks. The system is also available in single, fire rated and automated variants.



Features and Benefits

- Robust, high quality aluminium cavity frame
- Push together parts for easy and rapid installation
- Optional soft stop
- Seven different kit sizes (covering doors up to 2315mm x 930mm)
- 120mm or 125mm finished wall thickness
- Available accessories include a timber liner kit, self close system, simultaneous action kit and wide range of flush pulls and locks

STEP 1: CHOOSE YOUR KIT (please specify two kits for bi-parting doors)

Short Code		Max. Door Width	Max. Door Height	Door Thickness	Max. Door Weight		Finished Wall Thickness
Standard	With Soft Stop				Standard	With Soft Close	
PDKPRO1/***(x2)	N/A	610mm	1981mm	35 - 45mm	120kg	80kg	120mm or 125mm
PDKPRO2/***(x2)	PROSOFT2/***(x2)	686mm	1981mm	35 - 45mm	120kg	80kg	120mm or 125mm
PDKPRO3/***(x2)	PROSOFT3/***(x2)	762mm	1981mm	35 - 45mm	120kg	80kg	120mm or 125mm
PDKPRO4/***(x2)	PROSOFT4/***(x2)	838mm	1981mm	35 - 45mm	120kg	80kg	120mm or 125mm
PDKPRO6/***(x2)	PROSOFT6/***(x2)	826mm	2040mm	35 - 45mm	120kg	80kg	120mm or 125mm
PDKPRO7/***(x2)	PROSOFT7/***(x2)	726mm	2040mm	35 - 45mm	120kg	80kg	120mm or 125mm
PDKPRO10/***(x2)	PROSOFT10/***(x2)	930mm	2315mm	35 - 45mm	120kg	80kg	120mm or 125mm

*** For full short code please replace with required finished wall thickness size - 120 or 125 (mm)

STEP 2: CHOOSE YOUR LINER KIT

Short Code	Max. Door Thickness	Finished Wall Thickness
BILK/****	45mm	120mm or 125mm

*** For full short code please replace with required finished wall thickness size - 120 or 125 (mm)

STEP 3: CHOOSE YOUR OPTIONAL EXTRAS

Short Code	Description
BISELF	Self closing kit (to be used with PROSOFT) If using without a SIM kit max. door weight is 80kg If using with a SIM kit max. door weight is 50kg
SIM100	Simultaneous Action Kit
HH4/AN	Track Stop (two required if installing non soft closing bi-parting doors)

STEP 4: CHOOSE YOUR ACCESSORIES

Flush Pulls Sets



Round Flush Pull Set (**385/S**) satin, also available in chrome, polished brass and black



Round Flush Pull Set with Door Edge Pull (**385EDGE/S**) satin, also available in chrome and black



Square Flush Pull Set (**53/S**) satin, also available in chrome and black

Lock Sets



Round Lockable Flush Pull Set (**390/S**) satin, also available in chrome



Round Lockable Flush Pull Set with Indicator (**571/S**) satin, also available in chrome



Square Lockable Flush Pull Set (**60SQ/S**) satin, also available in chrome

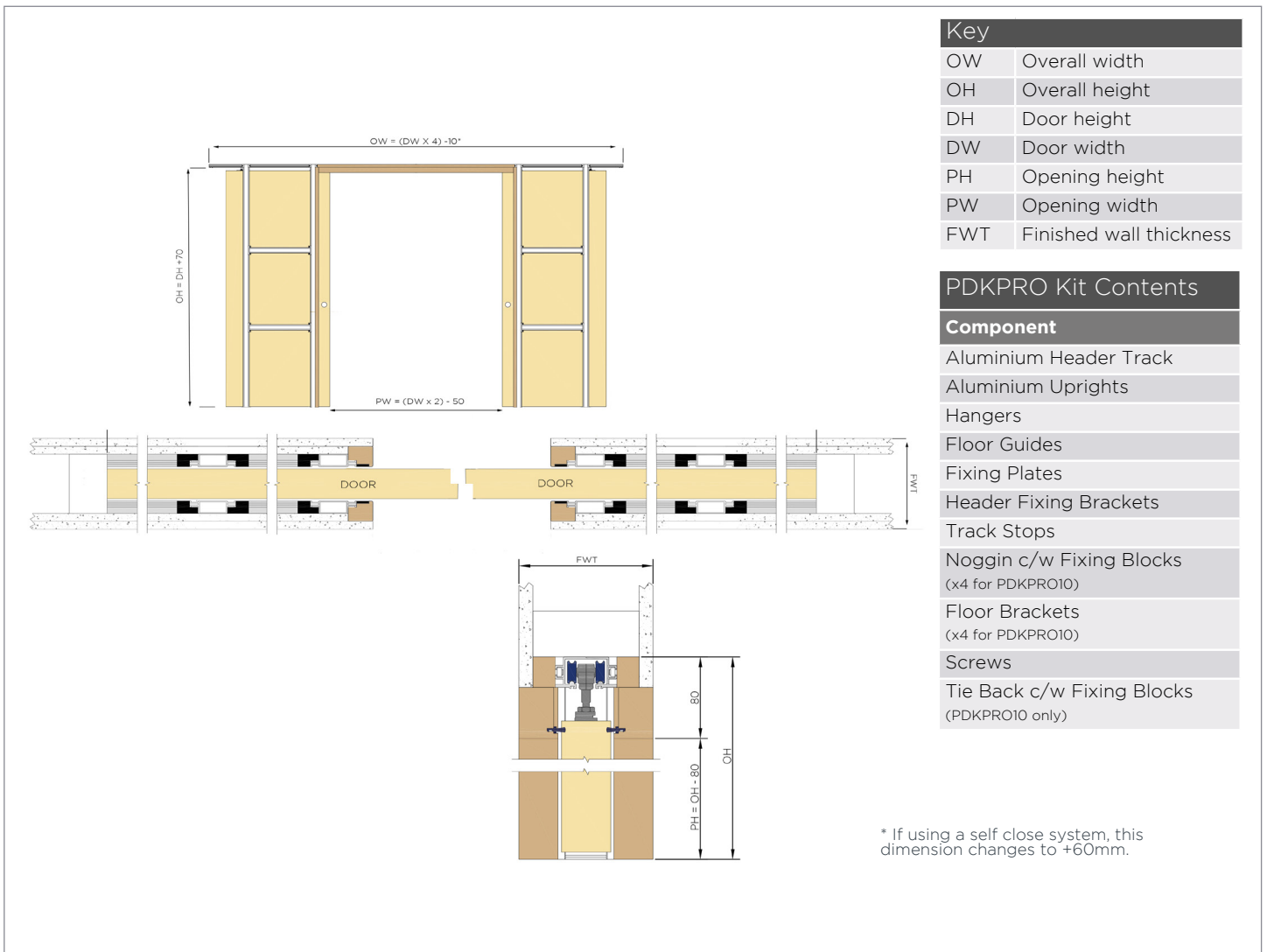

Finished Wall Thickness Calculation

120mm Finished Wall Thickness

95mm cavity + 12.5mm plasterboard either side = 120mm finished wall thickness

125mm Finished Wall Thickness

100mm cavity + 12.5mm plasterboard either side = 125mm finished wall thickness

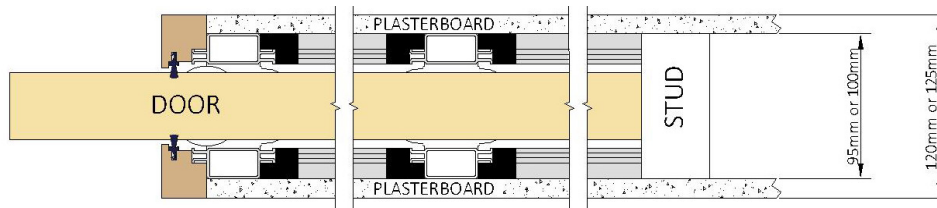

Opening Size Guide

Kit (x2 for bi-parting doors)	Max. Passage Size (W x H)	Overall Dimensions (W x H)	Cavity Thickness	Finished Wall Thickness
PDKPRO1/***(x2)	1170mm x 1971mm	2480mm x 2051mm	95mm or 100mm	120mm or 125mm
PDKPRO2/***(x2)	1322mm x 1971mm	2784mm x 2051mm	95mm or 100mm	120mm or 125mm
PDKPRO3/***(x2)	1474mm x 1971mm	3088mm x 2051mm	95mm or 100mm	120mm or 125mm
PDKPRO4/***(x2)	1626mm x 1971mm	3392mm x 2051mm	95mm or 100mm	120mm or 125mm
PDKPRO6/***(x2)	1602mm x 2030mm	3344mm x 2110mm	95mm or 100mm	120mm or 125mm
PDKPRO7/***(x2)	1402mm x 2030mm	2944mm x 2110mm	95mm or 100mm	120mm or 125mm
PDKPRO10/***(x2)	1810mm x 2305mm	3760mm x 2385mm	95mm or 100mm	120mm or 125mm

*** For full short code please replace with required finished wall thickness size - 120 or 125 (mm)

For further information, please contact us on:

UK Sales

T: +44 (0) 191 377 7345

E: sales@pchenderson.com

W: www.pchenderson.com

Export Sales

T: +44 (0) 191 377 7346

E: international@pchenderson.com

W: export.pchenderson.com