

FITTING INSTRUCTIONS - NOTICE DE POSE - MONTAGE HANDLEIDING - MONTAGEANLEITUNG
 INSTRUZIONI DI MONTAGGIO - INSTUCCIONES DE MONTAJE

	Max Door Weight	Max Door Height	Max Door Width	Min Door Thickness
Soltaire Endfold 45	45 kg	3000 mm	900 mm	35 mm
Soltaire Endfold 75	75 kg	3300 mm	900 mm	35 mm

		Hinges		Guides	Hangers		Pivot	Flushbolt
		Handle set	Midset	21SS/94	45 kg 21/180/SS	75 kg 21/250/SS	SEFP	FB110S
Kit	SEF145 SEF175		0					
	SEF245 SEF275						0	

SEF145 & SEF175 Kit Contents

Hanger & Guide Bag Pivot Bag Handle Hinge Bag FB110S Flushbolt

Track & Channel

180 & 250 Track

94P Channel

SEF245 & SEF275 Kit Contents

Hanger & Guide Bag Midset Hinge Bag Handle Hinge Bag FB110S Flushbolt

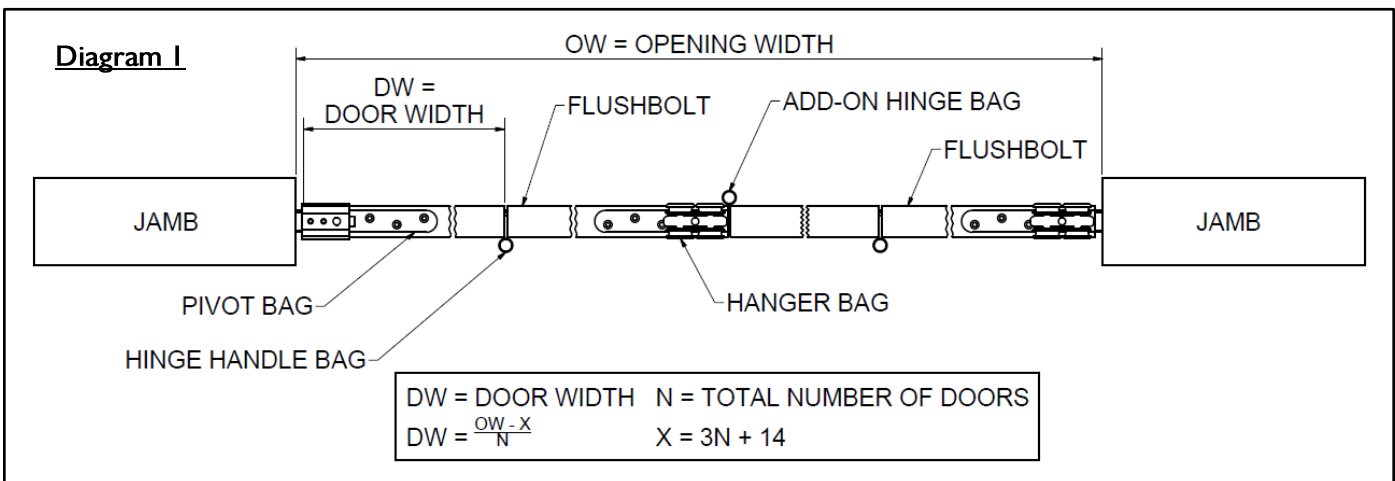

Preparing the Doors

To calculate the width of your doors use the tables below. All doors are the same width.

Diagram 1 shows the values used.

The table below shows some standard systems.

Number of Doors	DW
2	$\frac{OW - 20}{2}$
4	$\frac{OW - 26}{4}$
6	$\frac{OW - 32}{6}$
8	$\frac{OW - 38}{8}$

For non-standard configurations use the equation in **Diagram 1**.

Door Leaf Height Calculation

45 kg system:

Door height = Opening Height minus 62 mm.

75 kg system:

Door height = Opening Height minus 69 mm.

See **Diagram 2** for Opening Height.

Preparing Leaf for Fixings

Mortice slots for the hanger and guides at 5 mm depth on the top, bottom and side of the door as in **Diagram 3**. The hanger also requires a 27 mm diameter hole bored 36 mm deep.

Prepare door for Flushbolts as per included instructions. **Diagram 1** shows recommended Flushbolt positions.

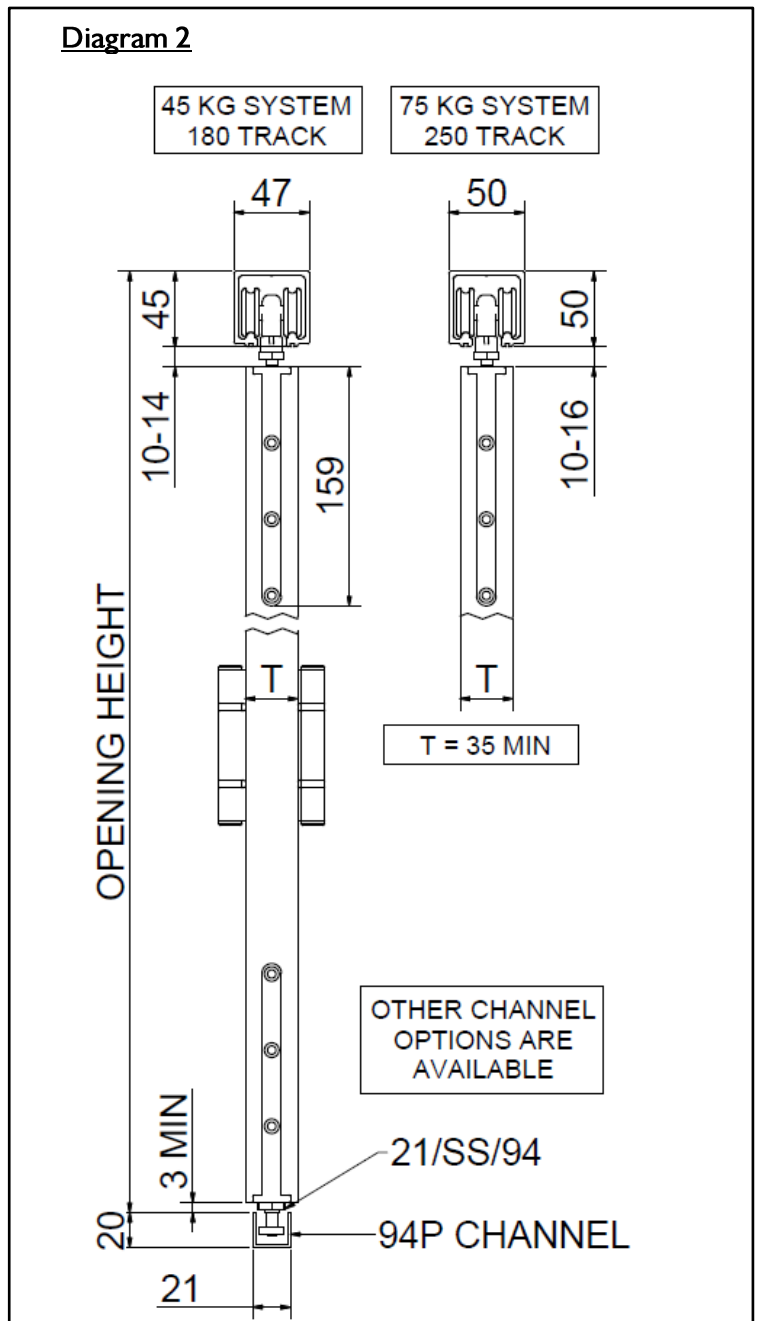
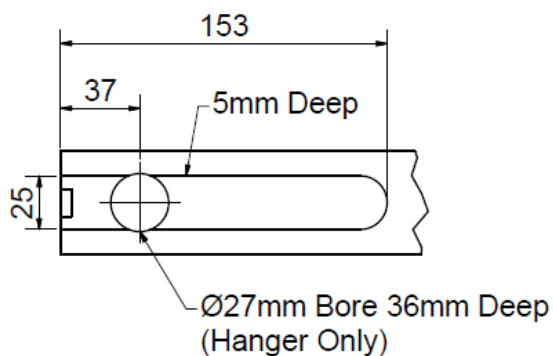
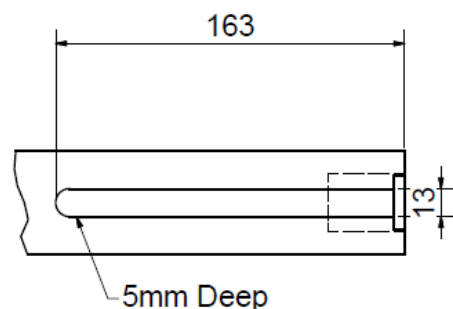

Diagram 3

Top and Bottom of Door



Side of Door



Example Systems

Diagram 4

PLAN 1
2 LEAVES STARTING
WITH PIVOT

PLAN 2
4 LEAVES STARTING
WITH PIVOT

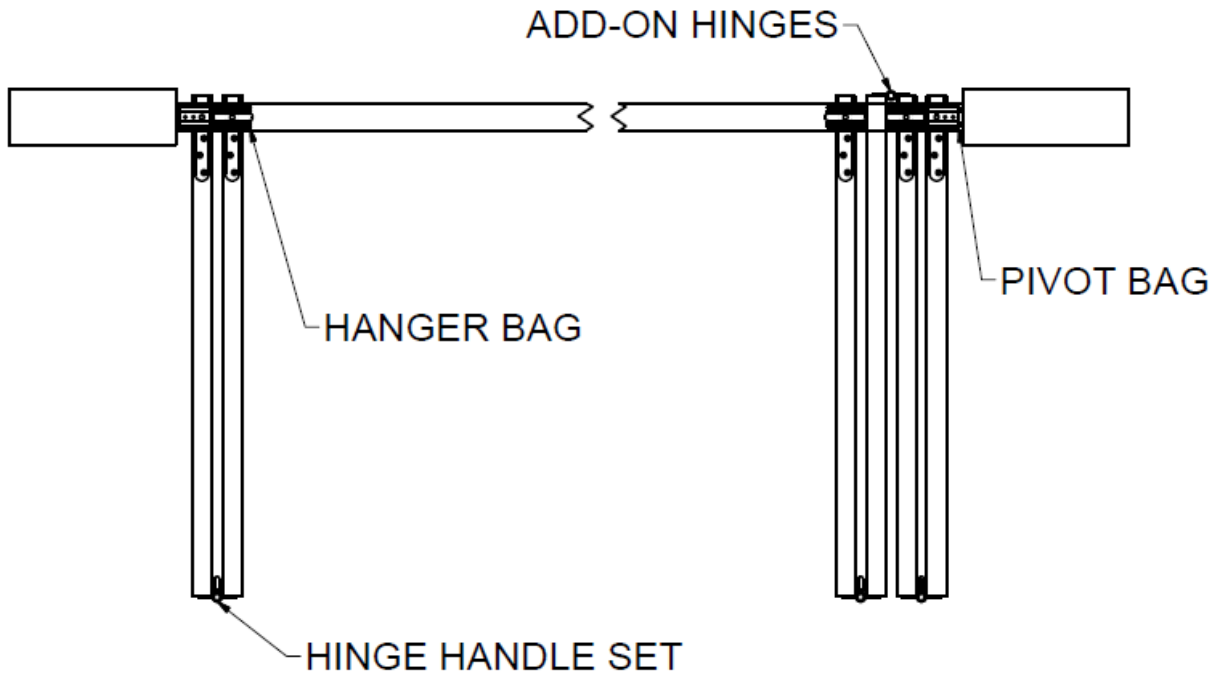
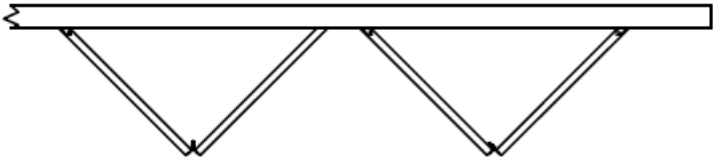
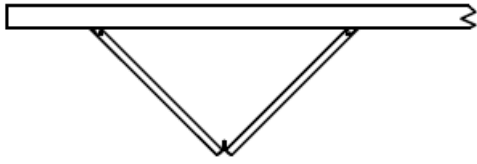

ALL LEAVES ARE OF EQUAL WIDTH

Track Hole Placement

Diagram 5

PIVOT BLOCK
ORIENTATION

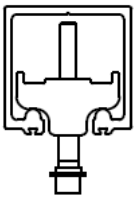

FOLD LEAF END

HOLE CENTRES

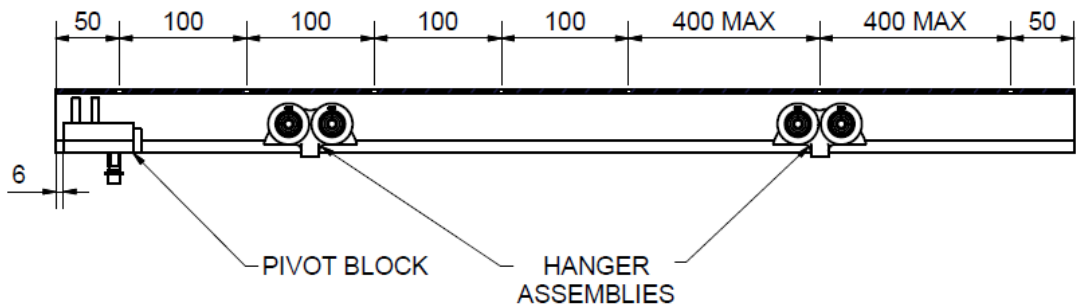

Installation guide

1. Check that you have all of the parts for your system, laying them out in the configuration they will be installed in. See the table on page 1 for the correct number of components and **Diagram 4** for example layouts.
2. Cut your length of track to the required length. Pre-drill the holes for fixing the track in place. Make sure to include extra fixing holes on the side of the track where the doors will stack as in **Diagram 5**.
3. Disassemble the wheel hangers and pivot block by removing the bolt from the body.
4. Slide the pivot block and wheel assemblies into the track in the correct order and orientation as in **Diagram 5**. Install the track with the pivot block and wheel assemblies inside. Ensure the pivot block is 6mm from the end of the track.
5. Assemble the leaves in pairs via the handle hinges as in **Diagram 6**. For ease of installation pre-drill the pilot holes for the additional hinges.
6. Suspend the first pair of doors by attaching the first leaf to the pivot block and engaging the hanger bolts. Ensure the bottom pivot is engaged.
7. Suspend the next pair of leaves by lifting and supporting the doors, then screwing the hanger bolt into the wheel assembly. Fix the second and third leaves together with the midset hinges.
8. Continue until all the doors are fitted.

Adjustment Guide

1. Close leaves and adjust the door height to achieve an equal gap between the top of all of the leaves and the track.
At the top of the door a gap of 10-14mm is required for 45kg systems and 10 -16mm for 75kg. At the bottom of the door there should be a gap of at least 3mm.
2. Once the adjustment is complete tighten the nut on the hangers and pivot block to the top as in **Diagram 7**.

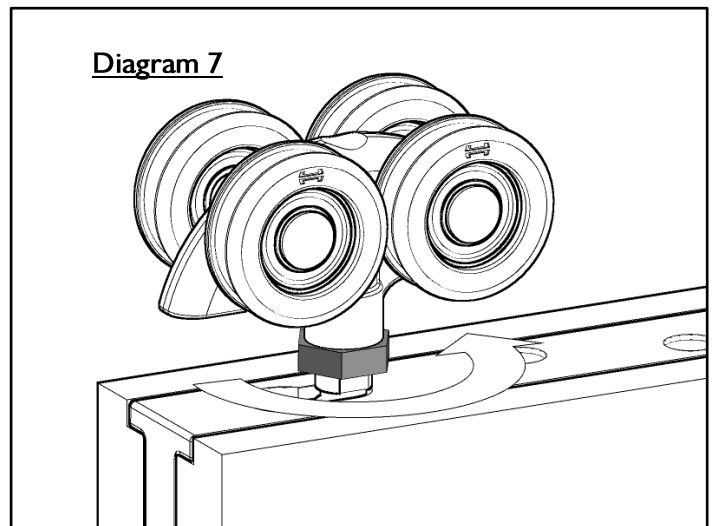
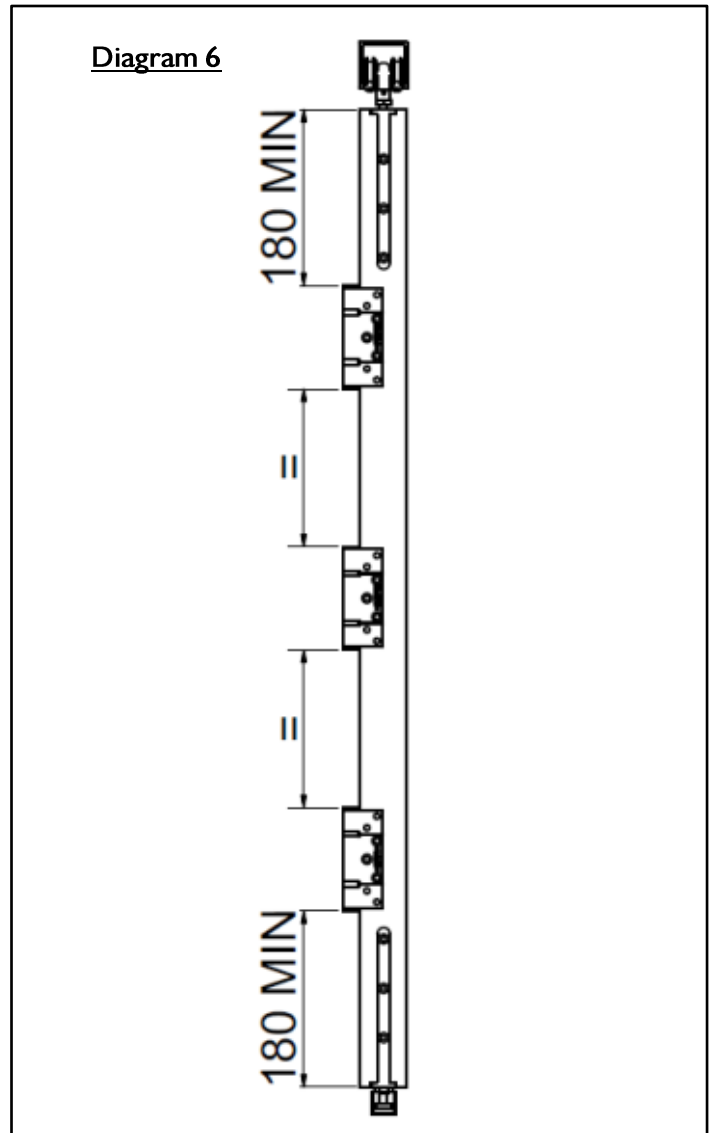

CARE AND MAINTENANCE

To provide years of trouble free operation, it is recommended that the track is kept free from dirt and debris. Periodically replace the general purpose grease on all bolts. To prolong the appearance of the exposed hinge parts, it is recommended they are periodically washed with soap and water. Maintenance is required on all components including stainless steel to validate manufacturer's warranty. For further maintenance details please refer to our website, www.pchenderson.com