

RIVNUT RNLFSTDL SERIES

Description	Large Flange, Splined Body
Material	Stainless Steel – A2
Finish	Plain

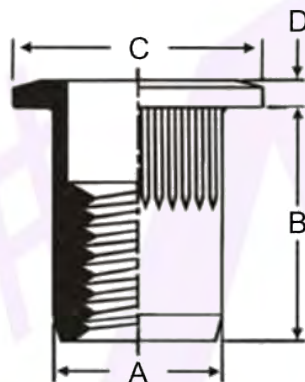

Dimensions in millimetres.

Part Number	Thread Size	Hole Size +0.15 / -0	A Max	B ±0.4	C ±0.3 *±0.64	D ±0.1	Grip Range
RNLFSTDL04	M4	6.75	6.73	10.70	9.90	0.80	0.5 ~ 2.0
RNLFSTDL04L				11.90			2.0 ~ 3.3
RNLFSTDL05	M5	7.60	7.52	12.10	10.50	0.80	0.5 ~ 3.3
RNLFSTDL05L				14.90			3.3 ~ 5.7
RNLFSTDL06	M6	10.00	9.91	14.70	12.70	1.00	0.7 ~ 4.2
RNLFSTDL06L				17.30			4.2 ~ 6.6
RNLFSTDL08	M8	13.50	13.46	17.50	*17.40	1.00	0.7 ~ 3.8
RNLFSTDL08L				20.50			3.8 ~ 7.9
RNLFSTDL10	M10	13.50	13.46	17.50	*17.40	1.00	0.7 ~ 3.8
RNLFSTDL10L				20.50			3.8 ~ 7.9

PLEASE NOTE – NOT ALL STYLES & SIZES ARE HELD IN STOCK AT ALL TIMES. PLEASE CONTACT US TO CHECK AVAILABILITY. MINIMUM ORDER QUANTITIES APPLY.