

## RIVNUT RNFFSTH SERIES

<b>Description</b>	Flush Flange, Half Hex Body
<b>Material</b>	Stainless Steel – A2
<b>Finish</b>	Plain

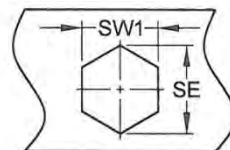
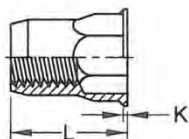

Dimensions in millimetres.

Part Number	Thread Size	Hex Hole Size SW1	SW +0 / -0.15	SE Min	D ±0.30	K +0.3 / -0	L +0.5 / -0	Grip Range
RNFFSTH04	M4	6.1	6.0	6.8	7.0	0.5	11.0	0.5 ~ 2.5
RNFFSTH05	M5	7.1	7.0	7.9	8.0	0.5	12.0	0.5 ~ 3.0
RNFFSTH06	M6	9.1	9.0	10.2	10.0	0.5	14.0	0.5 ~ 3.0
RNFFSTH08	M8	11.1	11.0	12.4	12.0	0.5	16.0	0.5 ~ 3.0
RNFFSTH10	M10	13.1	13.0	14.8	14.2	0.7	19.0	1.0 ~ 3.5

**PLEASE NOTE – NOT ALL STYLES & SIZES ARE HELD IN STOCK AT ALL TIMES. PLEASE CONTACT US TO CHECK AVAILABILITY. MINIMUM ORDER QUANTITIES APPLY.**

## RIVNUT RNLFSTH SERIES

<b>Description</b>	Large Flange, Half Hex Body
<b>Material</b>	Stainless Steel – A2
<b>Finish</b>	Plain

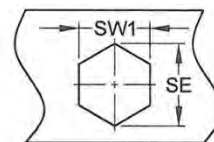
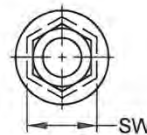
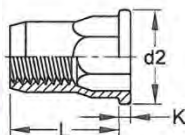

Dimensions in millimetres.

Part Number	Thread Size	Hex Hole Size SW1	SW +0 / -0.15	SE Min	d2 +0.5 / -0	K ±0.1	L ±0.3	Grip Range
RNLFSTH05	M5	7.1	7.0	7.9	10.0	1.0	12.0	0.5 ~ 3.0
RNLFSTH06	M6	9.1	9.0	10.2	12.0	1.5	14.0	0.5 ~ 3.0
RNLFSTH08	M8	11.1	11.0	12.4	14.5	1.5	14.5	0.5 ~ 3.0

**PLEASE NOTE – NOT ALL STYLES & SIZES ARE HELD IN STOCK AT ALL TIMES. PLEASE CONTACT US TO CHECK AVAILABILITY. MINIMUM ORDER QUANTITIES APPLY.**