

RIVNUT RNFFSSi SERIES

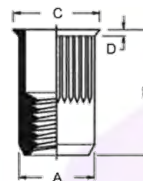

Description	Flush Flange, Splined Body
Material	Steel
Finish	Zinc



Dimensions in inches.

Part Number	Thread Size	Hole Size +.006/-0.000	A +.006/-0.000	B ±.015	C ±.010/±.015*	D ±.002	Grip Range
RNFFSSi316	3/16 UNC	.297	.297	.475	.340	.019	.020 ~ .130
RNFFSSi14	1/4 UNC	.391	.391	.580	.455	.022	.027 ~ .165
RNFFSSi516	5/16 UNC	.531	.531	.690	.595*	.022	.027 ~ .150
RNFFSSi38	3/8 UNC	.531	.531	.690	.595*	.022	.027 ~ .150

PLEASE NOTE – NOT ALL STYLES & SIZES ARE HELD IN STOCK AT ALL TIMES. PLEASE CONTACT US TO CHECK AVAILABILITY. MINIMUM ORDER QUANTITIES APPLY.

RIVNUT RNLFFSSi SERIES



Description	Large Flange, Splined Body
Material	Steel
Finish	Zinc

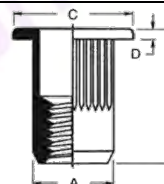

Dimensions in inches.

Part Number	Thread Size	Hole Size +.006/-0.000	A +.006/-0.000	B ±.015	C ±.010/±.025*	D ±.003	Grip Range
RNLFFSSi316	3/16 UNC	.297	.297	.475	.415	.030	.020 ~ .130
RNLFFSSi14	1/4 UNC	.391	.391	.580	.500	.030	.027 ~ .165
RNLFFSSi516	5/16 UNC	.531	.531	.690	.685*	.035	.027 ~ .150
RNLFFSSi38	3/8 UNC	.531	.531	.690	.685*	.035	.027 ~ .150

PLEASE NOTE – NOT ALL STYLES & SIZES ARE HELD IN STOCK AT ALL TIMES. PLEASE CONTACT US TO CHECK AVAILABILITY. MINIMUM ORDER QUANTITIES APPLY.